

STA. 873+20.64, LT.

RET	BEVERAGE KING ROUTE 4A WEST	7/10	→
RET	WOODARD MARINE RTE. 4A TO WEST SHORE	1 1/2	→
RET	BIRDSEYE DINER	1 1/2	←

STA. 871+46.40, LT.

RET	WILLIAM C. KUEHN LAW OFFICE ROXIE'S	1 2	→
RET	CASTLETON PIZZA PLACE & DELI	2	←
RET	RILEY AGENCY REALTY & INS.	2	←

STA. 874+63.20, LT.

RET	FARROW GALLERY & STUDIO MAIN ST.	1 1/2	←
RET	CASTLETON VILLAGE STORE	1 1/2	←
RET	POND HILL RANCH SOUTH ST.	5	←

STA. 896+12.16, LT.

STA. 894+43.20, LT.

R	FAIR HAVEN	4	→
R	CASTLETON	2	→
R	RUTLAND	12	→

N	FAIR HAVEN	4	→
N	CASTLETON	2	→
N	RUTLAND	12	→

STA. 896+96.64, LT.

STA. 896+96.64, LT.

STA. 899+97.60, LT.

RET	CASTLETON ELEMENTARY SCHOOL	→
RET	CASTLETON ELEMENTARY SCHOOL	→

STA. 896+96.64, LT.

R	LEGAL LOAD LIMIT 24,000 POUNDS
N	LEGAL LOAD LIMIT 24,000 POUNDS

W/ STOP

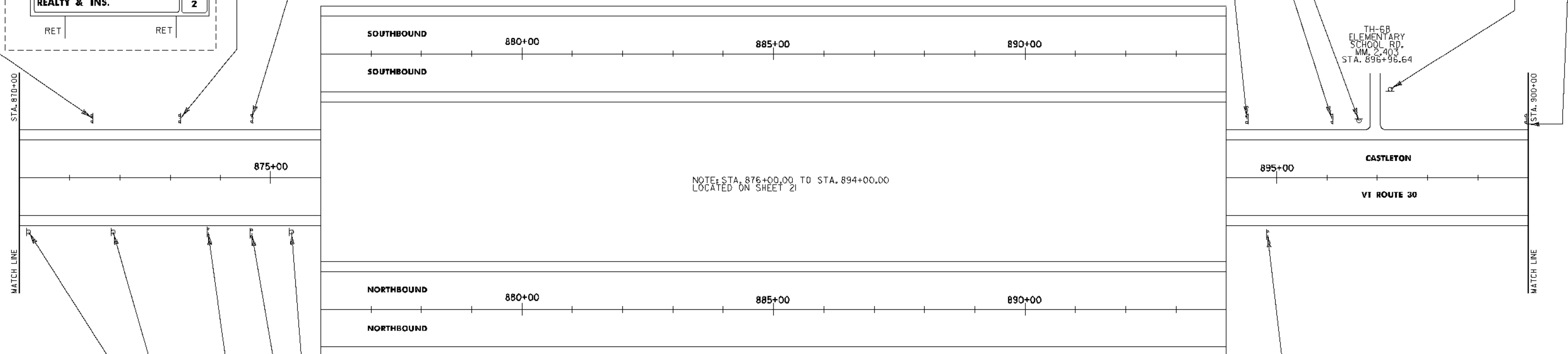

STA. 870+10.00, RT.

R	0300 1103 0180	N	0300 1103 0180
---	----------------------	---	----------------------

STA. 871+83.36, RT.

STA. 873+73.44, RT.

STA. 875+37.12, RT.

STA. 874+63.20, RT.

R	↑ FAIR HAVEN	4
R	CASTLETON	2 →
R	RUTLAND	12 →

N	↑ FAIR HAVEN	4
N	CASTLETON	2 →
N	RUTLAND	12 →

ACTUAL 17
SALVAGED 0
POSTS 0

SIGN LEGEND
R= REMOVE
S= SALVAGE
N= NEW
RET= RETAIN
B-B= BACK TO BACK
EXISTING= ---
NEW= - - - -

870+00 - 900+00

PROJECT NAME: WELLS-HUBBARDTON
PROJECT NUMBER: STPG SIGN (15)

FILE NAME: stpg sign15 plans.dgn PLOT DATE: 04-AUG-2008
PROJECT LEADER: N. AVERY DRAWN BY: ROADWAY
DESIGNED BY: N. AVERY CHECKED BY: A. GAMBLE
SIGNING PLAN #17 SHEET 20 OF 75