

Curve #1
 Δ 25°-02'-00"
 D 9°-30'
 R 603.11
 T 133.89
 L 263.51
 E 17.68
 2T-L 4.21
 Bank 0.0594/ft

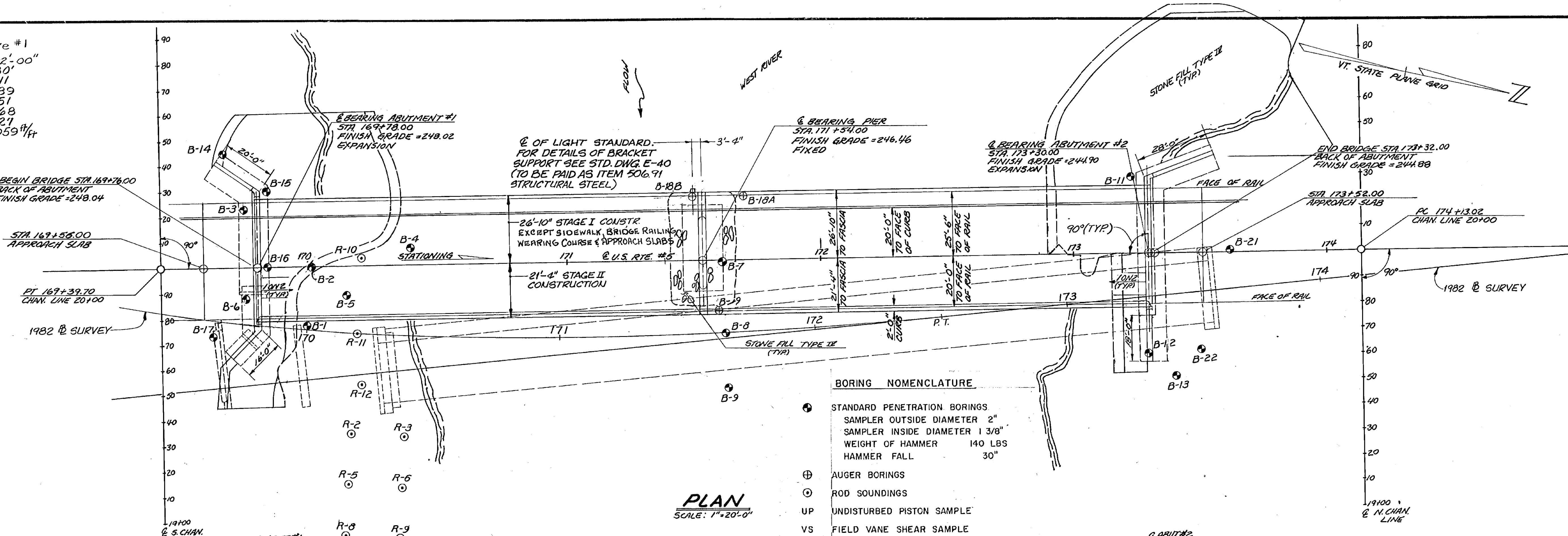

BORING NOMENCLATURE

- STANDARD PENETRATION BORINGS
 SAMPLER OUTSIDE DIAMETER 2"
 SAMPLER INSIDE DIAMETER 1 3/8"
 WEIGHT OF HAMMER 140 LBS
 HAMMER FALL 30"
- ⊕ AUGER BORINGS
- ROD SOUNDINGS
- UP UNDISTURBED PISTON SAMPLE
- VS FIELD VANE SHEAR SAMPLE

PLAN
 SCALE: 1" = 20'-0"

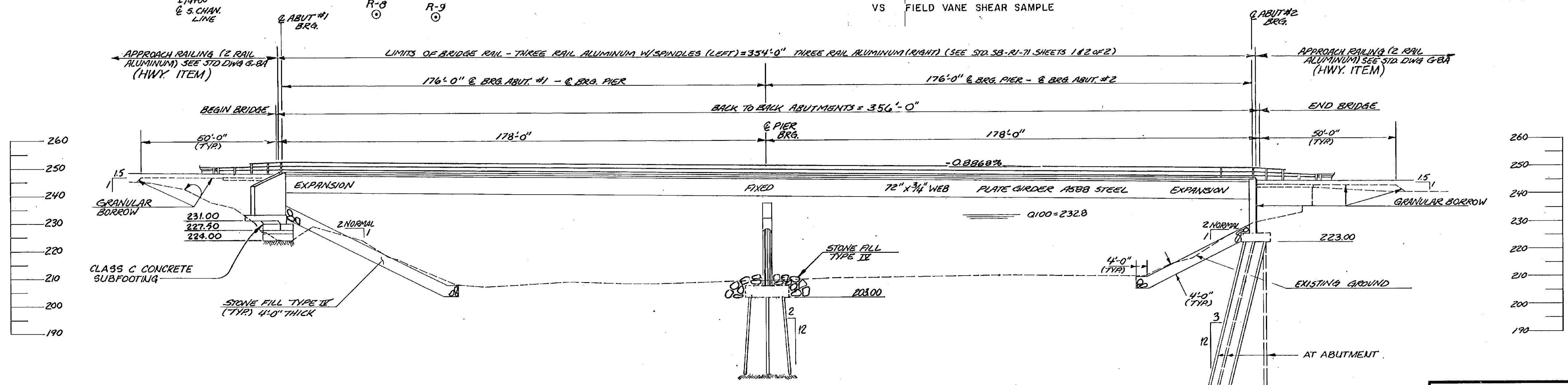

ELEVATION @ RIGHT FASCIA
 SCALE: 1" = 20'-0"

STATEWIDE - SOUTHEAST REGION
 BHF MEMB(21)
 SHEET 31 OF 34
 BRIDGE 8
 FOR REFERENCE ONLY

STATE OF VERMONT	
AGENCY OF TRANSPORTATION	
TOWN OF BRATTLEBORO	Bridge No. 8
HIGHWAY NO. U.S. RTE. 5	Log Sta. 171+54
U.S. RTE. 5 OVER WEST RIVER	
PLAN AND ELEVATION	
Designed by J.B. MCCARTHY	Drawn by L.C. GATES
Checked by J.B. MCCARTHY date 9-83	Bridge Design Supervisor Charles W. Terenziate 1/85
PROJECT BRATTLEBORO	PROJECT NO. BRM2000(9)
Bridge Sheet No. BR103	Sheet 36 of 124

BARNES & JARNIS, INC.
 CONSULTING ENGINEERS
 BOSTON, MASS. 02116