

# STATE OF VERMONT AGENCY OF TRANSPORTATION

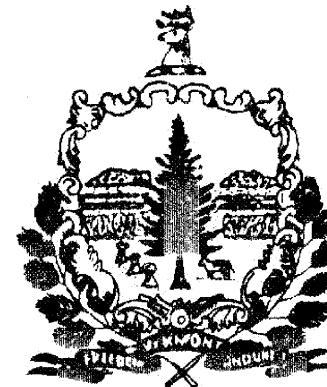

## PROPOSED IMPROVEMENT TOWNS OF WESTMINSTER & ROCKINGHAM COUNTY OF WINDHAM US ROUTE 5 (FAS)

BEGINNING AT A POINT ON US ROUTE 5, IN THE TOWN OF WESTMINSTER, APPROXIMATELY 0.331 MILES SOUTHERLY FROM THE WESTMINSTER-ROCKINGHAM TOWN LINE AND PROCEEDING NORTHERLY FOR 0.341 MILES.

LENGTH OF ROADWAY = 1365.84 FEET = 0.259 MILES  
LENGTH OF BRIDGE = 434.16 FEET = 0.082 MILES  
LENGTH OF PROJECT = 1800.00 FEET = 0.341 MILES

### PROJECT DESCRIPTION

WORK TO BE PERFORMED UNDER THIS CONTRACT CONSISTS OF REPLACEMENT OF BRIDGE NO. 33 OVER THE SAXTONS RIVER, ON NEW LOCATION AND ASSOCIATED ROADWAY WORK WHICH INCLUDES GRADING, DRAINAGE, SUBBASE AND PAVEMENT FOR U.S. ROUTE 5.

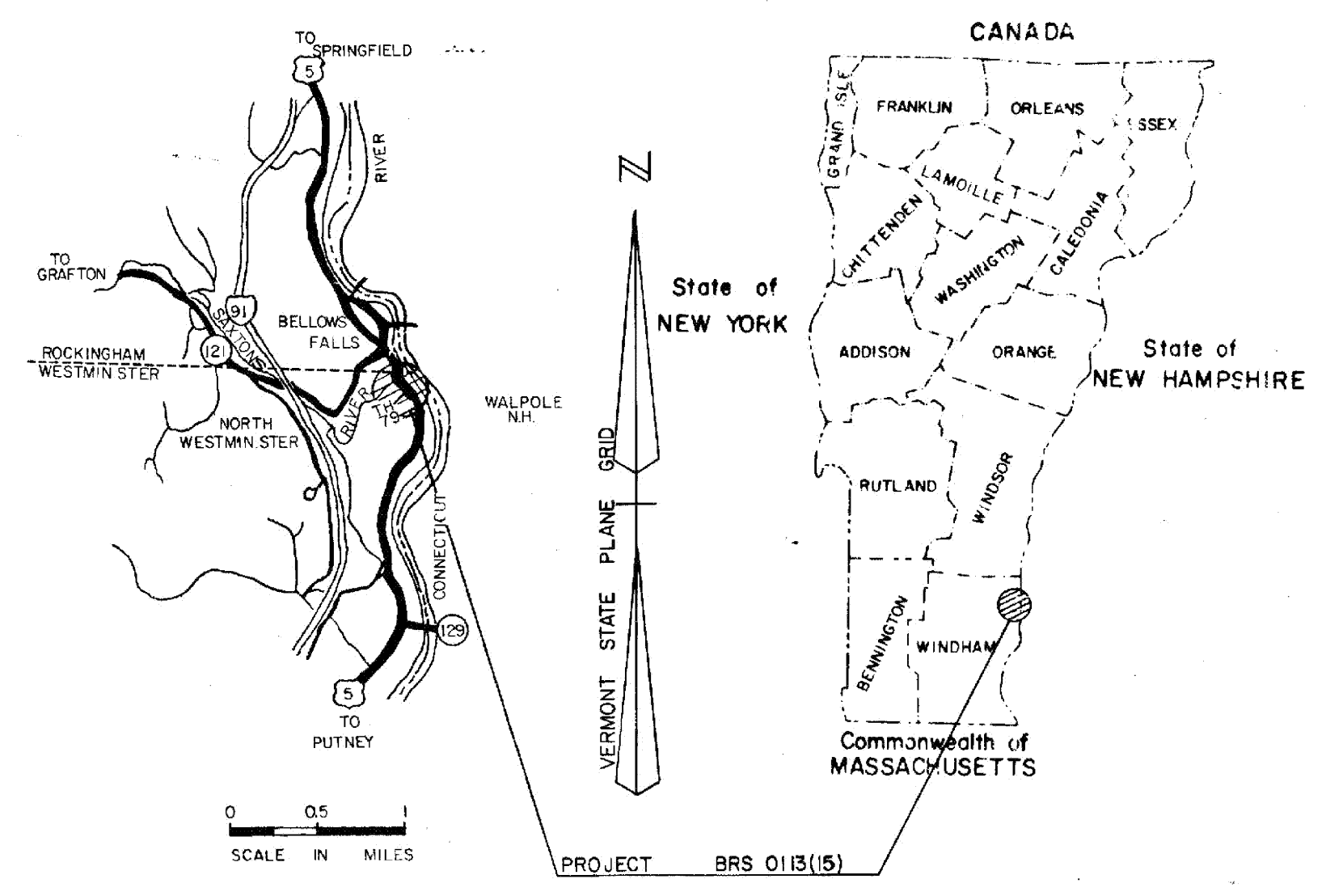

1	TITLE SHEET	
2-5	TYPICAL SHEETS	
6-8	QUANTITY SHEETS	
9-10	ITEM DETAIL AND DRAINAGE SHEETS	
11-13	EARTHWORK SHEETS	
14-15	BLANK	
16-28	ROW DETAIL SHEETS	
29-34	PLAN SHEETS	
35-44	BLANK	
45-53	PROFILE AND TIE SHEETS	
54-64	UTILITIES SHEETS	
65	BLANKS	
66	GRADING PLAN (TRK. LANES)	
67-69	TRAFFIC SIGNS, SIGNALS (SHEET 67-BLANK)	
70-77	BLANK	
78-131	BRIDGE BR. SERIES (INCLUDES CHANNEL X-SECTIONS)	
132-133	BLANK	
134	A-26	17 JUN 82
135	A-66	21 NOV 80 R
136	BLANK	
137	B-1	BANKING TABLES 08 DEC 71
138	B-5	SLOPE ROUNDING 06 DEC 71
139	B-11	SLOPE STABILIZATION 12 DEC 74 R
140	B-13	DRIVE INTERSECTIONS 14 DEC 71
141	B-71	DRIVE STANDARDS 23 JUL 80 R
142	BLANK	
143	C-1	VERTICAL GRANITE CURB 16 DEC 80 R
144	C-2A	PORTLAND CEMENT CONCRETE SIDEWALK 14 DEC 71
145	C-2B	PORTLAND CEMENT CONCRETE SIDEWALK 14 DEC 71
146	C-3	SIDEWALK RAMPS 07 AUG 80
147	BLANK	
148	D-2	UNDERDRAIN 16 DEC 76 R
149	D-4	UNDERDRAIN, PIPE ELBOWS 24 JUL 75 R
150	D-6	REINFORCED CONCRETE DROP INLET WITH GRATE 04 APR 73 R
151	D-8	REINFORCED CONCRETE DROP INLET WITH GRATE 06 DEC 71
152	D-9	REINFORCED CONCRETE DROP INLET WITH VERTICAL CURB 06 DEC 71
153	D-11	CAST IRON GRATE, TYPE A 24 AUG 81 R
154	D-13	CONCRETE CATCH BASIN WITH CAST IRON GRATE 10 AUG 81 R
155	D-16	PRECAST REINFORCED CONCRETE CURB DROP INLET, CAST IRON GRATE, TYPE B 14 NOV 72 R
156	D-20	HIGHWAY CROSSINGS FOR UNDERGROUND UTILITIES SRPT 75 R
157	D-22	SANITARY SEWER SYSTEMS 01 OCT 76
158-159	BLANK	
160	E-2	ROAD CONSTRUCTION APPROACH SIGNS 04 MAR 81 R
161	E-7	DELINEATION AND BARRICADES 02 FEB 83 R
162	E-7A	BARRICADE DETAILS - BREAKAWAY 03 JAN 85 R
163	E-8	TYPICAL MAJOR MAINTENANCE OPERATION 15 JUN 83 R
164	F-15A	REGULATORY SIGNS 18 JUL 84
165	F-15B	REGULATORY SIGNS 27 DEC 84 R
166	F-15C	REGULATORY SIGNS 18 JUL 84
167	F-19A	WARNING SIGNS 03 OCT 84
168	F-19B	WARNING SIGNS 19 FEB 85 R
169	F-23	GUIDE SIGNS PLACEMENT 10 FEB 83 R
170	F-24A	SIGN POSTS 08 JAN 81 R
171	F-29	SIGN PLACEMENT - NON EXPRESSWAY 25 AUG 81 R
172	BLANK	
173	K-40	BRIDGE LIGHTING DETAILS 02 JAN 85 R
174	K-50	PAVEMENT MARKING DETAILS 20 SEPT 85 R
175-176	BLANKS	
177	F-2	CHAIN LINK FENCE 01 FEB 79 R
178	F-3	CHAIN LINK FENCE 01 FEB 79 R
179	F-4	CHAIN LINK FENCE 19 MAR 79 R
180	BLANK	
181	G-1	GUARD RAIL, STANDARD STEEL BEAM 21 DEC 84 R
182	G-1D	GUARD RAIL, STANDARD STEEL BEAM 21 DEC 84 R
183	G-4	GUARD RAIL, PLANK WITH WOOD POSTS 25 MAY 82 R
184	G-8A	APPROACH RAILING - 2 RAIL ALUMINUM 01 JUL 78 R
185-186	BLANK	
187	J-1	BOUNDARY MARKERS 27 JUN 80
188	BLANK	
189	T-1	TEMPORARY EROSION CONTROL DETAILS 07 DEC 76 R
190	T-2	TEMPORARY EROSION CONTROL DETAILS 05 JUL 72
191	BLANK	
192	SCB-D1-75	GENERAL INFORMATION 14 SEPT 81 R
193	SCB-D4-76	DETAILS OF W BEAM BRIDGES 12 OCT 83 R
194	SCB-D6-73	DETAILS OF W BEAM BRIDGES 03 JAN 79 R
195	SCB-D7-71	DETAILS OF W BEAM BRIDGES 15 DEC 76 R
196	SB-R1-71	ALUMINUM BRIDGE RAILING DETAILS 11 FEB 85 R
197-203	BLANKS	
204-232	CROSS SECTIONS - MAINLINE	
233-237	CROSS SECTIONS - HOLMES DRIVE	
238-243	CROSS SECTIONS - TH 19	
244-251	CROSS SECTIONS - TRK 1	
252-254	CROSS SECTIONS - TRK 2	
255-257	CROSS SECTIONS - TRK 3	
258-259	BLANK	
260	DRIVE SECTION (417+25 RP.)	
261	TURN-A-ROUND CROSS SECTIONS	
262	REINFORCED CONC. DROP INLET DETAILS (RAFFLED)	

### CONVENTIONAL SIGNS

COUNTY LINE	---
TOWN LINE	- - - -
LIMITS OF ACCESS	○ ○ ○ ○
POINT OF ACCESS	X
FENCE LINE	— x — x —
STONE WALL	— x — x —
PAVELED WAY	— x — x —
RAILROAD	— x — x —
SURVEY LINE	— x — x —
CULVERT	— x — x —
POWER POLE	○
TELEPHONE POLE	○
TREES	○
CONTROL OF ACCESS	— x — x —
PROPERTY LINE	— x — x —
ROW TAKING LINE	— x — x —
SLOPE RIGHTS	○ SR ○
TOP OF CUT	— x — x —
TOE OF SLOPE	— x — x —

**DATUM**  
VERTICAL - NGVD 1929  
HORIZONTAL - N/A

CONTRACTOR - WINTERSSET INC.  
LYNDONVILLE, VT.  
RESIDENT ENGINEER - JACQUES G. COUTURE  
CONSTRUCTION BEGAN - JANUARY 5, 1987  
CONSTRUCTION COMPLETED - AUGUST 8, 1989  
RECORD PLANS BY - W. NATE THAYER

I hereby certify that all the construction required by this set of drawings has been accomplished as indicated herein.

By *Jacques G. Couture* Resident Engineer  
Date *22 July 1991*

NOTE: Any further information concerning final quantities, amounts or other details relative to this project may be found on microfilm in Central Files.

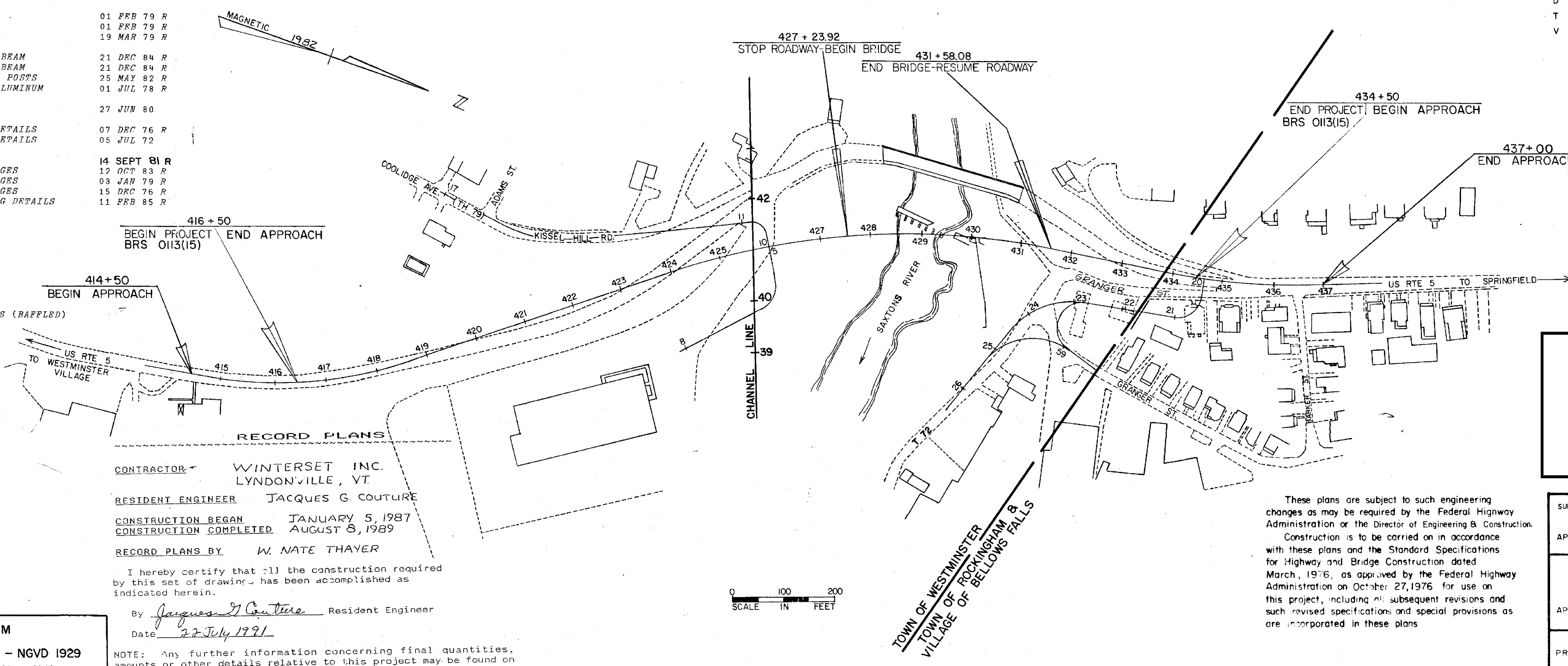

STATEWIDE - SOUTHEAST  
REGION  
BHF MEMB(21)  
  
SHEET 19 OF 34  
BRIDGE 33  
FOR REFERENCE ONLY

SUBMITTED BY ORDER OF THE STATE TRANSPORTATION BOARD	
APPROVED	DATE
DIRECTOR OF ENGINEERING AND CONSTRUCTION	
DEPARTMENT OF TRANSPORTATION FEDERAL HIGHWAY ADMINISTRATION	
APPROVED	DATE
DIVISION ADMINISTRATOR	
PROJECT BRS No 0113(15)	
SHEET 1 OF 262 SHEETS	