

NOTE
 REMOVAL OF EXISTING MATERIAL AND CLEANING OF EXISTING REINFORCEMENT AND ANCHORAGE STUDS TO BE PAID FOR UNDER ITEM 580.20 RAPID SETTING CONCRETE REPAIR MATERIAL WITH COARSE AGGREGATE.

**SLIDING PLATE JOINT DETAIL, BRIDGE 54
 (BOTH ENDS)**
 NOT TO SCALE

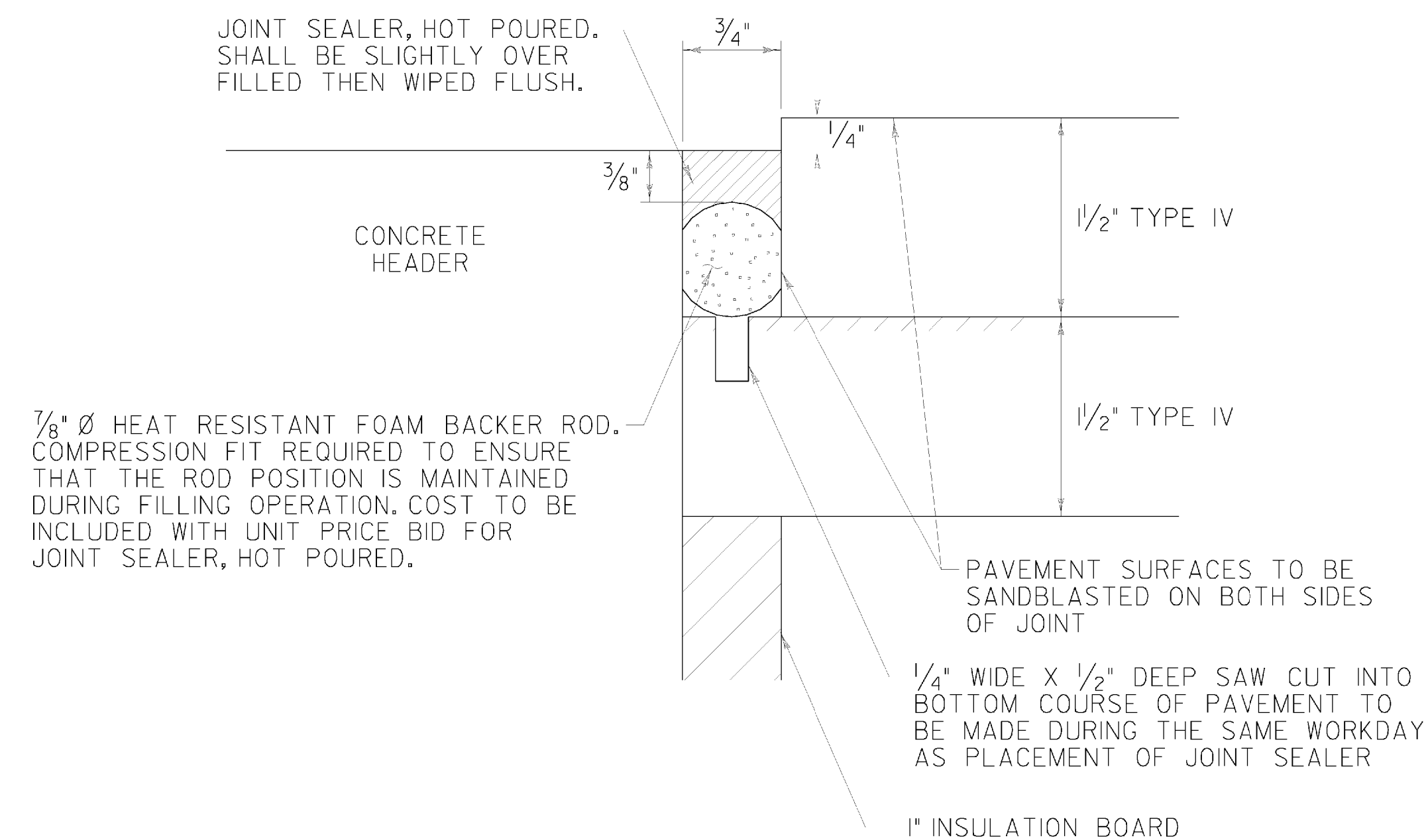

NOTE:
 1. CLEAN SAWING DUST AND OTHER FOREIGN MATERIAL FROM THE SAWED JOINT BEFORE APPLYING THE HOT POURED JOINT SEALER IN ACCORDANCE WITH SUBSECTION 524.05.

JOINT SEALER, HOT POURED DETAIL
 NOT TO SCALE

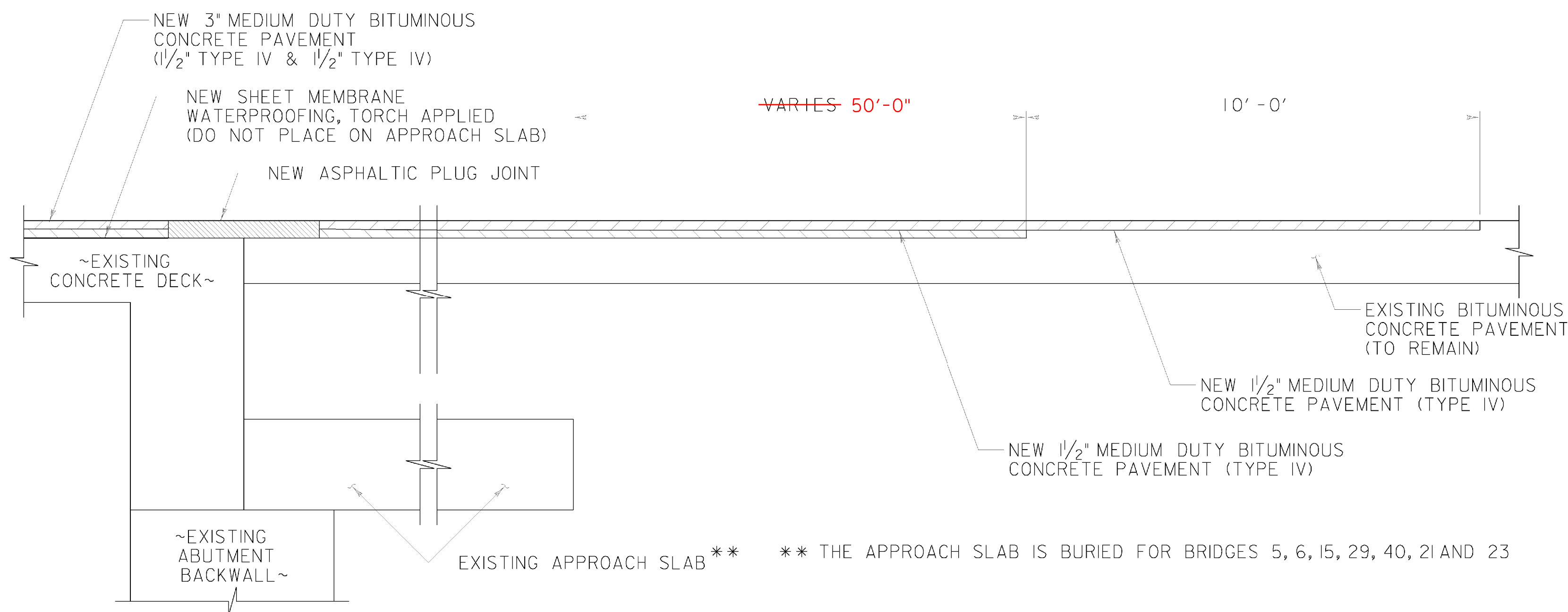

ALL APPROACHES EXTENDED TO 60 FT.

TYPICAL APPROACH SECTION
 NOT TO SCALE

FILE NAME = K:\19647\CADD\MSTN\MDT_3.dgn
 DATE/TIME = 3/11/2009
 USER = JMS



PROJECT NAME:	STATEWIDE - SOUTHWEST REGION
PROJECT NUMBER:	BHF MEMB(20)
FILE NAME:	MDT 3.DGN
PROJECT LEADER:	P. PIERCE
DESIGNED BY:	C. AYERS
BITUMINOUS CONCRETE DETAILS SHEET 2	
PLOT DATE:	3/11/2009
DRAWN BY:	C. KAHLBAUGH
CHECKED BY:	P. PIERCE
SHEET 9	OF 47