

RAMP TYPICALS - SEE SHEETS 6 & 7.

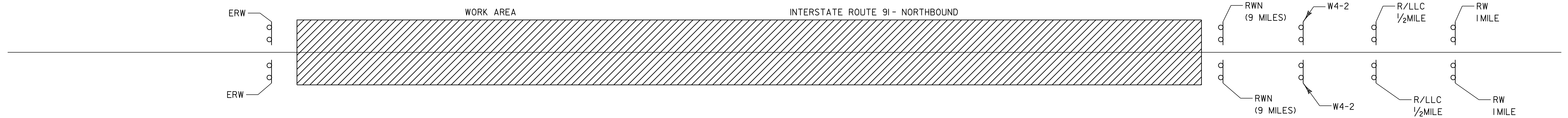

NOTES:

1. ADDITIONAL RAMP SIGNING MAY BE REQUIRED, AS DIRECTED BY THE RESIDENT ENGINEER.
2. THE BID PRICE FOR TRAFFIC CONTROL - ITEM 641.10, SHALL INCLUDE ALL APPROACH AND ON-PROJECT CONSTRUCTION SIGNING, BARRIERS, BARRELS, CONES, BARRICADES, TEMPORARY REGULATORY AND WARNING SIGNS AND POSTS AS DETAILED ON STANDARD E-103M, MAINLINE TRAFFIC CONTROL--DIVIDED HIGHWAY. ALL ADJUSTING, RELOCATING AND REMOVING OF THESE DEVICES AS DIRECTED BY THE RESIDENT ENGINEER SHALL BE INCLUDED. THE FOLLOWING ITEMS WILL BE PAID UNDER THEIR SPECIFIC BID PRICES:
 630.10 -- UNIFORMED TRAFFIC OFFICERS
 630.15 -- FLAGGERS
3. PORTABLE CHANGEABLE MESSAGE SIGNS ARE TO USED ALONG THIS PROJECT. THE PLACEMENT OF THESE MESSAGE SIGNS AS WELL AS THEIR MESSAGES WILL BE AS APPROVED BY THE RESIDENT ENGINEER. THIS QUANTITY IS PAID FOR UNDER ITEM 641.15 - PORTABLE CHANGEABLE MESSAGE SIGN.
4. THE CONTRACTOR SHALL INCLUDE A CONSTRUCTION SIGN APPROACH PACKAGE FOR EXPECTED LANE CLOSURES AND WORKZONE SPEED REDUCTIONS IN COMPLIANCE WITH STD. E-103. PAYMENT FOR THIS PACKAGE SHALL BE INCIDENTAL TO ITEM 641.10, "TRAFFIC CONTROL".

LEGEND

- RW 1 MILE = ROAD WORK 1 MILE
- R/LLC 1/2 MILE = RIGHT (OR LEFT) LANE CLOSED 1/2 MILE
- RWN = ROAD WORK NEXT (9 MILES)
- ERW = END ROAD WORK
- SRWA = SIDE ROAD WORK AHEAD
- SRW 500 = SIDE ROAD WORK 500 FT
- W4-2 = LANE ENDS
- //// = WORK AREA

SEE STD E-100 AND E-103 FOR SIGN PLACEMENT.

NOT TO SCALE

**CONSTRUCTION
APPROACH
SIGNING**

PROJECT NAME: STATEWIDE
 PROJECT NUMBER: IM RUTF(13)

FILE NAME: /pave/06a180/p06a180.dgn
 PROJECT LEADER: M. WOOLAVER
 DESIGNED BY: JLR
 p06a180cas.1

PLOT DATE: 15-MAY-2008 08:58
 DRAWN BY: KAS
 CHECKED BY: JLR
 SHEET 7 OF 7