

STATE OF VERMONT  
AGENCY OF TRANSPORTATION



PROPOSED IMPROVEMENT

ROADWAY WEATHER INFORMATION SYSTEMS  
TOWN OF FAIR HAVEN  
COUNTY OF RUTLAND

U.S. ROUTE 4 - VERMONT WELCOME CENTER

PROJECT LOCATION: EXIT US RTE. 4 EASTBOUND AT EXIT 1, APPROXIMATELY 0.25 MILES TURN RIGHT ON VERMONT WELCOME COURT. THE VERMONT WELCOME CENTER IS LOCATED ON THE SOUTHERN SIDE AT THE END OF THE ROAD.

PROJECT DESCRIPTION: SITE PREPARATION FOR A ROADWAY WEATHER INFORMATION SYSTEM, EQUIPPED WITH TELEPHONE AND ELECTRICAL SERVICES.

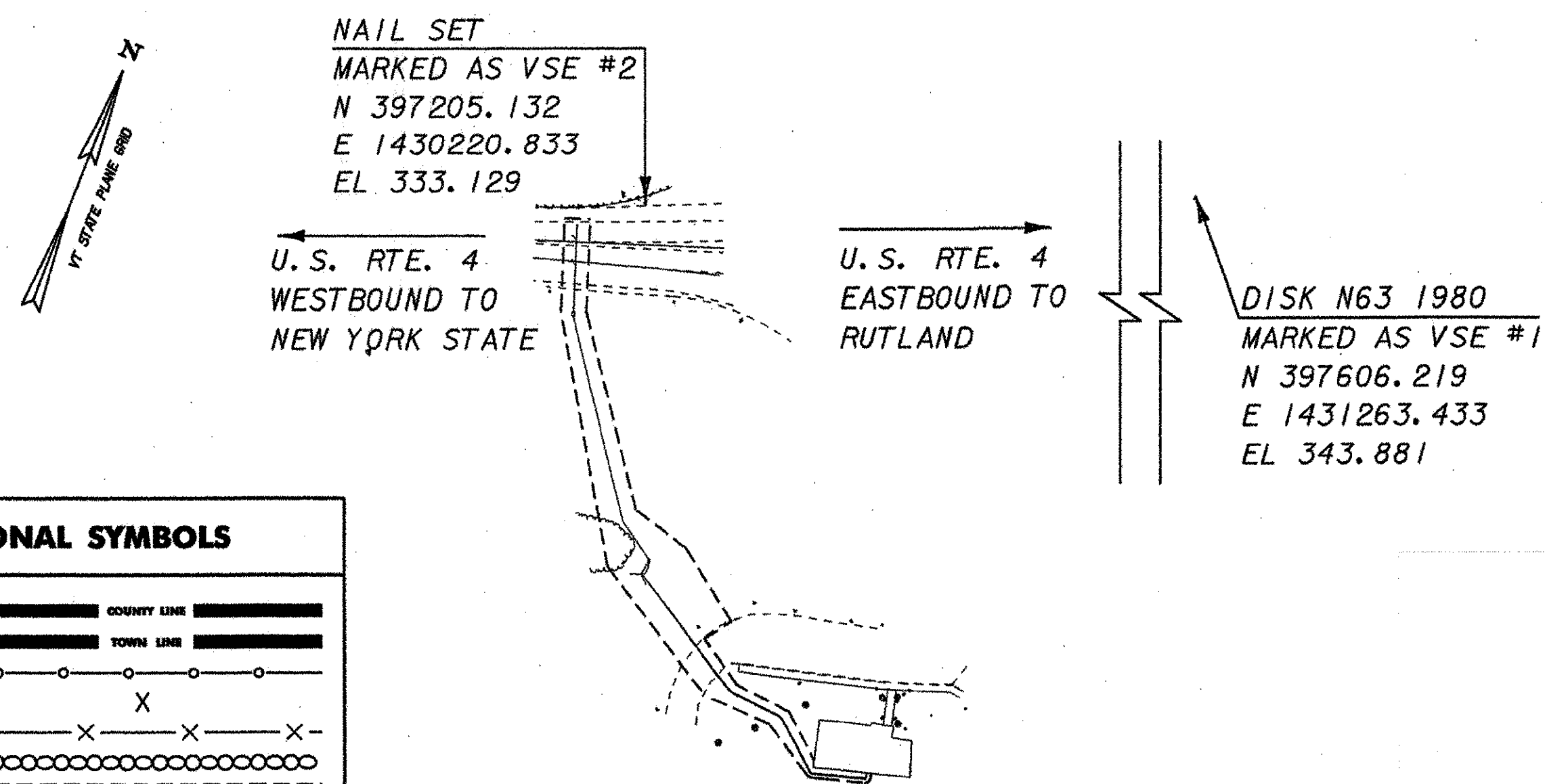

CONVENTIONAL SYMBOLS

|                    |  |
|--------------------|--|
| COUNTY LINE        |  |
| TOWN LINE          |  |
| LIMITS OF ACCESS   |  |
| POINT OF ACCESS    |  |
| FENCE LINE         |  |
| STONE WALL         |  |
| TRAVELED WAY       |  |
| GUARD RAIL         |  |
| RAILROAD           |  |
| SURVEY LINE        |  |
| CULVERT            |  |
| POWER POLE         |  |
| TELEPHONE POLE     |  |
| TREES              |  |
| CONTROL OF ACCESS  |  |
| PROPERTY LINE      |  |
| R.O.W. TAKING LINE |  |
| SLOPE RIGHTS       |  |
| TOP OF CUT         |  |
| TOE OF SLOPE       |  |

SURVEYED BY: TOPOGRAPHIC SURVEY BY: VSE DATE: 06/06  
SURVEY CONTROL BY: VSE DATE: 06/06

DATUM  
VERTICAL NAVD 88 (US FEET)  
HORIZONTAL NAD 83 (1996) VT SPC (US FEET)

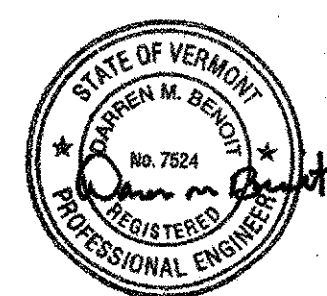

FAIR HAVEN

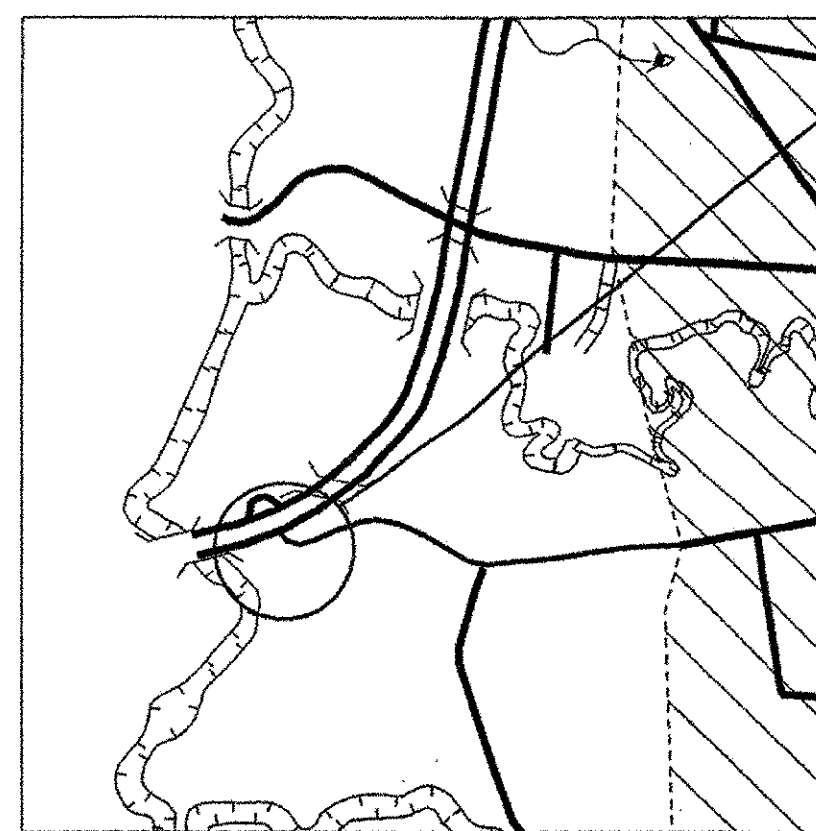

CANADA

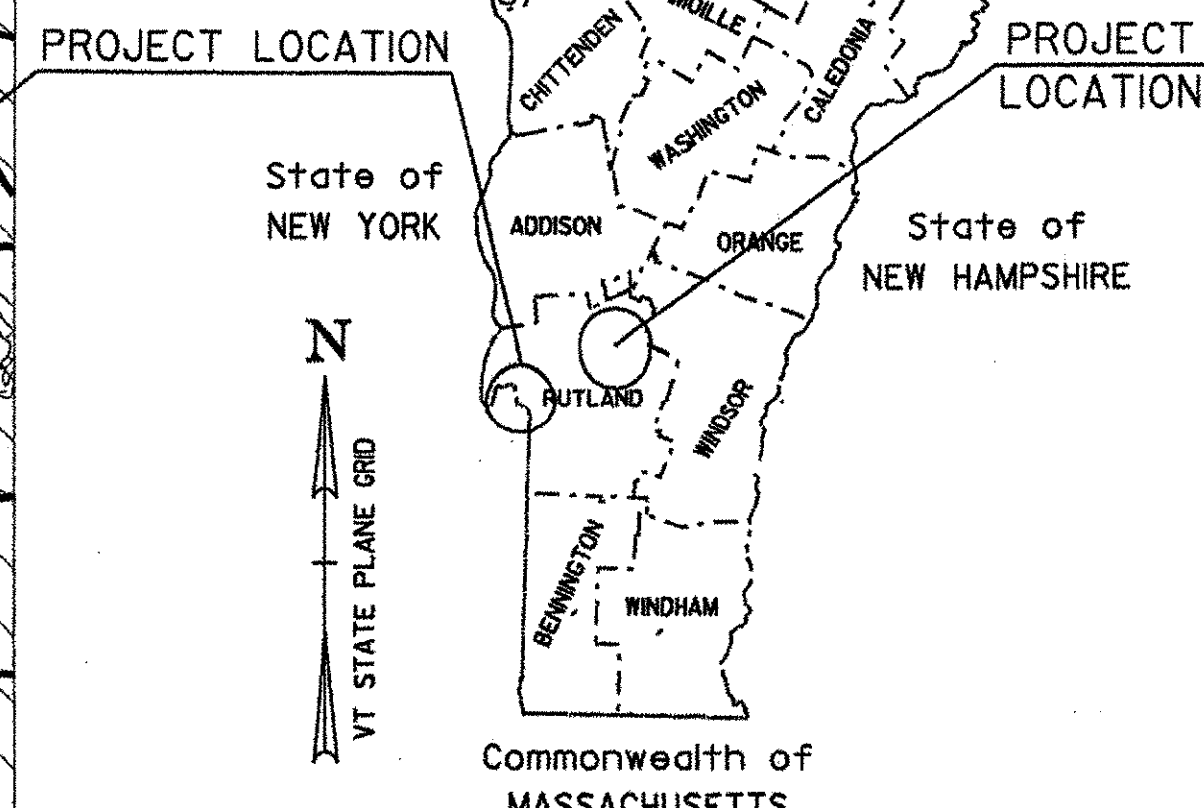

MENDON

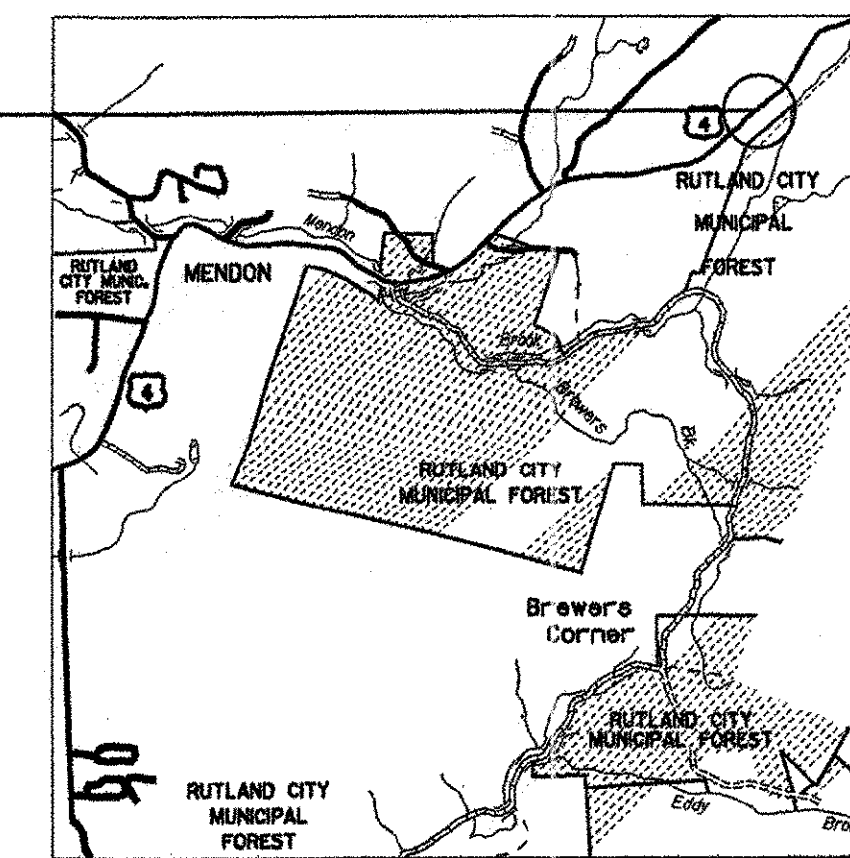

INFORMATION SYSTEMS

TOWN OF MENDON  
COUNTY OF RUTLAND

U.S. ROUTE 4 - VTRANS GARAGE

PROJECT LOCATION: START AT INTERSECTION OF US RTE. 4 & US RTE. 7 AND GO EAST ON US RTE. 4 APPROXIMATELY 7.0 MILES. THE VTRANS GARAGE IS LOCATED ON THE RIGHT (SOUTHERLY) SIDE OF THE ROAD.

PROJECT DESCRIPTION: SITE PREPARATION FOR A ROADWAY WEATHER INFORMATION SYSTEM, EQUIPPED WITH TELEPHONE AND ELECTRICAL SERVICES.

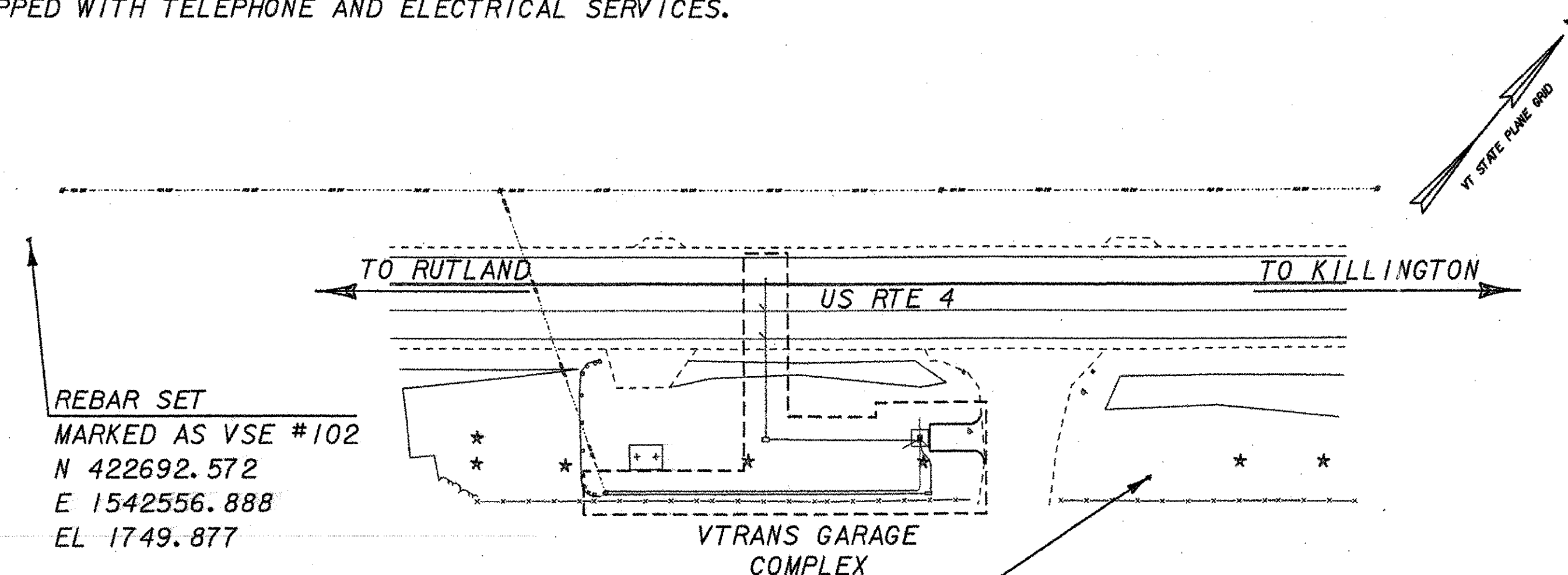

RECORD PLANS

CONTRACTOR: PIKE INDUSTRIES, INC. - BERLIN, VT  
RESIDENT ENGINEER: JOSH HULETT  
CONSTRUCTION BEGAN: NOVEMBER 5, 2007  
CONSTRUCTION COMPLETE: JUNE 6, 2008  
RECORD PLANS BY: JOSH HULETT & NICK GARBACIK

I HEREBY CERTIFY THAT ALL THE CONSTRUCTION REQUIRED BY THIS SET OF DRAWINGS HAS BEEN ACCOMPLISHED AS INDICATED HEREIN.

BY *Josh Hulett* RESIDENT ENGINEER

DATE 1/14/2009

NOTE: Any further information concerning final quantities, amounts or other details relative to this project may be found at Central Files in the electronic archives.

THESE PLANS ARE SUBJECT TO SUCH ENGINEERING CHANGES AS MAY BE REQUIRED BY THE FEDERAL HIGHWAY ADMINISTRATION OR THE DIRECTOR OF THE OPERATIONS DIVISION. CONSTRUCTION IS TO BE CARRIED ON IN ACCORDANCE WITH THESE PLANS AND THE STANDARD SPECIFICATIONS FOR CONSTRUCTION DATED 2006, AS APPROVED BY THE FEDERAL HIGHWAY ADMINISTRATION ON JUNE 15, 2006 FOR USE ON THIS PROJECT, INCLUDING ALL SUBSEQUENT REVISIONS AND SUCH REVISED SPECIFICATIONS AND SPECIAL PROVISIONS AS ARE INCORPORATED IN THESE PLANS.

DIRECTOR OF OPERATIONS

APPROVED *Sam* DATE 8/10/07

PROJECT MANAGER: DAN GRAHOVAC

PROJECT: FAIR HAVEN: RWIS1  
MENDON: RWIS1

SHEET 1 OF 12 SHEETS