

**CONSTRUCTION APPROACH SIGNING**

NOT TO SCALE  
SEE STD E-100 AND E-100A FOR SIGN PLACEMENT

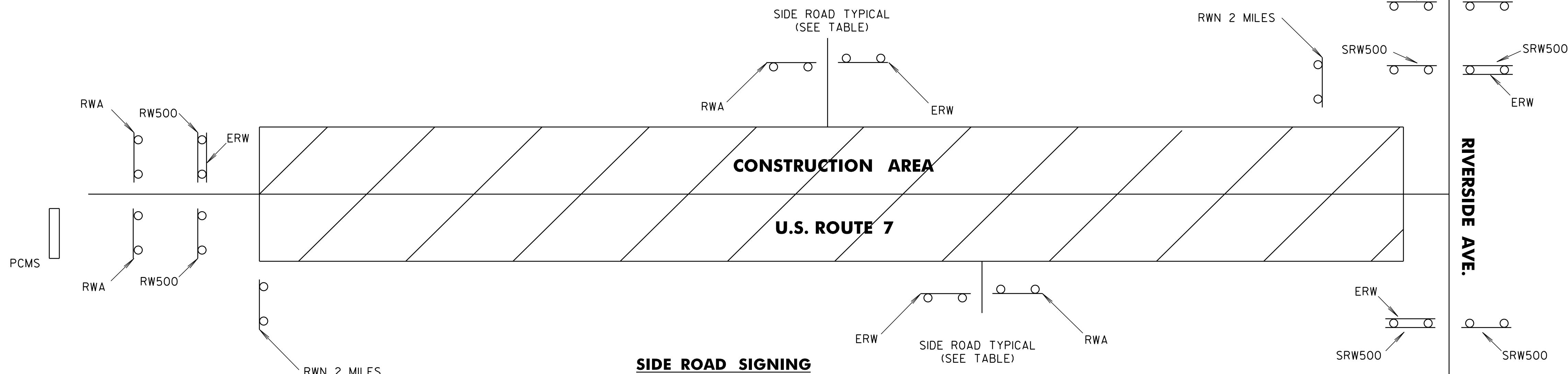

**SIDE ROAD SIGNING**

SIDE ROAD NAME	ROAD WORK AHEAD	SIDE ROAD WORK AHEAD	SIDE ROAD WORK 500 FT	END ROAD WORK	ROAD WORK 500 FT	ROAD WORK NEXT 2 MILES	PCMS
<b>BURLINGTON</b>							
BEGIN PROJECT (U.S. RT 7)	2			1	2	1	1
LYMAN AVE.	1			1			
WHITE PLACE	1			1			
FERGUSON AVE.	1			1			
PROCTOR AVE.	1			1			
FLYNN AVE.	2			2			
PROSPECT PARKWAY	1			1			
CLYMER STREET	1			1			
BIRCHCLIFF PARKWAY	1			1			
ALFRED STREET	1			1			
HOOVER STREET	1			1			
ADAMS COURT	1			1			
GOVE COURT	1			1			
LEDGE STREET	1			1			
SHELBURNE ROAD	1			1			
CHITTENDEN DRIVE	1			1			
BEECH STREET	1			1			
HOWARD STREET	1			1			
BAYVIEW STREET	1			1			
DEFOREST ROAD	1			1			
CLIFF STREET	2			2			
SPRUCE STREET	1			1			
TOWER TERRACE	1			1			
MAPLE STREET	2			2			
JACKSON COURT	1			1			
MAIN STREET	2			2			
COLLEGE STREET	2			2			
BRADLEY STREET	1			1			
BUELL STREET	1			1			
PEARL STREET	2			2			

SIDE ROAD NAME	ROAD WORK AHEAD	SIDE ROAD WORK AHEAD	SIDE ROAD WORK 500 FT	END ROAD WORK	ROAD WORK 500 FT	ROAD WORK NEXT 2 MILES	PCMS
<b>BURLINGTON (CONT'D)</b>							
ADSIT COURT	1			1			
BROOKES AVE.	1			1			
LOOMIS STREET	2			2			
HENRY STREET	1			1			
NORTH STREET	2			2			
CHARLES STREET	1			1			
POMEROY STREET	2			2			
ARCHIBALD STREET	2			2			
HYDE STREET	1			1			
RIVERSIDE AVE.	2	4	4	2			2
TOTAL	52	4	4	51	2	1	3

**LEGEND**

- RWA = ROAD WORK AHEAD
- RW500 = ROAD WORK 500 FT
- SRWA = SIDE ROAD WORK AHEAD
- SRW500 = SIDE ROAD WORK 500 FT
- ERW = END ROAD WORK
- RWN = ROAD WORK NEXT 2 MILES
- PCMS = PORTABLE CHANGABLE MESSAGE SIGN

**NOTES:**

1. THE CONTRACTOR SHALL SUBMIT A TRAFFIC CONTROL PLAN FOR APPROVAL PRIOR TO THE START OF CONSTRUCTION. THE COST OF PREPARING THIS PLAN (AND MAKING CHANGES IF NECESSARY) SHALL NOT BE PAID SEPARATELY BUT SHALL BE INCIDENTAL TO ITEM 641.10, "TRAFFIC CONTROL".

2. THE CONTRACTOR SHALL INCLUDE A CONSTRUCTION SIGN APPROACH PACKAGE FOR EXPECTED LANE CLOSURES AND WORK ZONE SPEED REDUCTIONS IN COMPLIANCE WITH THE TRAFFIC CONTROL DETAILS AND NOTES SHEET (SHEETS 66-69) AND PART 6 OF THE MUTCD. PAYMENT FOR PROVIDING THIS PACKAGE SHALL BE INCIDENTAL TO ITEM 641.10, "TRAFFIC CONTROL".

3. THE BID PRICE FOR ITEM 641.10 "TRAFFIC CONTROL", SHALL INCLUDE ALL OF THE FOLLOWING, AS NEEDED: APPROACH AND ON-PROJECT CONSTRUCTION SIGNING, PORTABLE ARROW BOARDS, BARRIERS, BARRELS, CONES, BARRICADES, TRUCK-MOUNTED ATTENUATOR(S), TEMPORARY REGULATORY AND WARNING SIGNS, AND POSTS AS DETAILED IN VTRANS STANDARDS. ALL ADJUSTING, RELOCATING, AND REMOVING OF THESE DEVICES AS DIRECTED BY THE RESIDENT ENGINEER SHALL ALSO BE INCLUDED. THE FOLLOWING ITEMS WILL BE PAID FOR SEPARATELY:  
646.602, 646.612, 646.622, 646.642, 646.652, 646.682, 646.692, AND  
646.702 - TEMPORARY PAVEMENT MARKINGS  
630.10 AND 630.15 - UNIFORMED TRAFFIC OFFICERS AND FLAGGERS

4. THREE (3) PORTABLE CHANGEABLE MESSAGE SIGNS (PCMS) WILL BE PROVIDED FOR USE ON THIS PROJECT. THE PLACEMENT OF THESE UNITS AS WELL AS THE MESSAGE WILL BE APPROVED BY THE RESIDENT ENGINEER. THESE SIGNS WILL BE PAID FOR UNDER ITEM 641.15, "PORTABLE CHANGEABLE MESSAGE SIGN".

PCMS SHOULD NOT REPLACE ANY OF THE SIGNING DETAILED IN THE MUTCD AND SHOULD NOT BE USED IF STANDARD TRAFFIC CONTROL DEVICES ADEQUATELY PROVIDE THE INFORMATION THE MOTORISTS NEED TO TRAVEL SAFELY.

THE PCMS SHALL CONSIST OF EITHER ONE OR TWO PHASES. TYPICALLY, A PHASE SHALL CONSIST OF UP TO THREE LINES OF EIGHT CHARACTERS PER LINE. THE PCMS SHOULD BE USED AS A SUPPLEMENT AND NOT AS A SUBSTITUTE FOR CONVENTIONAL SIGNS AND PAVEMENT MARKINGS.

THE PCMS SHOULD COMMUNICATE WHAT INFORMATION MOTORISTS NEED TO KNOW. UNNECESSARY INFORMATION SHOULD BE AVOIDED. MESSAGES SHOULD BE UPDATED PERIODICALLY TO DESCRIBE THE WORK ACTIVITY OCCURRING SO THAT THE PCMS CONTINUES TO COMMAND THE ATTENTION OF MOTORISTS.

5. THE MUTCD 2009 SHALL BE THE STANDARD FOR ALL TRAFFIC CONTROL DEVICES. EXISTING SIGNS, SIGNALS AND MARKINGS SHALL BE VALID UNTIL SUCH TIME AS THEY ARE REPLACED OR RECONSTRUCTED. WHEN NEW TRAFFIC CONTROL DEVICES ARE ERECTED OR PLACED OR EXISTING TRAFFIC CONTROL DEVICES ARE REPLACED OR REPAIRED THE EQUIPMENT, DESIGN, METHOD OF INSTALLATION, PLACEMENT OR REPAIR SHALL CONFORM WITH THE MUTCD.

6. NO CONSTRUCTION SIGNS SHALL BE INSTALLED AS TO INTERFERE OR OBSTRUCT THE VIEW OF EXISTING TRAFFIC CONTROL DEVICES, STOPPING SIGHT DISTANCE, AND CORNER SIGHT DISTANCE FROM DRIVES AND TOWN HIGHWAYS.

7. SEE THE TRAFFIC CONTROL DETAILS SHEETS FOR ADDITIONAL INFORMATION REGARDING IMPLEMENTATION OF THE TEMPORARY TRAFFIC CONTROL DEVICES.

**CONSTRUCTION APPROACH SIGNING SHEET**

PROJECT NAME: BURLINGTON (CLASS 1)	PLOT DATE: 18-APR-2014 13:53
PROJECT NUMBER: STP 2721(1)	DRAWN BY: BMB
FILE NAME: 07d206.dgn	CHECKED BY: EPD
PROJECT LEADER: CDL	SHEET 70 OF 70
DESIGNED BY: BMB	
PLOT FILE: 07d206_70.i	