

604.42 CHANGING ELEVATION OF SEWER MANHOLES
 STA. 53+88, RT
 STA. 55+94, RT

621.20 STEEL BEAM GUARDRAIL, GALVANIZED
 STA. 51+95 TO 52+20, RT
 90 17

646.20 4 INCH WHITE LINE
 STA. 51+50 TO 57+50, SOLID LT & RT
 (INCLUDE EDGE LINE BREAKS FOR TOWN HIGHWAYS)

646.602 TEMPORARY 4 INCH WHITE LINE, PAINT
 STA. 51+50 TO 57+50, SOLID LT & RT
 (INCLUDE EDGE LINE BREAKS FOR TOWN HIGHWAYS)

629.20 ADJUST ELEVATION OF VALVE BOX
 STA. 56+31, RT
 STA. 57+08, RT

621.60 ANCHOR FOR STEEL BEAM RAIL
 STA. 52+20, RT
 17

646.21 4 INCH YELLOW LINE
 STA. 51+50 TO 57+50, SOLID LT & RT

646.612 TEMPORARY 4 INCH YELLOW LINE, PAINT
 STA. 51+50 TO 57+50, SOLID LT & RT

621.80 REMOVAL AND DISPOSAL OF GUARDRAIL
 STA. 51+95 TO 52+20, RT
 90 15

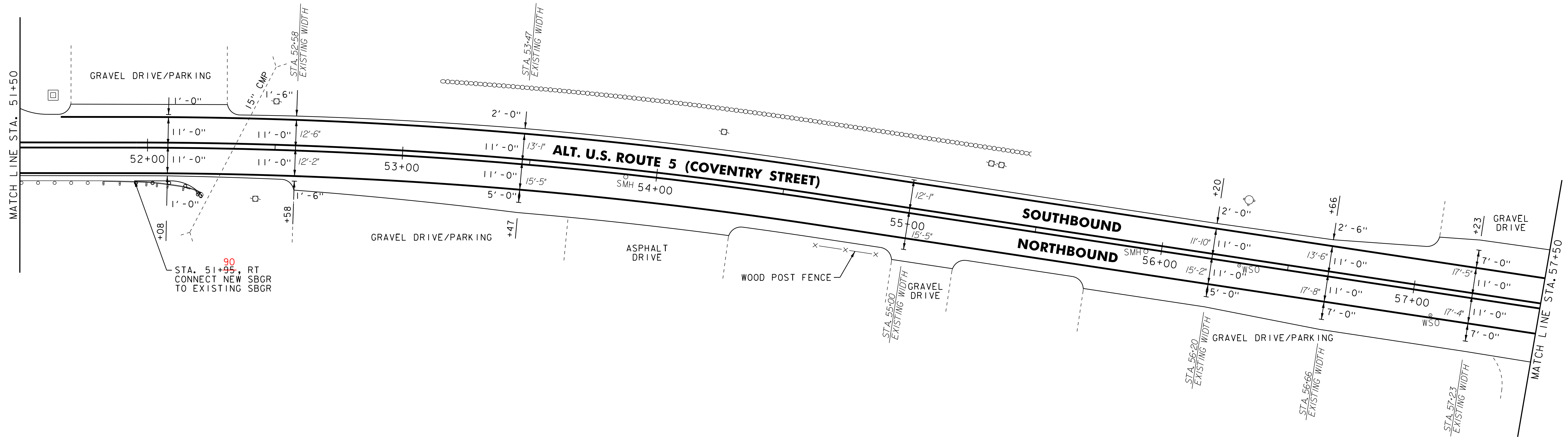

90
 STA. 51+95, RT
 CONNECT NEW SBGR
 TO EXISTING SBGR

- NOTES:
1. ALL EXISTING SIGNS NOT SHOWN SHALL BE RETAINED.
 2. FOR LEGEND, SEE LAYOUT SHEET #1

NOT TO SCALE

**PROJECT
 LAYOUT
 SHEET #6**

PROJECT NAME: NEWPORT CITY
 PROJECT NUMBER: STP 2719(I)

FILE NAME: 07D202.dgn
 PROJECT LEADER: JLL
 DESIGNED BY: STANTEC
 IPARM FILE: 07D202_17.i

PLOT DATE: 29-JAN-2013 09:2
 DRAWN BY: STANTEC
 CHECKED BY: JLL
 SHEET 17 OF 62