

INDEX OF SHEETS

SEE SHEET 2 OF 62

STATE OF VERMONT
AGENCY OF TRANSPORTATION

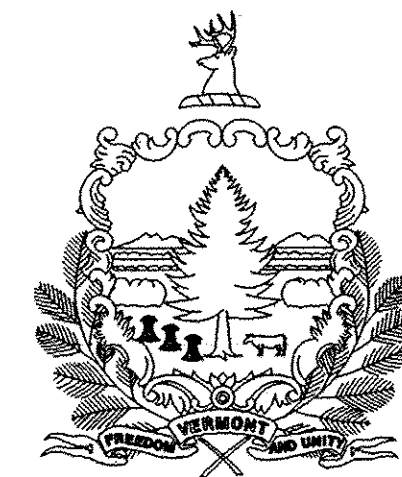

PROPOSED IMPROVEMENT
CITY OF NEWPORT AND VILLAGE OF DERBY
COUNTY OF ORLEANS

**NEWPORT CITY
STP 2719(1)
ALT U.S. ROUTE 5**

SEE SHEET 6 OF 62

**DERBY
STP 2703(1)
U.S. ROUTE 5 &
ALT U.S. ROUTE 5**

SEE SHEET 25 OF 62

**PROJECT LOCATION
STP 2719(1)
STP 2703(1)**

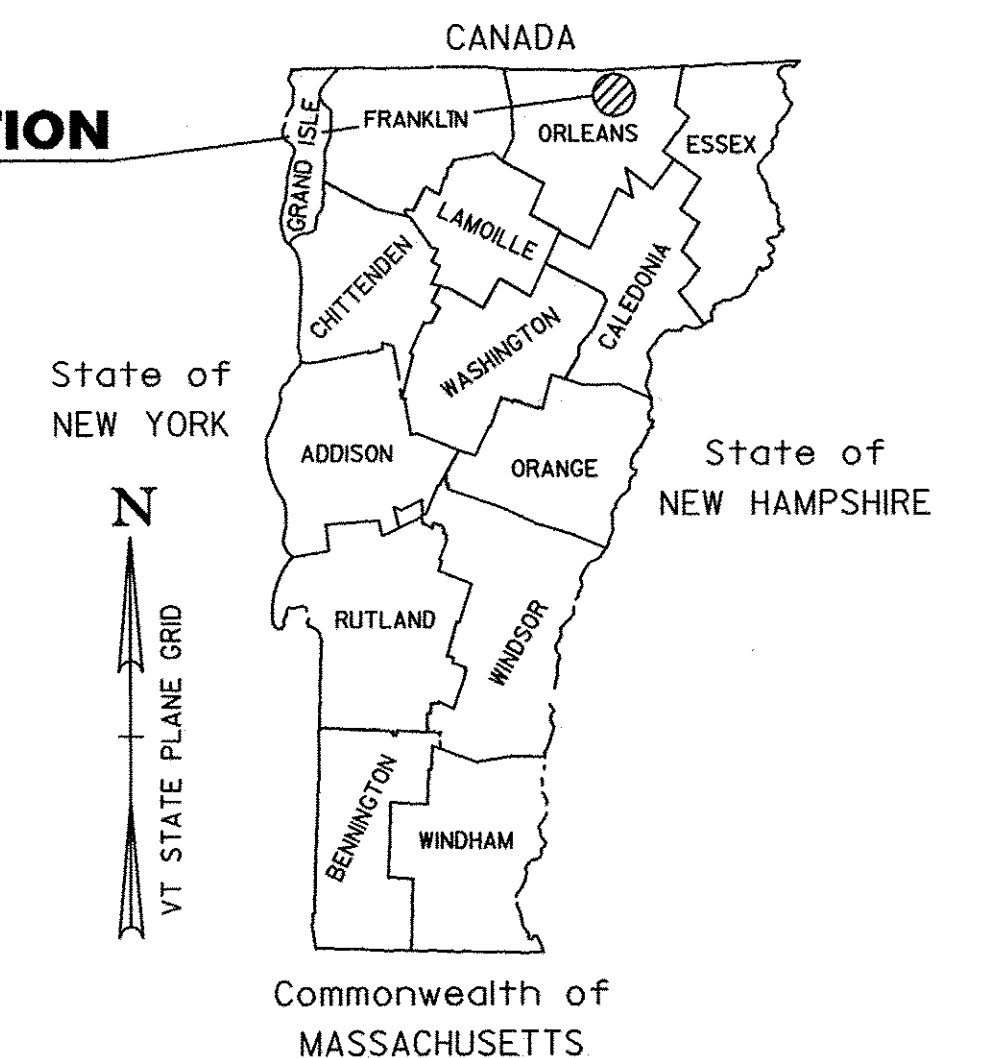

RECORD PLANS

CONTRACTOR: PIKE INDUSTRIES, INC. - BERLIN, VT

RESIDENT ENGINEER: SETH HISMAN

CONSTRUCTION BEGAN: AUGUST 2, 2010

CONSTRUCTION COMPLETE: JUNE 22, 2011

RECORD PLANS BY: SETH HISMAN & JENNA HYDE

I HEREBY CERTIFY THAT ALL THE CONSTRUCTION REQUIRED BY THIS SET OF DRAWINGS HAS BEEN ACCOMPLISHED AS INDICATED HEREIN.

BY: *Seth Hisman* RESIDENT ENGINEER

DATE: 1/16/13

NOTE: Any further information concerning final quantities, amounts or other details relative to this project may be found at Central Files in the electronic archives.

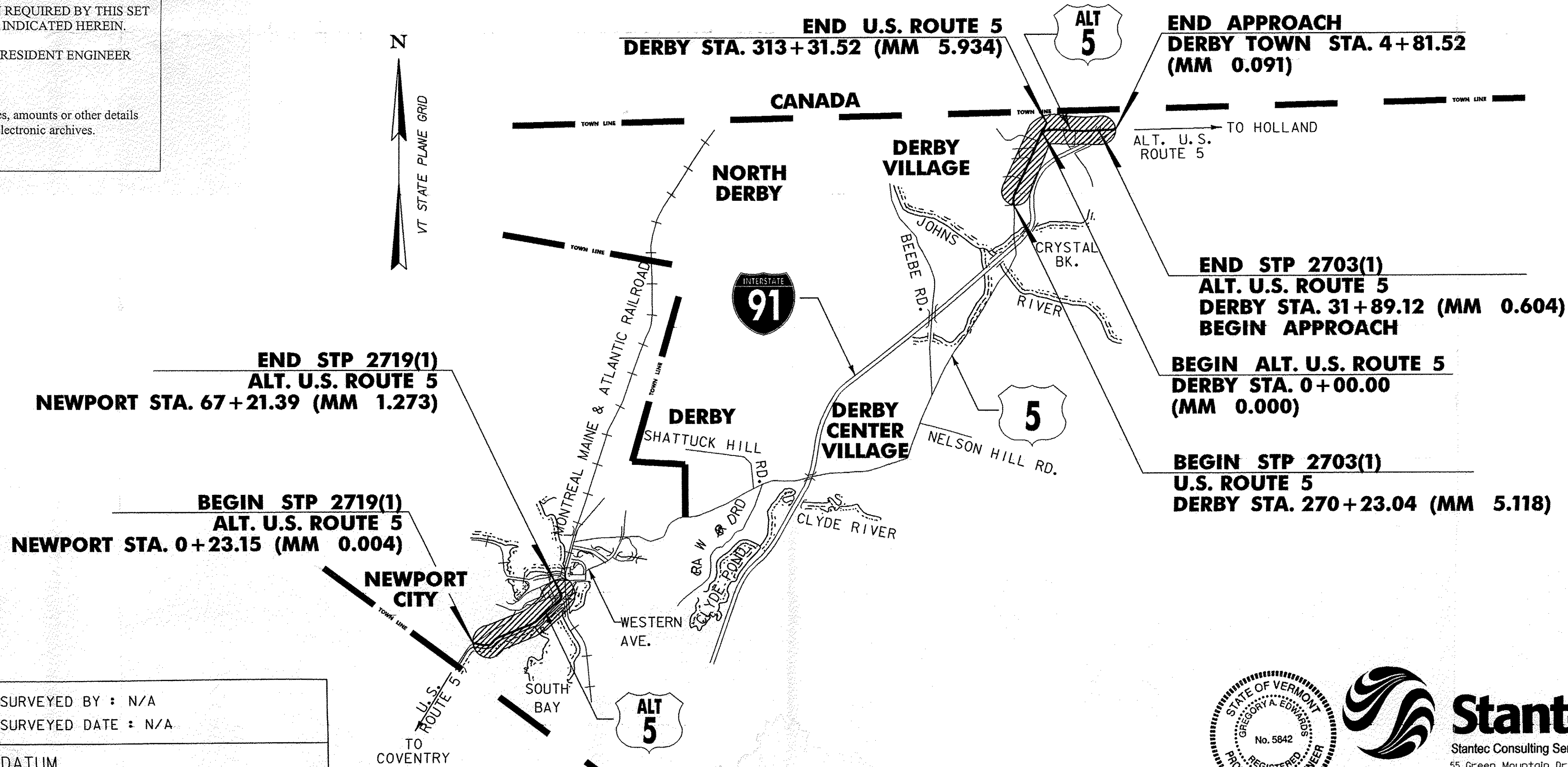

CONVENTIONAL SYMBOLS

COUNTY LINE	
TOWN LINE	
LIMITS OF ACCESS	
POINT OF ACCESS	
FENCE LINE	
STONE WALL	
TRAVELED WAY	
GUARD RAIL	
RAILROAD	
SURVEY LINE	
CULVERT	
POWER POLE	
TELEPHONE POLE	
TREES	
CONTROL OF ACCESS	
PROPERTY LINE	
R.O.W. TAKING LINE	
SLOPE RIGHTS	
TOP OF CUT	
TOE OF SLOPE	

SURVEYED BY : N/A
 SURVEYED DATE : N/A
 DATUM
 VERTICAL N/A
 HORIZONTAL N/A

NOTES:
 RIGHT-OF-WAY LIMITS, IF APPLICABLE, ARE PROVIDED SOLELY FOR THE CONVENIENCE OF THE STATE AND ITS CONTRACTOR DURING THE COURSE OF THIS PAVING PROJECT. ANY REFERENCES TO OFFSETS ON THESE PLANS ARE APPROXIMATE AND SHOULD NOT BE RELIED UPON FOR ANY PURPOSES.

THESE PLANS ARE SUBJECT TO SUCH ENGINEERING CHANGES AS MAY BE REQUIRED BY THE FEDERAL HIGHWAY ADMINISTRATION OR THE DIRECTOR OF PROGRAM DEVELOPMENT.

CONSTRUCTION IS TO BE CARRIED ON IN ACCORDANCE WITH THESE PLANS AND THE STANDARD SPECIFICATIONS FOR CONSTRUCTION DATED 2006, AS APPROVED BY THE FEDERAL HIGHWAY ADMINISTRATION ON JUNE 15, 2006 FOR USE ON THIS PROJECT, INCLUDING ALL SUBSEQUENT REVISIONS AND SUCH REVISED SPECIFICATIONS AND SPECIAL PROVISIONS AS ARE INCORPORATED IN THESE PLANS.

UNLESS OTHERWISE NOTED, ALL DRAWINGS AND DETAILS ON THESE PLANS ARE DRAWN "NOT TO SCALE".



Stantec
 Stantec Consulting Services Inc.
 55 Green Mountain Drive
 South Burlington VT U.S.A. 05403
 Tel. 802.864.0223
 Fax. 802.864.0165 p07d202.dgn
 www.stantec.com p07d202+s.1

DIRECTOR OF PROGRAM DEVELOPMENT	APPROVED: <i>Kevin Marsha</i> DATE 2/22/10
PROJECT MANAGER : KEVIN MARSHIA	
PROJECT NAME : NEWPORT CITY / DERBY	
PROJECT NUMBER : STP 2719(1) / STP 2703(1)	
SHEET 1 OF 62 SHEETS	