

604.412, 604.415, 604.418 REHAB, DROP INLETS, CATCH BASINS, OR MANHOLES, CLASS I, CLASS II OR CLASS III
 STA. 95+77 LT "TYPE D GRATE"
 STA. 97+63 RT "TYPE D GRATE"
 STA. 98+39 RT "TYPE D GRATE"
 STA. 100+23 LT "TYPE D GRATE"

604.40 CHANGING ELEVATION OF DROP INLETS, CATCH BASINS, AND MANHOLES
 STA. 98+75 LT (EMH)

604.42 CHANGING ELEVATION OF SEWER MANHOLES
 STA. 97+61 LT
 STA. 100+24 LT

629.20 ADJUST ELEVATION OF VALVE BOX
 STA. 96+99 LT (WSV) STA. 97+86 LT (WSV)
 STA. 97+09 LT (WSV) STA. 97+95 LT (WSV)
 STA. 97+12 LT (WSV) STA. 98+15 RT (WSV)
 STA. 98+88 LT (WSV)

203.16 SOLID ROCK EXCAVATION
 STA. 96+85 - STA. 96+91 LT
 STA. 96+92 - STA. 96+95 LT
 STA. 97+49 - STA. 97+72 RT
 STA. 97+52 - STA. 97+76 LT
 STA. 98+16 - STA. 98+28 RT

618.10 PORTLAND CEMENT CONCRETE SIDEWALK, 5 INCH
 STA. 96+85 - STA. 96+91 LT
 STA. 96+92 - STA. 96+95 LT
 STA. 97+49 - STA. 97+72 RT
 STA. 97+52 - STA. 97+76 LT
 STA. 98+16 - STA. 98+28 RT

618.30 DETECTABLE WARNING SURFACE
 STA. 96+88 LT STA. 97+65 RT
 STA. 96+93 LT STA. 97+69 LT
 STA. 97+55 RT STA. 98+18 RT
 STA. 97+58 LT STA. 98+20 RT

616.28 CAST-IN-PLACE CONCRETE CURB, TYPE B
 STA. 96+87 - STA. 96+91 LT
 STA. 96+95 - STA. 96+96 LT
 STA. 98+16 - STA. 98+21 RT

616.41 REMOVAL OF EXISTING CURB
 STA. 96+87 - STA. 96+91 LT
 STA. 96+95 - STA. 96+96 LT
 STA. 98+16 - STA. 98+21 RT

646.486 DURABLE 24" STOP BAR, RECESSED POLYUREA
 STA. 97+08 RT
 STA. 98+08 - STA. 98+18 RT
 STA. 98+09 LT

646.682 TEMPORARY 24" STOP BAR, PAINT
 STA. 97+08 RT
 STA. 98+08 - STA. 98+18 RT
 STA. 98+09 LT

646.416 DURABLE 4" YELLOW LINE, RECESSED POLYUREA
 STA. 94+50 - STA. 97+08 SOLID LT & RT
 STA. 98+08 RT (CENTERLINE ARCHIBALD ST.)
 STA. 98+09 - STA. 100+50 SOLID LT & RT

646.612 TEMPORARY 4" YELLOW LINE, PAINT
 STA. 94+50 - STA. 97+08 SOLID LT & RT
 STA. 98+08 RT (CENTERLINE ARCHIBALD ST.)
 STA. 98+09 - STA. 100+50 SOLID LT & RT

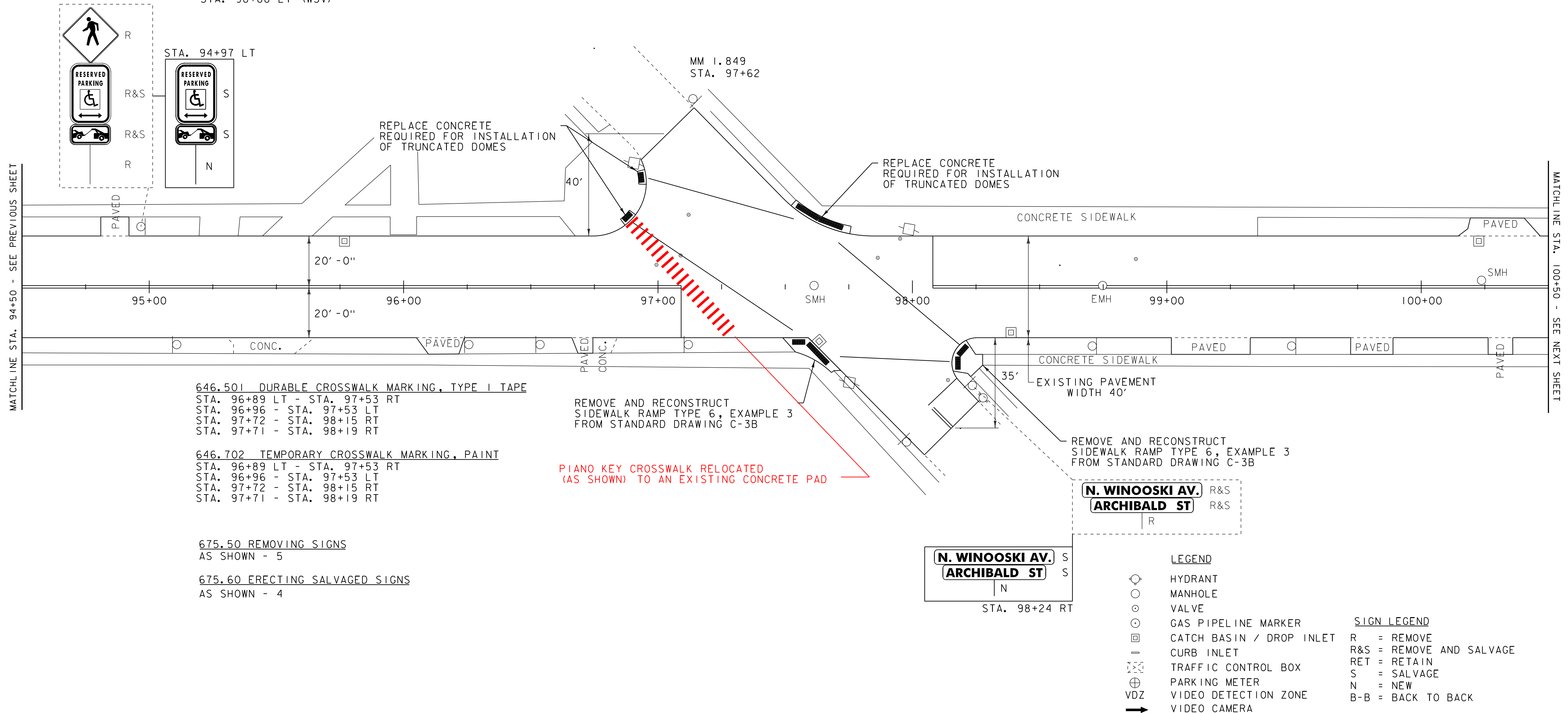

MATCHLINE STA. 94+50 - SEE PREVIOUS SHEET

MATCHLINE STA. 100+50 - SEE NEXT SHEET

PROJECT LAYOUT SHEET 17

NOT TO SCALE

PROJECT NAME:	BURLINGTON (CLASS I)
PROJECT NUMBER:	STP 2722 (I)
FILE NAME:	07d028.dgn
PROJECT LEADER:	EPD
DESIGNED BY:	CDL
PLOT FILE:	07d028_31.i
PLOT DATE:	05-JUN-2014 11:21
DRAWN BY:	SJL
CHECKED BY:	EPD
SHEET	31 OF 61