

**BR 27 BRIGHTON MM 5.718 = STA 301+91.04**

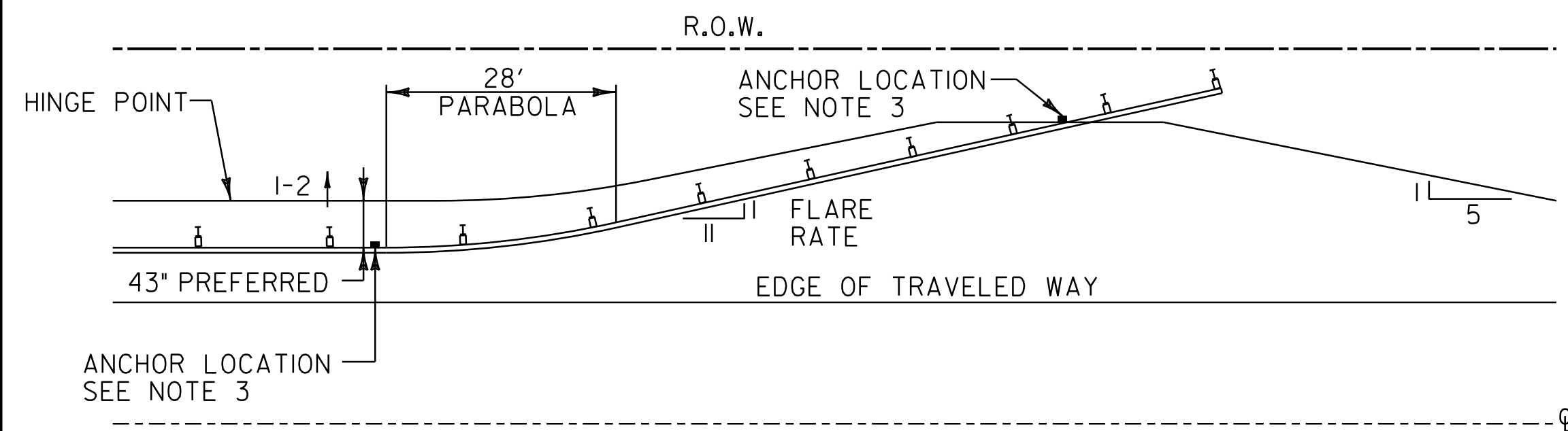

**DETAIL FOR BURIED STEEL BEAM GUARDRAIL ENDS IN BACKSLOPES WITH RUB RAIL**

- NOTES:
1. HEIGHT OF PRIMARY RAIL SHALL REMAIN AT A CONSTANT HEIGHT RELATIVE TO ROADWAY GRADE TO POINT OF DITCH BOTTOM.
  2. ADDITION OF RUB RAIL IS REQUIRED WHEN OPENING BENEATH PRIMARY RAIL EXCEEDS 18". RUB RAIL EXTENDS FROM THE EDGE OF SHOULDER TO THE BACK SLOPE.
  3. GUARDRAIL ANCHORS SHALL BE INSTALLED AS SHOWN IN THE PLANS OR AS DIRECTED BY THE RESIDENT ENGINEER.
  4. LOCATION OF EXISTING ANCHOR BOLTS TO BE VERIFIED IN THE FIELD BY THE CONTRACTOR PRIOR TO ORDERING BRIDGE POSTS.
  5. POSTS SHALL BE SHOP CUT AND DRILLED PRIOR TO GALVANIZING.
  6. SEE STANDARD SHEET SB-R6-82 FOR ADDITIONAL DETAILS.

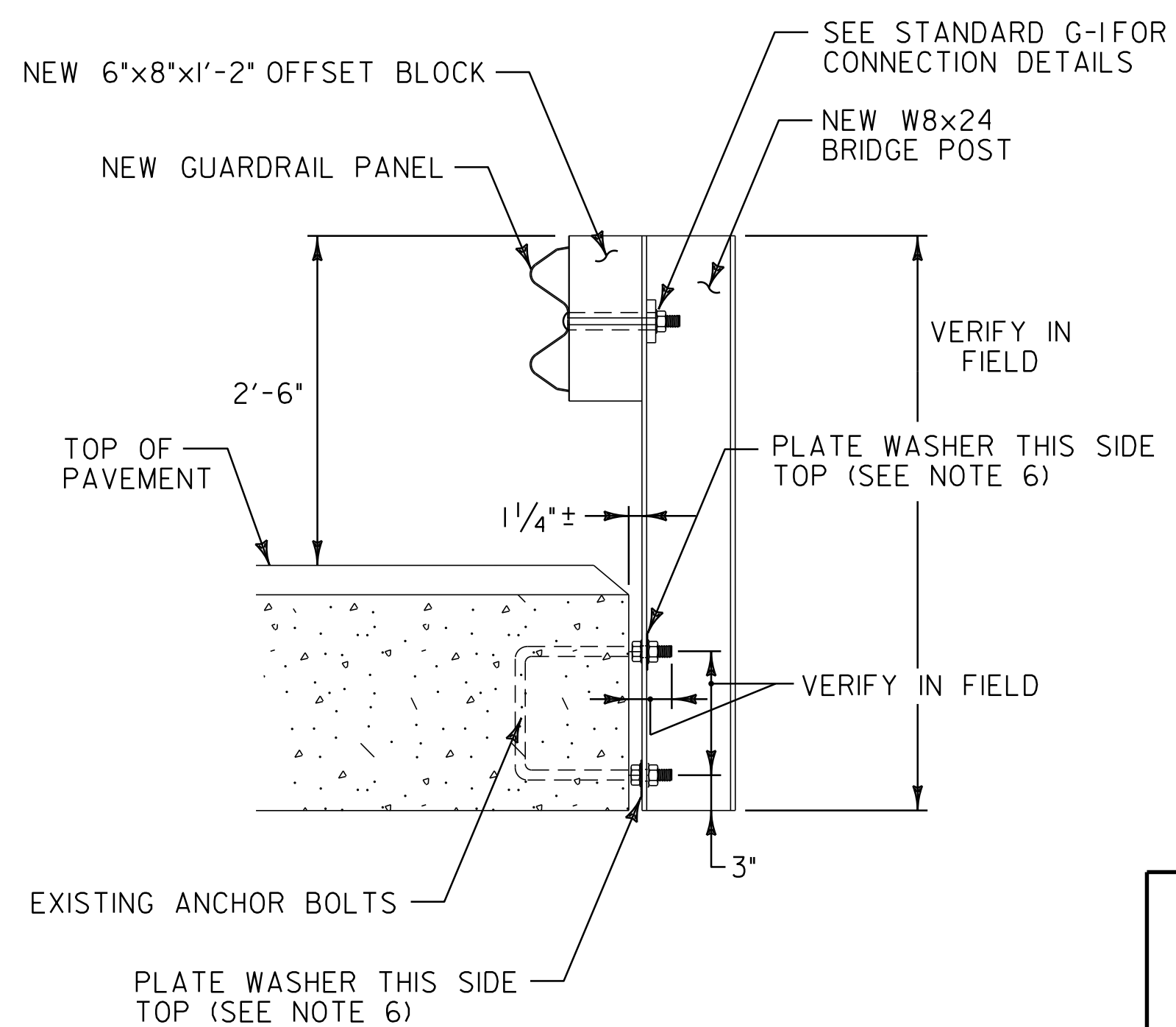

**BR 27 BRIDGE RAILING DETAIL**

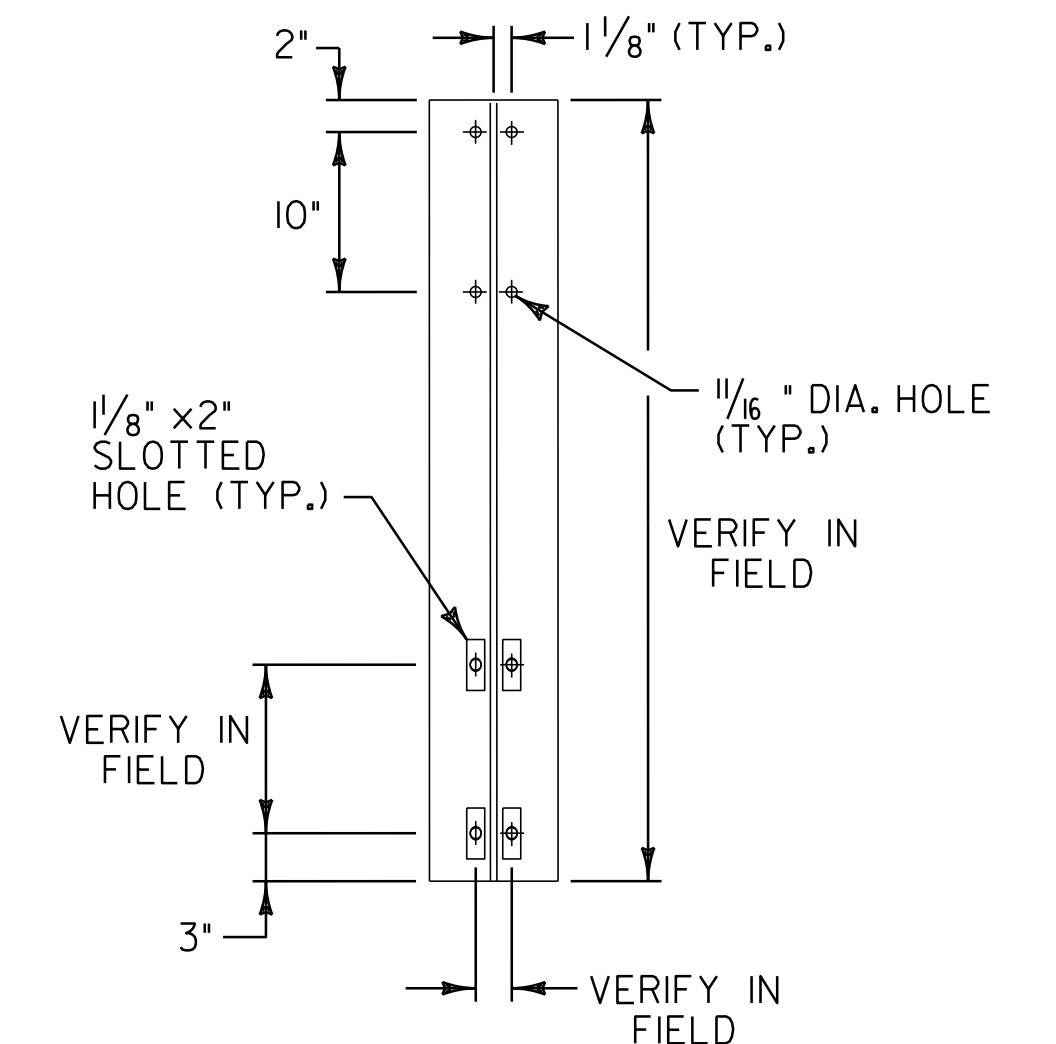

**POST DETAIL**

<b>BRIDGE DETAIL SHEET #2</b>	<b>NOT TO SCALE</b>	
	PROJECT NAME: BRIGHTON - WARREN GORE	
	PROJECT NUMBER: STP 2724(0)S	
	FILE NAME: p07c216.dgn	PLOT DATE: 31-OCT-2011 11:53
PROJECT LEADER: D.E.G.	DRAWN BY: C.A.K.	
DESIGNED BY: M.J.L.	CHECKED BY: D.W.E.	
IPARM FILE: p07c216bd2.i	SHEET 70 OF 107	