

604.412, 604.415 OR 604.418 REHAB.  
DIS, CBS OR MHS, CLASS I, II OR III  
STA. 57+22, RT  
STA. 58+58, RT  
STA. 60+29, RT

604.42 CHANGING ELEVATION OF SEWER MANHOLES  
STA. 55+15, LT  
STA. 57+15, LT  
STA. 58+39, LT

618.10 PORTLAND CEMENT CONCRETE SIDEWALK, 5 INCH  
STA. 58+57, RT

618.30 DETECTABLE WARNING SURFACE  
STA. 58+57, RT

629.20 ADJUST ELEVATION OF VALVE BOX  
STA. 58+50, RT

646.402 DURABLE 4 INCH WHITE LINE, THERMOPLASTIC  
(ALL LINES WILL INCLUDE EDGE LINE AND LANE LINE  
BREAKS AND RADII FOR SIDE ROADS)  
STA. 54+50 TO 60+50, SOLID LT & RT  
STA. 58+29, DOUBLE SOLID RT (MAIN ST.)

646.412 DURABLE 4 INCH YELLOW LINE, THERMOPLASTIC  
(ALL LINES WILL INCLUDE C BREAKS FOR SIDE ROADS)  
STA. 54+50 TO 60+50, SOLID LT & RT  
STA. 58+29, DOUBLE SOLID RT (MAIN ST.)

646.482 DURABLE 24 INCH STOP BAR, THERMOPLASTIC  
STA. 58+31, RT (MAIN ST.)

646.492 DURABLE LETTER OR SYMBOL, THERMOPLASTIC  
STA. 58+41, RT - "STOP"

646.502 DURABLE CROSSWALK MARKING, THERMOPLASTIC  
STA. 57+88 TO 58+62, RT  
STA. 58+57, LT & RT

646.602 TEMPORARY 4 INCH WHITE LINE, PAINT  
(ALL LINES WILL INCLUDE EDGE LINE AND LANE LINE  
BREAKS AND RADII FOR SIDE ROADS)  
STA. 54+50 TO 60+50, SOLID LT & RT  
STA. 58+29, DOUBLE SOLID RT (MAIN ST.)

646.612 TEMPORARY 4 INCH YELLOW LINE, PAINT  
(ALL LINES WILL INCLUDE C BREAKS FOR SIDE ROADS)  
STA. 54+50 TO 60+50, SOLID LT & RT  
STA. 58+29, DOUBLE SOLID RT (MAIN ST.)

646.682 TEMPORARY 24 INCH STOP BAR, PAINT  
STA. 58+31, RT (MAIN ST.)

646.692 TEMPORARY LETTER OR SYMBOL, PAINT  
STA. 58+41, RT - "STOP"

646.702 TEMPORARY CROSSWALK MARKING, PAINT  
STA. 57+88 TO 58+62, RT  
STA. 58+57, LT & RT

675.50 REMOVING SIGNS  
AS SHOWN - 1

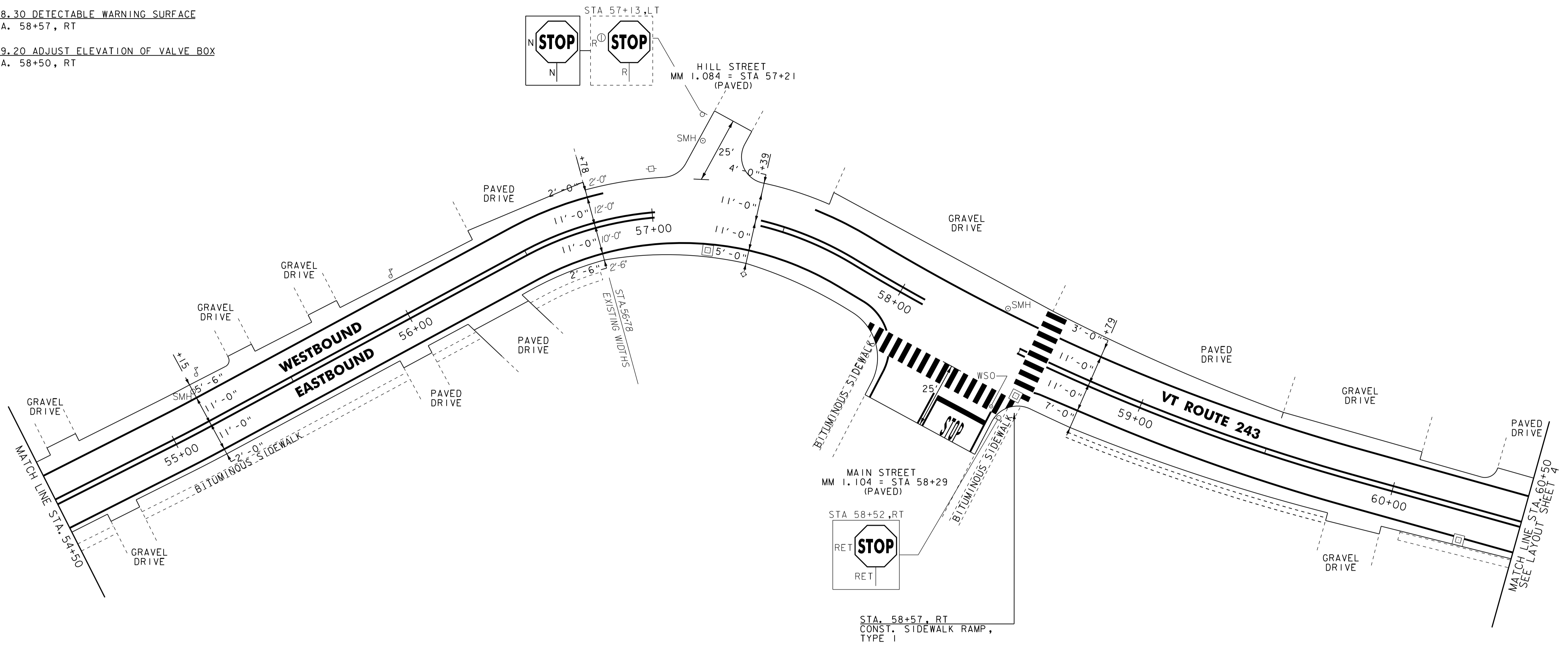

NOTES:  
1. ALL EXISTING SIGNS NOT SHOWN SHALL BE RETAINED.  
2. FOR LEGENDS, SEE LAYOUT SHEET #1.



NOT TO SCALE

**PROJECT  
LAYOUT  
SHEET #10**

PROJECT NAME: NORTH TROY	PLOT DATE: 25-OCT-2011 14:04
PROJECT NUMBER: STP 2620(1)	DRAWN BY: STANTEC
FILE NAME: p06b208.dgn	CHECKED BY: JLL
PROJECT LEADER: JLL	SHEET 94 OF 116
DESIGNED BY: MCF	
IPARM FILE: p06b208i10.i	