

604.42 CHANGING ELEVATION OF SEWER MANHOLES
 STA. 129+78, LT
 STA. 131+85, LT

629.20 ADJUST ELEVATION OF VALVE BOX
 STA. 129+75, LT

646.402 DURABLE 4 INCH WHITE LINE, THERMOPLASTIC
 STA. 129+52 TO 133+00, SOLID LT & RT
 (INCLUDING SMALL SECTION OF HIGHLAND AVE.)

646.412 DURABLE 4 INCH YELLOW LINE, THERMOPLASTIC
 STA. 129+52 TO 133+00, SOLID LT & RT
 (INCLUDING SMALL SECTION OF HIGHLAND AVE.)

646.482 DURABLE 24 INCH STOP BAR, THERMOPLASTIC
 STA. 129+91, LT

646.492 DURABLE LETTER OR SYMBOL, THERMOPLASTIC
 STA. 130+04, LT "STOP"

646.602 TEMPORARY 4 INCH WHITE LINE, PAINT
 STA. 129+52 TO 133+00, SOLID LT & RT
 (INCLUDING SMALL SECTION OF HIGHLAND AVE.)

646.612 TEMPORARY 4 INCH YELLOW LINE, PAINT
 STA. 129+52 TO 133+00, SOLID LT & RT
 (INCLUDING SMALL SECTION OF HIGHLAND AVE.)

646.682 TEMPORARY 24 INCH STOP BAR, PAINT
 STA. 129+91, LT

646.692 TEMPORARY LETTER OR SYMBOL, PAINT
 STA. 130+04, LT "STOP"

675.50 REMOVING SIGNS
 AS SHOWN - 7

BEGIN STP 2620(1)
VT ROUTE 105 NORTH TROY
STA. 129+51.84=MM 2.453
EQUALS END STP 2717(1)
STA. 129+25.44=MM 2.448

MATCH EXISTING
 PAVEMENT MARKINGS

1'-0" # 1'-0" # 1'-0" # 2'-0"

2'-0" # 1'-0" # 1'-0" # 2'-0"

* MATCH PAVEMENT MARKINGS
 PER PROJECT STP 2717 (1)

VT ROUTE 105 / HIGHLAND AVENUE
 128+00
 129+00

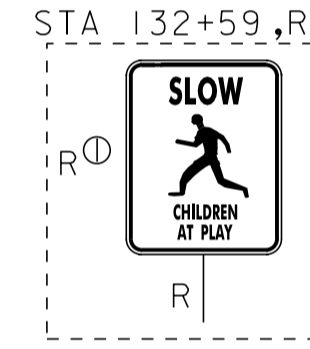
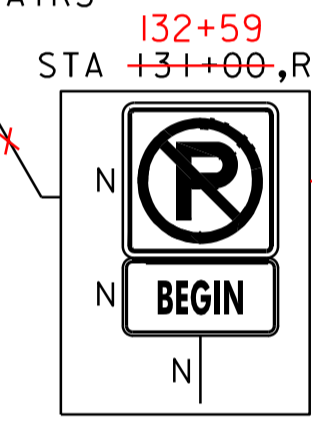
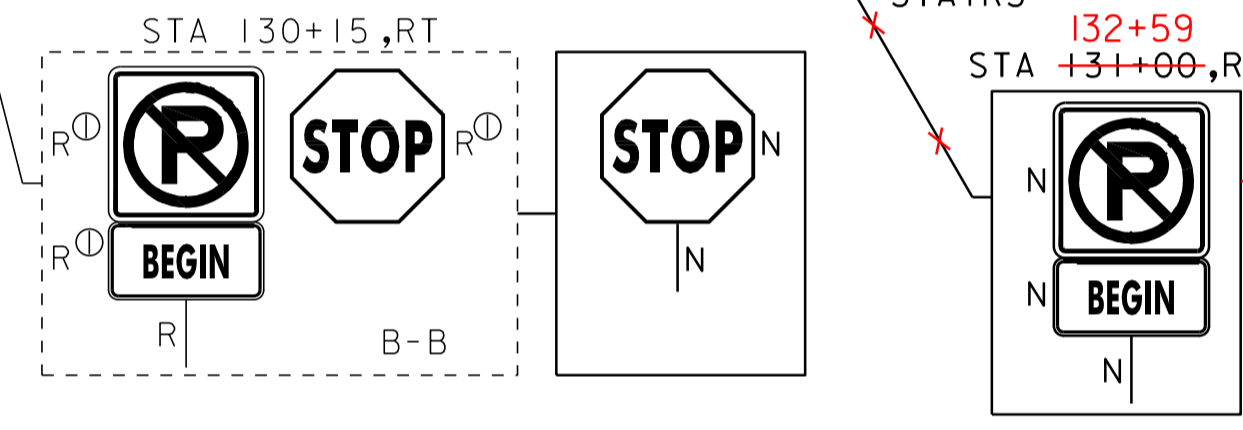
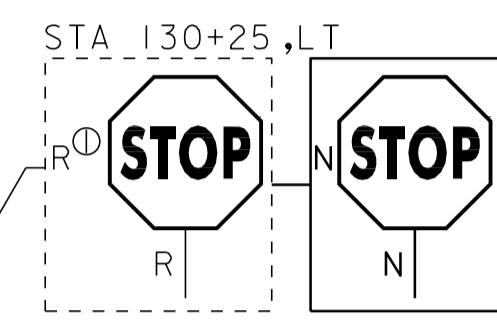
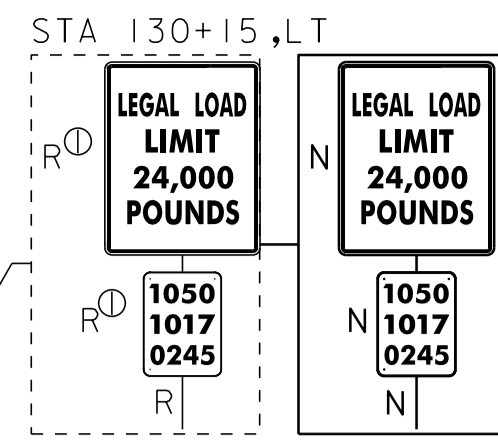

SIGN LEGEND	
N	= NEW
R	= REMOVE
R&S	= REMOVE & SALVAGE
S	= SALVAGE SIGN
RET	= RETAIN
B-B	= BACK TO BACK
R⊕	= REMOVE AND RETURN TO VILLAGE OF NORTH TROY

UTILITY LEGEND	
	= EXISTING HYDRANT
	= EXISTING DI
	= EXISTING MANHOLE
	= EXISTING TELEPHONE MANHOLE
	= EXISTING ELECTRIC MANHOLE
	= EXISTING SEWER MANHOLE
	= EXISTING WATER SHUTOFF
	= EXISTING GAS SHUTOFF
	= EXISTING MAILBOX
	= EXISTING POWER POLE
	= EXISTING TELEPHONE POLE
	= EXISTING UTILITY POLE
	= EXISTING SIGNAL HEAD
	= EXISTING PULL BOX
	= EXISTING VEHICLE DETECTOR LOOP
	= EXISTING GUARDRAIL
	= EXISTING RAILROAD

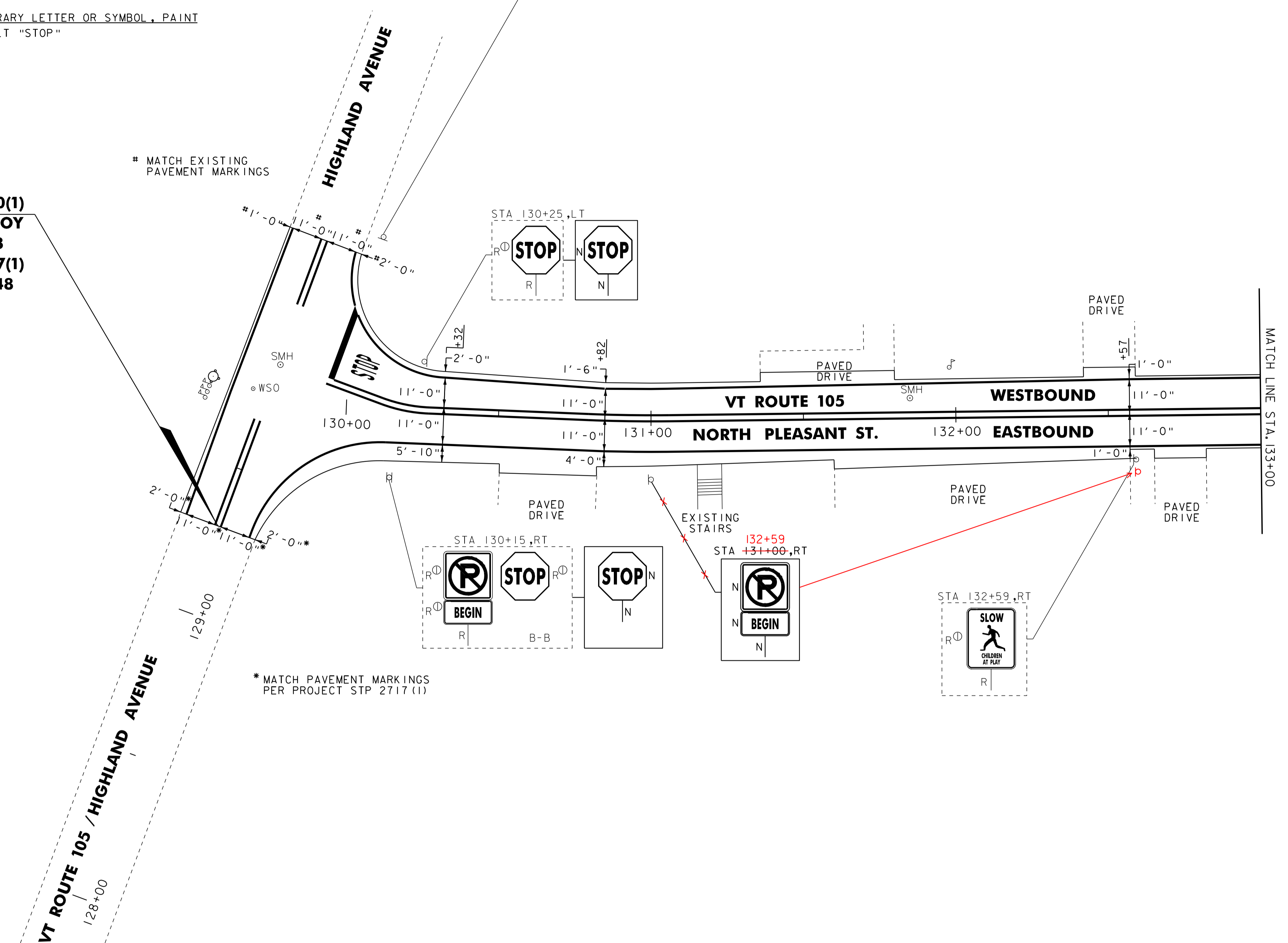

PROJECT LAYOUT SHEET #1	NOTE: ALL EXISTING SIGNS NOT SHOWN SHALL BE RETAINED.		
	PROJECT NAME:	NORTH TROY	
	PROJECT NUMBER:	STP 2620(1)	
	FILE NAME:	p06b208.dgn	
PROJECT LEADER:	JLL	PLOT DATE:	25-OCT-2011 4:03
DESIGNED BY:	MCF	DRAWN BY:	STANTEC
IPARM FILE:	p06b208101.i	CHECKED BY:	JLL
		SHEET	85 OF 116