

R2-1

LOCATION: VT ROUTE 58:
STA. 8+27, RT

COLOR: BLACK BORDER & TEXT
WHITE BACKGROUND (RETROREFLECTIVE)
MATERIAL: PER TRAFFIC SIGN TABLE

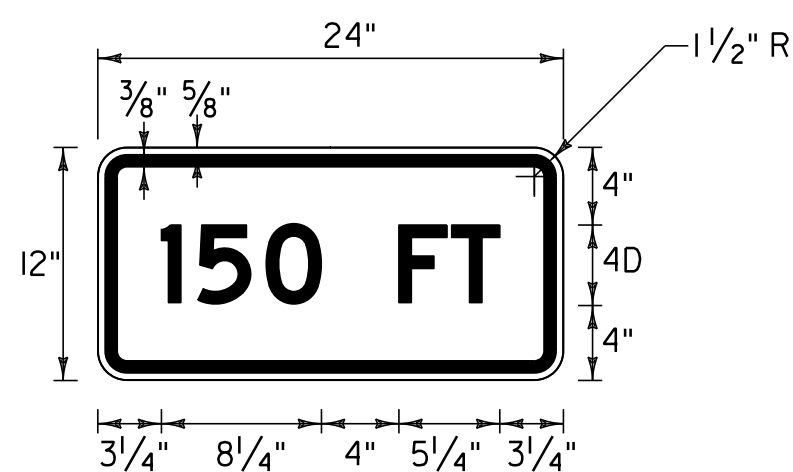

W16-2aP

LOCATION: VT ROUTE 58:
STA. 22+35, RT

COLOR: BLACK BORDER AND TEXT (RETROREFLECTIVE)
YELLOW BACKGROUND (RETROREFLECTIVE)
MATERIAL: PER THE TRAFFIC SIGN TABLE

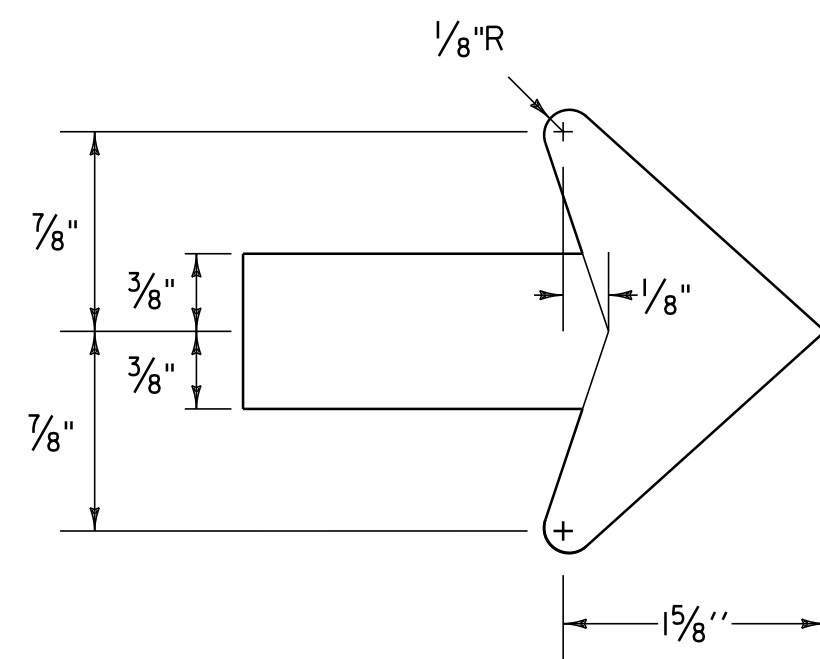

ARROW DETAIL FOR PARKING SIGNS

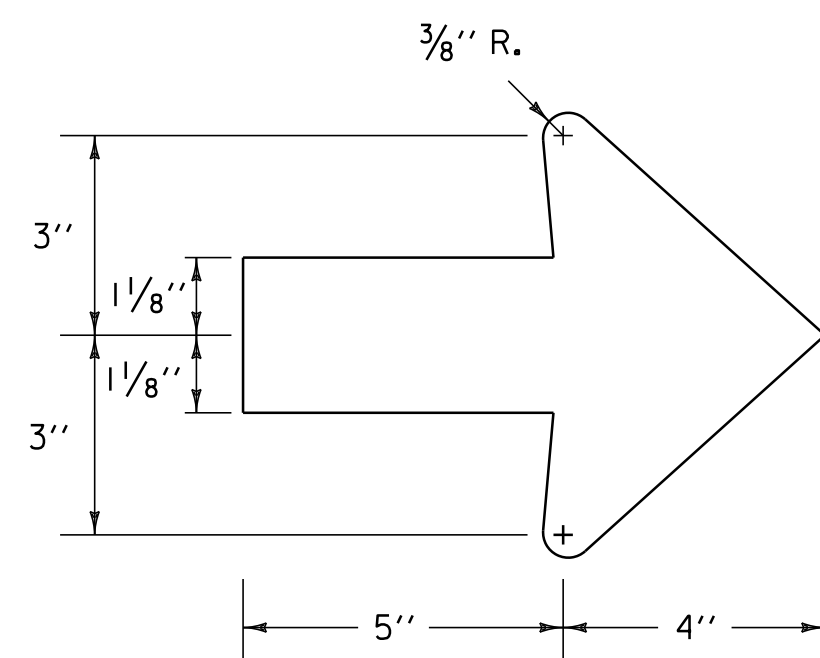

ARROW DETAIL FOR DESTINATION BOARDS



*SEE ARROW DETAIL FOR PARKING SIGNS ON THIS SHEET

LOCATION: VT ROUTE 58:
STA. 11+18, RT (LEFT ARROW)
STA. 12+87, RT (DOUBLE ARROW)
STA. 14+06, RT (DOUBLE ARROW)

COLOR: GREEN BORDER AND TEXT ON
WHITE BACKGROUND (RETROREFLECTIVE)

MATERIAL: PER THE TRAFFIC SIGN TABLE

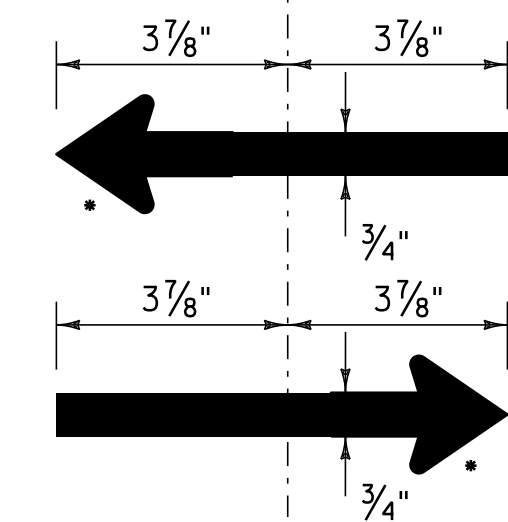

LOCATION: U.S. ROUTE 5
STA. 275+68, LT

COLOR: RED BORDER AND TEXT (RETROREFLECTIVE)
WHITE BACKGROUND (RETROREFLECTIVE)

MATERIAL: PER THE TRAFFIC SIGN TABLE



LOCATION: VT ROUTE 16:
STA. 123+03, LT

COLOR: GREEN BORDER AND TEXT
WHITE SYMBOL ON BLUE BACKGROUND
WHITE BACKGROUND (RETROREFLECTIVE)

MATERIAL: PER THE TRAFFIC SIGN TABLE

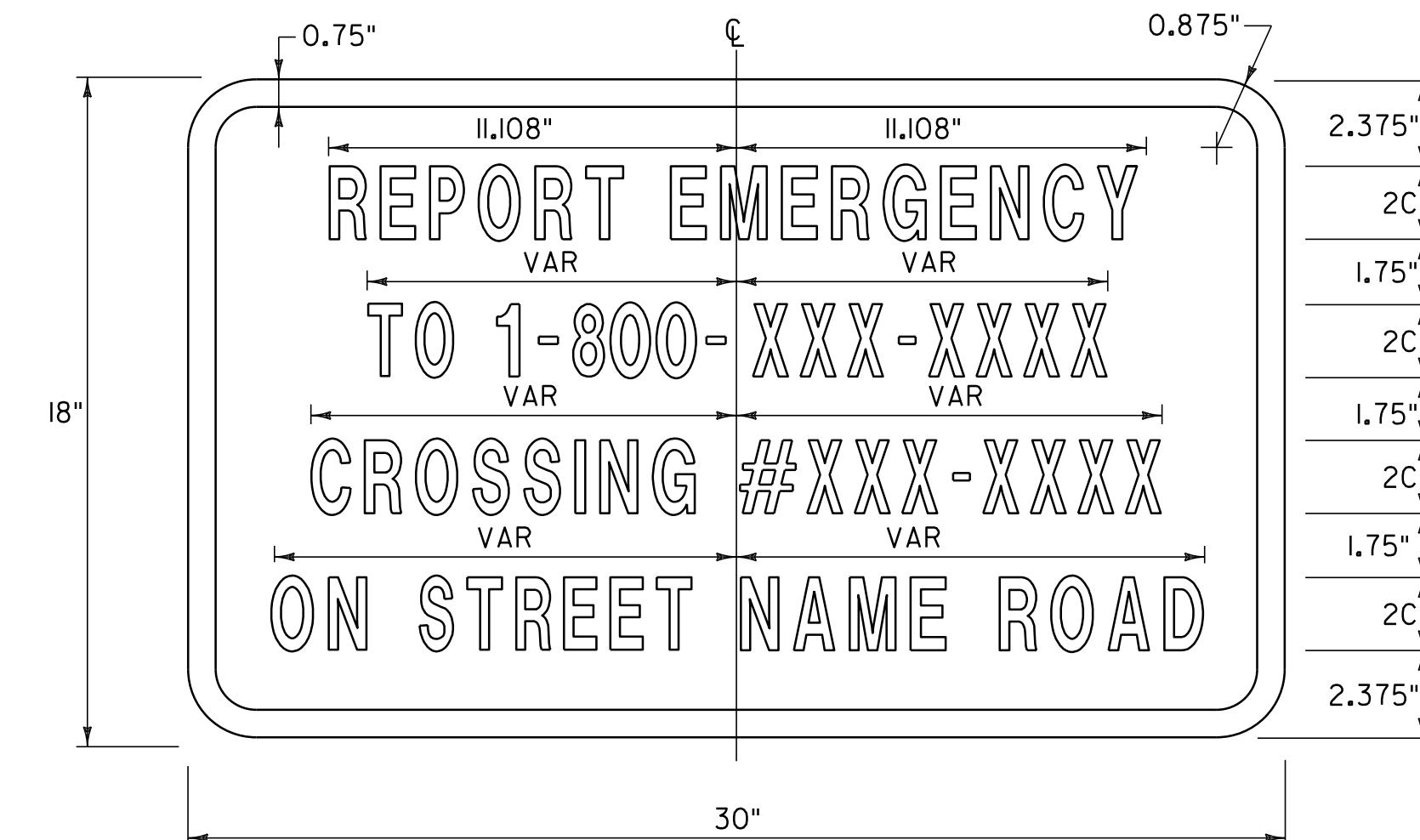
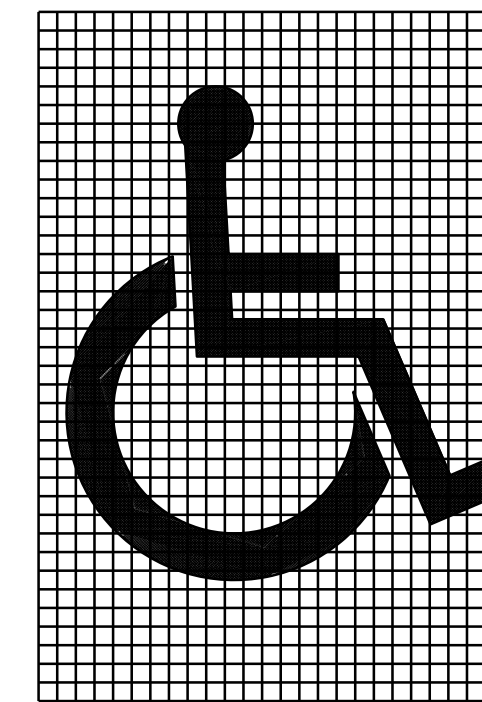

1-13a

LOCATION: VT ROUTE 58:
STA. 16+04, RT
STA. 17+53, LT
STA. 18+11, LT (2)

COLOR: WHITE BORDER AND TEXT (RETROREFLECTIVE)
BLUE BACKGROUND (RETROREFLECTIVE)
MATERIAL: PER THE TRAFFIC SIGN TABLE

TRAFFIC SIGN NOTES

- ALL SIGN LETTERING, DIGITS, ARROWS, AND DESIGN OF SYMBOLS FOR SIGNS REFERENCED IN THESE PLANS SHALL CONFORM WITH THE "STANDARD ALPHABET FOR HIGHWAY SIGNS AND PAVEMENT MARKINGS" AS ADOPTED BY THE U.S. DEPARTMENT OF TRANSPORTATION AND THE FEDERAL HIGHWAY ADMINISTRATION (FHWA) UNLESS OTHERWISE DETAILED WITHIN THESE PLANS.
- ALL COLORS SHALL CONFORM WITH THE STANDARD COLORS ADOPTED BY THE AMERICAN ASSOCIATION OF STATE HIGHWAY AND TRANSPORTATION OFFICIALS (AASHTO) AND APPROVED BY FHWA UNLESS OTHERWISE NOTED.
- UNLESS OTHERWISE DETAILED ON THE PLANS, ALL SIGN BASE MATERIALS SHALL BE FLAT SHEET ALUMINUM WITH THE FOLLOWING MINIMUM THICKNESSES:

SIZES	24" X 10"	36" X 12"	36" X 15"
	24" X 12"	42" X 12"	
	30" X 12"	48" X 12"	
	24" X 18"	36" X 18"	
	24" X 24"	54" X 12"	48" X 18"
	24" X 30"	36" X 24"	48" X 24"
	9" X 12"	30" X 15"	30" X 42"
	12" X 12"	30" X 18"	36" X 36"
	18" X 18"	30" X 30"	36" X 48"
	21" X 15"	30" X 42"	36" X 54"
THICKNESS	0.060"	0.080"	0.100"
			0.125"

RAILROAD CROSSING NUMBER SIGN NOTES:

- THE COLORS, LETTERING, DESIGN, AND SPECIFICATION SHALL CONFORM TO THE NOTES SHOWN ON VERMONT STANDARD E-132.
- THE EMERGENCY CONTACT TELEPHONE NUMBER IS 1-877-565-8133
- THE 1-13a SIGNS SHALL BE PLACED ON THE ROADWAY SIDE OF THE SIGNAL CABINET AS WELL AS ON THE EXISTING SIGNAL POLES AS SHOWN ON SHEETS 34 AND 35. THESE SIGNS ARE INCIDENTAL TO ITEM 900.645 SPECIAL PROVISION (RAIL - HIGHWAY CROSSING ACTIVE WARNING SYSTEM).
- THE CROSSING NUMBERS ARE #850-879H ON MAIN STREET, AND 850-878B ON NORTH AVE.

NOT TO SCALE

NOTES: 1. ALL SHEETING SHALL BE TYPE III MINIMUM PER 750.08

TRAFFIC SIGN DETAIL SHEET #4	PROJECT NAME: BARTON	
	PROJECT NUMBER: STP 2702(I)	
	FILE NAME: p07c192.dgn	PLOT DATE: 30-OCT-2013 17:0
	PROJECT LEADER: JLL	DRAWN BY: STANTEC
DESIGNED BY: STANTEC	CHECKED BY: STANTEC	
IPARM FILE: p07c192tsd04.i	SHEET 64 OF 75	

