

STEEL BEAM GUARDRAIL, GALVANIZED
STA. 414+08.0 TO 414+83.0, LT

ANCHOR FOR STEEL BEAM RAIL
STA. 414+08.0, LT
STA. 414+83.0, LT

REMOVAL AND DISPOSAL OF GUARDRAIL
STA. 414+08.0 TO 414+83.0, LT

TEMPORARY 4 INCH WHITE LINE, PAINT
DURABLE 4 INCH WHITE LINE (OPTION BID ITEM)
(ALL LINES WILL INCLUDE EDGE LINE BREAKS
AND RADIUS FOR SIDE ROADS)
STA. 413+50 TO 419+00, SOLID LT & RT
STA. 415+91, SOLID RT (EDGELINES, WAUGH FARM ROAD, TH-17)

TEMPORARY 4 INCH YELLOW LINE, PAINT
DURABLE 4 INCH YELLOW LINE (OPTION BID ITEM)
(ALL LINES WILL INCLUDE G BREAKS FOR SIDE ROADS)
STA. 413+50 TO 419+00, SOLID LT & RT
STA. 415+91, DOUBLE SOLID RT (WAUGH FARM ROAD, TH-17)

TEMPORARY 24 INCH STOP BAR, PAINT
DURABLE 24 INCH STOP BAR (OPTION BID ITEM)
STA. 415+91, RT (WAUGH FARM ROAD, TH-17)

TEMPORARY LETTER OR SYMBOL, PAINT
DURABLE LETTER OR SYMBOL (OPTION BID ITEM)
STA. 415+91, RT "STOP" (WAUGH FARM ROAD, TH-17)
STA. 418+52, RT "SCHOOL"

REMOVING SIGNS
AS SHOWN - 3

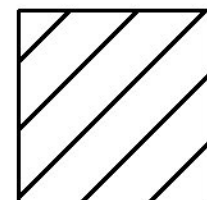
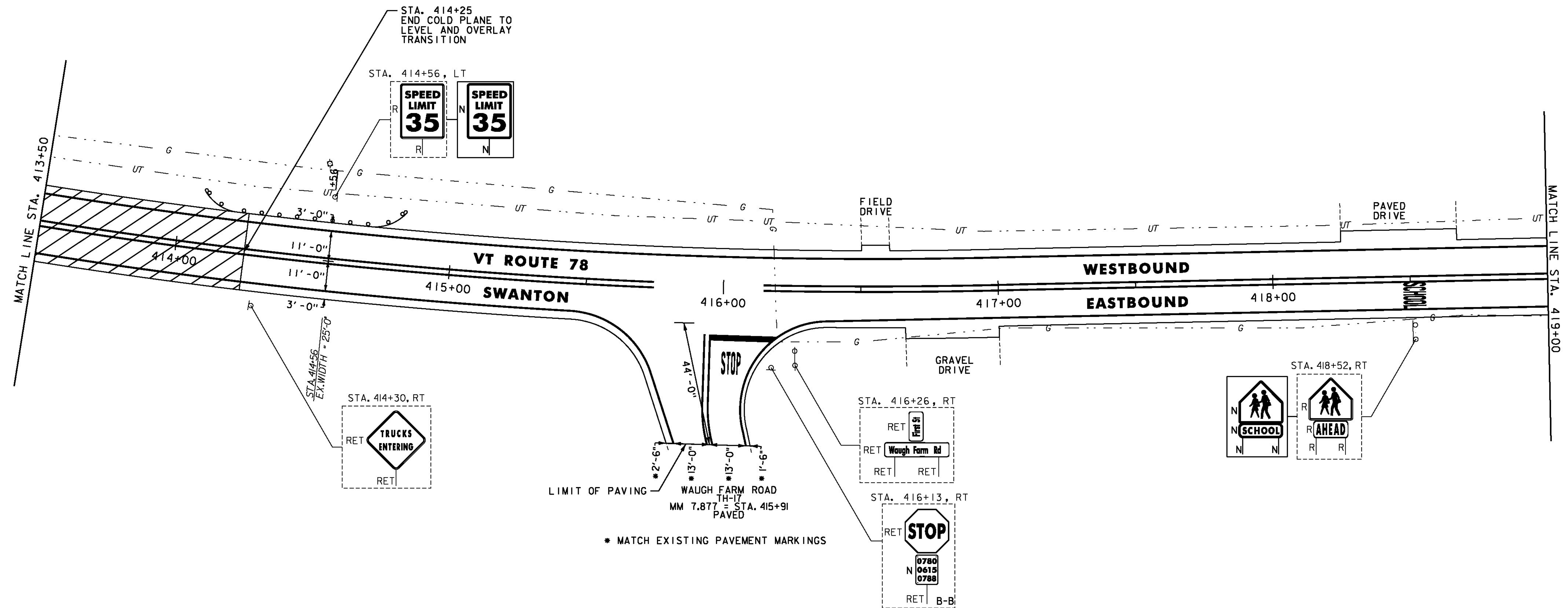

COLD PLANE TRANSITION AREA
(FOR DETAIL, SEE SHEET 3)

NOTES:

1. FOR LEGENDS, SEE SHEET 19.
2. ALL EXISTING SIGNS NOT SHOWN SHALL BE RETAINED.
3. ALL UTILITY LOCATIONS SHOWN ARE APPROXIMATE AND SHOULD BE VERIFIED PRIOR TO ANY WORK COMMENCING.

NOT TO SCALE



**PROJECT
LAYOUT
SHEET #6**

PROJECT NAME: SWANTON-SHELDON
PROJECT NUMBER: STP 2715(I)

FILE NAME: p07cl86.dgn
PROJECT LEADER: G. EDWARDS
DESIGNED BY: G. BARRETT

PLOT DATE: 4/24/2014
DRAWN BY: G. BARRETT
CHECKED BY: M. FOISY
SHEET 24 OF 121