

DURABLE 4 INCH WHITE LINE (SEE OPTION ITEMS)  
 STA. A 140+50 - STA. A 146+50 (SOLID LT & RT)

TEMPORARY 4 INCH WHITE LINE, PAINT  
 STA. A 140+50 - STA. A 146+50 (SOLID LT & RT)

REMOVE AND RESET GUARDRAIL  
 STA. A 140+50 - STA. A 145+52.5 RT  
 STA. A 142+42.5 - STA. A 144+61.25 LT

DURABLE 4 INCH YELLOW LINE (SEE OPTION ITEMS)  
 STA. A 140+50 - STA. A 146+50 (SOLID LT & RT)

TEMPORARY 4 INCH YELLOW LINE, PAINT  
 STA. A 140+50 - STA. A 146+50 (SOLID LT & RT)

REMOVAL AND DISPOSAL OF GUARDRAIL  
 STA. A 142+30 - STA. A 142+42.5 LT  
 STA. A 144+61.25 - STA. A 144+73.75 LT  
 STA. A 145+52.5 - STA. A 145+65 RT

CURVE #24  
 DELTA = 29°49'33"  
 D = 3°33'31" (1) D = 4°56'21" (2) D = 5°39'02" (3)  
 R = 1610.00' (1) R = 1160.00' (2) R = 1014.00' (3)  
 T = 354.16' (1) T = 294.13' (2)  
 L = 200.74' (1) L = 252.72' (2) L = 180.51' (3)  
 E = 38.49'  
 BANKING 0.059 FT/FT, 0.071 FT/FT, 0.075 FT/FT  
 DESIGN SPEED 50 MPH  
 SEE SUPERELEVATION DIAGRAMS  
 FOR MORE INFORMATION

REMOVING SIGNS  
 AS SHOWN - 2

STEEL BEAM GUARDRAIL, GALVANIZED W/8 FEET POSTS  
 STA. A 142+30 - STA. A 142+42.5 LT  
 STA. A 144+61.25 - STA. A 144+73.75 LT  
 STA. A 145+52.5 - STA. A 145+65 RT

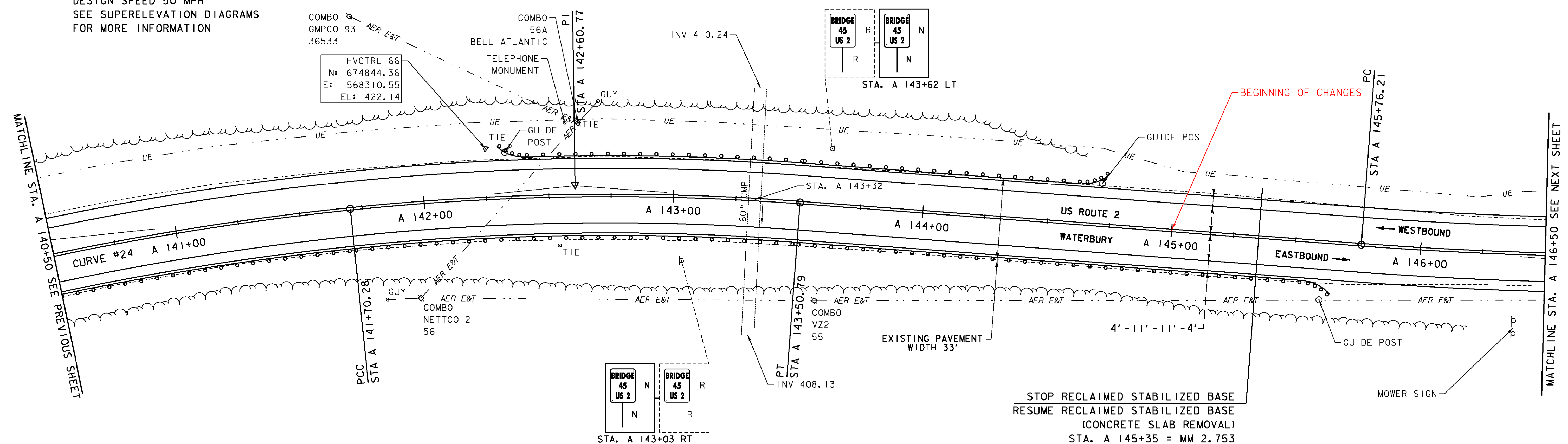
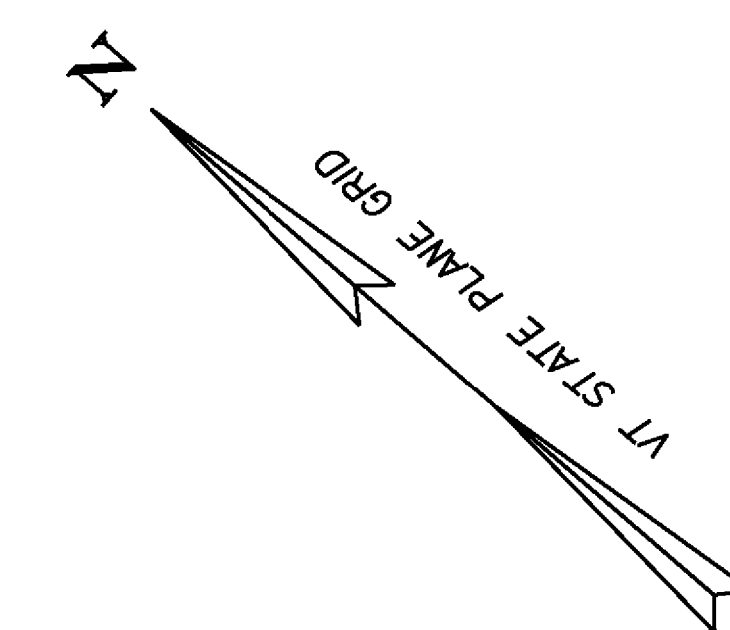

STOP RECLAIMED STABILIZED BASE  
 RESUME RECLAIMED STABILIZED BASE  
 (CONCRETE SLAB REMOVAL)  
 STA. A 145+35 = MM 2.753

SEE SHEET 85A FOR CHANGES  
 FROM STA. A 145+00 TO STA. A 151+00

- LEGEND**
- MAILBOX
  - BORING
  - SIGN
  - HYDRANT
  - MANHOLE
  - WATER SHUT OFF (WSO)
  - GAS PIPELINE MARKER
  - CATCH BASIN / DROP INLET
  - CURB INLET
  - TRAFFIC CONTROL BOX
  - PARKING METER
  - UTILITY POLE

- SIGN LEGEND**
- R = REMOVE
  - R&S = REMOVE AND SALVAGE
  - RET = RETAIN
  - S = SALVAGE
  - N = NEW
  - B-B = BACK TO BACK
  - = EXISTING
  - = NEW

DATUM  
 VERTICAL NAVD 88  
 HORIZONTAL NAD 83

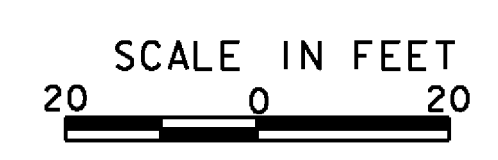

<b>PROJECT LAYOUT SHEET 60</b>	PROJECT NAME: BOLTON - WATERBURY	PLOT DATE: 04/17/2013
	PROJECT NUMBER: STP 2709 (1)	DRAWN BY: JBC/BMB
	FILE NAME: x07c172.dgn	CHECKED BY: CDL
	DESIGNED BY: BMB	SHEET 84 OF 217