

646.402 DURABLE 4 INCH WHITE LINE, THERMOPLASTIC OR  
 646.403 DURABLE 4 INCH WHITE LINE, EPOXY PAINT OR  
 646.404 DURABLE 4 INCH WHITE LINE, POLYUREA  
 (ALL LINES WILL INCLUDE EDGE LINE BREAKS AND  
 RADIUS FOR TOWN HIGHWAYS)  
 CASTLETON:  
 STA 260+50.00 - STA 272+50.00 EDGE LINE LT & RT

646.602 TEMPORARY 4 INCH WHITE LINE, PAINT  
 (ALL LINES WILL INCLUDE EDGE LINE BREAKS AND  
 RADIUS FOR TOWN HIGHWAYS)  
 CASTLETON:  
 STA 260+50.00 - STA 272+50.00 LT C RT  
 S - S

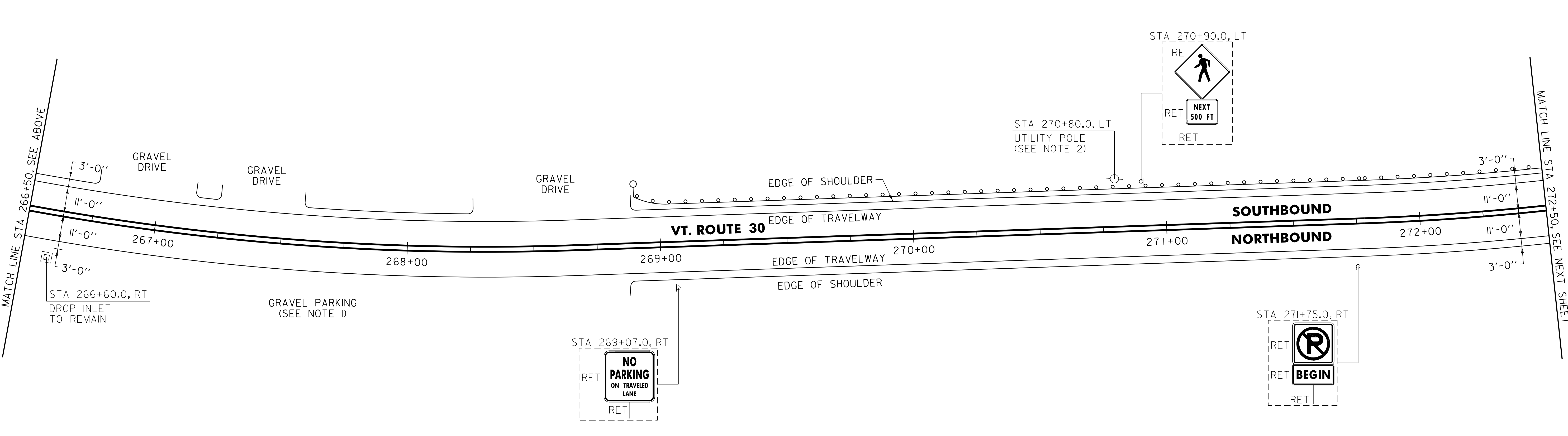
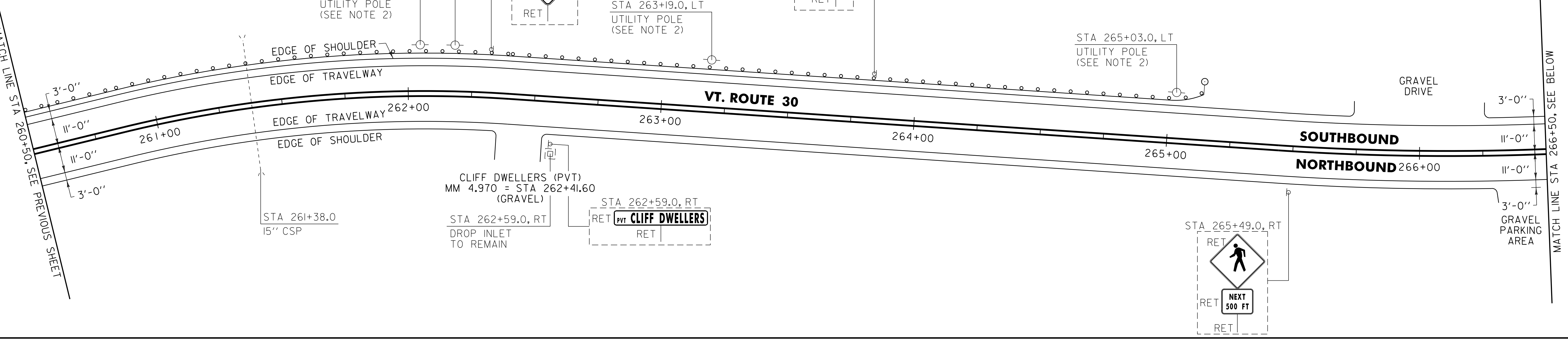

NOTES:  
 1. PROVIDE A 4 FT WIDE, 1/2" TYPE IVS APRON FOR THE EXISTING "GRAVEL PARKING". ANY REQUIRED EXCAVATION SHALL BE PERFORMED AS DIRECTD BY THE RESIDENT ENGINEER AND PAID FOR UNDER ITME 608.25 ALL PURPOSE EXCAVATOR RENTAL, TYPE I.  
 2. SEE SHEET 10 FOR REDUCED STEEL BEAM GUARDRAIL POST SPACING AT UTILITY POLE DETAIL.

621.205 STEEL BEAM GUARDRAIL, GALVANIZED W/8 FEET POSTS  
 CASTLETON:  
 STA 260+50.0 - STA 265+17.5 LT (528.5 LF)  
 STA 268+90.0 - STA 272+50.0 LT (360.0 LF)  
 621.60 ANCHOR FOR STEEL BEAM RAIL  
 CASTLETON:  
 STA 265+11.5 LT  
 STA 268+96.5 LT

621.80 REMOVAL AND DISPOSAL OF GUARDRAIL  
 CASTLETON:  
 STA 260+50.0 - STA 265+03.0 LT (453.0 LF)  
 STA 268+90.0 - STA 272+50.0 LT (360.0 LF)  
 676.10 DELINEATOR WITH STEEL POST  
 CASTLETON:  
 STA 265+17.5 LT  
 STA 268+90.0 LT

SIGN LEGEND  
 R = REMOVE  
 S = SALVAGE  
 N = NEW  
 RET = RETAIN  
 B-B = BACK TO BACK  
 EXISTING = - - - - -  
 NEW = \_\_\_\_\_

|                                 |                             |                             |
|---------------------------------|-----------------------------|-----------------------------|
| <b>PROJECT LAYOUT SHEET #21</b> | PROJECT NAME: CASTLETON     | PLOT DATE: 04-JUN-2013 09:3 |
|                                 | PROJECT NUMBER: STP 2909(1) | DRAWN BY: W.G.P.            |
|                                 | FILE NAME: p10c212.dgn      | CHECKED BY: D.E.G.          |
|                                 | DESIGNED BY: M.J.M.         | SHEET 149 OF 152            |
|                                 | IPARM FILE: p10c212121.i    |                             |