

646.402 DURABLE 4 INCH WHITE LINE, THERMOPLASTIC OR
 646.403 DURABLE 4 INCH WHITE LINE, EPOXY PAINT OR
 646.404 DURABLE 4 INCH WHITE LINE, POLYUREA
 (ALL LINES WILL INCLUDE EDGE LINE BREAKS AND
 RADIUS FOR TOWN HIGHWAYS)
 CASTLETON:
 STA 188+75.00 - STA 194+75.00 EDGE LINE LT & RT

646.412 DURABLE 4 INCH YELLOW LINE, THERMOPLASTIC OR
 646.413 DURABLE 4 INCH YELLOW LINE, EPOXY PAINT OR
 646.414 DURABLE 4 INCH YELLOW LINE, POLYUREA
 (ALL LINES WILL INCLUDE C/L BREAKS FOR
 TOWN HIGHWAYS) S=SOLID, D=DASHED
 CASTLETON:
 STA 188+75.00 - STA 194+75.00 LT S - S
 STA 190+76.64 DOUBLE SOLID LT, TH-7

646.602 TEMPORARY 4 INCH WHITE LINE, PAINT
 (ALL LINES WILL INCLUDE EDGE LINE BREAKS AND
 RADIUS FOR TOWN HIGHWAYS)
 CASTLETON:
 STA 188+75.00 - STA 194+75.00 LT S - S
 STA 190+76.64 DOUBLE SOLID LT, TH-7

646.612 TEMPORARY 4 INCH YELLOW LINE, PAINT
 (ALL LINES WILL INCLUDE C/L BREAKS FOR
 TOWN HIGHWAYS) S=SOLID, D=DASHED
 CASTLETON:
 STA 188+75.00 - STA 194+75.00 LT S - S
 STA 190+76.64 DOUBLE SOLID LT, TH-7

646.442 DURABLE 8 INCH WHITE LINE, THERMOPLASTIC OR
 646.443 DURABLE 8 INCH WHITE LINE, EPOXY PAINT OR
 646.444 DURABLE 8 INCH WHITE LINE, POLYUREA
 CASTLETON:
 STA 193+52.0 - STA 193+64.0 FIRE HYDRANT NO PARKING ZONE LT

646.482 DURABLE 24 INCH STOP BAR, THERMOPLASTIC OR
 646.483 DURABLE 24 INCH STOP BAR, EPOXY PAINT OR
 646.484 DURABLE 24 INCH STOP BAR, POLYUREA
 CASTLETON:
 STA 190+76.64 LT, TH-7

646.492 DURABLE LETTER OR SYMBOL, THERMOPLASTIC OR
 646.493 DURABLE LETTER OR SYMBOL, EPOXY PAINT
 CASTLETON:
 STA 190+76.64 LT, TH-7 "S,T,O,P" (4 EA)

646.502 DURABLE CROSSWALK MARKING, THERMOPLASTIC OR
 646.503 DURABLE CROSSWALK MARKING, EPOXY PAINT
 CASTLETON:
 STA 190+76.64 LT, TH-7

675.50 REMOVING SIGNS
 AS SHOWN - 4

646.682 TEMPORARY 24 INCH STOP BAR, PAINT
 CASTLETON:
 STA 190+76.64 LT, TH-7

646.692 TEMPORARY LETTER OR SYMBOL, PAINT
 CASTLETON:
 STA 190+76.64 LT, TH-7 "S,T,O,P" (8 EA)

646.702 TEMPORARY CROSSWALK MARKING, PAINT
 CASTLETON:
 STA 190+76.64 LT, TH-7

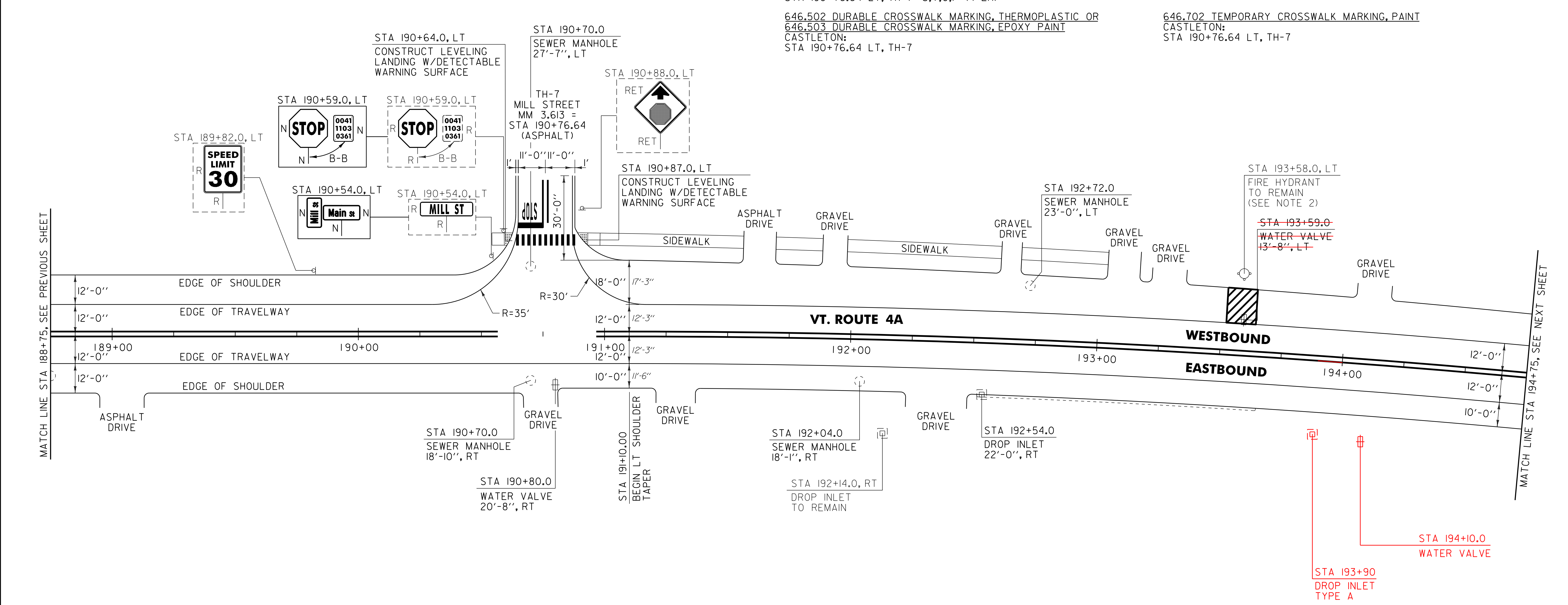

604.412, 604.415 OR 604.418 REHAB. DROP INLETS, CATCH
 BASINS OR MANHOLES (SEE NOTE 1)
 CASTLETON:
 STA 192+54.0 RT

604.42 CHANGING ELEVATION OF SEWER MANHOLES
 CASTLETON:
 STA 190+70.0 LT
 STA 190+70.0 RT
 STA 192+04.0 RT
 STA 192+72.0 LT

629.20 ADJUST ELEVATION OF VALVE BOX
 CASTLETON:
 STA 190+80.0 RT
 STA 193+59.0 LT

618.10 PORTLAND CEMENT CONCRETE SIDEWALK, 5 INCH
 CASTLETON:
 STA 190+64.0 LT (3.9 SY)
 STA 190+87.0 LT (3.9 SY)

618.30 DETECTABLE WARNING SURFACE
 CASTLETON:
 STA 190+64.0 LT (10.0 SF)
 STA 190+87.0 LT (10.0 SF)

SIGN LEGEND
 R = REMOVE
 S = SALVAGE
 N = NEW
 RET = RETAIN
 B-B = BACK TO BACK
 EXISTING = - - - - -
 NEW = _____

NOTES:
 1. THE CONTRACTOR SHALL REHAB. THE EXISTING DROP INLETS, CATCH BASINS OR MANHOLES TO A DEPTH AS DIRECTED BY THE RESIDENT ENGINEER. ALL REHAB. WORK WILL BE PAID FOR UNDER THE APPLICABLE REHAB. ITEM AS DIRECTED BY THE RESIDENT ENGINEER. ALL EXISTING UTILITIES MARKED "TO REMAIN" SHALL NOT BE ALTERED OR REHABILITATED UNLESS DIRECTED OTHERWISE BY THE RESIDENT ENGINEER.
 2. SEE SHEET 8 FOR FIRE HYDRANT PAVEMENT MARKING DETAIL.

PROJECT LAYOUT SHEET #8	NOT TO SCALE	
	PROJECT NAME: CASTLETON	PROJECT NUMBER: STP 2908(1)
	FILE NAME: p10c210.dgn	PLOT DATE: 04-JUN-2013 09:3
	PROJECT LEADER: D.E.G.	DRAWN BY: W.G.P.
	DESIGNED BY: M.J.M.	CHECKED BY: D.E.G.
	IPARM FILE: p10c210I08.i	SHEET 105 OF 152