

LIST OF TOWNSTATE HIGHWAYS FOR CONSTRUCTION SIGNS

| TOWN/STATE HIGHWAY NAME | SIDE ROAD WORK AHEAD | SIDE ROAD WORK 500' | END ROAD WORK | ROAD WORK 500' | ROAD WORK AHEAD | ROAD WORK NEXT XX MILES | OTHER |
|-------------------------|----------------------|---------------------|---------------|----------------|-----------------|-------------------------|------------------------------------|
| BEGINNING OF PROJECT | 4 | 4 | 2 | 1 | 1 | 1 | 2-PORTABLE CHANGEABLE MESSAGE SIGN |
| TH #8 (MM 1.131) | | | 1 | | 1 | | |
| TH #6 (MM 4.986) | | | 1 | | 1 | | |
| TH #5 (MM 5.273) | | | 1 | | 1 | | |
| TH #5 (MM 5.303) | | | 1 | | 1 | | |
| TH #3 (MM 5.830) | | | 1 | | 1 | | |
| TH #4 (MM 7.137) | | | 1 | | 1 | | |
| TH #2 APP (MM 7.196) | | | 1 | | 2 | 2 | 1-PORTABLE CHANGEABLE MESSAGE SIGN |
| TH #4 (MM 7.253) | | | 1 | | 1 | | |
| END OF PROJECT | | | 1 | 2 | 2 | 1 | 1-PORTABLE CHANGEABLE MESSAGE SIGN |
| TOTAL | 4 | 4 | 11 | 3 | 12 | 4 | 4 |

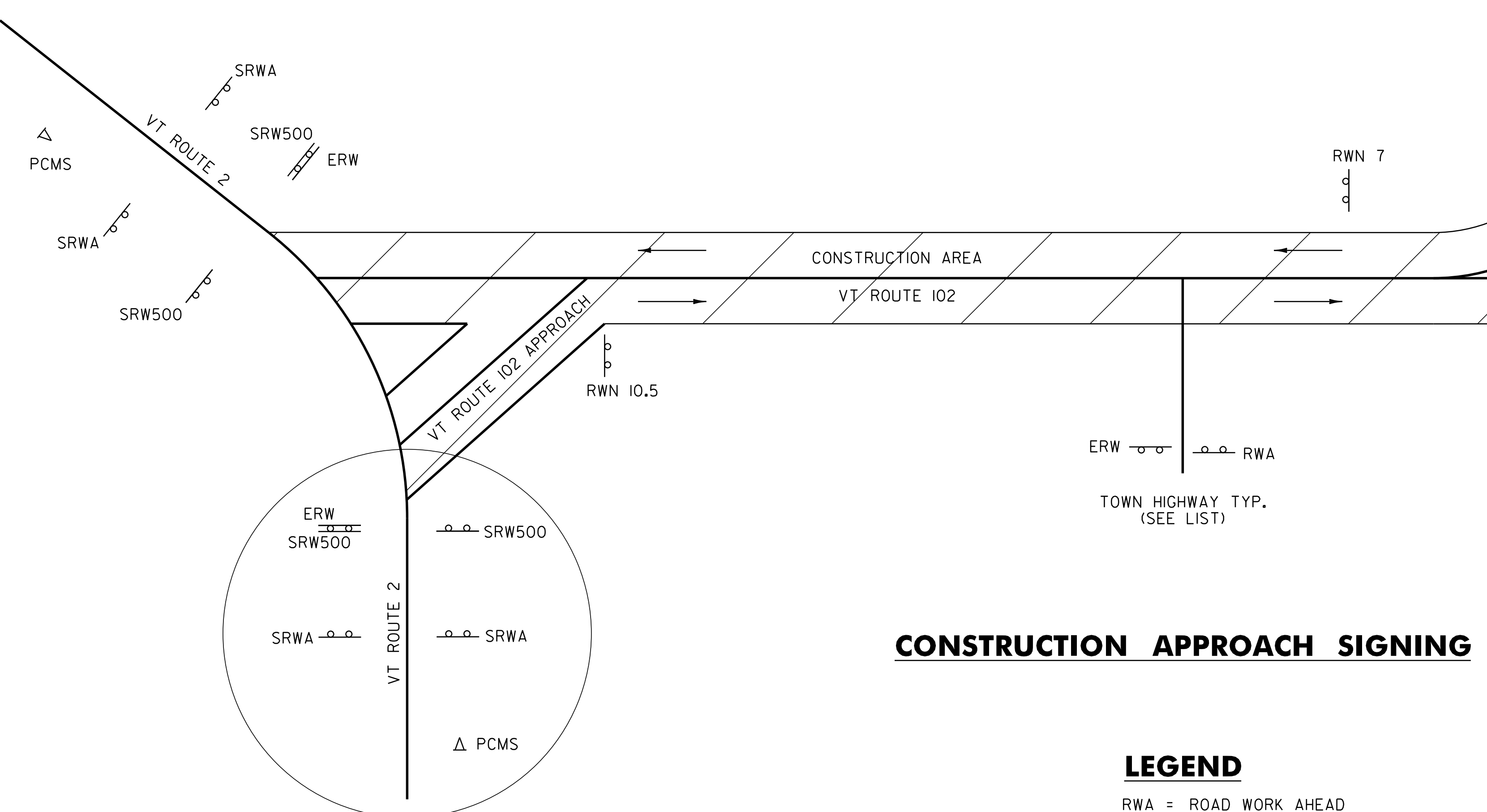
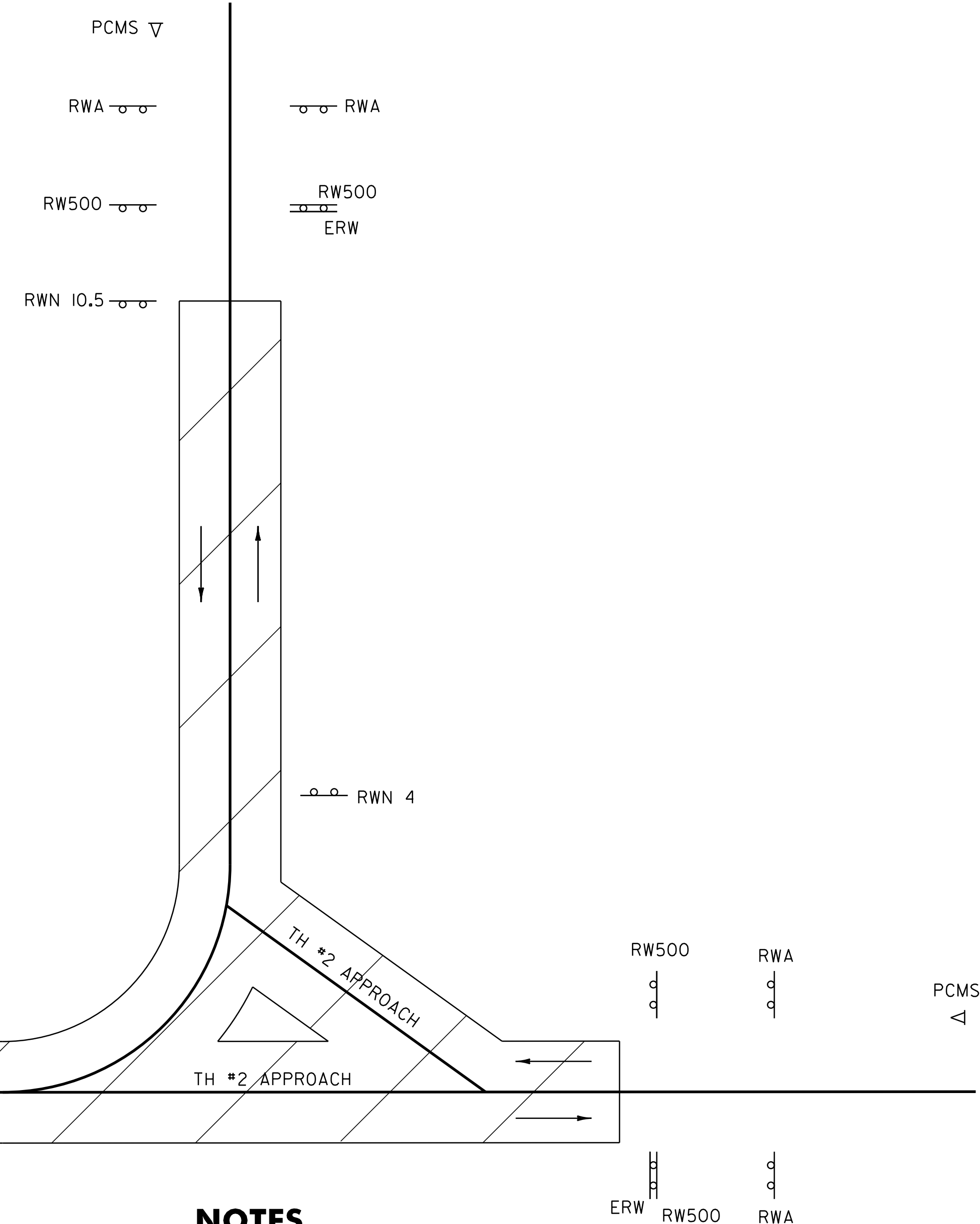

NOTES

- SEE STANDARDS E-100 AND E-100A FOR SIGN PLACEMENT.
- THE CONTRACTOR SHALL INCLUDE A CONSTRUCTION SIGN PACKAGE FOR EXPECTED LANE CLOSURES AND WORK ZONE SPEED REDUCTIONS IN COMPLIANCE WITH STANDARD E-103 AND MUTCD PART 6, FIGURE 6H-10. PAYMENT FOR PROVIDING THIS PACKAGE SHALL BE INCIDENTAL TO ITEM 641.10, TRAFFIC CONTROL.
- PAYMENT FOR CONSTRUCTION APPROACH SIGNING WILL BE MADE UNDER ITEM 641.10, TRAFFIC CONTROL.
- CONSTRUCTION ZONE SIGN LAYOUT SHALL BE IN ACCORDANCE WITH SECTION 6 OF THE LATEST EDITION OF THE MANUAL ON UNIFORM TRAFFIC CONTROL DEVICES (MUTCD).
- CONSTRUCTION SIGNS SHALL BE IN NEW OR LIKE NEW CONDITION PER VAOT STANDARDS.
- DIAMOND SHAPED SIGNS SHALL BE 4' X 4' WITH BLACK LEGEND ON FLUORESCENT ORANGE BACKGROUND.
- RETROREFLECTIVE SHEETING SHALL BE TYPE VII OR BETTER.
- CONSTRUCTION ZONE SIGNS SHALL BE INSTALLED ON TWO POSTS EACH OR AS AN NCHRP REPORT 350 COMPLIANT SIGN/STAND SYSTEM.
- INSTALLATION OF CONSTRUCTION ZONE SIGNING SHALL NOT BLOCK EXISTING SIGN ASSEMBLIES. A MINIMUM OF 200 FEET SHALL BE MAINTAINED BETWEEN ANY EXISTING SIGNS AND THE CONSTRUCTION SIGNS.
- PORTABLE CHANGEABLE MESSAGE SIGNS ARE OPTIONAL AND ARE TO BE USED AS DIRECTED BY THE RESIDENT ENGINEER. PAYMENT FOR THESE SHALL BE PAID UNDER 641.15, PORTABLE CHANGEABLE MESSAGE SIGN.

CONSTRUCTION APPROACH SIGNING

LEGEND

- RWA = ROAD WORK AHEAD
- RW500 = ROAD WORK 500'
- RWN = ROAD WORK NEXT XX MILES
- ERW = END ROAD WORK
- SRWA = SIDE ROAD WORK AHEAD
- SRW500 = SIDE ROAD WORK 500'
- △ PORTABLE CHANGEABLE MESSAGE SIGN
- TRAFFIC FLOW ARROWS

THE RESIDENT ENGINEER SHALL CONTACT NH DOT, HIGHWAY MAINTENANCE DISTRICT 1 ENGINEER; DAVE RODRIGUE, (603) 788-4641 BEFORE CONSTRUCTION SIGNS ARE LAID OUT ON THE ROUTE 2 PORTION TOWARDS NEW HAMPSHIRE.

NOT TO SCALE

| | |
|--|------------------------------------|
| CONSTRUCTION APPROACH SIGNING SHEET | PROJECT NAME: GUILDHALL-MAIDSTONE |
| | PROJECT NUMBER: STP 2706 (I) |
| | FILE NAME: ...07C162\...07C162.dgn |
| | PLOT DATE: 31-OCT-2011 10:44 |
| PROJECT LEADER: DOMEY | DRAWN BY: PAVT MGMT |
| DESIGNED BY: PAVT MGMT | CHECKED BY: PAVT MGMT |
| IPARM FILE NAME: 07C162_18.1 | SHEET 18 OF 18 |