

PRECAST REINFORCED CONCRETE DROP INLET WITH CAST IRON GRATE
 STA 18+60 LT
 6 INCH UNDERDRAIN PIPE
 STA 15+75 LT TO 16+75 LT
 6 INCH UNDERDRAIN CARRIER PIPE
 STA 16+75 LT TO 18+60 LT
 UNDERDRAIN FLUSHING BASIN
 STA 16+75 LT & 18+75 LT
 STONE FILL TYPE I
 STA 15+75 LT TO 19+50 LT
 STONE FILL TYPE II
 STA 18+50 RT TO 19+00 RT
 TREATED TREATED CURB
 STA 16+50 RT TO 19+00 RT
 REMOVE AND RESET GUARDRAIL
 STA 16+50 RT TO 19+00 RT

STA 18+30 LT
SPEED LIMIT 40
 R&S

TEMPORARY EROSION MATTING
 STA 18+20 RT TO 19+25 RT
 PROJECT DEMARCATION FENCE
 STA 15+75 LT TO 19+75 LT
 STA 15+75 RT TO 20+75 RT

REMOVING SIGNS
 STA 18+30 LT & RT
 ERECTING SALVAGED SIGNS
 STA 18+30 LT & RT
 SETTING SALVAGED POSTS
 STA 18+30 LT & RT
 SPECIAL PROVISION (8 INCH UNDERDRAIN PIPE)
 STA 16+75 TO 18+75

SPECIAL PROVISION (HORIZONTAL DIRECTIONAL DRILLING)(12" STEEL CASING W/8" CARRIER PIPE)
 STA 18+50
 SPECIAL PROVISION (INSTALL GEOTEXTILE UNDER STONE FILL)
 STA 15+75 LT TO 16+75 LT
 STA 16+75 LT TO 18+75 LT
 SPECIAL PROVISION (INSTALL GEOTEXTILE FOR SILT FENCE)
 STA 16+00 RT TO 19+75 RT
 CONSTRUCT DRAIN CURTAIN
 STA 16+75 LT TO 18+75 LT

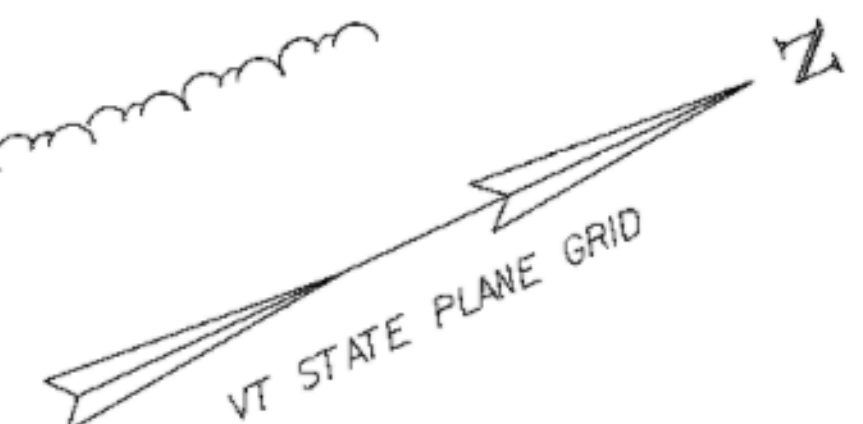
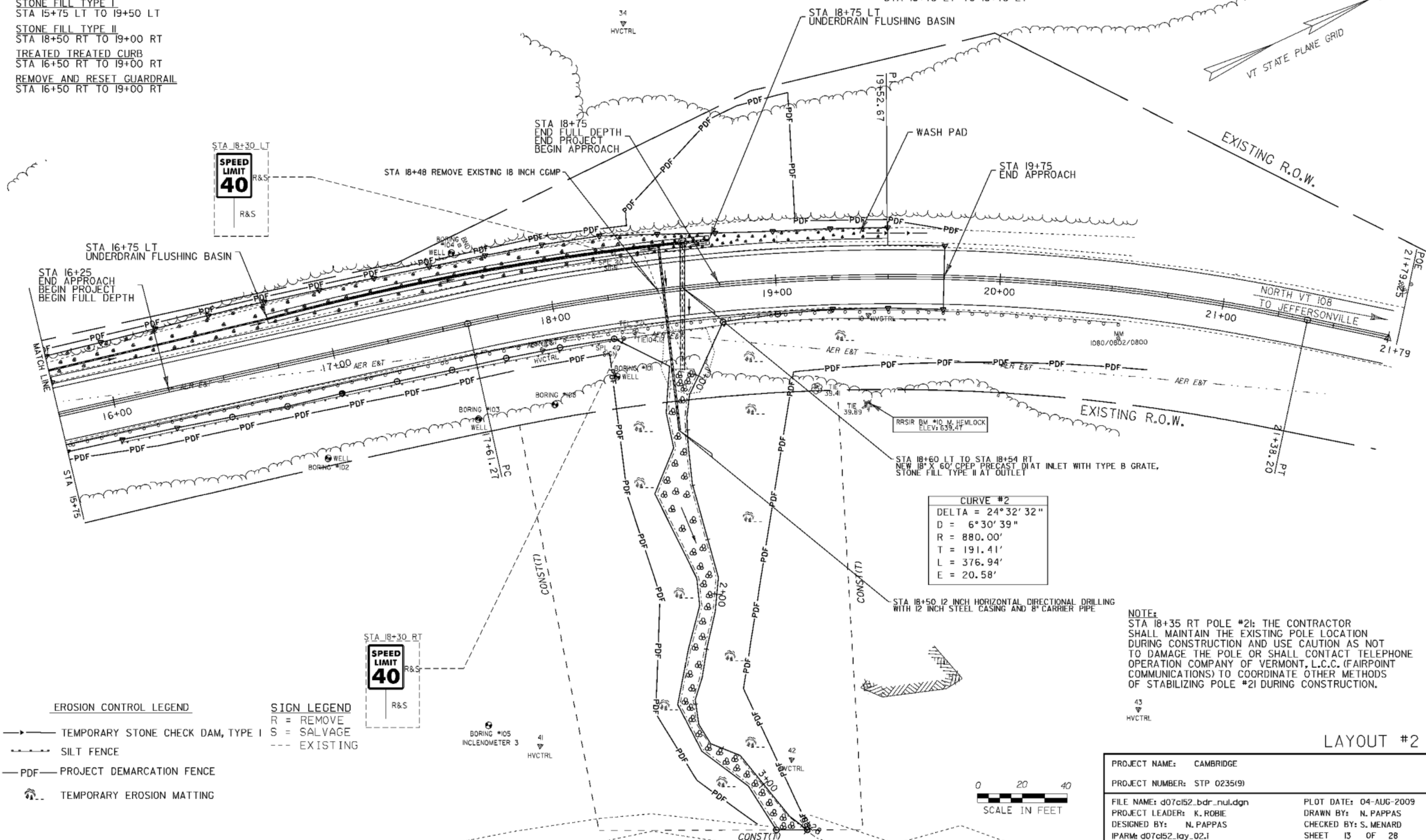

CURVE #2	
DELTA	= 24° 32' 32"
D	= 6° 30' 39"
R	= 880.00'
T	= 191.41'
L	= 376.94'
E	= 20.58'

NOTE:
 STA 18+35 RT POLE #21: THE CONTRACTOR SHALL MAINTAIN THE EXISTING POLE LOCATION DURING CONSTRUCTION AND USE CAUTION AS NOT TO DAMAGE THE POLE OR SHALL CONTACT TELEPHONE OPERATION COMPANY OF VERMONT, L.C.C. (FAIRPOINT COMMUNICATIONS) TO COORDINATE OTHER METHODS OF STABILIZING POLE #21 DURING CONSTRUCTION.

- EROSION CONTROL LEGEND**
- TEMPORARY STONE CHECK DAM, TYPE I
 - SILT FENCE
 - PDF — PROJECT DEMARCATION FENCE
 - TEMPORARY EROSION MATTING
- SIGN LEGEND**
- R = REMOVE
 - S = SALVAGE
 - EXISTING

STA 18+30 RT
SPEED LIMIT 40
 R&S



LAYOUT #2
 PROJECT NAME: CAMBRIDGE
 PROJECT NUMBER: STP 0235(9)
 FILE NAME: d07c152_bdr_nul.dgn
 PROJECT LEADER: K. ROBBE
 DESIGNED BY: N. PAPPAS
 IPARM: d07c152_lay_02.l
 PLOT DATE: 04-AUG-2009
 DRAWN BY: N. PAPPAS
 CHECKED BY: S. MENARD
 SHEET 13 OF 28