

INDEX OF SHEETS SEE SHEET 2

STATE OF VERMONT AGENCY OF TRANSPORTATION

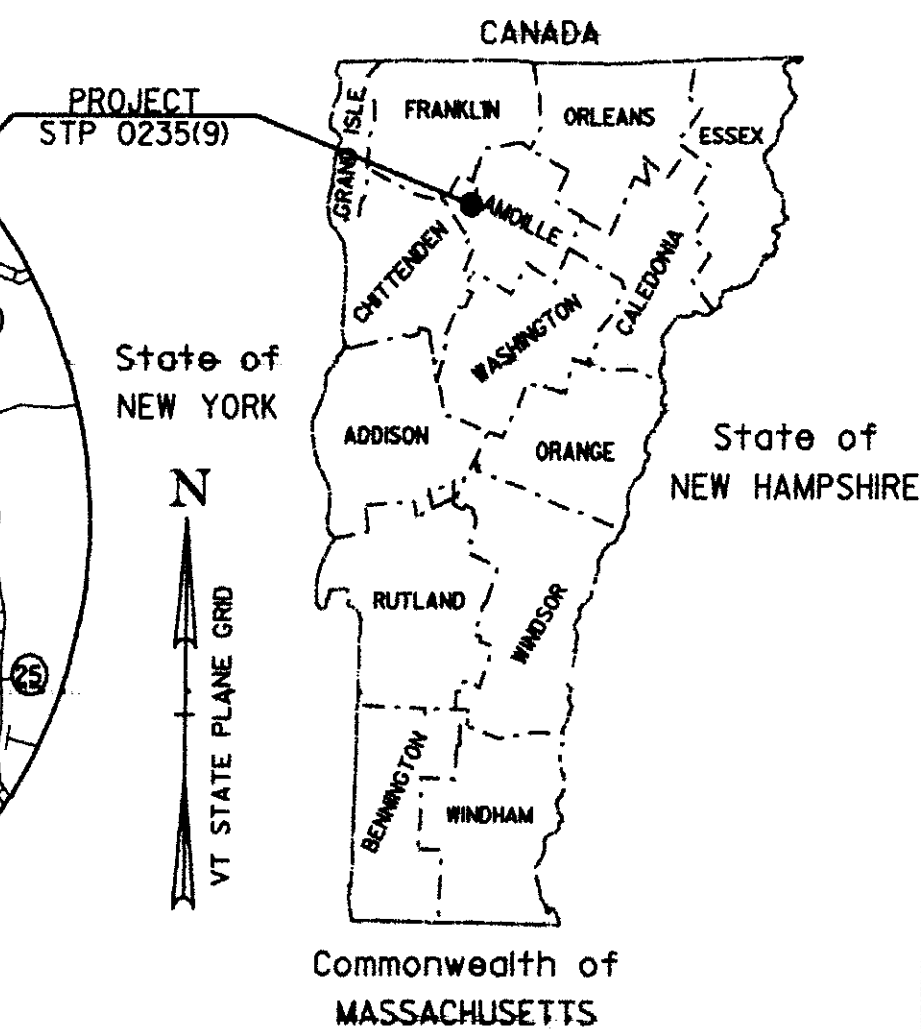

PROPOSED SAFETY IMPROVEMENT TOWN OF CAMBRIDGE COUNTY OF LAMOILLE VT ROUTE 108

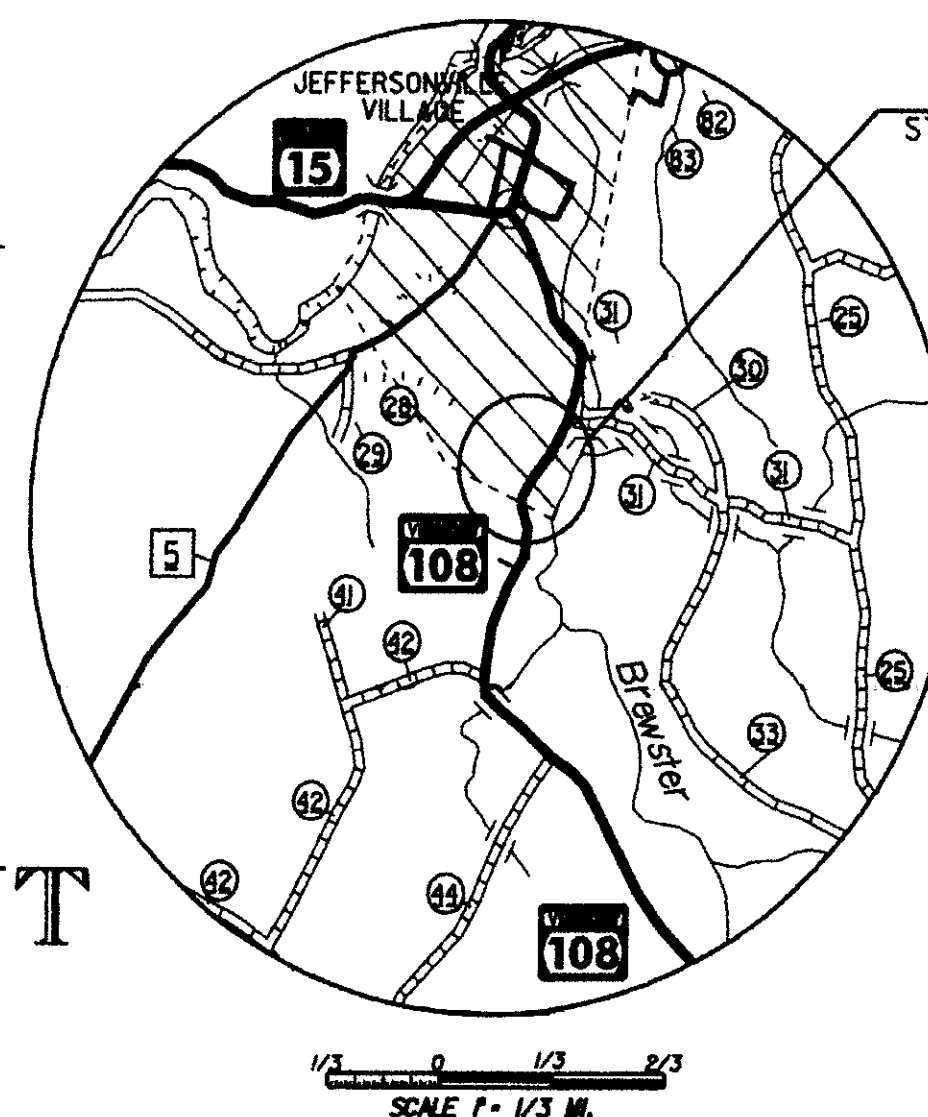

RECORD PLANS

CONTRACTOR: J. HUTCHINS, INC. - RICHMOND, VT

RESIDENT ENGINEER: GREG WILCOX

CONSTRUCTION BEGAN: OCTOBER 15, 2009

CONSTRUCTION COMPLETE: JUNE 10, 2010

RECORD PLANS BY: GREG WILCOX & C. PIERCE

I HEREBY CERTIFY THAT ALL THE CONSTRUCTION REQUIRED BY THIS SET OF DRAWINGS HAS BEEN ACCOMPLISHED AS INDICATED HEREIN.

BY: *Greg Wilcox* RESIDENT ENGINEER
DATE: 5/17/11

NOTE: Any further information concerning final quantities, amounts or other details relative to this project may be found at Central Files in the electronic archives.

LOCATED IN THE TOWN OF CAMBRIDGE, ON VERMONT ROUTE 108, BEGINNING AT APPROXIMATELY MM 7.88 AND EXTENDING NORTHERLY 0.047 MILES TO MM 7.93.
LENGTH OF PROJECT = 250 FEET = 0.047 MILES

WORK TO BE PERFORMED UNDER THIS PROJECT INCLUDES DIRECTIONAL BORING, DRAIN CURTAIN, UNDERDRAIN, DRAINAGE STRUCTURES, PAVEMENT, SUBBASE, GUARDRAIL AND OTHER RELATED ITEMS.

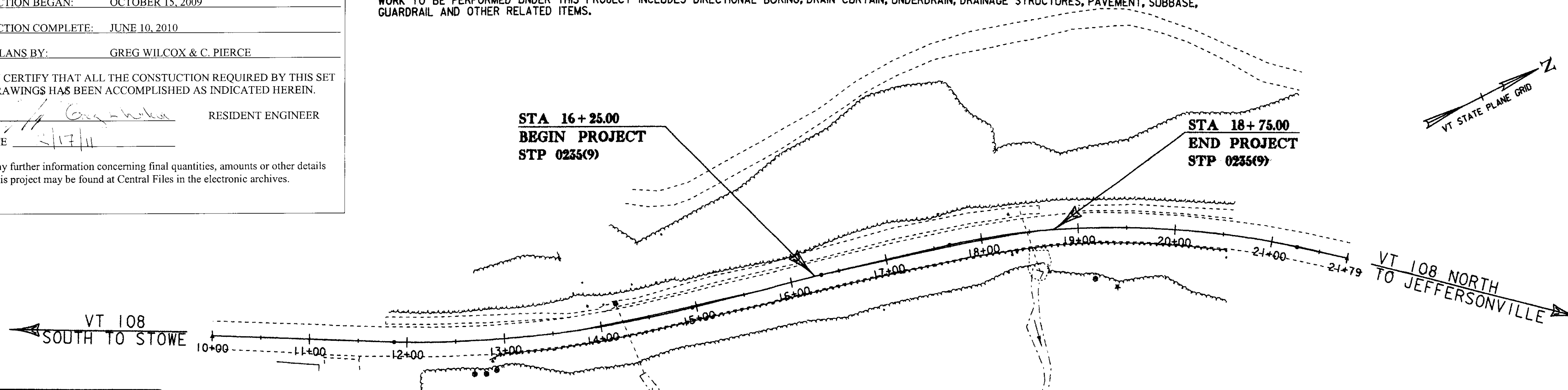

CONVENTIONAL SYMBOLS

COUNTY LINE	
TOWN LINE	
LIMITS OF ACCESS	
POINT OF ACCESS	
FENCE LINE	
STONE WALL	
TRAVELED WAY	
RAILROAD	
SURVEY LINE	
CULVERT	
POWER POLE	
TELEPHONE POLE	
TREES	
CONTROL OF ACCESS	
PROPERTY LINE	
R.O.W. TAKING LINE	
SLOPE RIGHTS	
TOP OF CUT	
TOE OF SLOPE	

SURVEYED BY : VTRANS
SURVEYED DATE : 05/2008

DATUM
VERTICAL NAVD 88
HORIZONTAL NAD 83 (07)

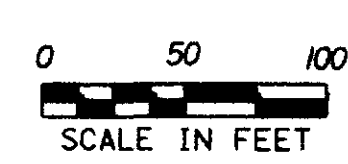

TRAFFIC DATA

HIGHWAY SECTION	ADT		FLEXIBLE ESALs	
	2009	2009 (05-15)	2009 (05-15)	2009 (05-25)
VT ROUTE 108	550	4,900	5,537	406,000

MAJOR COLLECTOR

DIRECTOR OF PROGRAM DEVELOPMENT
APPROVED: *Robert J. Starnelli* DATE: 5-4-09

PROJECT MANAGER : KENNETH A. ROBIE

PROJECT NAME : CAMBRIDGE
PROJECT NUMBER : STP 0235 (9)

SHEET 1 OF 28 SHEETS

THESE PLANS ARE SUBJECT TO SUCH ENGINEERING CHANGES AS MAY BE REQUIRED BY THE FEDERAL HIGHWAY ADMINISTRATION OR THE DIRECTOR OF PROGRAM DEVELOPMENT.
CONSTRUCTION IS TO BE CARRIED ON IN ACCORDANCE WITH THESE PLANS AND THE STANDARD SPECIFICATIONS FOR CONSTRUCTION DATED 2006, AS APPROVED BY THE FEDERAL HIGHWAY ADMINISTRATION ON JUNE 15, 2006 FOR USE ON THIS PROJECT, INCLUDING ALL SUBSEQUENT REVISIONS AND SUCH REVISED SPECIFICATIONS AND SPECIAL PROVISIONS AS ARE INCORPORATED IN THESE PLANS.