

CONSTRUCTION APPROACH SIGNING

NOT TO SCALE

SEE STD E-100, E-100A AND E-103 FOR SIGN PLACEMENT

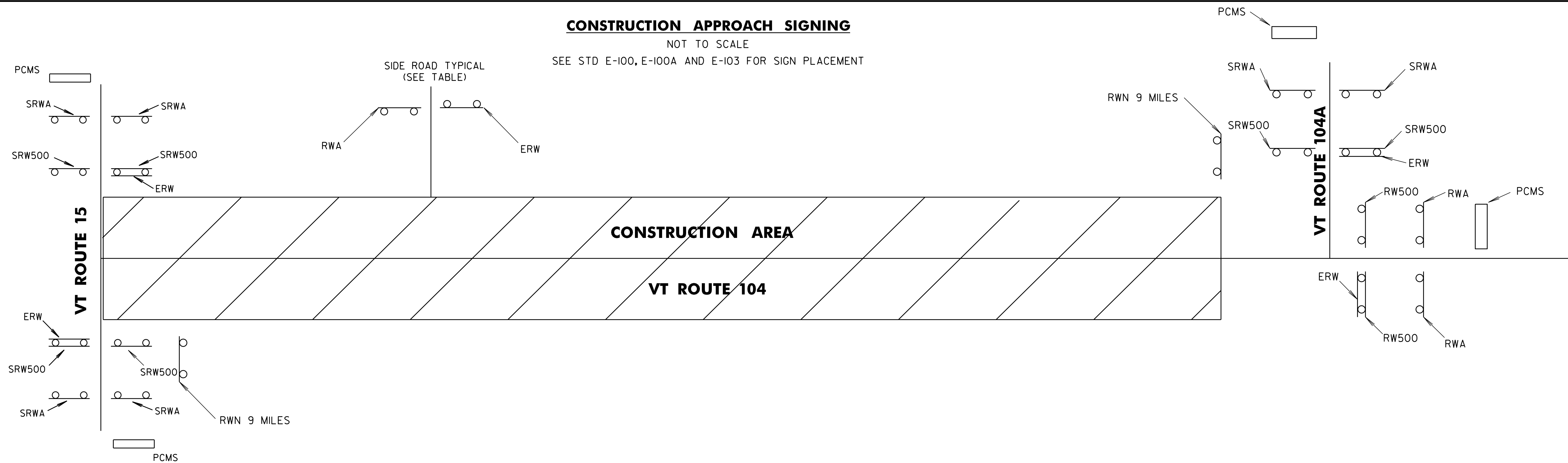

NOTES:

- THE CONTRACTOR SHALL SUBMIT A TRAFFIC CONTROL PLAN TO THE RESIDENT ENGINEER FOR THEIR APPROVAL PRIOR TO THE START OF CONSTRUCTION. THE COST OF PREPARING THIS PLAN (AND MAKING CHANGES IF NECESSARY) SHALL NOT BE PAID SEPARATELY BUT SHALL BE INCIDENTAL TO ITEM 64I.0, "TRAFFIC CONTROL".
- THE CONTRACTOR SHALL INCLUDE A CONSTRUCTION SIGN APPROACH PACKAGE FOR EXPECTED LANE CLOSURES AND WORK ZONE SPEED REDUCTIONS IN COMPLIANCE WITH THE TRAFFIC CONTROL NOTES AND PART 6 OF THE MUTCD. PAYMENT FOR PROVIDING THIS PACKAGE SHALL BE INCIDENTAL TO ITEM 64I.0, "TRAFFIC CONTROL".
- THE BID PRICE FOR "TRAFFIC CONTROL", ITEM 64I.0, SHALL INCLUDE ALL OF THE FOLLOWING, AS NEEDED: APPROACH AND ON-PROJECT CONSTRUCTION SIGNING, PORTABLE ARROW BOARDS, BARRIERS, BARRELS, CONES, BARRICADES, TEMPORARY REGULATORY AND WARNING SIGNS, AND POSTS AS DETAILED IN VTRANS STANDARDS. ALL ADJUSTING, RELOCATING, AND REMOVING OF THESE DEVICES AS DIRECTED BY THE RESIDENT ENGINEER SHALL ALSO BE INCLUDED. THE FOLLOWING ITEMS WILL BE PAID FOR SEPARATELY:
646.602, 646.612, 646.682 AND 646.692 - TEMPORARY PAVEMENT MARKINGS
630.I0 UNIFORMED TRAFFIC OFFICER, 630.I5 - FLAGGERS
- PORTABLE CHANGEABLE MESSAGE SIGNS (PCMS) WILL BE PROVIDED FOR USE ALONG THIS PROJECT. THE PLACEMENT OF THESE UNITS AS WELL AS THE MESSAGE WILL BE APPROVED BY THE RESIDENT ENGINEER. THESE SIGNS WILL BE PAID FOR UNDER ITEM 64I.5, "PORTABLE CHANGEABLE MESSAGE SIGN".

PCMS SHOULD NOT REPLACE ANY OF THE SIGNING DETAILED IN THE MUTCD AND SHOULD NOT BE USED IF STANDARD TRAFFIC CONTROL DEVICES ADEQUATELY PROVIDE THE INFORMATION THE MOTORISTS NEED TO TRAVEL SAFELY.

THE PCMS SHALL CONSIST OF EITHER ONE OR TWO PHASES. TYPICALLY, A PHASE SHALL CONSIST OF UP TO THREE LINES OF EIGHT CHARACTERS PER LINE. THE PCMS SHOULD BE USED AS A SUPPLEMENT AND NOT AS A SUBSTITUTE FOR CONVENTIONAL SIGNS AND PAVEMENT MARKINGS.

THE PCMS SHOULD COMMUNICATE WHAT INFORMATION MOTORISTS NEED TO KNOW. UNNECESSARY INFORMATION SHOULD BE AVOIDED. MESSAGES SHOULD BE UPDATED PERIODICALLY TO DESCRIBE THE WORK ACTIVITY OCCURRING SO THAT THE PCMS CONTINUES TO COMMAND THE ATTENTION OF MOTORISTS.
- THE MUTCD 2009 SHALL BE THE STANDARD FOR ALL TRAFFIC CONTROL DEVICES. EXISTING SIGNS, SIGNALS AND MARKINGS SHALL BE VALID UNTIL SUCH TIME AS THEY ARE REPLACED OR RECONSTRUCTED. WHEN NEW TRAFFIC CONTROL DEVICES ARE ERECTED OR PLACED OR EXISTING TRAFFIC CONTROL DEVICES ARE REPLACED OR REPAIRED THE EQUIPMENT, DESIGN, METHOD OF INSTALLATION, PLACEMENT OR REPAIR SHALL CONFORM WITH SUCH STANDARDS.
- NO CONSTRUCTION SIGNS SHALL BE INSTALLED AS TO INTERFERE OR OBSTRUCT THE VIEW OF EXISTING TRAFFIC CONTROL DEVICES, STOPPING SIGHT DISTANCE, AND CORNER SIGHT DISTANCE FROM DRIVES AND TOWN HIGHWAYS.
- CONES SHALL BE USED TO CLEARLY DEFINE THE TRAVEL SPACE AND PROVIDE SEPARATION FROM THE WORK SPACE ALONG ITS ENTIRE LENGTH.
- AS THE PAVING OPERATION MOVES, THE FLAGGER SIGNS SHALL BE MOVED ACCORDINGLY. AT NO TIME SHOULD THE FLAGGER SYMBOL SIGN BE MORE THAN 1000 FT FROM THE FLAGGER STATION. FLAGGER SIGNS SHALL BE COVERED OR TURNED AWAY IF FLAGGING OPERATIONS CEASE FOR MORE THAN 15 MINUTES.

- ALL PERMANENT SIGNS THAT CONFLICT WITH TEMPORARY TRAFFIC CONTROL SHALL BE COMPLETELY COVERED, THE PAYMENT FOR WHICH SHALL BE INCLUDED IN THE UNIT PRICE BID FOR ITEM 64I.0 TRAFFIC CONTROL.
- CONSTRUCTION ZONE SIGN LAYOUT SHALL BE IN ACCORDANCE WITH SECTION 6 OF THE 2009 MUTCD.
- CONSTRUCTION SIGNS SHALL BE IN NEW OR LIKE NEW CONDITION PER VAOT STANDARDS.
- DIAMOND SHAPED SIGNS SHALL BE 4'X4' WITH BLACK TEXT AND BORDER ON A RETROREFLECTIVE FLOURESCENT ORANGE BACKGROUND.
- RETROREFLECTIVE SHEETING SHALL BE AS SPECIFIED IN THE SPECIAL PROVISIONS.
- CONSTRUCTION ZONE SIGNS SHALL BE INSTALLED AS SPECIFIED IN THE SPECIAL PROVISIONS.
- WHERE TEMPORARY SIGNS ARE PLACED BEHIND GUARDRAIL, THEY SHALL BE ADJUSTED SUCH THAT THE BOTTOM OF THE SIGNS ARE ABOVE THE TOP OF GUARDRAIL.

	ROAD WORK AHEAD	END ROAD WORK	SIDE ROAD WORK AHEAD	SIDE ROAD WORK 500 FT	ROAD WORK 500 FT	ROAD WORK NEXT 9 MILES	PCMS
CAMBRIDGE							
VT 15		2	4	4			2
BEGIN PROJECT (VT 104)						1	
FAIRFAX							
ALLEN IRISH RD	1	1					
TOOF RD	1	1					
PLAINS RD	1	1					
RIVER RD	1	1					
SAND HILL RD	1	1					
VT-128 APPROACH	1	1					
VT-128	1	1					
MAPLE ST	1	1					
RIVER RD	1	1					
SCHOOL ST	1	1					
HUNT ST	1	1					
HUNTVILLE RD	1	1					
BUCK HOLLOW RD	1	1					
SAM WEBB RD	1	1					
VT 104A		1	2	2			1
END PROJECT (VT 104)	2	1			2	1	1
TOTALS	16	18	6	6	2	2	4

LEGEND

- RWA = ROAD WORK AHEAD
- RW500 = ROAD WORK 500 FT
- SRWA = SIDE ROAD WORK AHEAD
- SRW500 = SIDE ROAD WORK 500 FT
- ERW = END ROAD WORK
- RWN = ROAD WORK NEXT 9 MILES
- PCMS = PORTABLE CHANGEABLE MESSAGE SIGN

CONSTRUCTION APPROACH SIGNING SHEET

PROJECT NAME: CAMBRIDGE-FAIRFAX

PROJECT NUMBER: STP 2713(I)

FILE NAME: p07B182.dgn

PROJECT LEADER: CDL

DESIGNED BY: SJL

PLOT FILE: p07B182_36.t

PLOT DATE: 29-DEC-2014 13:46

DRAWN BY: SJL

CHECKED BY: EPD

SHEET 36 OF 36