

DURABLE 4 INCH WHITE LINE (SEE OPTION ITEMS)
 STA. 87+50 - STA. 102+25 (SOLID LT & RT)

TEMPORARY 4 INCH WHITE LINE, PAINT
 STA. 87+50 - STA. 102+25 (SOLID LT & RT)

DURABLE 4 INCH YELLOW LINE (SEE OPTION ITEMS)
 STA. 87+50 - STA. 92+76 (DASHED LT, SOLID RT, CENTERLINE)
 STA. 92+76 - STA. 102+25 (SOLID LT & RT, CENTERLINE)

TEMPORARY 4 INCH YELLOW LINE, PAINT
 STA. 87+50 - STA. 92+76 (DASHED LT, SOLID RT, CENTERLINE)
 STA. 92+76 - STA. 102+25 (SOLID LT & RT, CENTERLINE)

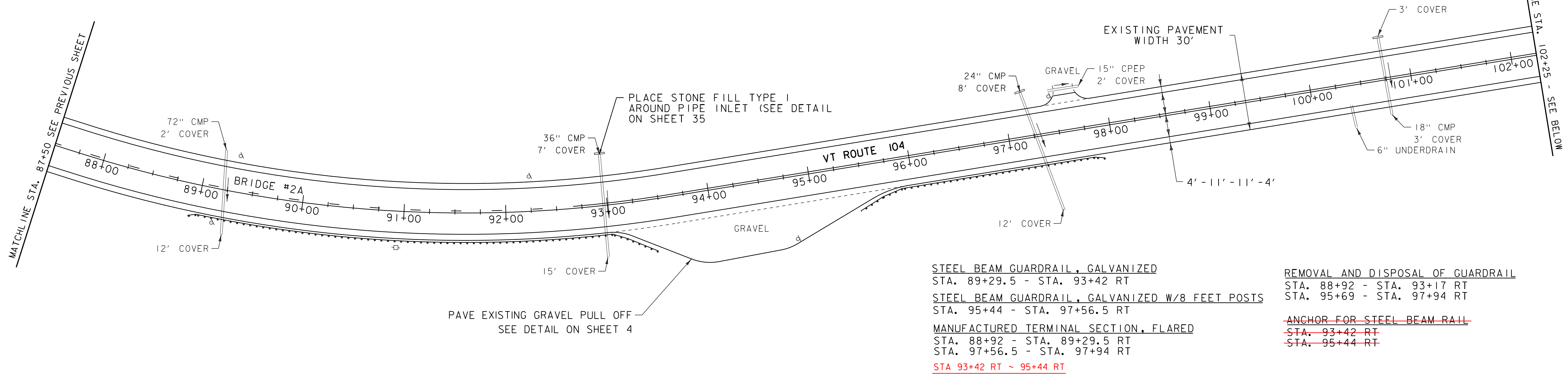

STEEL BEAM GUARDRAIL, GALVANIZED
 STA. 89+29.5 - STA. 93+42 RT

REMOVAL AND DISPOSAL OF GUARDRAIL
 STA. 88+92 - STA. 93+17 RT
 STA. 95+69 - STA. 97+94 RT

STEEL BEAM GUARDRAIL, GALVANIZED W/8 FEET POSTS
 STA. 95+44 - STA. 97+56.5 RT

~~ANCHOR FOR STEEL BEAM RAIL
 STA. 93+42 RT
 STA. 95+44 RT~~

MANUFACTURED TERMINAL SECTION, FLARED
 STA. 88+92 - STA. 89+29.5 RT
 STA. 97+56.5 - STA. 97+94 RT

~~STA 93+42 RT ~ 95+44 RT~~

STEEL BEAM GUARDRAIL, GALVANIZED
 STA. 10+19.5 - STA. 11+57 RT

STEEL BEAM GUARDRAIL, GALVANIZED W/8 FEET POSTS
 STA. 1+42 - STA. 6+69 RT
 STA. 3+44.5 - STA. 7+07 LT

MANUFACTURED TERMINAL SECTION, FLARED
 STA. 1+04.5 - STA. 1+42 RT
 STA. 3+07 - STA. 3+44.5 LT
 STA. 9+82 - STA. 10+19.5 RT
 STA. 11+57 - STA. 11+94.5 RT

REMOVAL AND DISPOSAL OF GUARDRAIL
 STA. 1+04.5 - STA. 6+67 RT
 STA. 3+07 - STA. 7+07 LT
 STA. 9+82 - STA. 11+94.5

TEMPORARY 4 INCH WHITE LINE, PAINT
 STA. 102+25 - STA. 103+85.77 (SOLID LT & RT)
 STA. 0+00 - STA. 13+50 (SOLID LT & RT)
 (WITH BREAKS AT TOWN ROADS)
 STA. 6+97 RT (EDGE LINES TH #50)
 STA. 7+30 LT (EDGE LINES TH #47)

THINNING AND TRIMMING FOR SIGNS
 STA. 8+00 RT (REFER TO DETAIL ON SHEET 6)

ANCHOR FOR STEEL BEAM RAIL
 STA. 6+54.5 RT
 STA. 6+67 RT
 STA. 6+87 LT
 STA. 7+07 LT

ALLEN IRISH RD
 TH #47
 MM 0.138
 STA. 7+30

STA. 7+07 LT ANCHOR
 FOR STEEL BEAM RAIL

CAMBRIDGE STA. 103+85.77
 FAIRFAX STA. 0+00.00

DURABLE 24 INCH STOP BAR (SEE OPTION ITEMS)
 STA. 6+95 - STA. 7+25 RT (TH #50)
 STA. 7+02 - STA. 7+31 LT (TH #47)
 DURABLE LETTER OR SYMBOL (SEE OPTION ITEMS)
 STA. 7+07 RT "STOP" (TH #50)
 STA. 7+22 LT "STOP" (TH #47)

CLEARY RD
 TH #50
 MM 0.132
 STA. 6+97

DURABLE 4 INCH YELLOW LINE (SEE OPTION ITEMS)
 STA. 102+25 - STA. 103+85.77 (SOLID LT & RT, CENTERLINE)
 STA. 0+00 - STA. 13+50 (SOLID LT & RT, CENTERLINE)
 (WITH BREAKS AT TOWN ROADS)
 STA. 6+97 RT (CENTERLINE TH #50)
 STA. 7+30 LT (CENTERLINE TH #47)

TEMPORARY 24 INCH STOP BAR, PAINT
 STA. 6+95 - STA. 7+25 RT (TH #50)
 STA. 7+02 - STA. 7+31 LT (TH #47)
 TEMPORARY LETTER OR SYMBOL, PAINT
 STA. 7+07 RT "STOP" (TH #50)
 STA. 7+22 LT "STOP" (TH #47)

- LEGEND
- MAILBOX
 - UTILITY POLE
 - HYDRANT
 - MANHOLE
 - WATER VALVE
 - CATCH BASIN / DROP INLET
 - SIGN

NOT TO SCALE

**PROJECT
 LAYOUT
 SHEET 4**

PROJECT NAME: CAMBRIDGE - FAIRFAX

PROJECT NUMBER: STP 2713(I)

FILE NAME: p07B182.dgn

PROJECT LEADER: CDL

DESIGNED BY: SJL

PLOT FILE: p07B182.22.t

PLOT DATE: 29-DEC-2014 13:46

DRAWN BY: SJL

CHECKED BY: EPD

SHEET 22 OF 36

DATUM
 VERTICAL N/A
 HORIZONTAL N/A

DURABLE 4 INCH WHITE LINE (SEE OPTION ITEMS)
 STA. 102+25 - STA. 103+85.77 (SOLID LT & RT)
 STA. 0+00 - STA. 13+50 (SOLID LT & RT)
 (WITH BREAKS AT TOWN ROADS)
 STA. 6+97 RT (EDGE LINES TH #50)
 STA. 7+30 LT (EDGE LINES TH #47)