

**LEGEND**

- [ ] = EXISTING SIGN
- R&S = REMOVE AND SALVAGE
- RET = RETAIN EXISTING SIGN OR POST
- EL = 4" WHITE EDGE LINE
- DYCL = 4" DOUBLE YELLOW CENTERLINE
- CL = 4" YELLOW CENTERLINE
- GORE = GORING

- DURABLE 4 INCH WHITE LINE, THERMOPLASTIC**  
 32+22.7 - 34+91.7 LT, 274 LF (EL)  
 32+22.7 - 34+91.7 RT, 267 LF (EL)  
 13+14.6 - 13+31.6 LT-RT, 126 LF (RESTORE SIX 9' X 18' PARKING STALLS)
- DURABLE 4 INCH YELLOW LINE, THERMOPLASTIC**  
 32+22.7 - 34+91.7 LT, 272 LF (DYCL)  
 32+22.7 - 34+91.7 LT, 260 LF (DYCL)  
 12+31.8 - 12+41.3 LT-RT, 20 LF (CL)

- DURABLE 6 INCH YELLOW LINE, THERMOPLASTIC**  
 32+47.7 - 34+91.7 LT-RT, 288 LF, (GORE)
- REMOVING SIGNS**  
 7 EACH
- ERECTING SALVAGED SIGNS**  
 7 EACH

**NOTES:**

1. FOR ADDITIONAL TEMPORARY PAVEMENT MARKINGS AND PAVEMENT MARKING MASK, SEE TRAFFIC CONTROL PLAN SHEETS
2. THE CONTRACTOR SHALL RESTORE ALL DISTURBED PAVEMENT MARKINGS TO THEIR PRECONSTRUCTION CONDITION OR AS DIRECTED BY THE ENGINEER

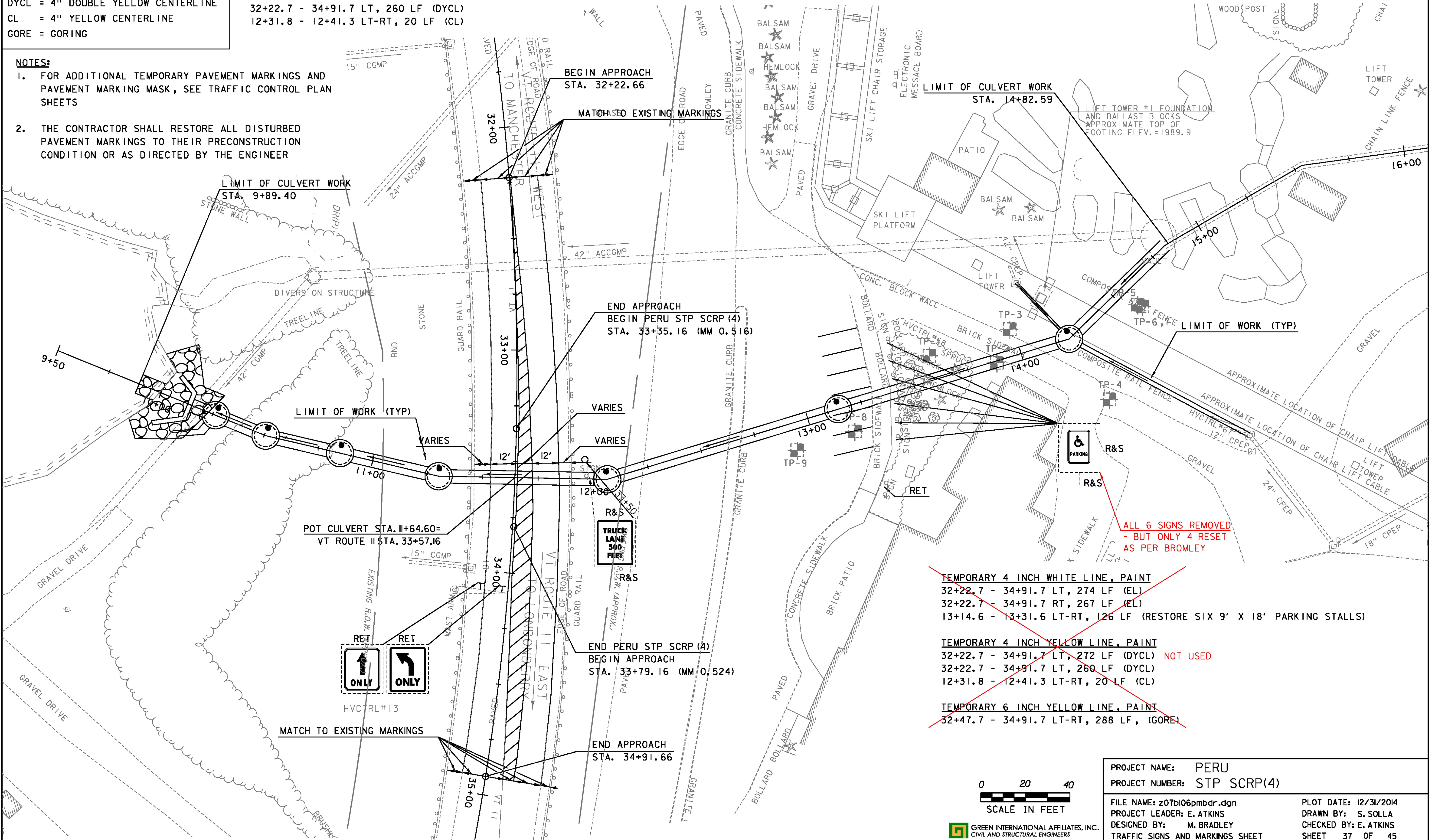

- ~~TEMPORARY 4 INCH WHITE LINE, PAINT~~  
 32+22.7 - 34+91.7 LT, 274 LF (EL)  
 32+22.7 - 34+91.7 RT, 267 LF (EL)  
 13+14.6 - 13+31.6 LT-RT, 126 LF (RESTORE SIX 9' X 18' PARKING STALLS)
- ~~TEMPORARY 4 INCH YELLOW LINE, PAINT~~  
 32+22.7 - 34+91.7 LT, 272 LF (DYCL) NOT USED  
 32+22.7 - 34+91.7 LT, 260 LF (DYCL)  
 12+31.8 - 12+41.3 LT-RT, 20 LF (CL)
- ~~TEMPORARY 6 INCH YELLOW LINE, PAINT~~  
 32+47.7 - 34+91.7 LT-RT, 288 LF, (GORE)

PROJECT NAME: PERU  
 PROJECT NUMBER: STP SCRP(4)

FILE NAME: z07b106pmbdr.dgn  
 PROJECT LEADER: E. ATKINS  
 DESIGNED BY: M. BRADLEY  
 TRAFFIC SIGNS AND MARKINGS SHEET

PLOT DATE: 12/31/2014  
 DRAWN BY: S. SOLLA  
 CHECKED BY: E. ATKINS  
 SHEET 37 OF 45

