

COLD PLANING, BITUMINOUS CONCRETE
 32+22.7 - 32+97.7
 34+16.7 - 34+91.66

TREATED TIMBER CURB
 32+97.7 LT - 34+16.7 LT

REMOVING AND RESETTING FENCE
 14+05.0 LT - 14+22.6 RT
 14+51.3 LT - 14+58.8 RT

REMOVE AND RESET GUARDRAIL **EXISTING RAIL WAS IN POOR CONDITION**
 32+94.6 RT - 34+19.6 RT
 32+94.6 LT - 34+19.6 LT

SPECIAL PROVISION (REMOVE AND RESET CONCRETE PAVERS)
 13+28.6 RT - 14+17.9 RT

AGGREGATE SHOULDERS, IN PLACE
 32+47.7 - 32+97.7
 34+16.7 - 34+66.7

REMOVING AND RESETTING CURB
 16+65.7 LT - 12+59.9 RT
 12+71.9 LT - 12+66.0 RT

STONE FILL, TYPE II
 9+64.4 LT - RT - 10+26.9 LT - RT

SPECIAL PROVISION (PORTLAND CEMENT CONCRETE ISLAND TREATMENT, 4 INCH)
 12+59.9 RT - 12+71.9 LT

SPECIAL PROVISION (LANDSCAPE AREA RESTORATION)
 13+35.5 RT - 13+97.3 RT

REHAB. DROP INLETS, CATCH BASINS, OR MANHOLES, CLASS II
 14+07.1 LT

CHAIN LINK FENCE, 4 FEET
 10+02.3 LT - 10+06.6

NOTES:

- SEE TRAFFIC SIGNS AND MARKINGS SHEET FOR PAVEMENT MARKING INFORMATION
- REFER TO LANDSCAPE PLAN SHEET FOR MORE INFORMATION
- THE WORK ADJACENT TO THE POND IS ANTICIPATED TO BE COMPLETED IN THE DRY WHEN THE POND IS DRAINED OR LOW. THE CONTRACTOR SHALL COORDINATE WITH BROMLEY SKI RESORT.
- CONTRACTOR SHALL LEAVE EXCAVATION SUPPORT IN PLACE AND BACKFILL USING CONTROLLED DENSITY (FLOWABLE) FILL, SEE DETAILS AND PIPE INSTALLATION NOTES

RETAIN EXISTING PIPE
 WEIR WALL ADDED TO STRUCTURE 1

- 9+92.7 LT - 14+82.6 LT
EXISTING 42" PCCSP - SPECIAL PROVISION (DECOMMISSION PIPE)
- 14+82.6 LT - 16+00.0 LT
EXISTING 42" PCCSP - RETAIN
- 11+26.2 RT - 11+45.5 RT
EXISTING 15" PCCSP - RETAIN PIPE
EXISTING DI @ 11+45.5 RT - PROTECT AND ADJUST STRUCTURE
- 14+22.6 LT - 14+50.6 RT
EXISTING 12" CPEP - REMOVE
EXISTING DI @ 14+50.6 RT - REMODEL
- 14+50.6 RT - 14+43.2 RT
EXISTING 24" CPEP - RETAIN
EXISTING DI @ 14+43.2 RT - RETAIN
- 10+45.5 RT - 9+50.0 RT
EXISTING 42" CGMP - REMOVE 20' OF EXISTING PIPE
- 14+07.1 LT - UNK
ABANDON EXISTING 12" CPEP - RETAIN EXISTING DI

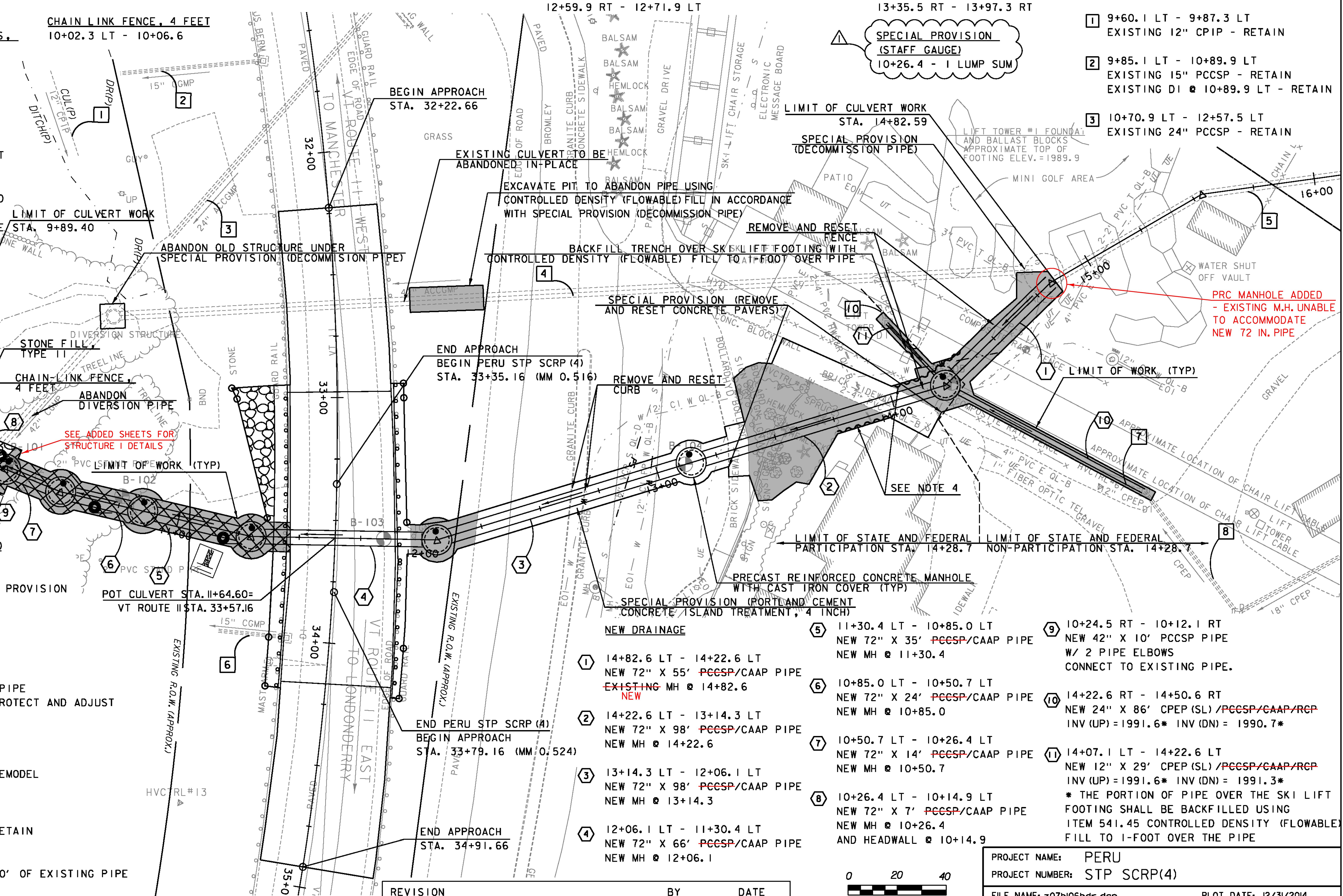

REVISION	BY	DATE
▲ ADDED CONSTRUCTION NOTE FOR SPECIAL PROVISION (STAFF GAUGE)	MAB	2/10/2015



SCALE IN FEET
 GREEN INTERNATIONAL AFFILIATES, INC.
 CIVIL AND STRUCTURAL ENGINEERS

PROJECT NAME: PERU
 PROJECT NUMBER: STP SCR(4)
 FILE NAME: z07b106bdr.dgn
 PLOT DATE: 12/31/2014
 DRAWN BY: M. BRADLEY
 DESIGNED BY: M. BRADLEY
 PLAN SHEET
 CHECKED BY: E. ATKINS
 SHEET 26 OF 45