

FOOTING PLAN
(BOTTOM REINFORCEMENT SHOWN, TOP SIMILAR)
SCALE 3/8" = 1'

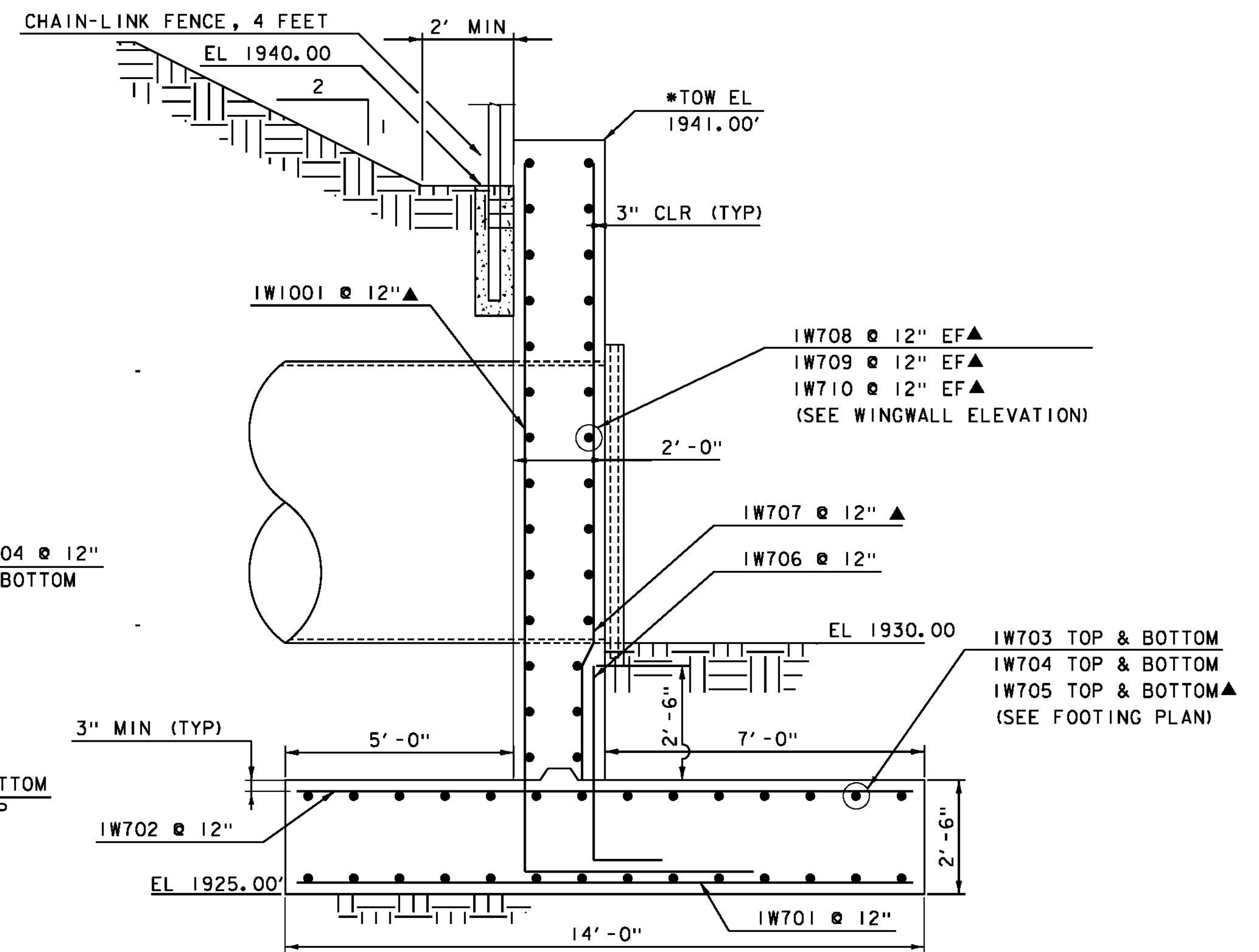

HEADWALL/WINGWALL SECTION
SCALE 1/2" = 1' *TOW = TOP OF WALL

WALL AND FOOTING REINFORCING DETAILS

| | |
|-----------------------------|------------------------|
| PROJECT NAME: PERU | PLOT DATE: 12/31/2014 |
| PROJECT NUMBER: STP SCRP(4) | DRAWN BY: M. BRADLEY |
| FILE NAME: z07b106det.dgn | CHECKED BY: B. KHALIFA |
| PROJECT LEADER: E. ATKINS | SHEET II OF 45 |
| DESIGNED BY: B. KHALIFA | |
| DETAIL SHEET 5 | |