

TEMPORARY 4 INCH WHITE LINE
STA. 9+07.23 - 17+37.18, RT.

PAVEMENT MARKING MASK
BEFORE CONSTRUCTION:
DOUBLE YELLOW LINE: 9+07.23 - 17+37.18, CL.

REMOVAL OF EXISTING PAVEMENT MARKINGS
AFTER CONSTRUCTION:
24 INCH STOP BAR: 9+07.23, RT.
17+37.18, LT.
TEMP 4" WHITE TAPE: 9+07.37 - 17+37.18, RT.



**STA. 10+47.23
BEGIN PROJECT
STP 030-2(22)
BEGIN TRANSITION**

**STA. 15+97.18
END TRANSITION
END PROJECT
STP 030-2(22)**

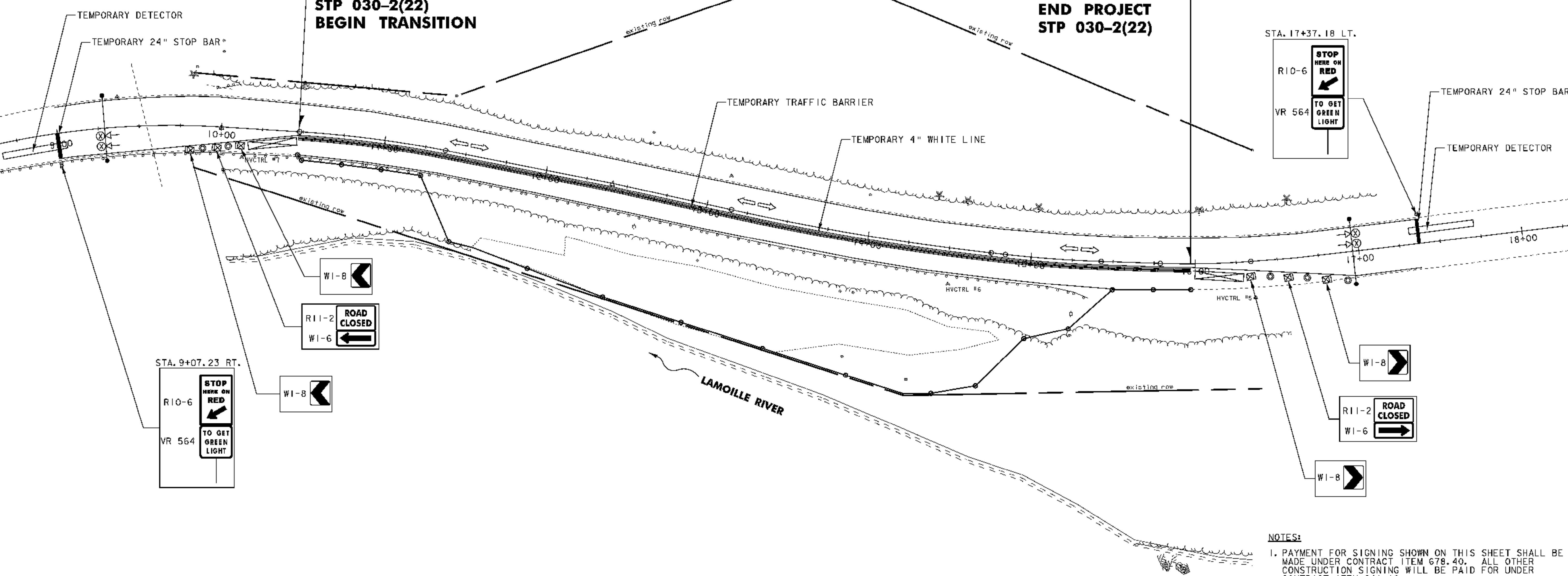

- LEGEND**
- SIGNAL POLES WITH SPAN WIRE
 - ⊗← TRAFFIC SIGNAL HEAD & PHASE
 - ⊞ SIGN AND POST
 - ▭ ENERGY ABSORPTION ATTENUATOR
 - ⇌ TRAFFIC DIRECTION

- NOTES:**
1. PAYMENT FOR SIGNING SHOWN ON THIS SHEET SHALL BE MADE UNDER CONTRACT ITEM 678.40. ALL OTHER CONSTRUCTION SIGNING WILL BE PAID FOR UNDER CONTRACT ITEM 641.10.
 2. PAYMENT FOR TEMPORARY DETECTORS WILL BE MADE UNDER CONTRACTOR ITEM 678.42.
 3. PAYMENT FOR ENERGY ABSORPTION ATTENUATORS WILL BE MADE UNDER CONTRACT ITEM 621.56. SEE VTRANS APPROVED PRODUCTS LISTING FOR A LIST OF SPECIFIC PRODUCT OPTIONS.

PROJECT NAME: WOLCOTT
PROJECT NUMBER: STP 030-2(22)
FILE NAME: d07b096+cl.dgn
PROJECT LEADER: JLS
DESIGNED BY: MBL
TRAFFIC CONTROL PLAN

PLOT DATE: 11-SEP-2007
DRAWN BY: MBL
CHECKED BY: SDM
SHEET 13 OF 22

