

ITEM 646.404 - DURABLE 4 INCH WHITE LINE, POLYUREA
 (ALL LINES WILL INCLUDE EDGE LINE BREAKS AND
 RADIUS FOR SIDE ROADS)
 STA. 112+50 TO 115+25, SOLID RT
 STA. 112+50 TO 115+94, SOLID LT
 STA. 115+25 TO 116+05, DOTTED LT
 STA. 116+02 TO 116+82, DOTTED LT
 STA. 116+05 TO 117+50, SOLID RT
 STA. 116+82 TO 117+50, SOLID LT

ITEM 646.414 - DURABLE 4 INCH YELLOW LINE, POLYUREA
 (ALL LINES WILL INCLUDE 1/2" BREAKS FOR SIDE ROADS)
 STA. 112+50 TO 117+50, SOLID LT & RT
 STA. 112+50 TO 117+50, DASHED LT & RT

ITEM 646.494 - DURABLE LETTER OR SYMBOL, POLYUREA
 STA. 113+65, LT, ARROW
 STA. 113+77, LT, HELMETED BICYCLIST
 STA. 114+48, LT, ARROW
 STA. 114+64, LT, ARROW
 STA. 115+76, LT, ARROW
 STA. 115+92, LT, ARROW

REMOVING SIGNS
 AS SHOWN - 1

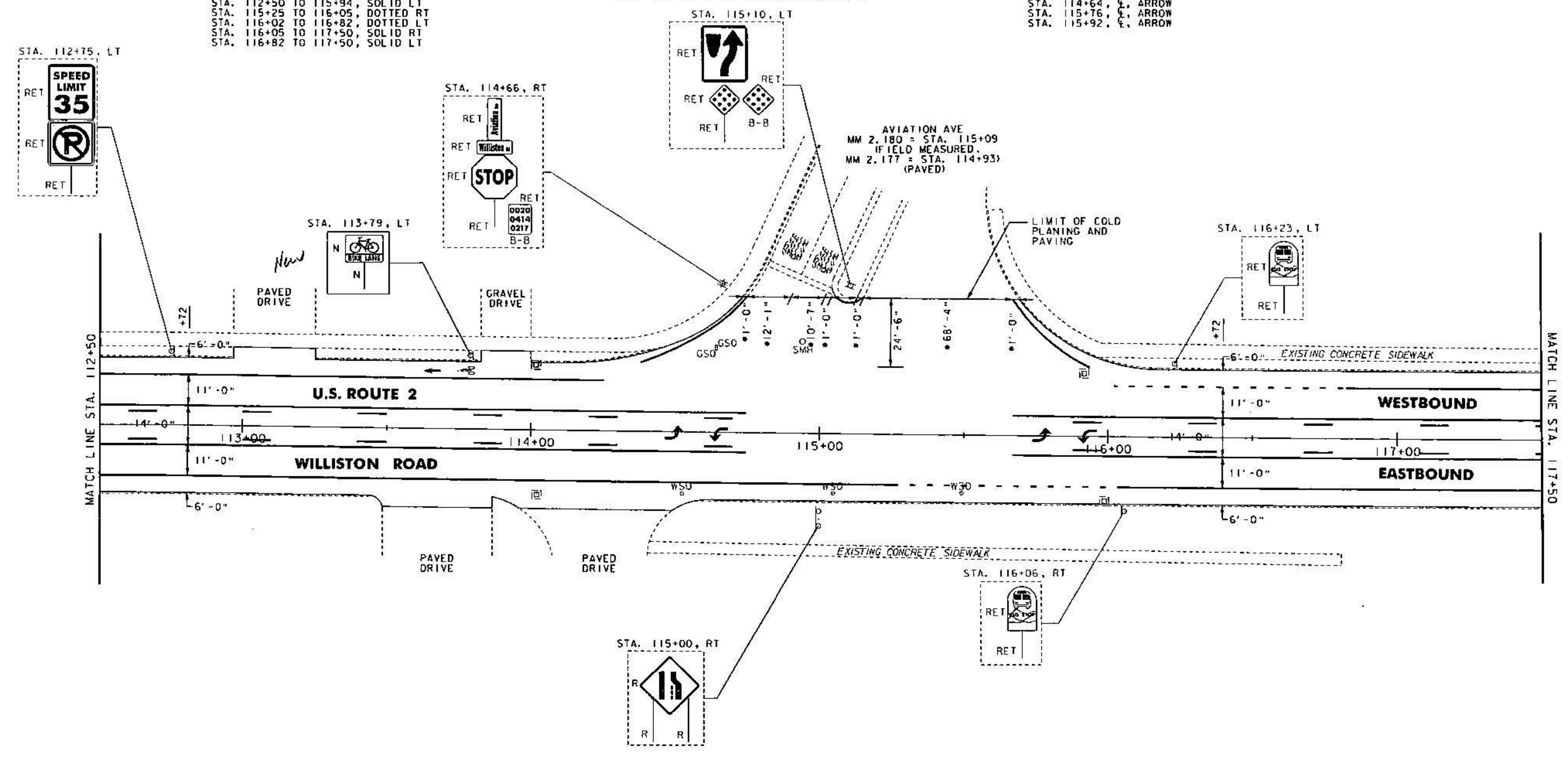

NOT TO SCALE

CHANGE ORDER SIGN - STRIPE SHEET #13	PROJECT NAME: BURLINGTON-SOUTH BURLINGTON	PLOT DATE: 09/19/12
	PROJECT NUMBER: NH 2624(1)	DRAWN BY: CDM
	FILE NAME: p06d216.dgn	CHECKED BY: RMC
	DESIGNED BY: CDM	SHEET 13 OF 18
	IPARM FILE: p06d216135.1	