

REHAB,  
Dis, CBs OR MHS, CLASS I, II OR III  
SEE SHEET 105

VERTICAL GRANITE CURB

STA. 59+31, RT  
STA. 59+88, RT

REMOVAL OF EXISTING CURB

STA. 59+31, RT  
STA. 59+88, RT

PORTLAND CEMENT CONCRETE SIDEWALK, 5 INCH

STA. 59+31, RT  
STA. 59+88, RT

DETECTABLE WARNING SURFACE

STA. 59+31, RT  
STA. 59+88, RT

ADJUST ELEVATION OF VALVE BOX  
SEE SHEET 105

DURABLE 4 INCH WHITE LINE, TYPE I TAPE  
(ALL LINES WILL INCLUDE EDGE LINE BREAKS  
AND RADII FOR SIDE ROADS)  
STA. 56+00 TO 60+00, SOLID LT & RT  
STA. 56+00 TO 60+00, DASHED LT & RT

DURABLE 4 INCH YELLOW LINE, TYPE I TAPE  
(ALL LINES WILL INCLUDE  $\phi$  BREAKS FOR SIDE ROADS)  
STA. 56+00 TO 60+00, SOLID LT & RT

DURABLE 24 INCH STOP BAR, TYPE I TAPE  
STA. 59+58, RT (HEATH ST.)

DURABLE LETTER OR SYMBOL, TYPE I TAPE  
STA. 59+58, RT (HEATH ST.) "STOP"

DURABLE CROSSWALK MARKING, TYPE I TAPE  
STA. 59+58, RT (HEATH ST.)

TEMPORARY 4 INCH WHITE LINE, PAINT  
(ALL LINES WILL INCLUDE EDGE LINE BREAKS  
AND RADII FOR SIDE ROADS)  
STA. 56+00 TO 60+00, SOLID LT & RT  
STA. 56+00 TO 60+00, DASHED LT & RT

TEMPORARY 4 INCH YELLOW LINE, PAINT  
(ALL LINES WILL INCLUDE  $\phi$  BREAKS FOR SIDE ROADS)  
STA. 56+00 TO 60+00, SOLID LT & RT

TEMPORARY 24 INCH STOP BAR, PAINT  
STA. 59+58, RT (HEATH ST.)

TEMPORARY LETTER OR SYMBOL, PAINT  
STA. 59+58, RT (HEATH ST.) "STOP"

TEMPORARY CROSSWALK MARKING, PAINT  
STA. 59+58, RT (HEATH ST.)

REMOVING SIGNS  
AS SHOWN - 12

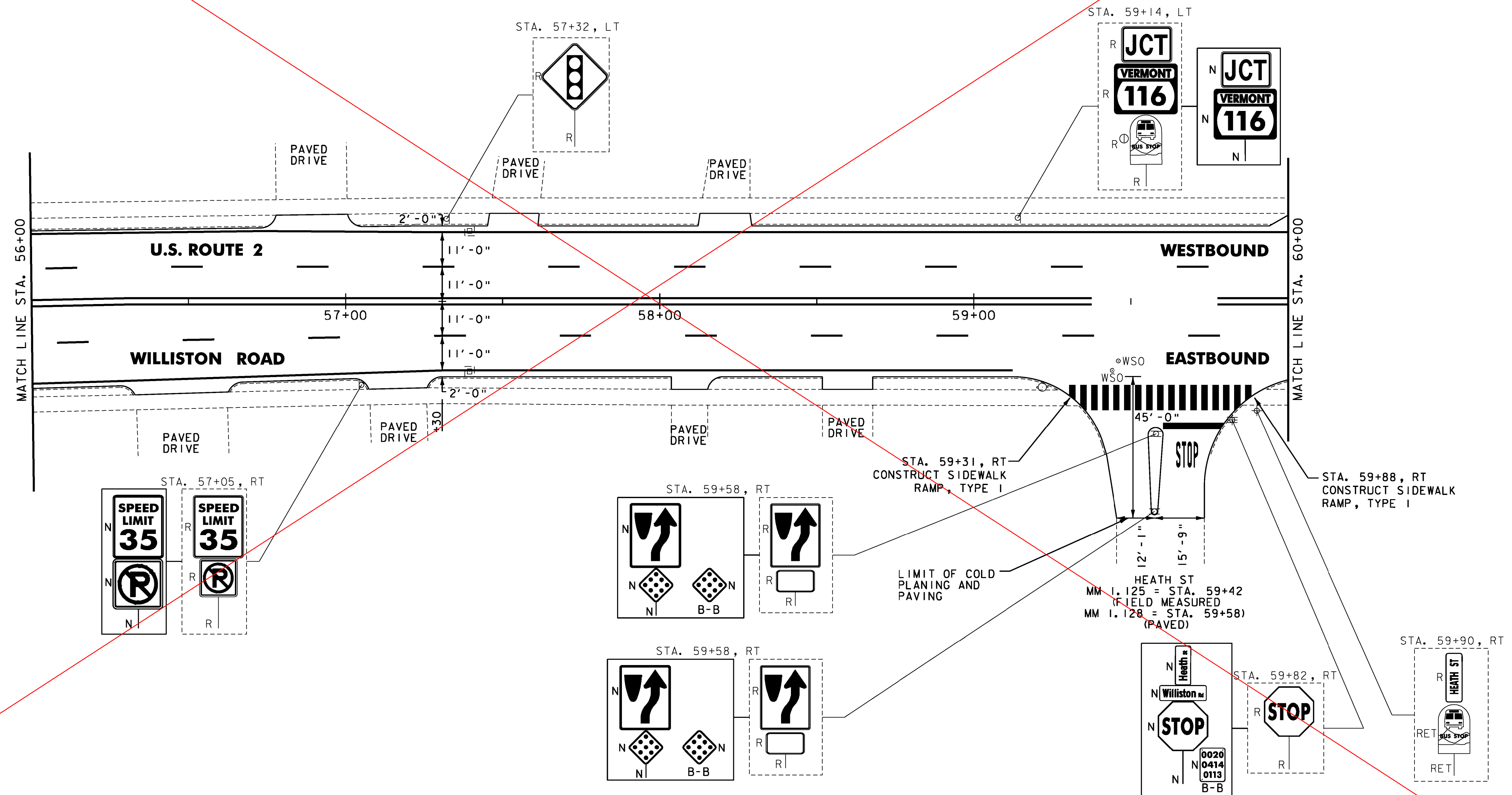

- NOTES:
- FOR LEGENDS, SEE SHEET 13.
  - ALL EXISTING SIGNS NOT SHOWN SHALL BE RETAINED.
  - THE SIDEWALK "LANDINGS" NOTED CONSIST OF THE REMOVAL AND REPLACEMENT OF A SINGLE SLAB OF CONCRETE SIDEWALK IN ORDER TO INSTALL A NEW DETECTABLE WARNING SURFACE.

NOT TO SCALE



**PROJECT LAYOUT SHEET #26**

PROJECT NAME: BURLINGTON-SOUTH BURLINGTON	PLOT DATE: 2/7/2012
PROJECT NUMBER: NH 2624(1)	DRAWN BY: STANTEC
FILE NAME: p06d216.dgn	CHECKED BY: STANTEC
DESIGNED BY: STANTEC	SHEET 40 OF 108
IPARM FILE: p06d216126.i	

SEE SHEET 40 A