

MAJOR EQUIPMENT LIST

EQUIPMENT ITEM NO. 678.15	US 5 (MAIN STREET) @ ELLIOT STREET
CANTILEVER POLES W/MAST ARMS	1
PEDESTAL POSTS	5
NEW 12" TRAFFIC SIGNAL HEADS W/ TUNNEL VISORS, DISCONNECT HANGERS, BACKPLATES AND MOUNTING HARDWARE	
ONE-WAY, 3-SECTION	3
ONE-WAY, 5-SECTION	1
ONE-WAY, 3-SECTION SIDE-MOUNTED - POLE	1
ONE-WAY, 5-SECTION PEDESTAL POST TOP-MOUNTED	1
PEDESTRIAN PUSHBUTTON ASSEMBLIES - PEDESTAL POST MOUNTED	5
ACCESSIBLE PEDESTRIAN SIGNAL	
PEDESTAL POST TOP MOUNTED, ONE-WAY	3
PEDESTAL POST TOP MOUNTED, TWO-WAY	1
PEDESTAL POST SIDE-MOUNTED, ONE-WAY	1
CONTROLLER/CABINET W/ MASTER EQUIPMENT	1
OPTICAL VEHICLE PREEMPTION SYSTEM	1
RADIO INTERCONNECT/VIDEO DETECTION SYSTEM	1
RAILROAD PREEMPTION SYSTEM	1
POWER DROP STANCHION	1
ILLUMINATED LED TRAFFIC SIGN	2

SIGNAL FACE ARRANGEMENT

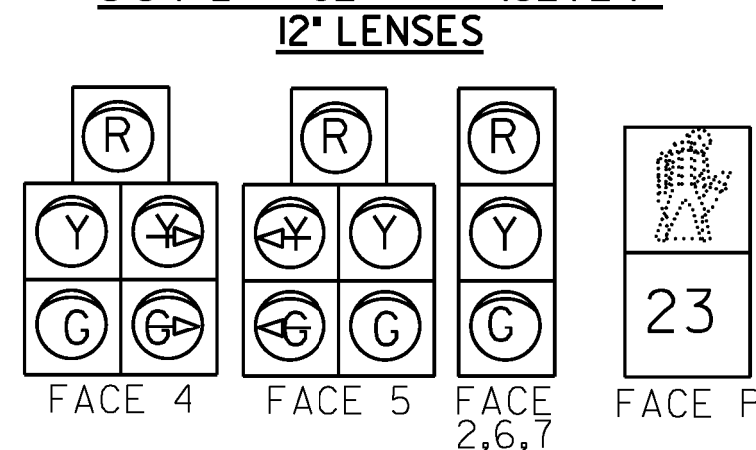

NOTE: INCLUDE BACKPLATE ALL SIGNAL FACES.

EQUIPMENT	ITEM NO.	UNIT	US 5 (MAIN STREET) @ ELLIOT STREET	NOTES
WIRED CONDUIT (2") (PVC)	678.23	LF	222'	-
WIRED CONDUIT (2 1/2") (PVC)	678.23	LF	68'	-
ELECTRICAL CONDUIT SLEEVE (8") (PVC)	678.30	LF	106'	-
PULL BOX - STANDARD	678.25	EA	3	-

THE QUANTITIES LISTED ABOVE ARE APPROXIMATE AND ARE FURNISHED FOR INFORMATION ONLY. MISCELLANEOUS (UNLISTED) WIRE, CABLE, HARDWARE ETC. ARE REQUIRED TO PROVIDE FOR A FUNCTIONING TRAFFIC SIGNAL SYSTEM. THE CONTRACTOR IS RESPONSIBLE FOR VERIFICATION OF THE NUMBER OF ITEMS AND THE TYPES OF EQUIPMENT REQUIRED.

NOTES:

1. OFFSET IS REFERENCED AT THE END OF PHASE 2.
2. SPLITS AND OFFSETS ARE SHOWN IN SECONDS.
3. VIDEO DETECTION AREAS 2, 4, 5, 6A, 6B AND 7 ARE IN NON-LOCK PRESENCE MODE.
4. SIGNAL TO COORDINATE WITH MAIN STREET SYSTEM WITH ALL OTHER LOCATIONS VIA SPREAD SPECTRUM RADIO. ELLIOT STREET IS MASTER LOCATION.
5. ANY PULL BOX OR JUNCTION BOX WITHIN SIDEWALK SHALL HAVE A SKID RESISTANT COVER.
6. SPREAD SPECTRUM RADIO ASSEMBLY TO SEND SIGNAL TO COORDINATE WITH 142/119, FLAT STREET AND ROUTE 9 (HIGH STREET). INSTALL TWO-WAY ANTENNA ON ON MP3A AND MASTER RADIO IN THE CONTROLLER CABINET. REMOTE RADIOS TO BE INSTALLED IN CABINETS AT 142/119, FLAT STREET AND HIGH STREET. INSTALL ANTENNAS ON AT THESE LOCATIONS.
7. RAILROAD PREEMPTION TO FORCE PHASE 2 AND HOLD UNTIL RELEASED. CABINET TO INCLUDE CONTACT CLOSURE RADIO TO COMMUNICATE WITH THE SIGNAL AT ROUTE 119 AND ROUTE 142.
8. SIGNAL TO INCLUDE VEHICLE IDENTIFYING OPTICAL PRE-EMPT. AND COMMUNICATION SYSTEM. THE SYSTEM INCLUDES AN OPTICAL SIGNAL PROCESSOR, 3 OPTICAL DETECTORS, RED STROBE LIGHT AND APPROX. 240 +/-' OF DETECTOR CABLE.

ILLUMINATED LED TRAFFIC SIGN



SIGN FACE LTS1, LTS2

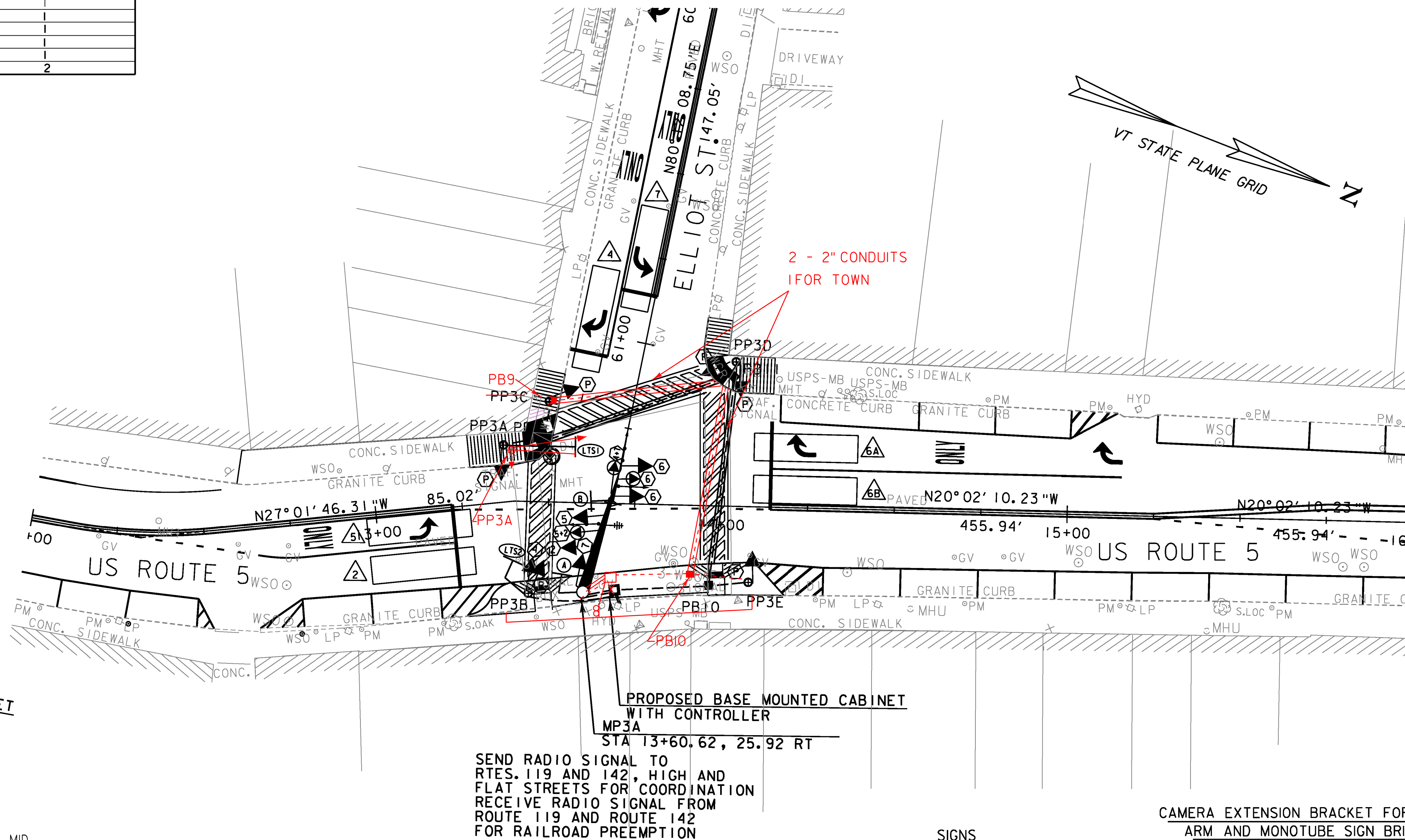

2025 HOURLY VOLUMES

ROUTE 5 - MAIN STREET 2025			ROUTE 5 - MAIN STREET 2025		
MID	PM	AM	AM	PM	MID
43	71	33	55	60	68
571	583	480	358	498	446

US 5 (MAIN STREET) @ ELLIOT STREET

ELECTRICAL CONDUIT SLEEVE (8") (PVC)	WIRED CONDUIT (2") (PVC)	WIRED CONDUIT (2") (PVC) (CONT.)	WIRED CONDUIT (2 1/2") (PVC)
PB9 TO PBII - 53' 42"	PB9 TO PBII - 60' 58"	PB9 TO PP3A - 14' 34"	CONTROLLER TO MP3A - 45' 16"
PBIO TO PBII - 53'	PBIO TO PBII - 64' 66"	PB9 TO PP3C - 13'	CONTROLLER TO MP3A - 45' 16"
		PBIO TO PP3E - 13' 15"	CONTROLLER TO PBIO - 38' 16"
		PBII TO PP3D - 8' 9"	

POWER STAN. CONTROLLER TO LIGHT POLE - 7' 37"
CONTROLLER TO POWER STANCHION - 7' 13"
CONTROLLER TO PP3B - 36' 33"

SEE SHEET 157 FOR MAST ARM CROSS SECTION
SEE SHEETS 26-66 FOR PAVEMENT MARKINGS
SEE SHEETS 136-140 FOR SIGNING LAYOUT
ALL SIGNALS WITHIN THE MAIN STREET SIGNAL SYSTEM ARE COORDINATED AND A PART OF THE WIRELESS RADIO INTERCONNECT.
SEE SHEETS 150, 151, 152 - TRAFFIC SIGNAL SHEETS NO. 1, 2 AND 4 FOR THE OTHER LOCATIONS.

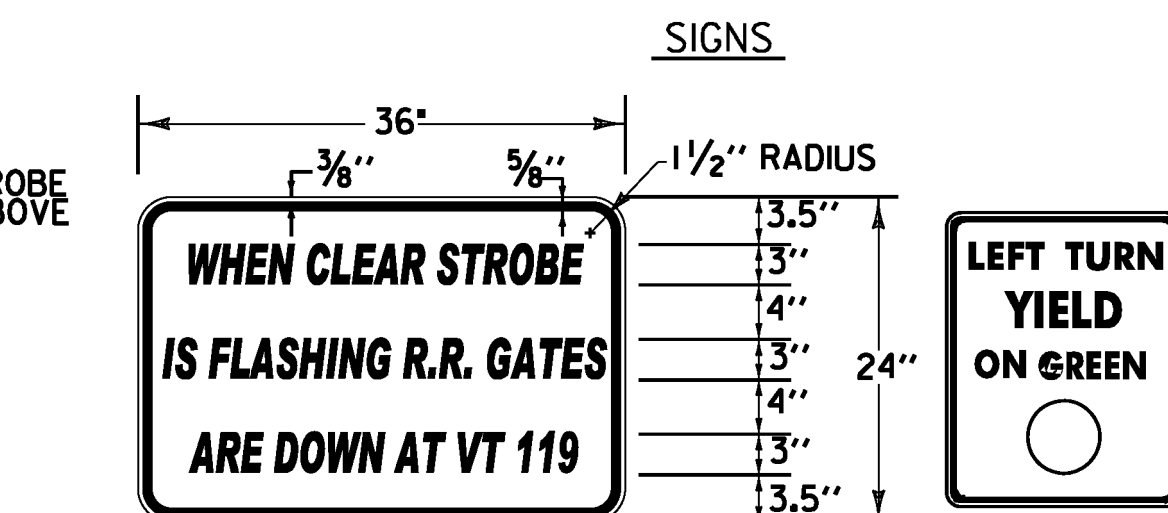

RAILROAD PREEMPTION SIGN DETAIL
MATERIALS: SEE STD. E-144
COLORS: TEXT & BORDER - BLACK
BACKGROUND - WHITE (REFL. ENCAPSULATED LENS)
NOT TO SCALE
NOTE: SEE SIGNING SHEETS FOR ALL OTHER SIGNS.

CAMERA EXTENSION BRACKET FOR MAST ARM AND MONOTUBE SIGN BRIDGE

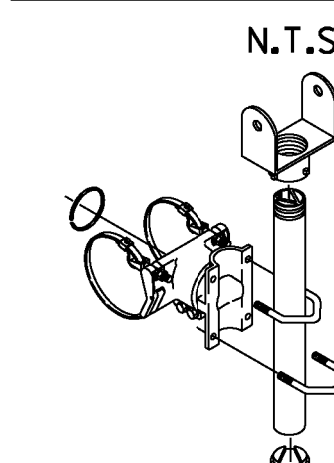

TWO PIECE CAMERA MOUNT
TUBE LENGTHS: 23", 37", 46", OR 74"
BAND LENGTHS: 29", 36", 42", 48", OR 56"
NOTES:
All assemblies shall have steel fasteners and stainless steel clamp screw kits.
For 2 piece bracket mounts shall be specified for camera type.

EXISTING	NEW	LEGEND
		MAST ARM POLE (MP)
		STRAIN POLE (SP)
		CONTROLLER CABINET
		PULL BOX (PB)/ JUNCTION BOX (JB)
		SIGNAL HEAD
		CONDUIT
		PEDESTAL POST (PP)
		MAST ARM MOUNTED SIGN
		STANCHION
		VIDEO DETECTOR
		VIDEO DETECTION AREA
		OPTICAL DETECTOR
		ILLUMINATED LED TRAFFIC SIGN

PROJECT NAME: BRATTLEBORO
PROJECT NUMBER: STP 2000(20)

FILE NAME: z08d044tr-fbdr.dgn
PLOT DATE: 6/27/2011
PROJECT LEADER: KEN UPMAL
DRAWN BY: T. BIGELOW
DESIGNED BY: V. KACOYANNAKIS
CHECKED BY: D. SPENCER
TRAFFIC SIGNAL SHEET 3
SHEET 152 OF 163