

LABEL	BEGIN		END		RADIUS (FT)	LENGTH (FT)
	STA.	OFFSET (FT)	STA.	OFFSET (FT)		
L9	US RTE. 5 SOUTH 10+70.49 LT	12.63	US RTE. 5 SOUTH 10+74.21 LT	12.60	NA	3.72
C9	US RTE. 5 SOUTH 10+74.21 LT	12.60	US RTE. 5 SOUTH 10+80.81 LT	15.02	15.04	7.09
C10	US RTE. 5 SOUTH 10+83.81 LT	17.65	US RTE. 5 SOUTH 10+87.14 LT	24.19	15.04	7.41
L10	US RTE. 5 SOUTH 10+87.14 LT	24.19	FLAT ST. 51+40.66 RT	18.62	NA	5.90
L11	US RTE. 5 SOUTH 10+75.79 RT	20.84	US RTE. 5 SOUTH 10+81.79 RT	20.75	NA	6.00
L12	US RTE. 5 SOUTH 10+85.79 RT	20.69	US RTE. 5 SOUTH 10+91.77 RT	20.60	NA	5.98
L13	US RTE. 5 SOUTH 11+16.82 RT	20.89	US RTE. 5 SOUTH 11+22.86 RT	21.14	NA	6.05
L14	US RTE. 5 SOUTH 11+26.86 RT	21.29	US RTE. 5 SOUTH 11+32.91 RT	21.54	NA	6.05
C11	FLAT ST. 51+39.54 LT	18.10	FLAT ST. 51+45.22 LT	20.02	8.36	6.13
C12	US RTE. 5 SOUTH 11+28.49 LT	16.26	US RTE. 5 SOUTH 11+32.89 LT	14.99	8.36	4.65
L15	US RTE. 5 SOUTH 11+32.89 LT	14.99	US RTE. 5 SOUTH 11+35.20 LT	14.72	NA	2.32
L16	US RTE. 5 SOUTH 11+35.20 LT	14.72	US RTE. 5 SOUTH 11+44.13 LT	15.06	NA	8.94
L17	US RTE. 5 SOUTH 12+60.83 LT	12.80	US RTE. 5 SOUTH 13+42.72 LT	13.21	NA	83.47

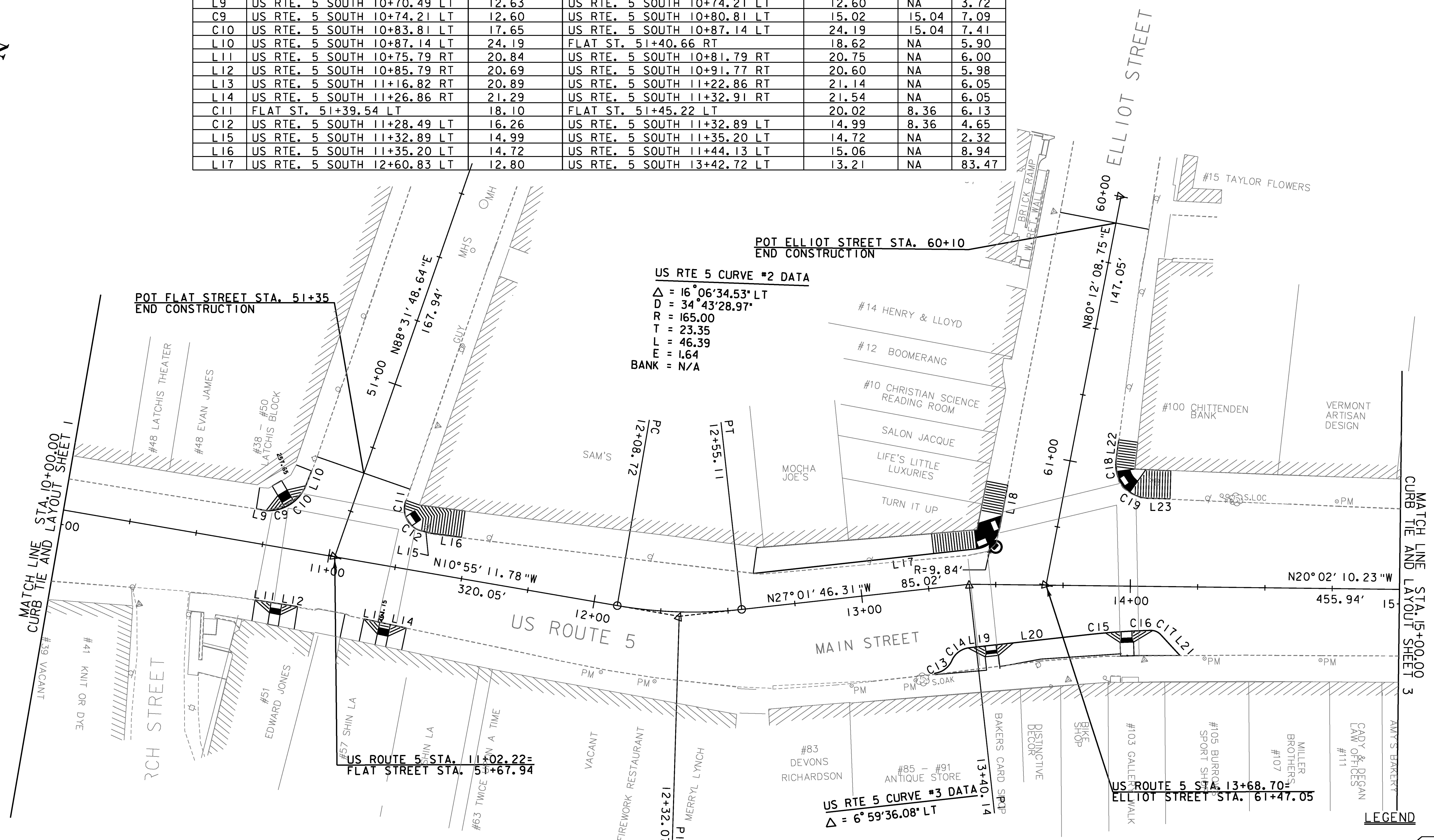

US RTE 5 CURVE #2 DATA
 $\Delta = 16^\circ 06' 34.53''$ LT
 $D = 34^\circ 43' 28.97''$
 $R = 165.00$
 $T = 23.35$
 $L = 46.39$
 $E = 1.64$
 $BANK = N/A$

US RTE 5 CURVE #3 DATA
 $\Delta = 6^\circ 59' 36.08''$ LT

LABEL	BEGIN		END		RADIUS (FT)	LENGTH (FT)
	STA.	OFFSET (FT)	STA.	OFFSET (FT)		
L18	ELLIOT ST. 61+24.80 RT	21.00	ELLIOT ST. 61+13.29 RT	21.02	NA	11.51
C13	US RTE. 5 SOUTH 13+23.69 RT	31.46	US RTE. 5 SOUTH 13+30.63 RT	27.46	8.01	8.38
C14	US RTE. 5 SOUTH 13+30.63 RT	27.46	US RTE. 5 SOUTH 13+37.56 RT	23.46	8.01	8.38
L19	US RTE. 5 SOUTH 13+37.56 RT	23.46	US RTE. 5 SOUTH 13+46.40 RT	22.87	NA	6.01
L20	US RTE. 5 SOUTH 13+50.37 RT	22.38	US RTE. 5 SOUTH 13+84.29 RT	18.22	NA	34.18
C15	US RTE. 5 SOUTH 13+84.29 RT	18.22	US RTE. 5 SOUTH 13+96.77 RT	16.97	282.15	12.55
C16	US RTE. 5 SOUTH 14+00.76 RT	16.69	US RTE. 5 SOUTH 14+07.69 RT	16.34	282.15	9.22
C17	US RTE. 5 SOUTH 14+07.69 RT	16.34	US RTE. 5 SOUTH 14+11.52 RT	17.90	5.00	4.27
L21	US RTE. 5 SOUTH 14+11.52 RT	17.90	US RTE. 5 SOUTH 14+18.69 RT	25.49	NA	10.44
L22	ELLIOT ST. 60+88.88 LT	16.30	ELLIOT ST. 60+96.59 LT	16.76	NA	7.73
C18	ELLIOT ST. 60+96.59 LT	16.76	ELLIOT ST. 61+00.61 LT	17.67	12.45	4.14
C19	US RTE. 5 SOUTH 13+99.41 LT	34.97	US RTE. 5 SOUTH 14+06.32 LT	32.74	12.45	7.37
L23	US RTE. 5 SOUTH 14+06.32 LT	32.74	US RTE. 5 SOUTH 14+13.68 LT	32.63	NA	7.35

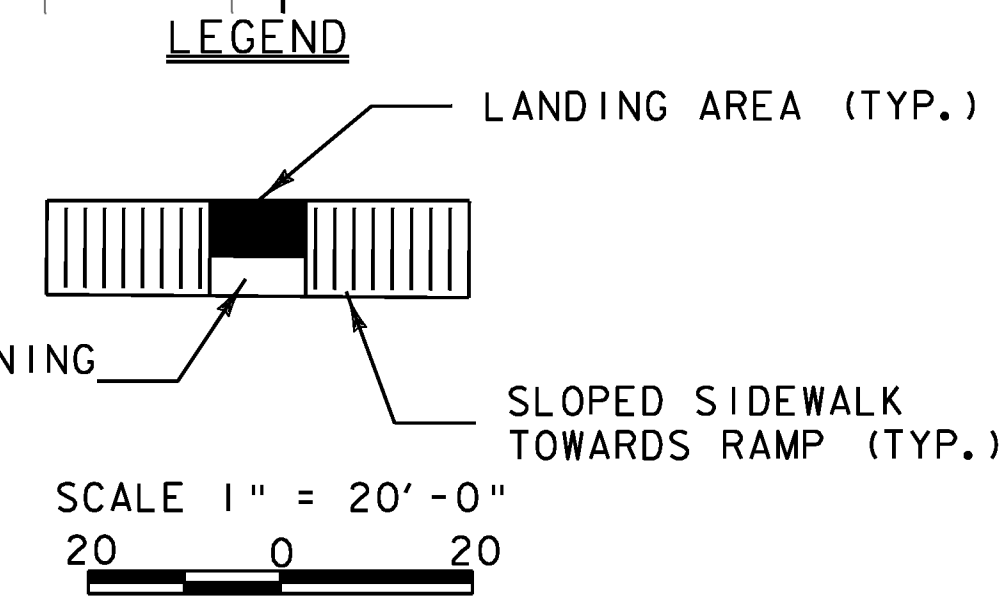

PROJECT NAME: BRATTLEBORO
PROJECT NUMBER: STP 2000(24)
FILE NAME: z08d044curbbdr.dgn
DESIGNED BY: B. SABEAN
CURB TIE AND LAYOUT SHEET 2
PLOT DATE: 4/8/2010
DRAWN BY: A. ACHARYA
CHECKED BY: V. KACOYANNAKIS
SHEET 98 OF 163