

TEMPORARY 4" WHITE LINE, PAINT
 DURABLE 4" WHITE LINE, RECESSED POLYUREA
 233+00 TO 233+66 SOLID CL (LANE LINE)
 233+74 TO 234+55 SOLID LT (LANE LINE)
 234+55 TO 236+00 DASHED LT (LANE LINE)

TEMPORARY 4" WHITE LINE, PAINT
 DURABLE 4" WHITE LINE, THERMOPLASTIC
 233+00 TO 233+63 SOLID LT (PARKING)
 233+78 TO 234+60 SOLID LT (PARKING)
 234+75 TO 234+80 SOLID LT (NO PARKING)
 234+80 TO 235+01 SOLID LT (PARKING)
 235+18 TO 236+18 SOLID LT (PARKING)

TEMPORARY 4" YELLOW LINE, PAINT
 DURABLE 4" YELLOW LINE, THERMOPLASTIC
 233+00 TO 233+65 SOLID RT
 233+73 TO 235+07 SOLID RT
 235+15 TO 236+00 SOLID RT

TEMPORARY LETTER OR SYMBOL, PAINT
 233+36 LT - THRU/RIGHT ARROW
 233+36 RT - LEFT ARROW
 234+11 LT - THRU/RIGHT ARROW
 234+94 LT - THRU/RIGHT ARROW
 234+94 RT - LEFT ARROW

DURABLE LETTER OR SYMBOL, THERMOPLASTIC
 233+36 LT - THRU/RIGHT ARROW
 233+36 RT - LEFT ARROW
 234+11 LT - THRU/RIGHT ARROW
 234+11 RT - ONLY
 234+94 LT - THRU/RIGHT ARROW
 234+94 RT - LEFT ARROW

TEMPORARY CROSSWALK MARKING, PAINT
 DURABLE CROSSWALK MARKING, THERMOPLASTIC
 233+69 TO 233+71 RT TO LT
 235+11 RT TO LT

PORTLAND CEMENT CONCRETE SIDEWALK, 5 INCH
 233+66 TO 233+73 RT (LANDING)
 233+68 TO 233+73 LT (LANDING)
 235+08 TO 235+15 LT (LANDING)
 235+09 TO 235+14 RT (LANDING)

DETECTABLE WARNING
 SURFACE (DWS)
 233+70 RT
 233+71 LT
 235+11 RT
 235+11 LT

REHAB. DROP INLETS, CATCH BASINS,
 OR MANHOLES, CLASS I, II, OR III
 233+12 RT (CB)
 233+13 LT (CB)
 234+74 LT (CB)
 234+75 RT (CB)
 235+65 RT (CB)

THINNING AND TRIMMING FOR SIGNS
 233+63 RT

REMOVING SIGNS
 AS SHOWN - 4

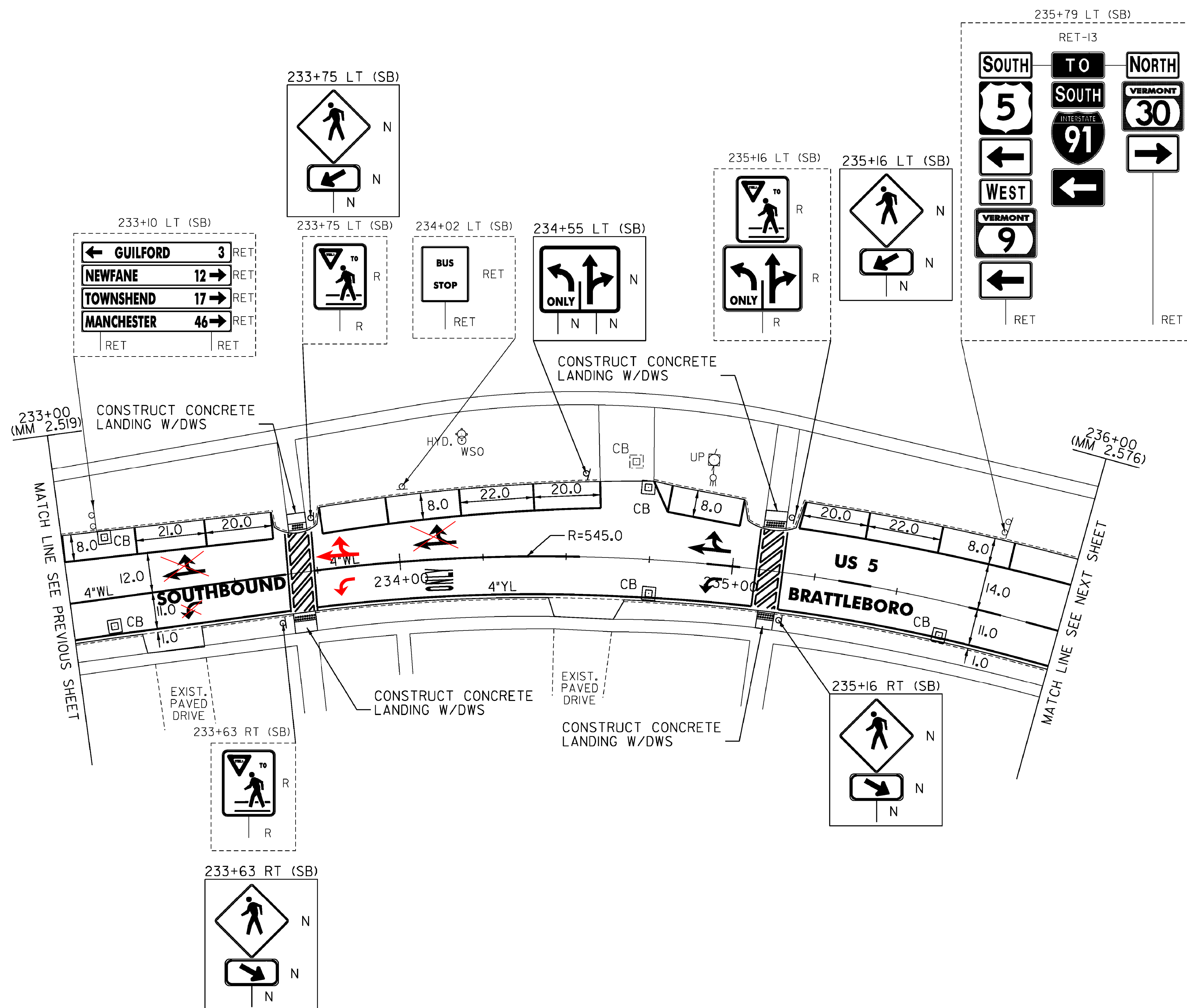

LEGEND

- R = REMOVE EXISTING
- S = SALVAGE
- R&S = REMOVE AND SALVAGE
- N = NEW
- RET = RETAIN
- B-B = BACK TO BACK
- = EXISTING GUARDRAIL
- = PROPOSED GUARDRAIL
- YL = YELLOW LINE
- WL = WHITE LINE

ROADWAY LAYOUT 20 US 5

PROJECT NAME:	BRATTLEBORO
PROJECT NUMBER:	STP 2623(I)
FILE NAME:	/pave/06d214/pd214
DESIGNED BY:	NULL
IPARM FILE NAME:	06D214_46
PLOT DATE:	3/19/2010
DRAWN BY:	MRS
CHECKED BY:	PTS
SHEET	46 OF 163

NOT TO SCALE

MODEL: Default
 CLD_08-0324_z06D0214.dgn