

TEMPORARY 4" WHITE LINE, PAINT  
 DURABLE 4" WHITE LINE, RECESSED POLYUREA  
 110+50 TO A 7+81 SOLID RT  
 110+50 TO A 7+90 LT  
 110+50 TO 110+76 LT (LANE LINE)  
 110+80 TO A 7+82 RT SOLID (LANE LINE)  
 A 9+08 TO A 9+76 SOLID CL (LANE LINE)  
 A 9+76 TO A 10+00 DOTTED CL (LANE LINE)  
 A 9+77 TO A 10+00 DOTTED RT (LANE LINE)

TEMPORARY 4" WHITE LINE, PAINT  
 DURABLE 4" WHITE LINE, THERMOPLASTIC  
 VT 142  
 113+00 TO 113+43 SOLID RT (LANE LINE)  
 113+00 TO 113+52 SOLID LT  
 113+00 TO 113+43 SOLID RT  
 VT 119  
 41+34 TO 42+00 SOLID RT  
 41+54 TO 42+00 SOLID LT (LANE LINE)  
 41+54 TO 42+00 SOLID LT

TEMPORARY 4" YELLOW LINE, PAINT  
 DURABLE 4" YELLOW LINE, RECESSED POLYUREA  
 110+50 TO A 7+83 SOLID LT & RT  
 A 9+08 TO A 10+00 DOUBLE SOLID RT

TEMPORARY 4" YELLOW LINE, PAINT  
 DURABLE 4" YELLOW LINE, THERMOPLASTIC  
 A 8+19 TO A 8+22 DOUBLE SOLID LT (EXIST. DRIVE)  
 VT 142  
 113+00 TO 113+43 SOLID LT & RT  
 VT 119  
 41+54 TO 42+00 SOLID LT & RT

TEMPORARY CROSSWALK MARKING, PAINT  
 DURABLE CROSSWALK MARKING, THERMOPLASTIC  
 A 7+90 TO A 7+96 RT TO LT  
 A 8+02 TO A 8+49 LT  
 A 8+89 TO A 9+06 LT TO RT  
 VT 142  
 113+51 TO 113+57 RT TO LT

TEMPORARY LETTER OR SYMBOL, PAINT  
 110+72 LT - THRU ARROW  
 A 7+70 RT - LEFT/THRU ARROW  
 A 7+75 RT - RIGHT TURN ARROW  
 A 9+17 RT - LEFT TURN ARROW  
 VT 142  
 113+35 RT - RIGHT TURN ARROW  
 VT 119  
 41+62 LT - RIGHT TURN ARROW  
 41+66 LT - THRU/LEFT ARROW

DURABLE LETTER OR SYMBOL, THERMOPLASTIC  
 110+72 LT - THRU ARROW  
 110+72 LT - ONLY  
 110+84 RT - ONLY  
 A 7+70 RT - LEFT/THRU ARROW  
 A 7+75 RT - RIGHT TURN ARROW  
 A 9+17 RT - LEFT TURN ARROW  
 A 9+72 RT - ONLY  
 VT 142  
 113+35 RT - RIGHT TURN ARROW  
 VT 119  
 41+62 LT - RIGHT TURN ARROW  
 41+66 LT - THRU/LEFT ARROW

TEMPORARY 24" STOP BAR, PAINT  
 DURABLE 24" STOP BAR, RECESSED TYPE I TAPE  
 A 7+81 TO A 7+83 RT  
 A 7+99 TO A 8+23 LT  
 A 9+08 LT TO RT  
 VT 142  
 113+43 RT  
 VT 119  
 41+53 LT

TEMPORARY RAILROAD CROSSING SYMBOL, PAINT  
 DURABLE RAILROAD CROSSING SYMBOL, THERMOPLASTIC  
 41+91 RT

CHANGING ELEVATION OF DROP INLETS,  
 CATCH BASINS, OR MANHOLES  
 A 8+79 LT (DMH)

CHANGING ELEVATION OF DROP INLETS,  
 CATCH BASINS, OR MANHOLES  
 (TO BE ADJUSTED BY OWNER)  
 A 8+45 LT (TMH)  
 A 8+63 LT (TMH)  
 VT 119  
 41+11 RT (TMH)

REHAB. DROP INLETS, CATCH BASINS,  
 OR MANHOLES, CLASS I, II, OR III  
 A 7+70 LT (CB)  
 A 8+11 RT (CB) (STP 2000(24))  
 A 8+75 LT (CB)  
 A 9+63 LT (CB)  
 A 9+73 RT (CB)  
 VT 142  
 113+62 RT (CB) (STP 2000(24))  
 113+81 LT (CB) (STP 2000(24))  
 VT 119  
 41+33 RT (CB)  
 41+88 LT (CB)

CHANGING ELEVATION  
 OF SEWER MANHOLES  
 A 7+50 RT  
 A 9+62 RT  
 VT 119  
 40+88 LT

ADJUST ELEVATION  
 OF VALVE BOX  
 A 8+56 RT  
 A 8+79 RT  
 A 8+94 RT  
 A 9+64 RT  
 A 9+73 RT  
 A 9+81 RT  
 A 9+82 RT  
 VT 119  
 40+97 RT

REMOVING SIGNS  
 AS SHOWN - 2

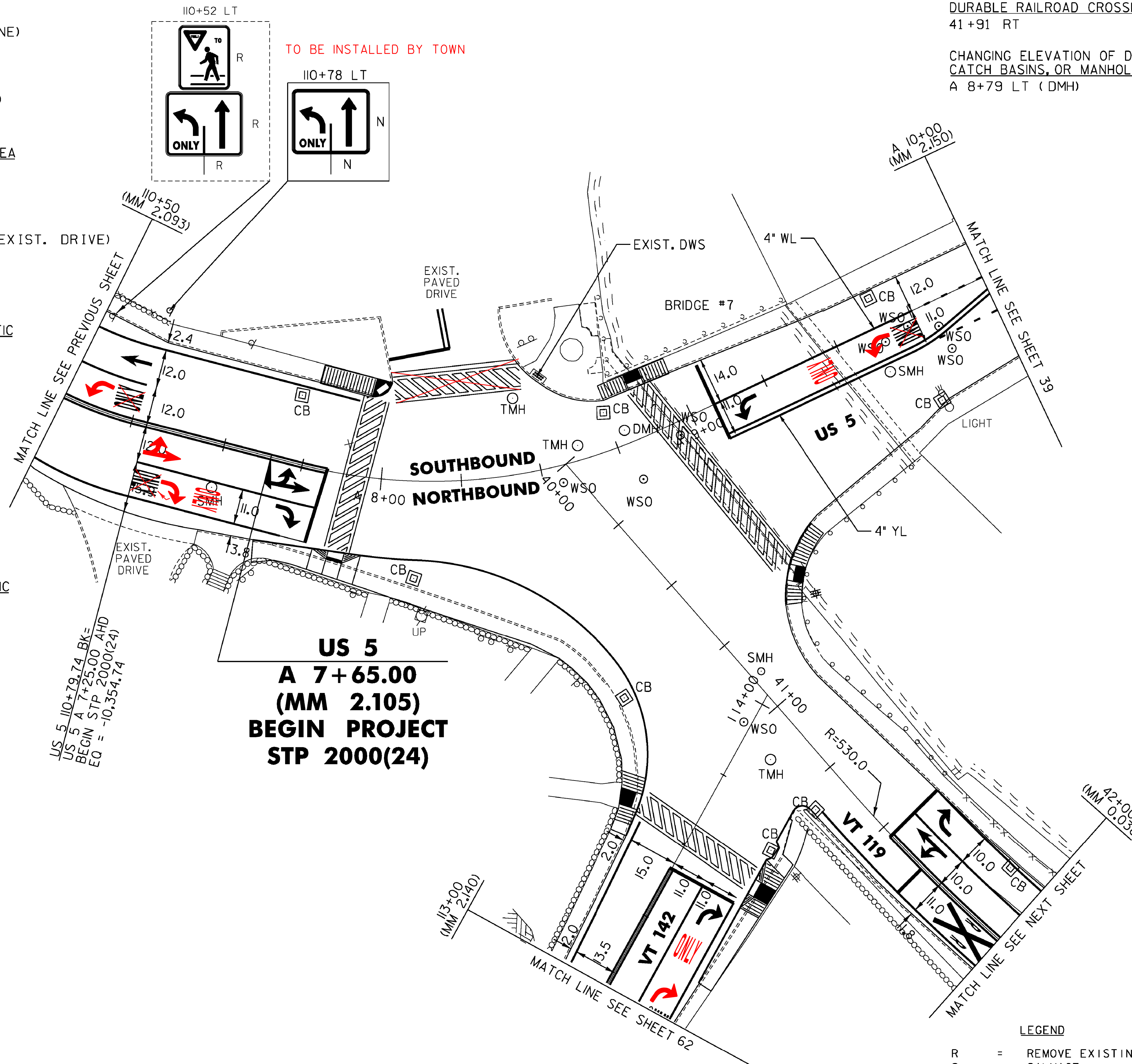

TO BE INSTALLED BY TOWN

SEE STP 2000(24) FOR SIGNING BETWEEN  
 STA A 7+25 TO 128+25 ON US 5,  
 ON VT 119, AND BETWEEN STA 113+00 TO  
 114+00 ON VT 142.

LEGEND

- R = REMOVE EXISTING
- S = SALVAGE
- R&S = REMOVE AND SALVAGE
- N = NEW
- RET = RETAIN
- B-B = BACK TO BACK
- = EXISTING GUARDRAIL
- o-o = PROPOSED GUARDRAIL
- YL = YELLOW LINE
- WL = WHITE LINE

ROADWAY LAYOUT 12 US 5

PROJECT NAME: BRATTLEBORO	
PROJECT NUMBER: STP 2623(I)	
FILE NAME: /pave/06d214/pd214	PLOT DATE: 3/19/2010
PROJECT LEADER: PTS	DRAWN BY: MRS
DESIGNED BY: NLL	CHECKED BY: PTS
IPARM FILE NAME: 06D214_37	SHEET 37 OF 163

NOT TO SCALE

MODEL: Default  
 CLD\_08-0324\_Z06D0214.dgn