

TEMPORARY 4" WHITE LINE, PAINT
 DURABLE 4" WHITE LINE, RECESSED POLYUREA
 84+00 TO 87+54 SOLID LT
 84+00 TO 87+74 SOLID RT
 85+00 TO 86+30 DOTTED RT (LANE LINE)
 86+30 TO 87+55 SOLID RT (LANE LINE)
 88+04 TO 89+50 SOLID LT
 88+11 TO 89+16 SOLID LT (LANE LINE)
 88+25 TO 89+50 SOLID RT
 89+16 TO 89+50 DOTTED LT (LANE LINE)

TEMPORARY 4" WHITE LINE, PAINT
 DURABLE 4" WHITE LINE, THERMOPLASTIC
 87+56 TO 87+60 SOLID LT (TH 428)
 87+83 TO 87+98 SOLID RT (TH 486)
 87+88 TO 87+89 SOLID LT (TH 428)
 88+16 TO 88+21 SOLID RT (TH 486)

TEMPORARY 4" YELLOW LINE, PAINT
 DURABLE 4" YELLOW LINE, RECESSED POLYUREA
 84+00 TO 87+55 DOUBLE SOLID LT
 84+00 TO 86+29 DOUBLE SOLID RT
 88+17 TO 89+50 DOUBLE SOLID RT

TEMPORARY 4" YELLOW LINE, PAINT
 DURABLE 4" YELLOW LINE, THERMOPLASTIC
 87+75 DOUBLE SOLID LT (TH 428)
 88+05 DOUBLE SOLID RT (TH 486)

TEMPORARY CROSSWALK MARKING, PAINT
 DURABLE CROSSWALK MARKING, THERMOPLASTIC
 87+58 TO 87+91 LT
 87+80 TO 88+20 RT
 87+98 TO 88+20 LT TO RT
 87+50 TO 87+13 LT TO RT
 TEMPORARY 24" STOP BAR, PAINT
 DURABLE 24" STOP BAR, RECESSED TYPE I TAPE
 87+58 TO 87+75 LT (TH 428)
 88+06 TO 88+17 RT (TH 486)

TEMPORARY LETTER OR SYMBOL, PAINT
 86+34 RT - LEFT TURN ARROW
 87+51 RT - LEFT TURN ARROW
 87+66 LT - STOP (TH 428)
 88+13 RT - STOP (TH 486)
 88+26 CL - LEFT TURN ARROW
 89+13 CL - LEFT TURN ARROW

DURABLE LETTER OR SYMBOL, THERMOPLASTIC
 86+34 RT - LEFT TURN ARROW
 86+93 RT - ONLY
 87+51 RT - LEFT TURN ARROW
 87+66 LT - STOP (TH 428)
 88+13 RT - STOP (TH 486)
 88+26 CL - LEFT TURN ARROW
 88+70 CL - ONLY
 89+13 CL - LEFT TURN ARROW

CHANGING ELEVATION OF DROP INLETS,
 CATCH BASINS, OR MANHOLES
 86+56 RT (MH)
 87+66 LT (DMH)

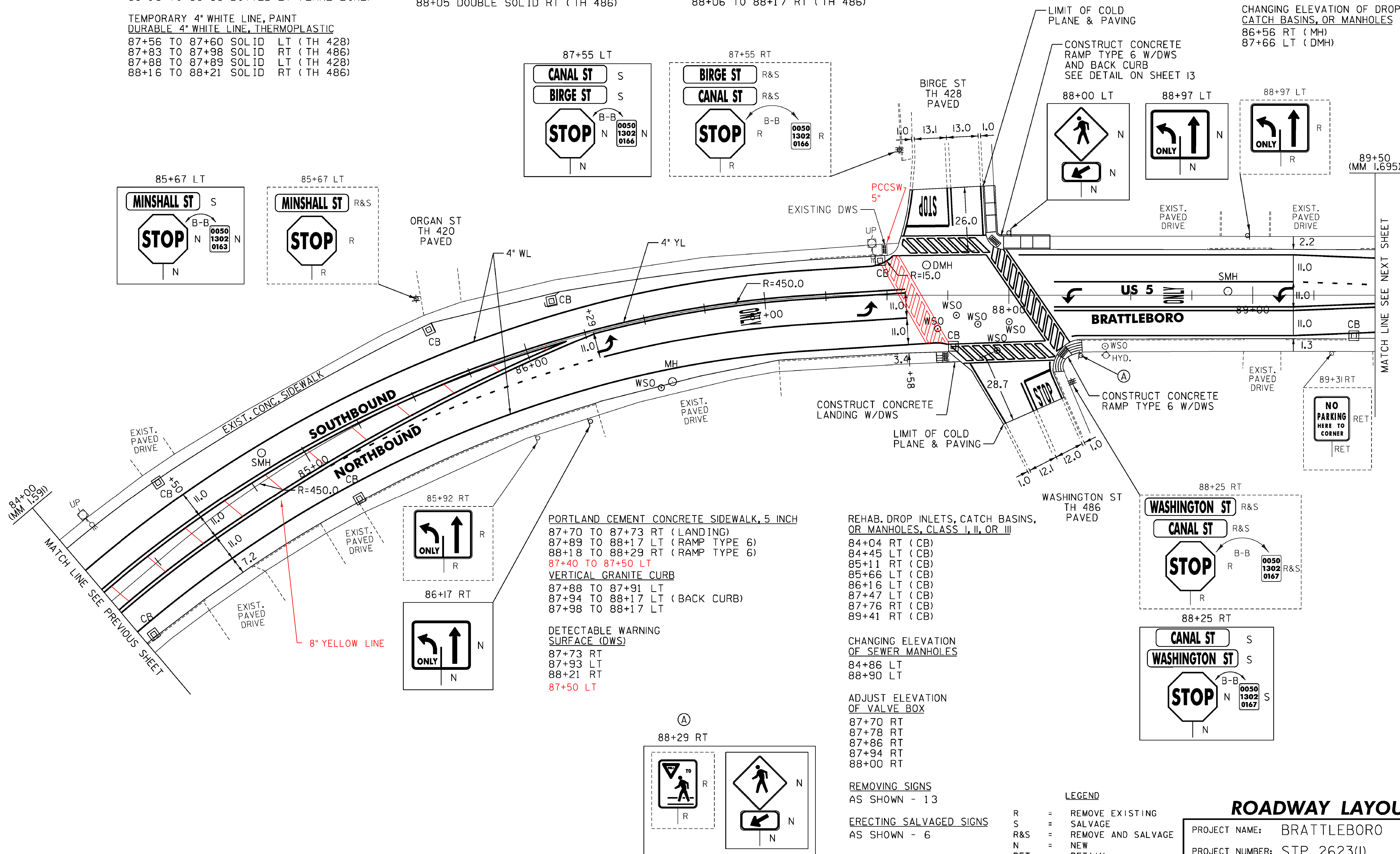

PORTLAND CEMENT CONCRETE SIDEWALK, 5 INCH
 87+70 TO 87+73 RT (LANDING)
 87+89 TO 88+17 LT (RAMP TYPE 6)
 88+18 TO 88+29 RT (RAMP TYPE 6)
 87+40 TO 87+50 LT
 VERTICAL GRANITE CURB
 87+88 TO 87+91 LT
 87+94 TO 88+17 LT (BACK CURB)
 87+98 TO 88+17 LT

DETECTABLE WARNING SURFACE (DWS)
 87+73 RT
 87+93 LT
 88+21 RT
 87+50 LT

REHAB. DROP INLETS, CATCH BASINS,
 OR MANHOLES, CLASS I, II, OR III
 84+04 RT (CB)
 84+45 LT (CB)
 85+11 RT (CB)
 85+66 LT (CB)
 86+16 LT (CB)
 87+47 LT (CB)
 87+76 RT (CB)
 89+41 RT (CB)

CHANGING ELEVATION OF SEWER MANHOLES
 84+86 LT
 88+90 LT

ADJUST ELEVATION OF VALVE BOX
 87+70 RT
 87+78 RT
 87+86 RT
 87+94 RT
 88+00 RT

REMOVING SIGNS AS SHOWN - 13

ERECTING SALVAGED SIGNS AS SHOWN - 6

- LEGEND**
- R = REMOVE EXISTING
 - S = SALVAGE
 - R&S = REMOVE AND SALVAGE
 - N = NEW
 - RET = RETAIN
 - B-B = BACK TO BACK
 - = EXISTING GUARDRAIL
 - = PROPOSED GUARDRAIL
 - YL = YELLOW LINE
 - WL = WHITE LINE

ROADWAY LAYOUT 7 US 5

PROJECT NAME: BRATTLEBORO
 PROJECT NUMBER: STP 2623(I)
 FILE NAME: /pave/06d214/pd214
 PROJECT LEADER: PTS
 DESIGNED BY: NLL
 IPARM FILE NAME: 06D214_32
 PLOT DATE: 3/19/2010
 DRAWN BY: MRS
 CHECKED BY: PTS
 SHEET 32 OF 163

NOT TO SCALE

MODEL: Default
 CLD 08-0324 z06D0214.dgn