

- NOTES**
- ① - SPECIAL PROVISION (PARKING METER POST)
 - ② - SPECIAL PROVISION (REMOVE PARKING METER POST)

ELIMINATED DOUBLE POST

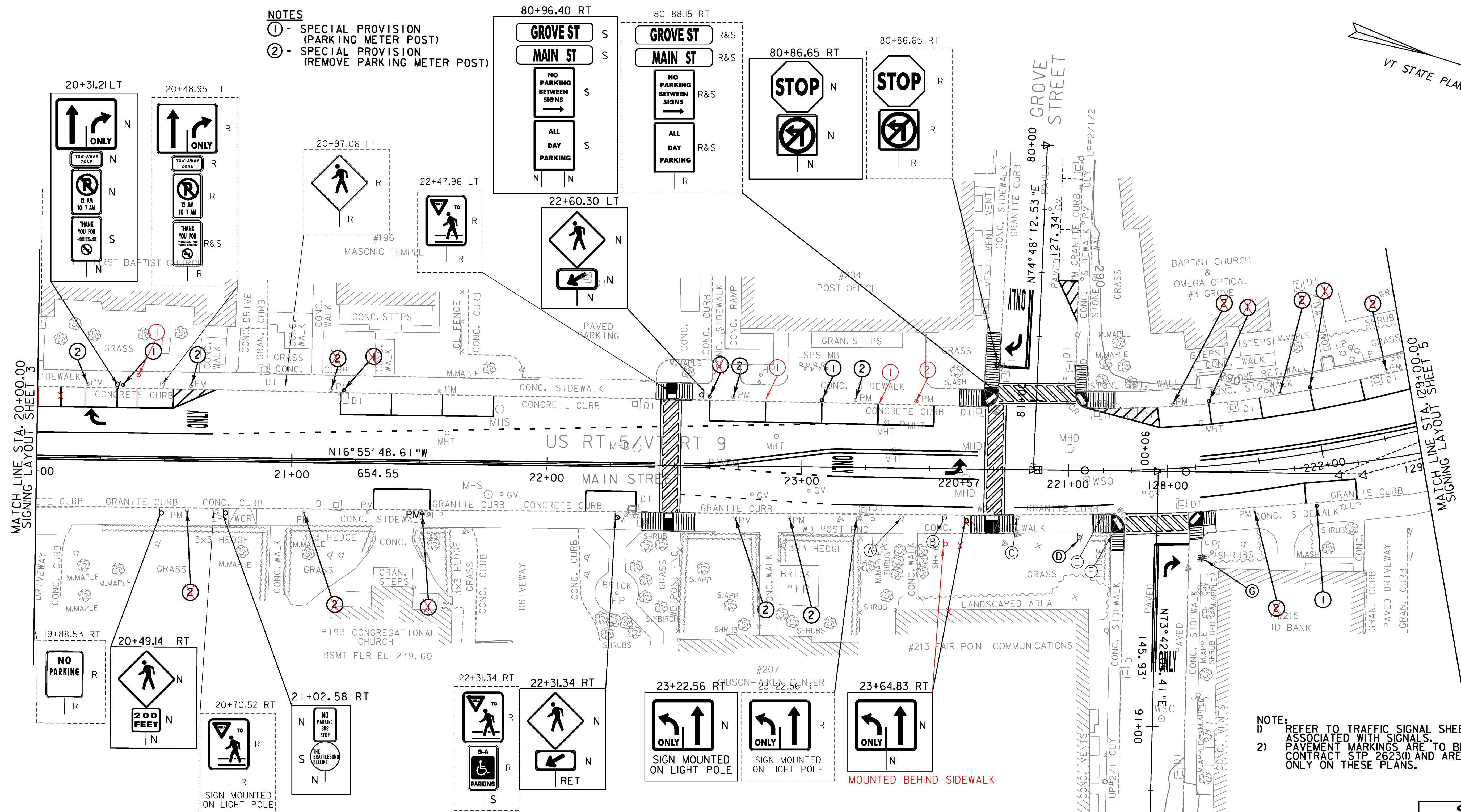

- NOTE:**
- 1) REFER TO TRAFFIC SIGNAL SHEETS FOR THE SIGNS ASSOCIATED WITH SIGNALS.
 - 2) PAVEMENT MARKINGS ARE TO BE COMPLETED UNDER CONTRACT STP 2623(0) AND ARE SHOWN FOR REFERENCE ONLY ON THESE PLANS.

SIGN LEGEND	
	= EXISTING SIGN
	= NEW SIGN
R	= REMOVE EXISTING SIGN AND POST
R+S	= SALVAGE SIGN AND RELOCATE TO NOTED LOCATION WITH NEW SIGN POST, REMOVE AND DISPOSE EXISTING SIGN POST
N	= NEW
RET	= RETAIN AT EXISTING LOCATION
B-B	= BACK TO BACK

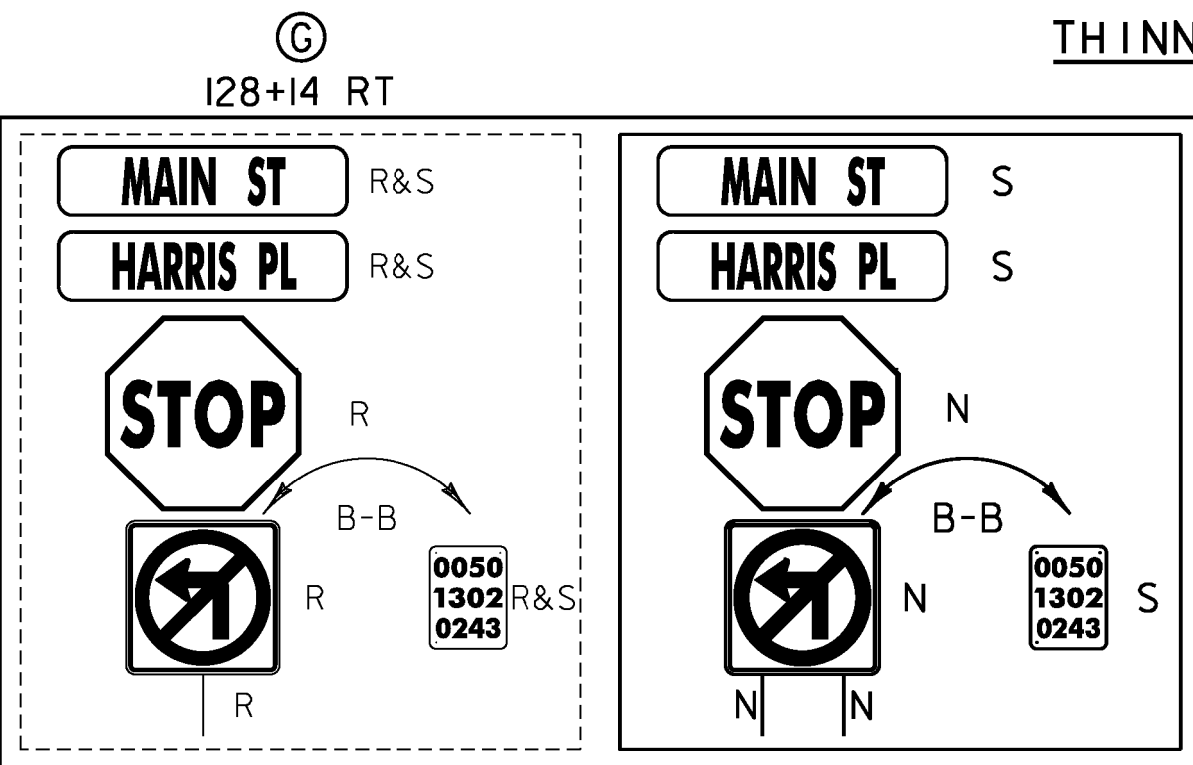
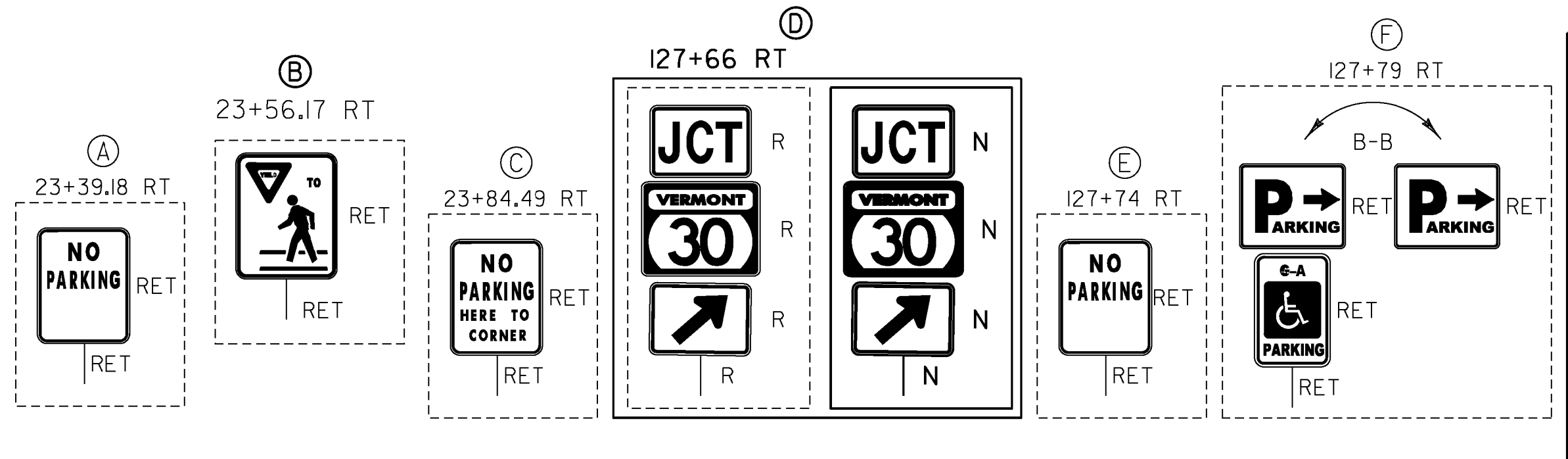

THINNING AND TRIMMING FOR SIGNS
TEACH (HARRIS PL. 90+33 RT)

REMOVING SIGNS
25 EACH

ERECTING SALVAGED SIGNS
9 EACH

SPECIAL PROVISION (PARKING METER POST)
8 EACH

SPECIAL PROVISION (REMOVE PARKING METER POST)
13 EACH

SCALE 1" = 20' - 0"
20 0 20

PROJECT NAME:	BRATTLEBORO
PROJECT NUMBER:	STP 2000(24)
FILE NAME:	z08d044bdr_ssgn.dgn
PROJECT LEADER:	KEN UPMAL
DESIGNED BY:	V. KACOYANNAKIS
SIGNING LAYOUT SHEET	4
PLOT DATE:	4/8/2010
DRAWN BY:	T. BIGELOW
CHECKED BY:	J.SOBEL
SHEET	139 OF 163