

CLD 08-0324 z06D0214.dgn MODEL: Default

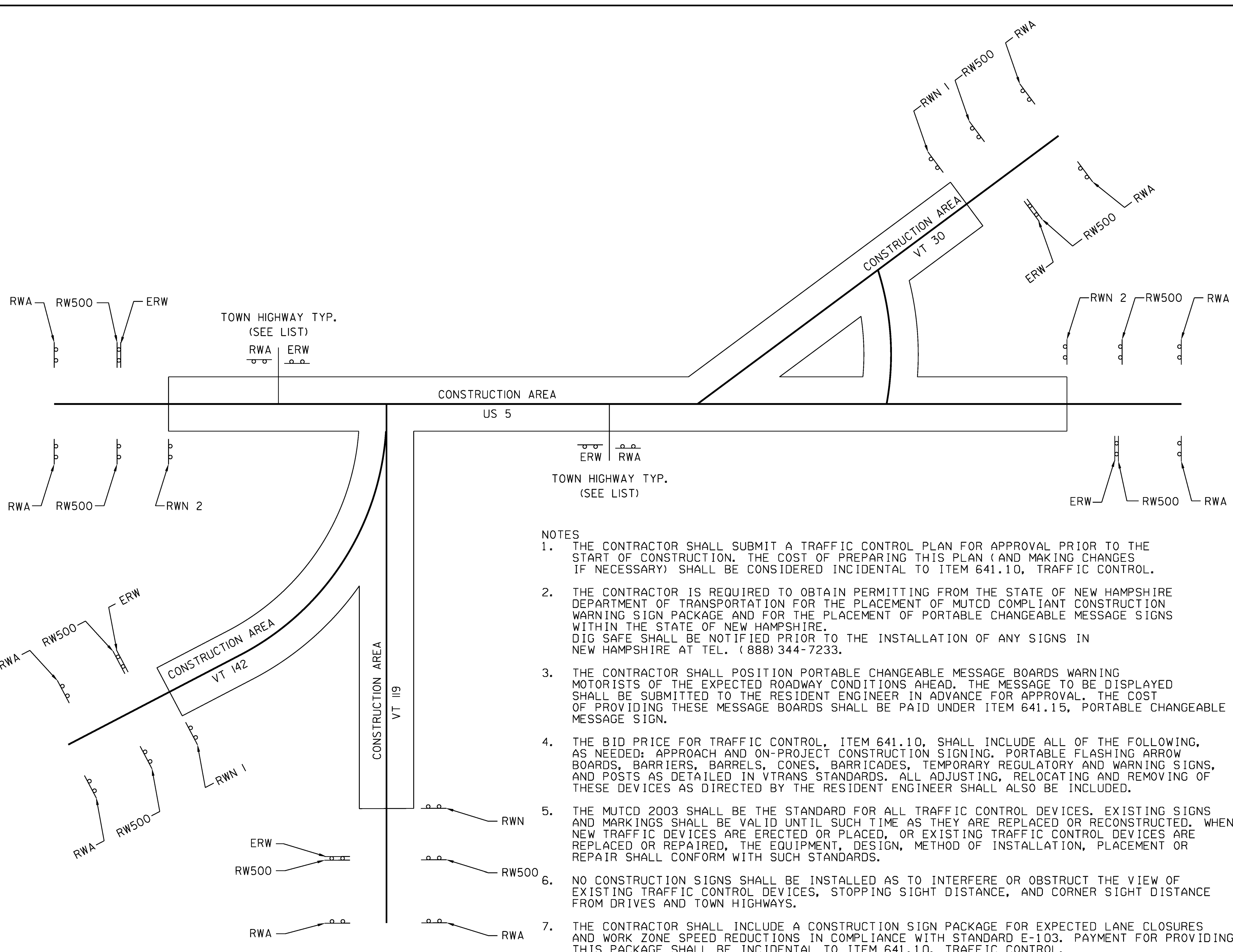

NOTES

1. THE CONTRACTOR SHALL SUBMIT A TRAFFIC CONTROL PLAN FOR APPROVAL PRIOR TO THE START OF CONSTRUCTION. THE COST OF PREPARING THIS PLAN (AND MAKING CHANGES IF NECESSARY) SHALL BE CONSIDERED INCIDENTAL TO ITEM 641.10, TRAFFIC CONTROL.
2. THE CONTRACTOR IS REQUIRED TO OBTAIN PERMITTING FROM THE STATE OF NEW HAMPSHIRE DEPARTMENT OF TRANSPORTATION FOR THE PLACEMENT OF MUTCD COMPLIANT CONSTRUCTION WARNING SIGN PACKAGE AND FOR THE PLACEMENT OF PORTABLE CHANGEABLE MESSAGE SIGNS WITHIN THE STATE OF NEW HAMPSHIRE. DIG SAFE SHALL BE NOTIFIED PRIOR TO THE INSTALLATION OF ANY SIGNS IN NEW HAMPSHIRE AT TEL. (888) 344-7233.
3. THE CONTRACTOR SHALL POSITION PORTABLE CHANGEABLE MESSAGE BOARDS WARNING MOTORISTS OF THE EXPECTED ROADWAY CONDITIONS AHEAD. THE MESSAGE TO BE DISPLAYED SHALL BE SUBMITTED TO THE RESIDENT ENGINEER IN ADVANCE FOR APPROVAL. THE COST OF PROVIDING THESE MESSAGE BOARDS SHALL BE PAID UNDER ITEM 641.15, PORTABLE CHANGEABLE MESSAGE SIGN.
4. THE BID PRICE FOR TRAFFIC CONTROL, ITEM 641.10, SHALL INCLUDE ALL OF THE FOLLOWING, AS NEEDED: APPROACH AND ON-PROJECT CONSTRUCTION SIGNING, PORTABLE FLASHING ARROW BOARDS, BARRIERS, BARRELS, CONES, BARRICADES, TEMPORARY REGULATORY AND WARNING SIGNS, AND POSTS AS DETAILED IN VTRANS STANDARDS. ALL ADJUSTING, RELOCATING AND REMOVING OF THESE DEVICES AS DIRECTED BY THE RESIDENT ENGINEER SHALL ALSO BE INCLUDED.
5. THE MUTCD 2003 SHALL BE THE STANDARD FOR ALL TRAFFIC CONTROL DEVICES. EXISTING SIGNS AND MARKINGS SHALL BE VALID UNTIL SUCH TIME AS THEY ARE REPLACED OR RECONSTRUCTED. WHEN NEW TRAFFIC DEVICES ARE ERECTED OR PLACED, OR EXISTING TRAFFIC CONTROL DEVICES ARE REPLACED OR REPAIRED, THE EQUIPMENT, DESIGN, METHOD OF INSTALLATION, PLACEMENT OR REPAIR SHALL CONFORM WITH SUCH STANDARDS.
6. NO CONSTRUCTION SIGNS SHALL BE INSTALLED AS TO INTERFERE OR OBSTRUCT THE VIEW OF EXISTING TRAFFIC CONTROL DEVICES, STOPPING SIGHT DISTANCE, AND CORNER SIGHT DISTANCE FROM DRIVES AND TOWN HIGHWAYS.
7. THE CONTRACTOR SHALL INCLUDE A CONSTRUCTION SIGN PACKAGE FOR EXPECTED LANE CLOSURES AND WORK ZONE SPEED REDUCTIONS IN COMPLIANCE WITH STANDARD E-103. PAYMENT FOR PROVIDING THIS PACKAGE SHALL BE INCIDENTAL TO ITEM 641.10, TRAFFIC CONTROL.
8. ON VTRANS STANDARD E-103, SIGN W4-2 MAY BE REPLACED WITH W9-2.
9. WHEN DIRECTED BY THE RESIDENT ENGINEER, "NO OUTLET" SIDE DRIVES WILL NOT REQUIRE CONSTRUCTION SIGNING.
10. SEE STD E-100, E-100A AND E-103 FOR SIGN PLACEMENT.
11. ALL PERMANENT SIGNS WHICH CONFLICT WITH TEMPORARY TRAFFIC CONTROL MUST BE COMPLETELY COVERED.
12. ALL CONSTRUCTION SIGNS SHALL BE "A MAXIMUM OF 36 INCHES" OR AS APPROVED BY THE RESIDENT ENGINEER.

LIST OF TOWN/STATE HIGHWAYS FOR CONSTRUCTION SIGNS

TOWN/STATE HIGHWAY NAME	ROAD WORK AHEAD (RWA)	END ROAD WORK (ERW)	ROAD WORK 500' (RW500)	ROAD WORK NEXT 1 MILE (RWN 1)	ROAD WORK NEXT 2 MILE (RWN 2)
BEGIN PROJECT US 5	2	1	2		1
TH 534	1	1			
TH 530	1	1			
TH 10	1	1			
TH 396	1	1			
TH 512	1	1			
TH 398	1	1			
TH 504	1	1			
TH 400	1	1			
TH 494	1	1			
TH 420	1	1			
TH 428	1	1			
TH 486	1	1			
TH 478 (ONE-WAY)	0	1			
TH 476 (ONE-WAY)	1	0			
TH 430	1	1			
TH 11	1	1			
TH 468 (ONE-WAY)	0	1			
TH 468 (ONE-WAY)	1	0			
TH 9	1	1			
ARCH ST	1	1			
TH 442	1	1			
TH 11	1	1			
TH 2	1	1			
TH 346	1	1			
TH 368	1	1			
TH 366	1	1			
TH 364	1	1			
TH 362	1	1			
TH 358	1	1			
TH 356	1	1			
TH 354	1	0			
END PROJECT US 5	2	1	2		1
US 5 SOUTHBOUND					
TH 342 (ONE-WAY)	1	1			
CHAPIN ST	1	1			
BEGIN VT 30	2	1	2	1	
TH 334	1				
END ON VT 30	2	1			
BEGIN VT 142	2	1	2	1	
TH 496	1	1			
BEGIN VT 119	2	1	2	1	
TOTAL	45	37	10	3	2



W9-2

W4-2

NOT TO SCALE

TEMPORARY TRAFFIC CONTROL PLAN

PROJECT NAME:	BRATTLEBORO
PROJECT NUMBER:	STP 2623(I)
FILE NAME:	/pave/06d214/pd214
PROJECT LEADER:	PTS
DESIGNED BY:	NLL
IPARM FILE NAME:	06D214_86
PLOT DATE:	3/19/2010
DRAWN BY:	WWG
CHECKED BY:	PTS
SHEET	86 OF 163