

TEMPORARY 4" WHITE LINE, PAINT
 DURABLE 4" WHITE LINE, THERMOPLASTIC
 92+50 TO 93+47 SOLID LT
 93+47 TO 93+55 SOLID LT (TH 496)
 93+67 TO 94+16 SOLID LT (TH 496)
 92+50 TO 98+00 SOLID RT
 94+16 TO 98+00 SOLID LT

TEMPORARY 4" YELLOW LINE, PAINT
 DURABLE 4" YELLOW LINE, THERMOPLASTIC
 92+50 TO 93+45 SOLID LT & RT
 93+61 TO 93+75 DOUBLE SOLID LT (TH 496)
 94+20 TO 98+00 SOLID LT & RT

TEMPORARY 24" STOP BAR, PAINT
 DURABLE 24" STOP BAR, RECESSED TYPE ITAPE
 93+45 RT
 93+58 TO 93+74 LT
 94+20 LT

REHAB. DROP INLETS, CATCH BASINS,
 OR MANHOLES, CLASS I, II, OR III
 97+65 LT (CB)

CHANGING ELEVATION OF DROP INLETS,
 CATCH BASINS, OR MANHOLES
 (TO BE ADJUSTED BY OWNER)
 93+83 LT (TMH)
 97+08 LT (TMH)

REMOVING SIGNS
 AS SHOWN - 1

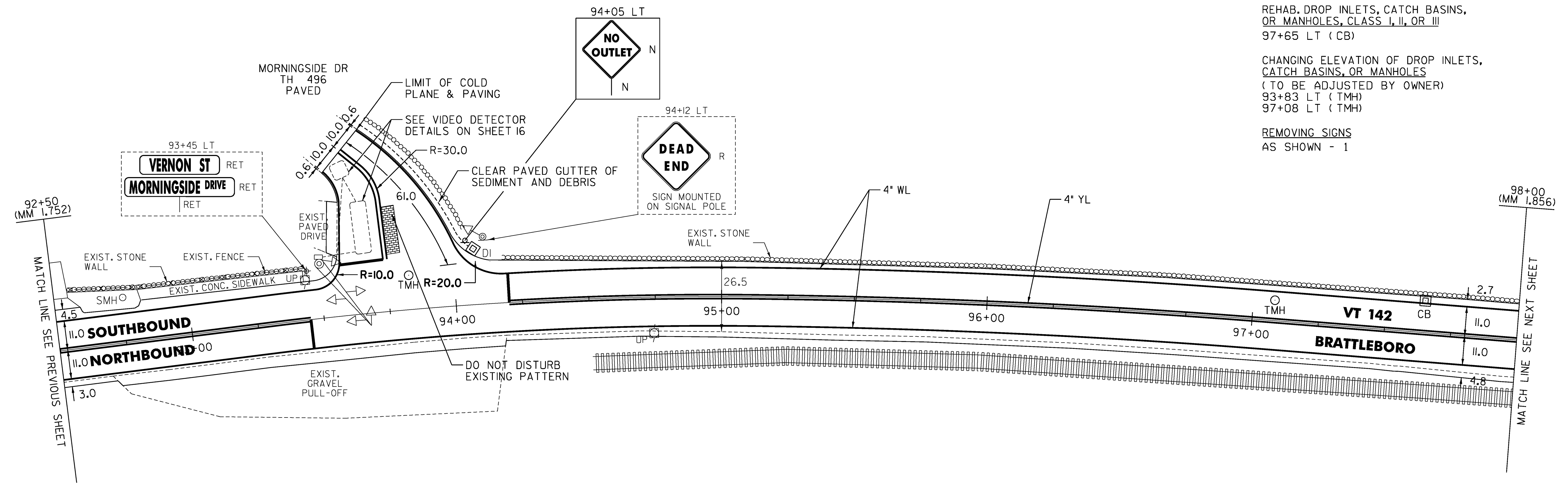

MODEL: Default
 CLD_08-0324_z06D0214.dgn

NOT TO SCALE

LEGEND

R	=	REMOVE EXISTING
S	=	SALVAGE
R&S	=	REMOVE AND SALVAGE
N	=	NEW
RET	=	RETAIN
B-B	=	BACK TO BACK
---	=	EXISTING GUARDRAIL
---	=	PROPOSED GUARDRAIL
Y-L	=	YELLOW LINE
W-L	=	WHITE LINE

ROADWAY LAYOUT 33 VT 142

PROJECT NAME: BRATTLEBORO	
PROJECT NUMBER: STP 2623(I)	
FILE NAME: /pave/06d214/pd214	PLOT DATE: 3/19/2010
PROJECT LEADER: PTS	DRAWN BY: MRS
DESIGNED BY: NULL	CHECKED BY: PTS
IPARM FILE NAME: 06D214_59	SHEET 59 OF 163