

TEMPORARY 4" WHITE LINE, PAINT
 DURABLE 4" WHITE LINE, RECESSED POLYUREA
 110+50 TO A 7+81 SOLID RT
 110+50 TO A 7+90 LT
 110+50 TO 110+76 LT (LANE LINE)
 110+80 TO A 7+82 RT SOLID (LANE LINE)
 A 9+08 TO A 9+76 SOLID CL (LANE LINE)
 A 9+76 TO A 10+00 DOTTED CL (LANE LINE)
 A 9+77 TO A 10+00 DOTTED RT (LANE LINE)

TEMPORARY 4" WHITE LINE, PAINT
 DURABLE 4" WHITE LINE, THERMOPLASTIC
 VT 142
 113+00 TO 113+43 SOLID RT (LANE LINE)
 113+00 TO 113+52 SOLID LT
 113+00 TO 113+43 SOLID RT
 VT 119
 41+34 TO 42+00 SOLID RT
 41+54 TO 42+00 SOLID LT (LANE LINE)
 41+54 TO 42+00 SOLID LT

TEMPORARY 4" YELLOW LINE, PAINT
 DURABLE 4" YELLOW LINE, RECESSED POLYUREA
 110+50 TO A 7+83 SOLID LT & RT
 A 9+08 TO A 10+00 DOUBLE SOLID RT

TEMPORARY 4" YELLOW LINE, PAINT
 DURABLE 4" YELLOW LINE, THERMOPLASTIC
 A 8+19 TO A 8+22 DOUBLE SOLID LT (EXIST. DRIVE)
 VT 142
 113+00 TO 113+43 SOLID LT & RT
 VT 119
 41+54 TO 42+00 SOLID LT & RT

TEMPORARY CROSSWALK MARKING, PAINT
 DURABLE CROSSWALK MARKING, THERMOPLASTIC
 A 7+90 TO A 7+96 RT TO LT
 A 8+02 TO A 8+49 LT
 A 8+89 TO A 9+06 LT TO RT
 VT 142
 113+51 TO 113+57 RT TO LT

TEMPORARY LETTER OR SYMBOL, PAINT
 110+72 LT - THRU ARROW
 A 7+70 RT - LEFT/THRU ARROW
 A 7+75 RT - RIGHT TURN ARROW
 A 9+17 RT - LEFT TURN ARROW
 VT 142
 113+35 RT - RIGHT TURN ARROW
 VT 119
 41+62 LT - RIGHT TURN ARROW
 41+66 LT - THRU/LEFT ARROW

DURABLE LETTER OR SYMBOL, THERMOPLASTIC
 110+72 LT - THRU ARROW
 110+72 LT - ONLY
 110+84 RT - ONLY
 A 7+70 RT - LEFT/THRU ARROW
 A 7+75 RT - RIGHT TURN ARROW
 A 9+17 RT - LEFT TURN ARROW
 A 9+72 RT - ONLY
 VT 142
 113+35 RT - RIGHT TURN ARROW
 VT 119
 41+62 LT - RIGHT TURN ARROW
 41+66 LT - THRU/LEFT ARROW

TEMPORARY 24" STOP BAR, PAINT
 DURABLE 24" STOP BAR, RECESSED TYPE I TAPE
 A 7+81 TO A 7+83 RT
 A 7+99 TO A 8+23 LT
 A 9+08 LT TO RT
 VT 142
 113+43 RT
 VT 119
 41+53 LT

TEMPORARY RAILROAD CROSSING SYMBOL, PAINT
 DURABLE RAILROAD CROSSING SYMBOL, THERMOPLASTIC
 41+91 RT

CHANGING ELEVATION OF DROP INLETS,
 CATCH BASINS, OR MANHOLES
 A 8+79 LT (DMH)

CHANGING ELEVATION OF DROP INLETS,
 CATCH BASINS, OR MANHOLES
 (TO BE ADJUSTED BY OWNER)
 A 8+45 LT (TMH)
 A 8+63 LT (TMH)
 VT 119
 41+11 RT (TMH)

REHAB. DROP INLETS, CATCH BASINS,
 OR MANHOLES, CLASS I, II, OR III

A 7+70 LT (CB)
 A 8+11 RT (CB) (STP 2000(24))
 A 8+75 LT (CB)
 A 9+63 LT (CB)
 A 9+73 RT (CB)
 VT 142
 113+62 RT (CB) (STP 2000(24))
 113+81 LT (CB) (STP 2000(24))
 VT 119
 41+33 RT (CB)
 41+88 LT (CB)

CHANGING ELEVATION
 OF SEWER MANHOLES
 A 7+50 RT
 A 9+62 RT
 VT 119
 40+88 LT

ADJUST ELEVATION
 OF VALVE BOX

A 8+56 RT
 A 8+79 RT
 A 8+94 RT
 A 9+64 RT
 A 9+73 RT
 A 9+81 RT
 A 9+82 RT
 VT 119
 40+97 RT

REMOVING SIGNS
 AS SHOWN - 2

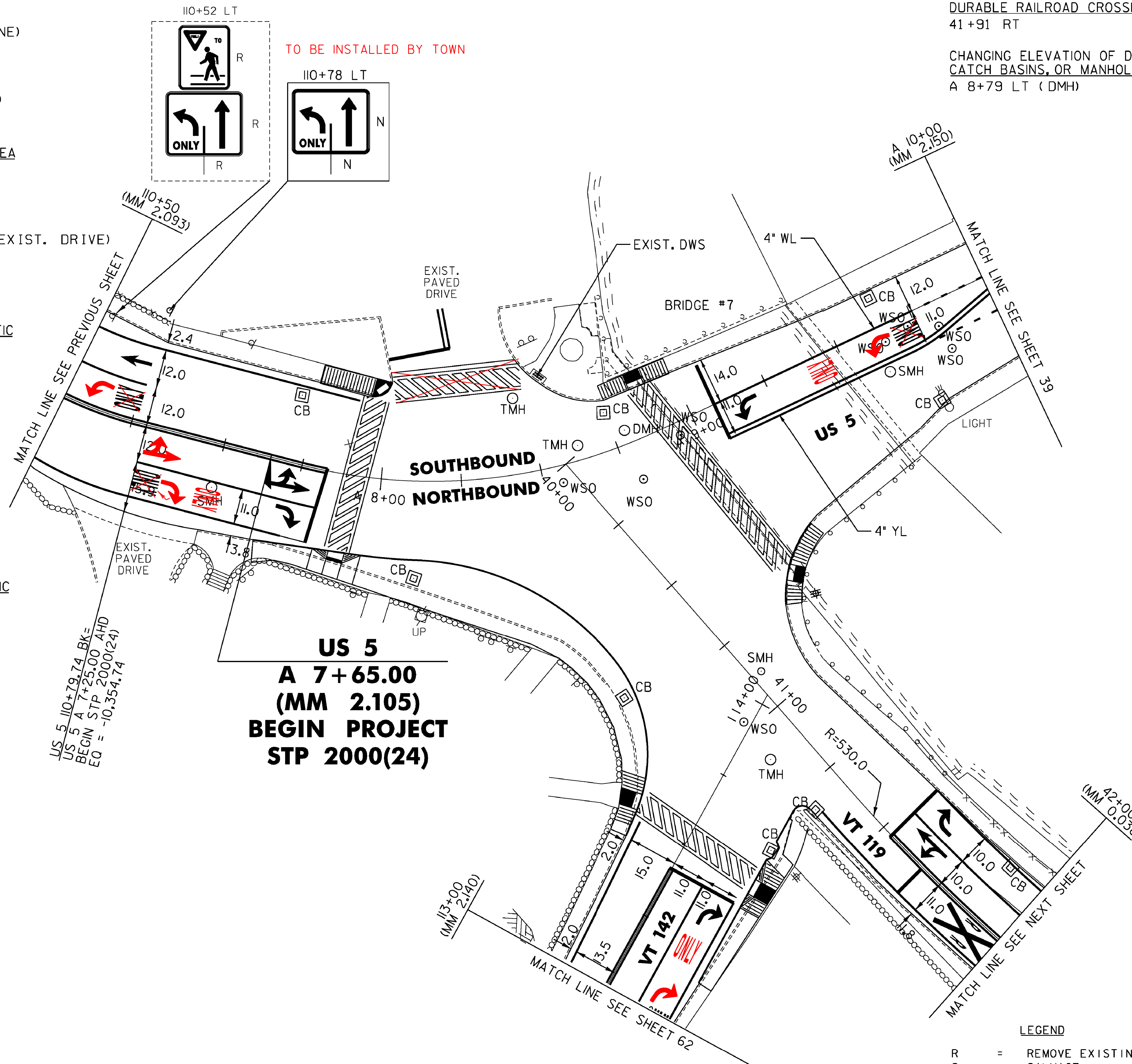

SEE STP 2000(24) FOR SIGNING BETWEEN
 STA A 7+25 TO 128+25 ON US 5,
 ON VT 119, AND BETWEEN STA 113+00 TO
 114+00 ON VT 142.

LEGEND

- R = REMOVE EXISTING
- S = SALVAGE
- R&S = REMOVE AND SALVAGE
- N = NEW
- RET = RETAIN
- B-B = BACK TO BACK
- = EXISTING GUARDRAIL
- = PROPOSED GUARDRAIL
- YL = YELLOW LINE
- WL = WHITE LINE

ROADWAY LAYOUT 12 US 5

PROJECT NAME: BRATTLEBORO	
PROJECT NUMBER: STP 2623(I)	
FILE NAME: /pave/06d214/pd214	PLOT DATE: 3/19/2010
PROJECT LEADER: PTS	DRAWN BY: MRS
DESIGNED BY: NLL	CHECKED BY: PTS
IPARM FILE NAME: 06D214_37	SHEET 37 OF 163

NOT TO SCALE

MODEL: Default
 CLD_08-0324_Z06D0214.dgn