

646.402 DURABLE 4 INCH WHITE LINE, THERMOPLASTIC
 (ALL LINES WILL INCLUDE EDGE LINE BREAKS AND RADIUS FOR TOWN HIGHWAYS)

U.S. ROUTE 7:
 STA 24+00.00 - STA 30+00.00 EDGE LINE LT/RT
 STA 24+00.00 - STA 24+20.00 DOTTED LANE LINE LT
 STA 24+60.48 - SOLID LANE LINE LT, PARK STREET
 STA 24+00.00 - STA 30+00.00 DASHED LANE LINE RT
 STA 25+00.00 - STA 30+00.00 DASHED LANE LINE LT
 STA 26+50.00 - STA 28+50.00 DOTTED LANE LINE RT
 STA 26+50.00 - STA 27+50.00 SOLID LANE LINE LT
 STA 27+50.00 - STA 28+50.00 DOTTED LANE LINE LT
 STA 28+50.00 - STA 30+00.00 SOLID LANE LINE C/L
 STA 28+50.00 - STA 30+00.00 SOLID LANE LINE RT

STA 24+30.0, LT STA 24+36.0, LT STA 24+36.0, LT
 (ALL LINES WILL INCLUDE C/L BREAKS FOR TOWN HIGHWAYS)

U.S. ROUTE 7:
 STA 24+00.00 - STA 25+09.00 DOUBLE SOLID C/L
 STA 24+87.00 - STA 25+09.00 DOUBLE SOLID C/L&RT
 STA 24+60.48 - DOUBLE SOLID LT, PARK STREET
 STA 25+50.00 - STA 27+50.00 DOUBLE SOLID LT/RT
 STA 27+50.00 - STA 30+00.00 DOUBLE SOLID LT

646.412 DURABLE 4 INCH YELLOW LINE, THERMOPLASTIC
 (ALL LINES WILL INCLUDE C/L BREAKS FOR TOWN HIGHWAYS)

U.S. ROUTE 7:
 STA 24+00.00 - STA 30+00.00 EDGE LINE LT/RT
 STA 24+00.00 - STA 24+20.00 DOTTED LANE LINE LT
 STA 24+60.48 - SOLID LANE LINE LT, PARK STREET
 STA 24+00.00 - STA 30+00.00 DASHED LANE LINE RT
 STA 25+00.00 - STA 30+00.00 DASHED LANE LINE LT
 STA 26+50.00 - STA 28+50.00 DOTTED LANE LINE RT
 STA 26+50.00 - STA 27+50.00 SOLID LANE LINE LT
 STA 27+50.00 - STA 28+50.00 DOTTED LANE LINE LT
 STA 28+50.00 - STA 30+00.00 SOLID LANE LINE C/L
 STA 28+50.00 - STA 30+00.00 SOLID LANE LINE RT

646.602 TEMPORARY 4 INCH WHITE LINE, PAINT
 (ALL LINES WILL INCLUDE EDGE LINE BREAKS AND RADIUS FOR TOWN HIGHWAYS)

U.S. ROUTE 7:
 STA 24+00.00 - STA 25+09.00 DOUBLE SOLID C/L
 STA 24+87.00 - STA 25+09.00 DOUBLE SOLID C/L&RT
 STA 24+60.48 - DOUBLE SOLID LT, PARK STREET
 STA 25+50.00 - STA 27+50.00 DOUBLE SOLID LT/RT
 STA 27+50.00 - STA 30+00.00 DOUBLE SOLID LT

646.612 TEMPORARY 4 INCH YELLOW LINE, PAINT
 (ALL LINES WILL INCLUDE C/L BREAKS FOR TOWN HIGHWAYS)

U.S. ROUTE 7:
 STA 24+00.00 - STA 25+09.00 DOUBLE SOLID C/L&RT
 STA 24+87.00 - STA 25+09.00 DOUBLE SOLID C/L&RT
 STA 24+60.48 - DOUBLE SOLID LT, PARK STREET
 STA 25+50.00 - STA 27+50.00 DOUBLE SOLID LT/RT
 STA 27+50.00 - STA 30+00.00 DOUBLE SOLID LT

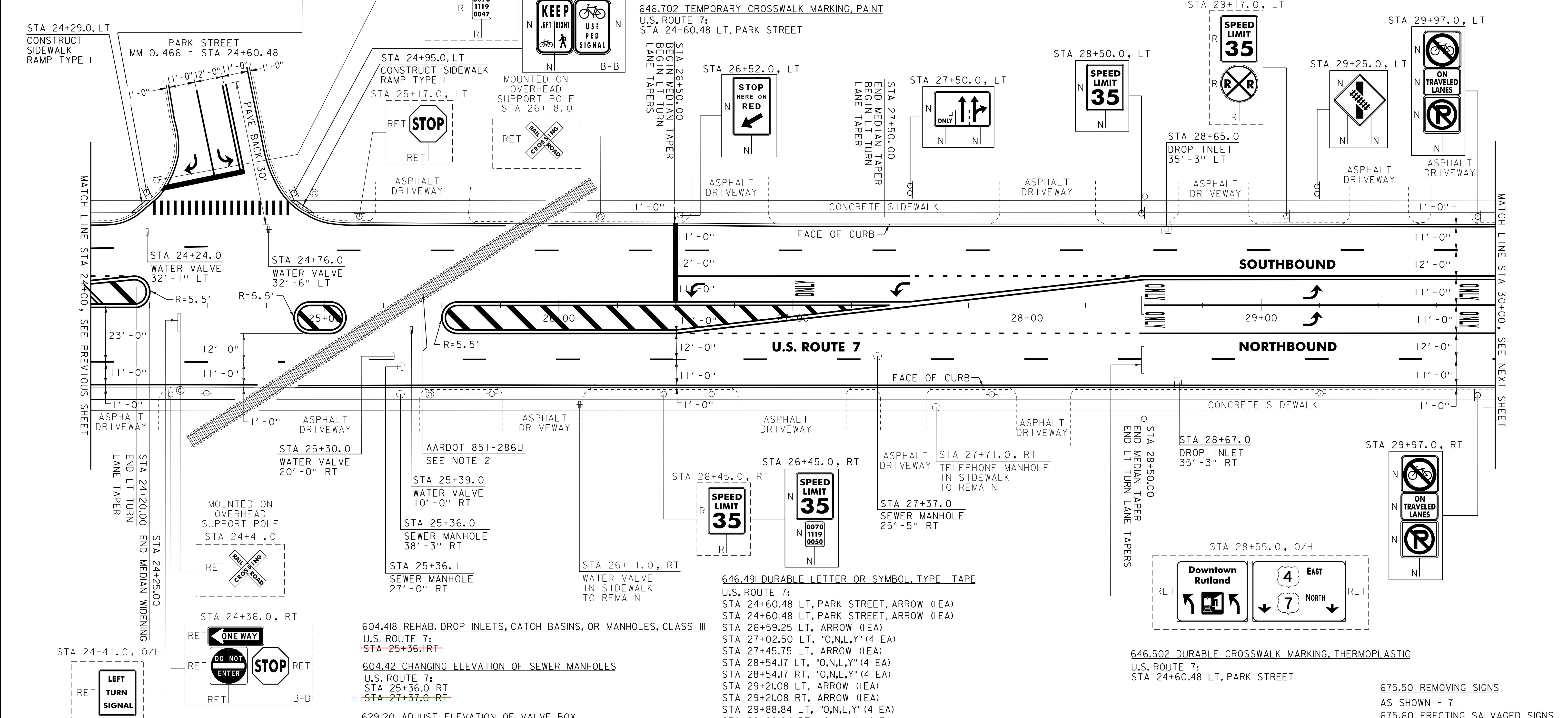

NOTES:
 1. SEE SHEET 40 & 41 FOR VIDEO DETECTION SYSTEM SHEET.
 2. SEE SHEET 74 FOR RAIL GRADE CROSSING DETAIL SHEET.

604.412 REHAB. DROP INLETS, CATCH BASINS, OR MANHOLES, CLASS III
 U.S. ROUTE 7:
 STA 28+65.0 LT STA 27+37.0 RT
 STA 28+67.0 RT STA 25+36.1 RT

604.418 REHAB. DROP INLETS, CATCH BASINS, OR MANHOLES, CLASS III
 U.S. ROUTE 7:
~~STA 25+36.1 RT~~

604.42 CHANGING ELEVATION OF SEWER MANHOLES
 U.S. ROUTE 7:
 STA 25+36.0 RT
~~STA 27+37.0 RT~~

629.20 ADJUST ELEVATION OF VALVE BOX
 U.S. ROUTE 7:
 STA 24+24.0 LT
 STA 24+76.0 LT
 STA 25+30.0 RT
 STA 25+39.0 RT DID NOT TOUCH

646.452 DURABLE 8 INCH YELLOW LINE, THERMOPLASTIC
 U.S. ROUTE 7:
 STA 24+00.00 - STA 24+25.00 HATCHED MEDIAN LT/RT
 STA 24+87.00 - STA 25+09.00 HATCHED MEDIAN LT/RT
 STA 25+50.00 - STA 27+50.00 HATCHED MEDIAN LT/RT

646.481 DURABLE 24 INCH STOP BAR, TYPE I TAPE
 U.S. ROUTE 7:
 STA 24+60.48 LT, PARK STREET
 STA 26+50.00 LT

646.702 TEMPORARY CROSSWALK MARKING, PAINT
 U.S. ROUTE 7:
 STA 24+60.48 LT, PARK STREET

646.491 DURABLE LETTER OR SYMBOL, TYPE I TAPE
 U.S. ROUTE 7:
 STA 24+60.48 LT, PARK STREET, ARROW (1 EA)
 STA 24+60.48 LT, PARK STREET, ARROW (1 EA)
 STA 26+59.25 LT, ARROW (1 EA)
 STA 27+02.50 LT, "O,N,L,Y" (4 EA)
 STA 27+45.75 LT, ARROW (1 EA)
 STA 28+54.17 LT, "O,N,L,Y" (4 EA)
 STA 28+54.17 RT, "O,N,L,Y" (4 EA)
 STA 29+21.08 LT, ARROW (1 EA)
 STA 29+21.08 RT, ARROW (1 EA)
 STA 29+88.84 LT, "O,N,L,Y" (4 EA)
 STA 29+88.84 RT, "O,N,L,Y" (4 EA)

646.692 TEMPORARY LETTER OR SYMBOL, PAINT
 U.S. ROUTE 7:
 STA 24+60.48 LT, PARK STREET, ARROW (2 EA)
 STA 24+60.48 LT, PARK STREET, ARROW (2 EA)
 STA 26+59.25 LT, ARROW (2 EA)
 STA 27+45.75 LT, ARROW (2 EA)
 STA 29+21.08 LT, ARROW (2 EA)
 STA 29+21.08 RT, ARROW (2 EA)

SIGN LEGEND
 R = REMOVE
 S = SALVAGE
 N = NEW
 RET = RETAIN
 B-B = BACK TO BACK
 EXISTING = _____
 NEW = _____

646.491 DURABLE LETTER OR SYMBOL, TYPE I TAPE
 U.S. ROUTE 7:
 STA 24+60.48 LT, PARK STREET, ARROW (1 EA)
 STA 24+60.48 LT, PARK STREET, ARROW (1 EA)
 STA 26+59.25 LT, ARROW (1 EA)
 STA 27+02.50 LT, "O,N,L,Y" (4 EA)
 STA 27+45.75 LT, ARROW (1 EA)
 STA 28+54.17 LT, "O,N,L,Y" (4 EA)
 STA 28+54.17 RT, "O,N,L,Y" (4 EA)
 STA 29+21.08 LT, ARROW (1 EA)
 STA 29+21.08 RT, ARROW (1 EA)
 STA 29+88.84 LT, "O,N,L,Y" (4 EA)
 STA 29+88.84 RT, "O,N,L,Y" (4 EA)

646.502 DURABLE CROSSWALK MARKING, THERMOPLASTIC
 U.S. ROUTE 7:
 STA 24+60.48 LT, PARK STREET

675.50 REMOVING SIGNS
 AS SHOWN - 7
 675.60 ERECTING SALVAGED SIGNS
 AS SHOWN - 1

| | | | |
|----------------------------------|-----------------------------|--------------------------|------------------------------|
| <h1>PROJECT LAYOUT SHEET #5</h1> | PROJECT NAME: RUTLAND CITY | FILE NAME: p06d050.dgn | PLOT DATE: 03-AUG-2012 12:22 |
| | PROJECT NUMBER: NH 2605(I)S | DESIGNED BY: MJL | DRAWN BY: C&K |
| | | IPARM FILE: p06d050i05.i | CHECKED BY: DWE |