

646.402 DURABLE 4 INCH WHITE LINE, THERMOPLASTIC
 (ALL LINES WILL INCLUDE EDGE LINE BREAKS AND RADIUS FOR TOWN HIGHWAYS)

U.S. ROUTE 7:
 STA 12+00.00 - STA 18+00.00 EDGE LINE LT/RT
 STA 12+00.00 - STA 18+00.00 DASHED LANE LINE LT
 STA 12+00.00 - STA 18+00.00 DASHED LANE LINE RT

646.412 DURABLE 4 INCH YELLOW LINE, THERMOPLASTIC
 (ALL LINES WILL INCLUDE C/L BREAKS FOR TOWN HIGHWAYS)

U.S. ROUTE 7:
 STA 12+00.00 - STA 18+00.00 SOLID/DASH TURN LANE LINES LT/RT
 STA 14+04.48 DOUBLE SOLID RT, CHAPLIN AVENUE

646.481 DURABLE 24 INCH STOP BAR, TYPE ITAPE
 U.S. ROUTE 7:
 STA 14+04.48 RT, CHAPLIN AVENUE

646.491 DURABLE LETTER OR SYMBOL, TYPE ITAPE
 U.S. ROUTE 7:
 STA 13+53.00 C/L, ARROW (1EA)
 STA 13+64.00 C/L, ARROW (1EA)
 STA 14+04.48 RT, CHAPLIN AVENUE, "S,T,O,P" (4 EA)
 STA 14+49.00 C/L, ARROW (1EA)
 STA 14+60.00 C/L, ARROW (1EA)
 STA 16+68.00 C/L, ARROW (1EA)
 STA 16+79.00 C/L, ARROW (1EA)

646.602 TEMPORARY 4 INCH WHITE LINE, PAINT
 (ALL LINES WILL INCLUDE EDGE LINE BREAKS AND RADIUS FOR TOWN HIGHWAYS)

U.S. ROUTE 7:
 STA 12+00.00 - STA 18+00.00 EDGE LINE LT/RT
 STA 12+00.00 - STA 18+00.00 DASHED LANE LINE LT
 STA 12+00.00 - STA 18+00.00 DASHED LANE LINE RT

646.612 TEMPORARY 4 INCH YELLOW LINE, PAINT
 (ALL LINES WILL INCLUDE C/L BREAKS FOR TOWN HIGHWAYS)

U.S. ROUTE 7:
 STA 12+00.00 - STA 18+00.00 SOLID/DASH TURN LANE LINES LT/RT
 STA 14+04.48 DOUBLE SOLID RT, CHAPLIN AVENUE

646.682 TEMPORARY 24 INCH STOP BAR, PAINT
 U.S. ROUTE 7:
 STA 14+04.48 RT, CHAPLIN AVENUE

646.692 TEMPORARY LETTER OR SYMBOL, PAINT

U.S. ROUTE 7:
 STA 13+53.00 C/L, ARROW (1EA)
 STA 13+64.00 C/L, ARROW (1EA)
 STA 14+04.48 RT, CHAPLIN AVENUE, "S,T,O,P" (8 EA)
 STA 14+49.00 C/L, ARROW (2 EA)
 STA 14+60.00 C/L, ARROW (2 EA)
 STA 16+68.00 C/L, ARROW (2 EA)
 STA 16+79.00 C/L, ARROW (2 EA)

646.702 DURABLE CROSSWALK MARKING, PAINT
 U.S. ROUTE 7:
 STA 14+04.48 RT CHAPLIN AVENUE

646.502 DURABLE CROSSWALK MARKING, THERMOPLASTIC
 U.S. ROUTE 7:
 STA 14+04.48 RT CHAPLIN AVENUE

675.50 REMOVING SIGNS AS SHOWN - II

675.60 ERECTING SALVAGED SIGNS AS SHOWN - I

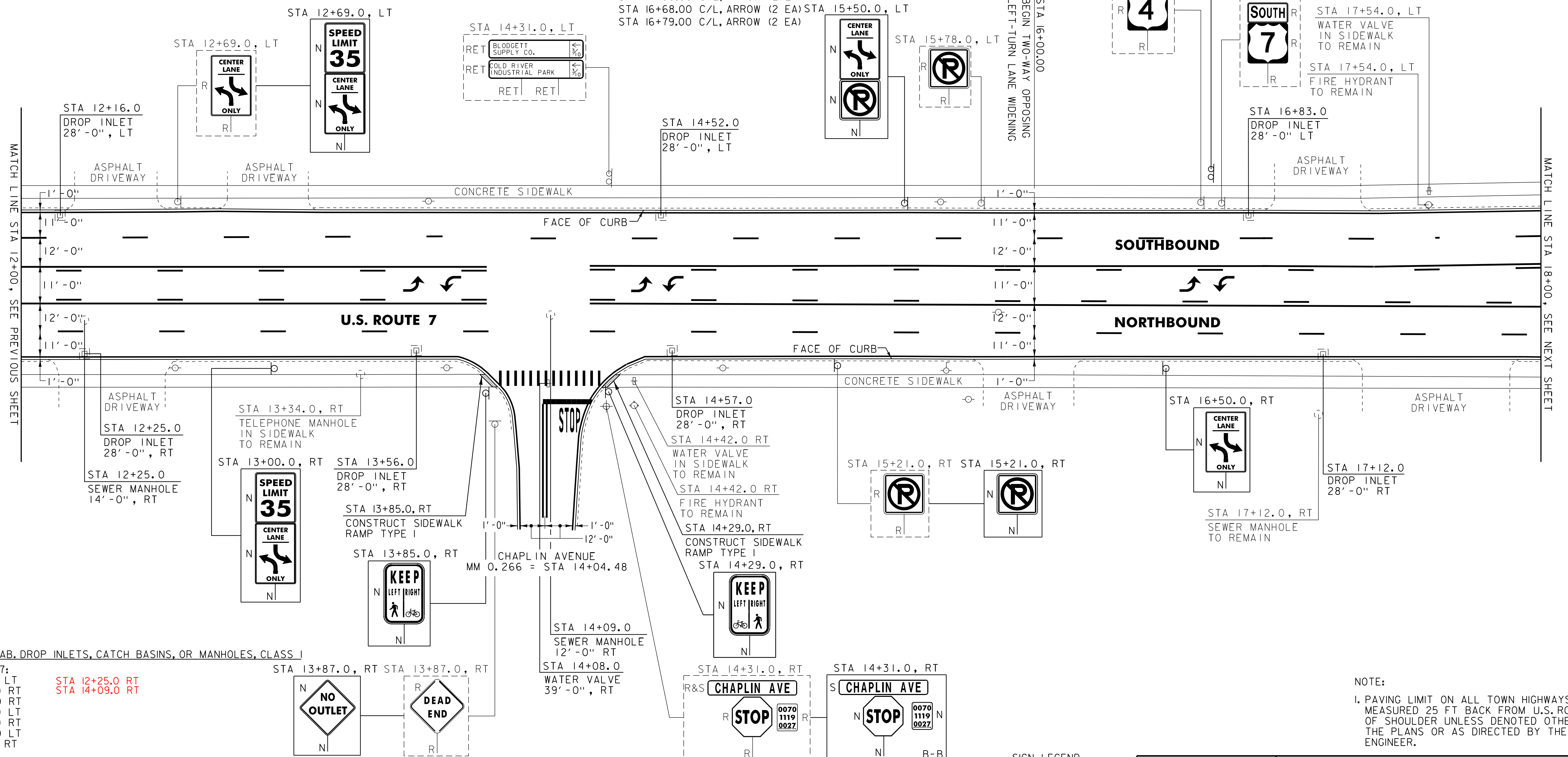

604.412 REHAB. DROP INLETS, CATCH BASINS, OR MANHOLES, CLASS I

U.S. ROUTE 7:
 STA 12+16.0 LT
 STA 12+25.0 RT
 STA 13+56.0 RT
 STA 14+52.0 LT
 STA 14+57.0 RT
 STA 16+83.0 LT
 STA 17+12.0 RT

604.415 REHAB. DROP INLETS, CATCH BASINS, OR MANHOLES, CLASS II

U.S. ROUTE 7:
 STA 12+25.0 RT
 STA 14+09.0 RT
 STA 14+08.0 RT

SIGN LEGEND
 R = REMOVE
 S = SALVAGE
 N = NEW
 RET = RETAIN
 B-B = BACK TO BACK
 EXISTING = - - - - -
 NEW = _____

PROJECT LAYOUT SHEET #3

NOTE:
 1. PAVING LIMIT ON ALL TOWN HIGHWAYS SHALL BE MEASURED 25 FT BACK FROM U.S. ROUTE 7 EDGE OF SHOULDER UNLESS DENOTED OTHERWISE ON THE PLANS OR AS DIRECTED BY THE RESIDENT ENGINEER.

PROJECT NAME: RUILAND CITY
 PROJECT NUMBER: NH 2605(I)S
 FILE NAME: p06d050.dgn
 PROJECT LEADER: DEG
 DESIGNED BY: MJL
 IPARM FILE: p06d050i03.i

PLOT DATE: 03-AUG-2012 12:2
 DRAWN BY: C&K
 CHECKED BY: DWE
 SHEET 15 OF 76