

646.402 DURABLE 4 INCH WHITE LINE, THERMOPLASTIC
(ALL LINES WILL INCLUDE EDGE LINE BREAKS AND RADIUS FOR TOWN HIGHWAYS)

U.S. ROUTE 7:
STA 0+00.00 - STA 5+80.00 EDGE LINE LT/RT
STA 0+00.00 - STA 5+03.00 DASHED LANE LINE LT
STA 0+00.00 - STA 5+80.00 DASHED LANE LINE RT
STA 3+75.00 - STA 5+02.00 SOLID LANE LINE RT

646.602 TEMPORARY 4 INCH WHITE LINE, PAINT
(ALL LINES WILL INCLUDE EDGE LINE BREAKS AND RADIUS FOR TOWN HIGHWAYS)

U.S. ROUTE 7:
STA 0+00.00 - STA 5+80.00 EDGE LINE LT/RT
STA 0+00.00 - STA 5+03.00 DASHED LANE LINE LT
STA 0+00.00 - STA 5+80.00 DASHED LANE LINE RT
STA 3+75.00 - STA 5+02.00 SOLID LANE LINE RT

675.50 REMOVING SIGNS
AS SHOWN - 8

675.60 ERECTING SALVAGED SIGNS
AS SHOWN - 1

646.412 DURABLE 4 INCH YELLOW LINE, THERMOPLASTIC
(ALL LINES WILL INCLUDE C/L BREAKS FOR TOWN HIGHWAYS)

U.S. ROUTE 7:
STA 0+00.00 - STA 2+75.00 SOLID/DASH TURN LANE LINES LT/RT
STA 2+75.00 - STA 5+03.00 DOUBLE SOLID LT
STA 5+59.68 DOUBLE SOLID RT, CURTIS AVENUE

646.612 TEMPORARY 4 INCH YELLOW LINE, PAINT
(ALL LINES WILL INCLUDE C/L BREAKS FOR TOWN HIGHWAYS)

U.S. ROUTE 7:
STA 0+00.00 - STA 2+75.00 SOLID/DASH TURN LANE LINES LT/RT
STA 2+75.00 - STA 5+03.00 DOUBLE SOLID LT
STA 5+59.68 DOUBLE SOLID RT, CURTIS AVENUE

646.481 DURABLE 24 INCH STOP BAR, TYPE 1 TAPE

U.S. ROUTE 7:
STA 5+03.00 LT/RT
STA 5+59.68 RT, CURTIS AVENUE

646.682 TEMPORARY 24 INCH STOP BAR, PAINT

U.S. ROUTE 7:
STA 5+03.00 LT/RT
STA 5+59.68 RT, CURTIS AVENUE

646.491 DURABLE LETTER OR SYMBOL, TYPE 1 TAPE

U.S. ROUTE 7:
STA 0+56.00 C/L, ARROW (1EA)
STA 0+67.00 C/L, ARROW (1EA)
STA 2+40.00 C/L, ARROW (1EA)
STA 2+51.00 C/L, ARROW (1EA)
STA 3+79.25 C/L, ARROW (1EA)
STA 4+36.00 C/L, "O,N,L,Y" (4 EA)
STA 4+93.75 C/L, ARROW (1EA)

646.692 TEMPORARY LETTER OR SYMBOL, PAINT

U.S. ROUTE 7:
STA 0+56.00 C/L, ARROW (2 EA)
STA 0+67.00 C/L, ARROW (2 EA)
STA 2+40.00 C/L, ARROW (2 EA)
STA 2+51.00 C/L, ARROW (2 EA)
STA 3+79.25 C/L, ARROW (2 EA)
STA 4+93.75 C/L, ARROW (2 EA)

646.702 DURABLE CROSSWALK MARKING, PAINT

U.S. ROUTE 7:
STA 5+33.28 LT, HANNAFORD ACCESS
STA 5+59.68 RT, CURTIS AVENUE

646.502 DURABLE CROSSWALK MARKING, THERMOPLASTIC

U.S. ROUTE 7:
STA 5+33.28 LT, HANNAFORD ACCESS
STA 5+59.68 RT, CURTIS AVENUE

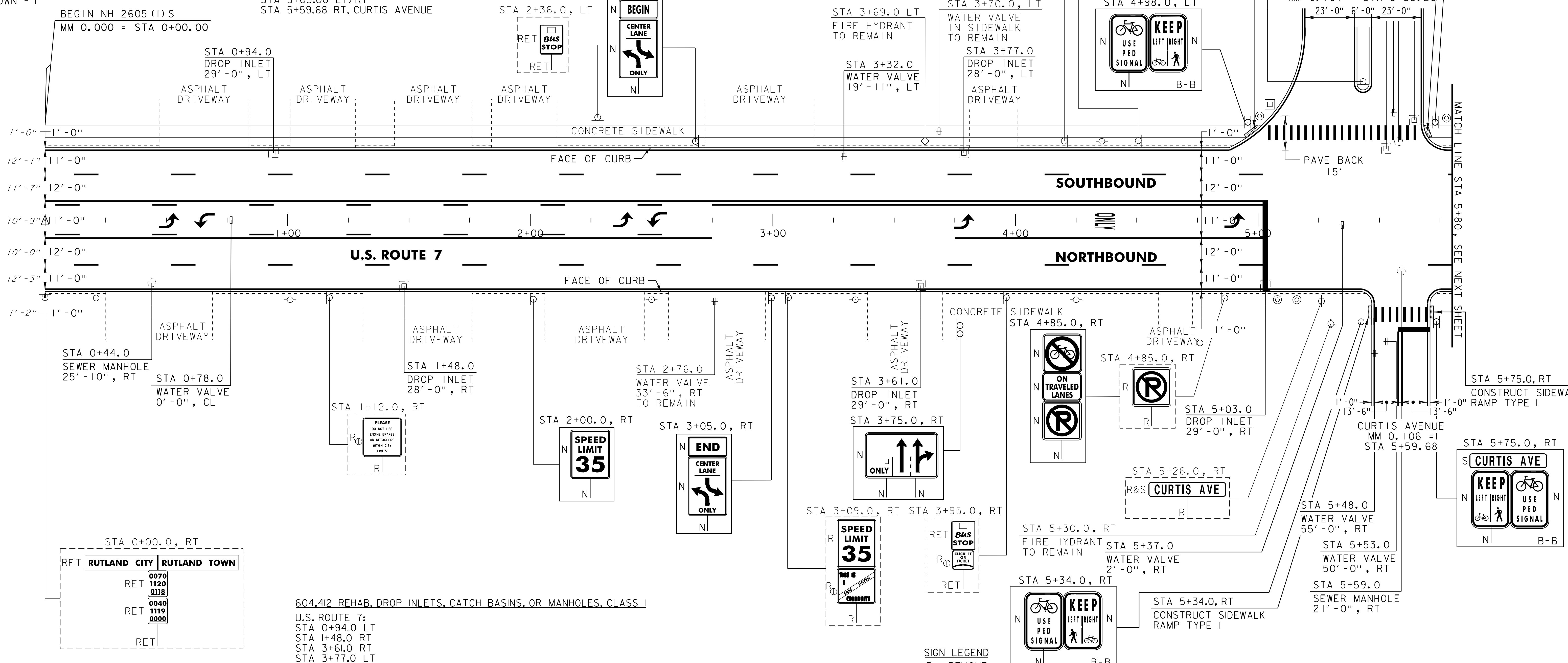

NOTES:
1. SEE SHEET 38 FOR VIDEO DETECTION SYSTEM SHEET.
2. PAVING LIMIT ON ALL TOWN HIGHWAYS SHALL BE MEASURED 25 FT BACK FROM U.S. ROUTE 7 EDGE OF SHOULDER UNLESS DENOTED OTHERWISE ON THE PLANS OR AS DIRECTED BY THE RESIDENT ENGINEER.

604.412 REHAB. DROP INLETS, CATCH BASINS, OR MANHOLES, CLASS I

U.S. ROUTE 7:
STA 0+94.0 LT
STA 1+48.0 RT
STA 3+61.0 RT
STA 3+77.0 LT
STA 5+03.0 RT
STA 5+55.0 LT
STA 5+69.0 LT

604.42 CHANGING ELEVATION OF SEWER MANHOLES

U.S. ROUTE 7:
STA 0+44.0 RT
~~STA 5+59.0 LT~~ STRUCTURE NOT TOUCHED
STA 5+59.0 RT

629.20 ADJUST ELEVATION OF VALVE BOX

U.S. ROUTE 7:
STA 0+78.0 CL
STA 3+32.0 LT
STA 5+37.0 RT
STA 5+47.0 LT NO VALVE FOUND
STA 5+48.0 RT
STA 5+53.0 RT

SIGN LEGEND
R = REMOVE
S = SALVAGE
N = NEW
RET = RETAIN
B-B = BACK TO BACK
EXISTING = _____
NEW = _____
⊙ = RETURN TO THE RUTLAND CITY

PROJECT LAYOUT SHEET #1

PROJECT NAME: RUTLAND CITY
PROJECT NUMBER: NH 2605(I)S
FILE NAME: p06d050.dgn
PROJECT LEADER: DEJ
DESIGNED BY: MJL
IPARM FILE: p06d050i01.i
PLOT DATE: 03-AUG-2012 12:2
DRAWN BY: C&K
CHECKED BY: DWE
SHEET 13 OF 76