

**NOTES**

1. THIS DETAIL SHOWS A TYPICAL APPLICATION OF THE EROSION CONTROL PLAN WHICH MAY CHANGE BASED ON SITE CONDITIONS. THE CONTRACTOR IS RESPONSIBLE FOR ENSURING ALL CONDITIONS OF THE CONSTRUCTION GENERAL PERMIT ARE ADHERED TO.
2. TEMPORARY EROSION CONTROL MEASURES ARE CONCEPTUALLY SHOWN. THE CONTRACTOR MAY RELOCATE TEMPORARY MEASURES TO IMPROVE EROSION CONTROL WITH APPROVAL OF THE RESIDENT ENGINEER AND ON SITE COORDINATOR.
3. THE CONTRACTOR SHALL USE OTHER TEMPORARY EROSION CONTROL MEASURES AS NECESSITATED BY THE SEQUENCE OF CONSTRUCTION OR AS DIRECTED BY THE RESIDENT ENGINEER AND ON SITE COORDINATOR.
4. REFER TO TEMPORARY EROSION CONTROL DETAIL SHEETS AND THE LOW-RISK HANDBOOK FOR ADDITIONAL DETAILS.
5. CONTRACTOR TO REMOVE ALL TEMPORARY EROSION CONTROL MEASURES.
6. SEED AND MULCH TO BE PAID FOR IN STP 2629 (I).

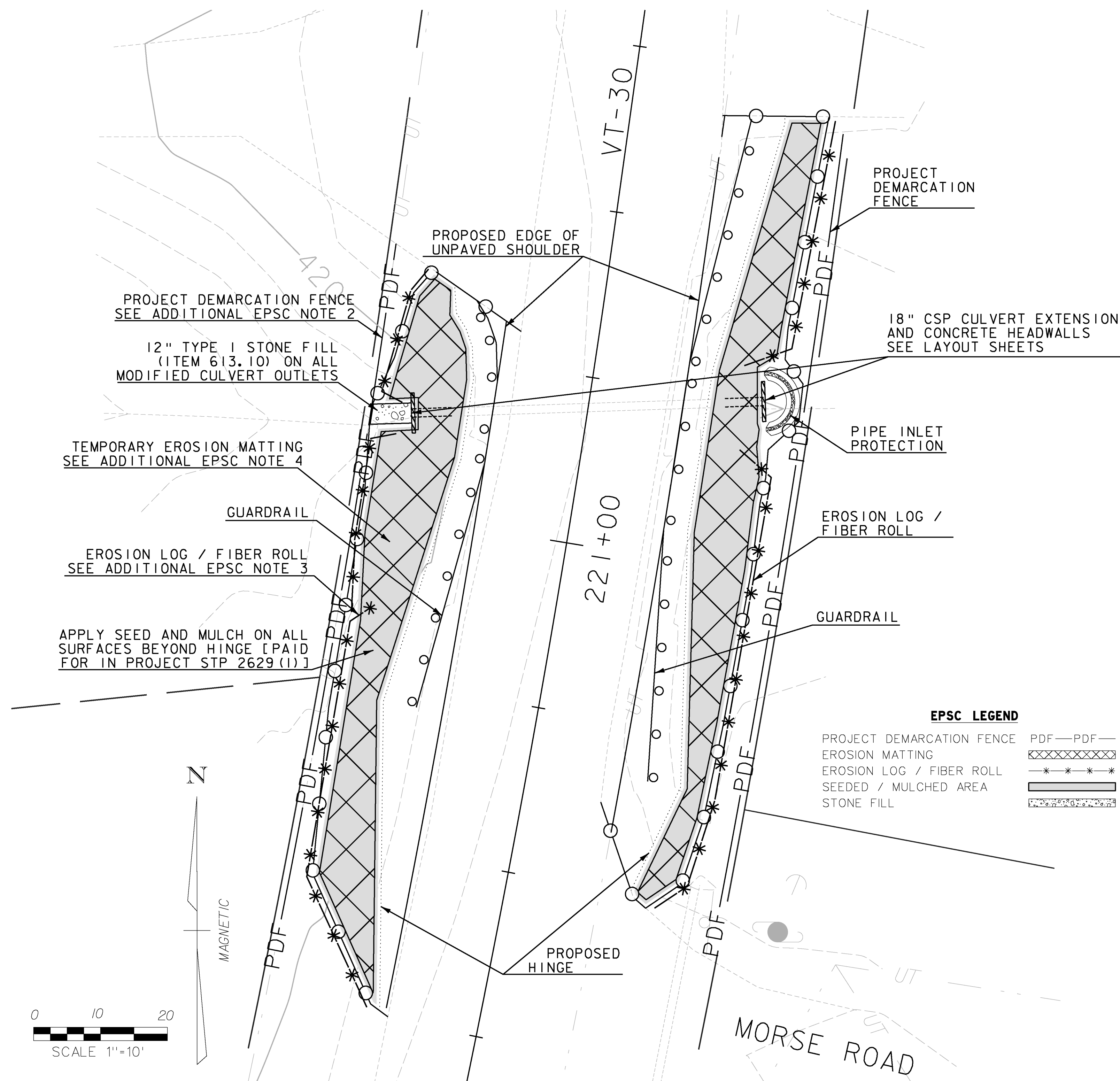

**EPSC LEGEND**

PROJECT DEMARCATION FENCE	PDF—PDF—
EROSION MATTING	XXXXXX
EROSION LOG / FIBER ROLL	—*—*—*
SEEDED / MULCHED AREA	▨
STONE FILL	▩

**ADDITIONAL EPSC NOTES:**

1. THE TYPICAL EPSC APPLICATION ILLUSTRATED SHALL BE APPLIED TO THE WHOLE LENGTH OF PROJECT. ALL APPLICABLE EPSC MEASURES AND DETAILS SHALL BE EMPLOYED WHEREVER REASONABLE.
2. PRIOR TO CONSTRUCTION, PLACE PROJECT DEMARCATION FENCING AS SHOWN ON PLANS ADJACENT TO THE RIGHT OF WAY, SENSITIVE FEATURES OR AS DIRECTED BY THE ENGINEER.
3. PLACE EROSION LOG ALONG TOE OF ALL SLOPES GREATER THAN 10 FEET IN LENGTH, ADJACENT TO ALL WETLANDS, AS SHOWN ON PLANS, AND AS DIRECTED BY THE ENGINEER. ON 100 FOOT INTERVALS OR AT THE INLET TO DRAINAGE DITCHES, CURVE SOCK UPSLOPE TO PROVIDE MINOR RUNOFF RETENTION. INSTALL PER MANUFACTURER'S RECOMMENDATION.
4. PLACE TEMPORARY EROSION MATTING (ITEM 653.20) ON ALL SLOPES STEEPER THAN 1:3. PLACE 12" TYPE 1 STONE (ITEM 613.10) ON SLOPES STEEPER THAN 1:2 AS SHOWN ON PLANS OR AS DIRECTED BY ENGINEER.
5. REMOVE PROJECT DEMARCATION FENCING AND EROSION LOG AT THE COMPLETION OF THE PROJECT OR AS DIRECTED BY ENGINEER.

**TYPICAL EPSC APPLICATION**

DATUM	VERTICAL	NAVD 88
	HORIZONTAL	NAD 83

NO.	DATE	REVISIONS	BY	CK'D

**RS&G INC.**  
RESOURCE SYSTEMS GROUP, INC.  
60 Lake Street, Unit 1E • Burlington, Vermont 05401  
TEL 802.393.0118 • FAX 802.393.0122 • www.rsginc.com

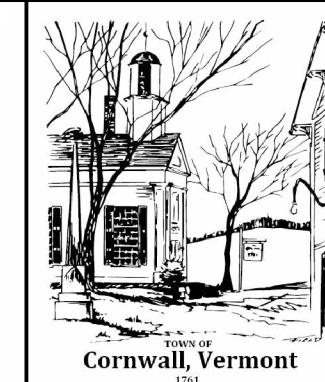

PROJECT NAME: CORNWALL - MIDDLEBURY  
PROJECT NUMBER: STP EH08(13)  
FILE NAME: Z08F122BDR EPSC.DGN  
PROJECT LEADER: MS  
DESIGNED BY: CM  
EPSC PLAN - EPSC DETAIL SHEET 1

PLOT DATE: 06/09/2010  
DRAWN BY: CM  
CHECKED BY: MS  
SHEET 82 OF 133