

646.402 DURABLE 4 INCH WHITE LINE, THERMOPLASTIC  
 (ALL LINES WILL INCLUDE EDGE LINE BREAKS AND RADIUS FOR TOWN HIGHWAYS)  
 RIPTON:  
 STA 50+00.00 - STA 63+00.00 EDGE LINE LT & RT

646.412 DURABLE 4 INCH YELLOW LINE, THERMOPLASTIC  
 (ALL LINES WILL INCLUDE C/L BREAKS FOR TOWN HIGHWAYS) S=SOLID, D=DASHED  
 RIPTON:  
 STA 50+00.00 - STA 63+00.00 LT C RT S - S

646.602 TEMPORARY 4 INCH WHITE LINE, PAINT  
 (ALL LINES WILL INCLUDE EDGE LINE BREAKS AND RADIUS FOR TOWN HIGHWAYS)  
 RIPTON:  
 STA 50+00.00 - STA 63+00.00 EDGE LINE LT & RT

646.612 TEMPORARY 4 INCH YELLOW LINE, PAINT  
 (ALL LINES WILL INCLUDE C/L BREAKS FOR TOWN HIGHWAYS) S=SOLID, D=DASHED  
 RIPTON:  
 STA 50+00.00 - STA 63+00.00 LT C RT S - S

675.50 REMOVING SIGNS  
 AS SHOWN - 25

675.60 ERECTING SALVAGED SIGNS  
 AS SHOWN - 6

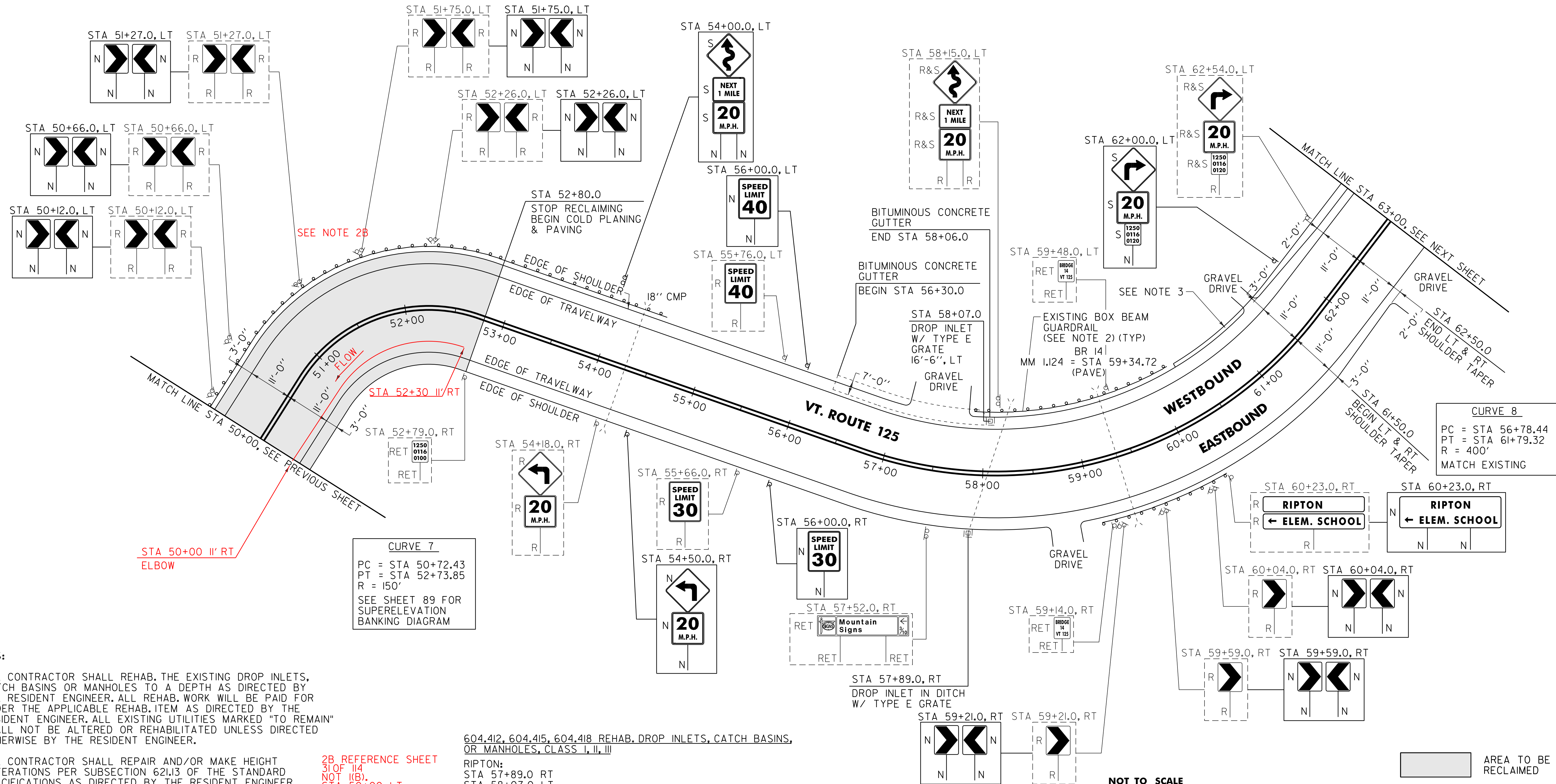

**CURVE 7**  
 PC = STA 50+72.43  
 PT = STA 52+73.85  
 R = 150'  
 SEE SHEET 89 FOR SUPERELEVATION BANKING DIAGRAM

**CURVE 8**  
 PC = STA 56+78.44  
 PT = STA 61+79.32  
 R = 400'  
 MATCH EXISTING

- NOTES:
- THE CONTRACTOR SHALL REHAB. THE EXISTING DROP INLETS, CATCH BASINS OR MANHOLES TO A DEPTH AS DIRECTED BY THE RESIDENT ENGINEER. ALL REHAB. WORK WILL BE PAID FOR UNDER THE APPLICABLE REHAB. ITEM AS DIRECTED BY THE RESIDENT ENGINEER. ALL EXISTING UTILITIES MARKED "TO REMAIN" SHALL NOT BE ALTERED OR REHABILITATED UNLESS DIRECTED OTHERWISE BY THE RESIDENT ENGINEER.
  - THE CONTRACTOR SHALL REPAIR AND/OR MAKE HEIGHT ALTERATIONS PER SUBSECTION 621.13 OF THE STANDARD SPECIFICATIONS AS DIRECTED BY THE RESIDENT ENGINEER BETWEEN RIPTON STA 50+00 AND STA 63+00 LT. ALL WORK SHALL BE PAID FOR UNDER ITEM 900.640 SPECIAL PROVISION (BOX BEAM GUARDRAIL REPAIRS, WEATHERING). AN ESTIMATED QUANTITY FOR THIS ITEM HAS BEEN INCLUDED IN THE PLAN SET. SEE SHEET 9 FOR AVAILABLE BOX BEAM GUARDRAIL INVENTORY.
  - SEE SHEET 87 FOR NEW DRAINAGE PLAN FROM STA 59+55.0 TO STA 63+45.0 LT.

2B REFERENCE SHEET  
 31 OF 114  
 NOT (K(B)).  
 STA 50+00 LT

604.412, 604.415, 604.418 REHAB. DROP INLETS, CATCH BASINS, OR MANHOLES, CLASS I, II, III  
 RIPTON:  
 STA 57+89.0 RT  
 STA 58+07.0 LT

616.35 TREATED TIMBER CURB  
 RIPTON:  
~~STA 58+00.0 - STA 60+00.0 LT (200.0 LF) - NOT PLACED USED EXISTING~~

616.47 BITUMINOUS CONCRETE GUTTERS AND TRAFFIC ISLANDS  
 RIPTON:  
 STA 56+30.0 - STA 58+06.0 LT (6.9 TON)

**SIGN LEGEND**  
 R = REMOVE  
 S = SALVAGE  
 N = NEW  
 RET = RETAIN  
 B-B = BACK TO BACK  
 EXISTING = - - - - -  
 NEW = \_\_\_\_\_

**PROJECT LAYOUT SHEET #5**

PROJECT NAME: RIPTON - HANCOCK  
 PROJECT NUMBER: STP 2803(1)  
 FILE NAME: p08cl60.dgn  
 PROJECT LEADER: D.E.G.  
 DESIGNED BY: M.J.M.  
 IPARM FILE: p08cl60105.i

PLOT DATE: 19-SEP-2013 11:15  
 DRAWN BY: C.A.K.  
 CHECKED BY: D.W.E.  
 SHEET 64 OF 114

NOT TO SCALE

AREA TO BE RECLAIMED