

646.402 DURABLE 4 INCH WHITE LINE, THERMOPLASTIC
 (ALL LINES WILL INCLUDE EDGE LINE BREAKS AND RADIUS FOR TOWN HIGHWAYS)
 MIDDLEBURY:
 STA 128+50.00 - STA 143+50.00 EDGE LINE LT & RT

646.412 DURABLE 4 INCH YELLOW LINE, THERMOPLASTIC
 (ALL LINES WILL INCLUDE C/L BREAKS FOR TOWN HIGHWAYS) S=SOLID, D=DASHED
 MIDDLEBURY: LT C RT
 STA 128+50.00 - STA 143+50.00 S - S
 STA 138+44.16 DOUBLE SOLID LT, TH-35

646.602 TEMPORARY 4 INCH WHITE LINE, PAINT
 (ALL LINES WILL INCLUDE EDGE LINE BREAKS AND RADIUS FOR TOWN HIGHWAYS)
 MIDDLEBURY:
 STA 128+50.00 - STA 143+50.00 EDGE LINE LT & RT

646.612 TEMPORARY 4 INCH YELLOW LINE, PAINT
 (ALL LINES WILL INCLUDE C/L BREAKS FOR TOWN HIGHWAYS) S=SOLID, D=DASHED
 MIDDLEBURY: LT C RT
 STA 128+50.00 - STA 143+50.00 S - S
 STA 138+44.16 DOUBLE SOLID LT, TH-35

646.482 DURABLE 24 INCH STOP BAR, THERMOPLASTIC
 MIDDLEBURY:
 STA 138+44.16 LT, TH-35

646.682 TEMPORARY 24 INCH STOP BAR, PAINT
 MIDDLEBURY:
 STA 138+44.16 LT, TH-35

646.492 DURABLE LETTER OR SYMBOL, THERMOPLASTIC
 MIDDLEBURY:
 STA 138+44.16 LT, TH-35 "S,T,O,P" (4 EA)

646.692 TEMPORARY LETTER OR SYMBOL, PAINT
 MIDDLEBURY:
 STA 138+44.16 LT, TH-35 "S,T,O,P" (4 EA)

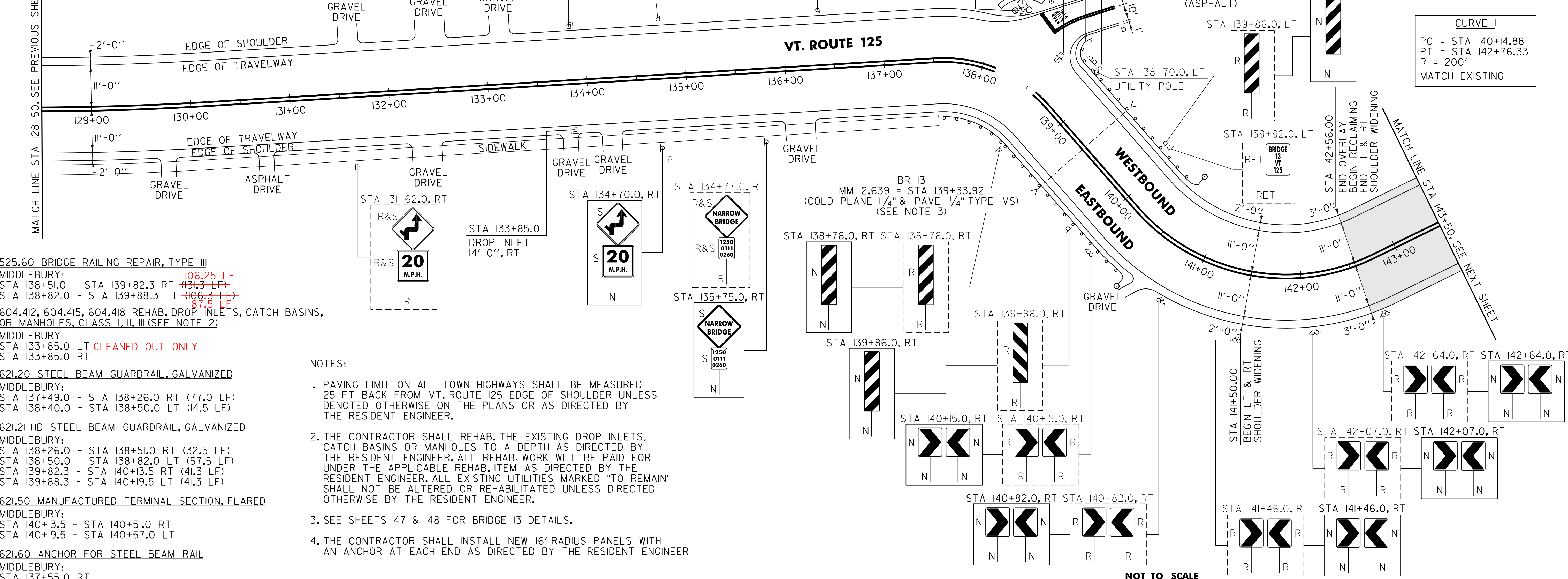

525.60 BRIDGE RAILING REPAIR, TYPE III
 MIDDLEBURY:
 STA 138+51.0 - STA 139+82.3 RT (106.25 LF)
 STA 138+82.0 - STA 139+88.3 LT (106.3 LF)
 STA 139+88.3 - STA 140+19.5 LT (87.5 LF)

604.412, 604.415, 604.418 REHAB. DROP INLETS, CATCH BASINS, OR MANHOLES, CLASS I, II, III (SEE NOTE 2)
 MIDDLEBURY:
 STA 133+85.0 LT CLEANED OUT ONLY
 STA 133+85.0 RT

621.20 STEEL BEAM GUARDRAIL, GALVANIZED
 MIDDLEBURY:
 STA 137+49.0 - STA 138+26.0 RT (77.0 LF)
 STA 138+40.0 - STA 138+50.0 LT (14.5 LF)

621.21 HD STEEL BEAM GUARDRAIL, GALVANIZED
 MIDDLEBURY:
 STA 138+26.0 - STA 138+51.0 RT (32.5 LF)
 STA 138+50.0 - STA 138+82.0 LT (57.5 LF)
 STA 139+82.3 - STA 140+13.5 RT (41.3 LF)
 STA 139+88.3 - STA 140+19.5 LT (41.3 LF)

621.50 MANUFACTURED TERMINAL SECTION, FLARED
 MIDDLEBURY:
 STA 140+13.5 - STA 140+51.0 RT
 STA 140+19.5 - STA 140+57.0 LT

621.60 ANCHOR FOR STEEL BEAM RAIL
 MIDDLEBURY:
 STA 137+55.0 RT
 STA 138+40.0 LT
 STA 138+66.5 LT

- NOTES:
- PAVING LIMIT ON ALL TOWN HIGHWAYS SHALL BE MEASURED 25 FT BACK FROM VT. ROUTE 125 EDGE OF SHOULDER UNLESS DENOTED OTHERWISE ON THE PLANS OR AS DIRECTED BY THE RESIDENT ENGINEER.
 - THE CONTRACTOR SHALL REHAB. THE EXISTING DROP INLETS, CATCH BASINS OR MANHOLES TO A DEPTH AS DIRECTED BY THE RESIDENT ENGINEER. ALL REHAB. WORK WILL BE PAID FOR UNDER THE APPLICABLE REHAB. ITEM AS DIRECTED BY THE RESIDENT ENGINEER. ALL EXISTING UTILITIES MARKED "TO REMAIN" SHALL NOT BE ALTERED OR REHABILITATED UNLESS DIRECTED OTHERWISE BY THE RESIDENT ENGINEER.
 - SEE SHEETS 47 & 48 FOR BRIDGE 13 DETAILS.
 - THE CONTRACTOR SHALL INSTALL NEW 16' RADIUS PANELS WITH AN ANCHOR AT EACH END AS DIRECTED BY THE RESIDENT ENGINEER

629.20 ADJUST ELEVATION OF VALVE BOX
 MIDDLEBURY:
 STA 138+56.0 LT

676.10 DELINEATOR WITH STEEL POST
 MIDDLEBURY:
 STA 140+51.0 RT
 STA 140+57.0 LT



SIGN LEGEND
 R = REMOVE
 S = SALVAGE
 N = NEW
 RET = RETAIN
 B-B = BACK TO BACK
 EXISTING =
 NEW =

NOT TO SCALE

PROJECT LAYOUT SHEET #7

PROJECT NAME: MIDDLEBURY	PROJECT NUMBER: STP 2627(1)
FILE NAME: p06c222.dgn	PLOT DATE: 19-SEP-2013 11:14
PROJECT LEADER: D.E.G.	DRAWN BY: C.A.K.
DESIGNED BY: M.J.L.	CHECKED BY: D.W.E.
IPARM FILE: p06c222107.1	SHEET 26 OF 114

675.50 REMOVING SIGNS AS SHOWN - 24
 675.60 ERECTING SALVAGED SIGNS AS SHOWN - 5

CURVE 1
 PC = STA 140+14.88
 PT = STA 142+76.33
 R = 200'
 MATCH EXISTING