

TEMPORARY 4in YELLOW LINE (PAINT)
 DURABLE 4in YELLOW LINE (THERMOPLASTIC)
 STA 246+00 TO ~~293+83~~
 295+10 SOLID LT&RT
 TEMPORARY 4in WHITE LINE (PAINT)
 DURABLE 4in WHITE LINE (THERMOPLASTIC)
 STA 246+00 TO ~~293+83~~
 295+10 SOLID LT&RT

~~DITCHING LOCATIONS (REFER TO SHEET 8 FOR DETAILS)~~
~~STA 246+70 TO 255+80 RT~~
~~STA 259+20 TO 274+20 RT~~
~~STA 277+20 TO 286+30 RT~~

RELOCATE MAILBOX, SINGLE SUPPORT
 STA 269+90 LT - I
 REHABILITATION OF C.B.'S, D.I.'S, OR M.H.'S
 STA 293+40 RT

PAVEMENT CORES -

#	TOTAL DEPTH (in)	SOLID CORE	DRAINABLE BASE	COMMENTS
9	4.5	NO	NO	1" RUTTING

NOTE:
 - NO PCC UNDER ANY CORES
 - NO CORES OVER ASPHALTED
 - NO SHOULDER CORES

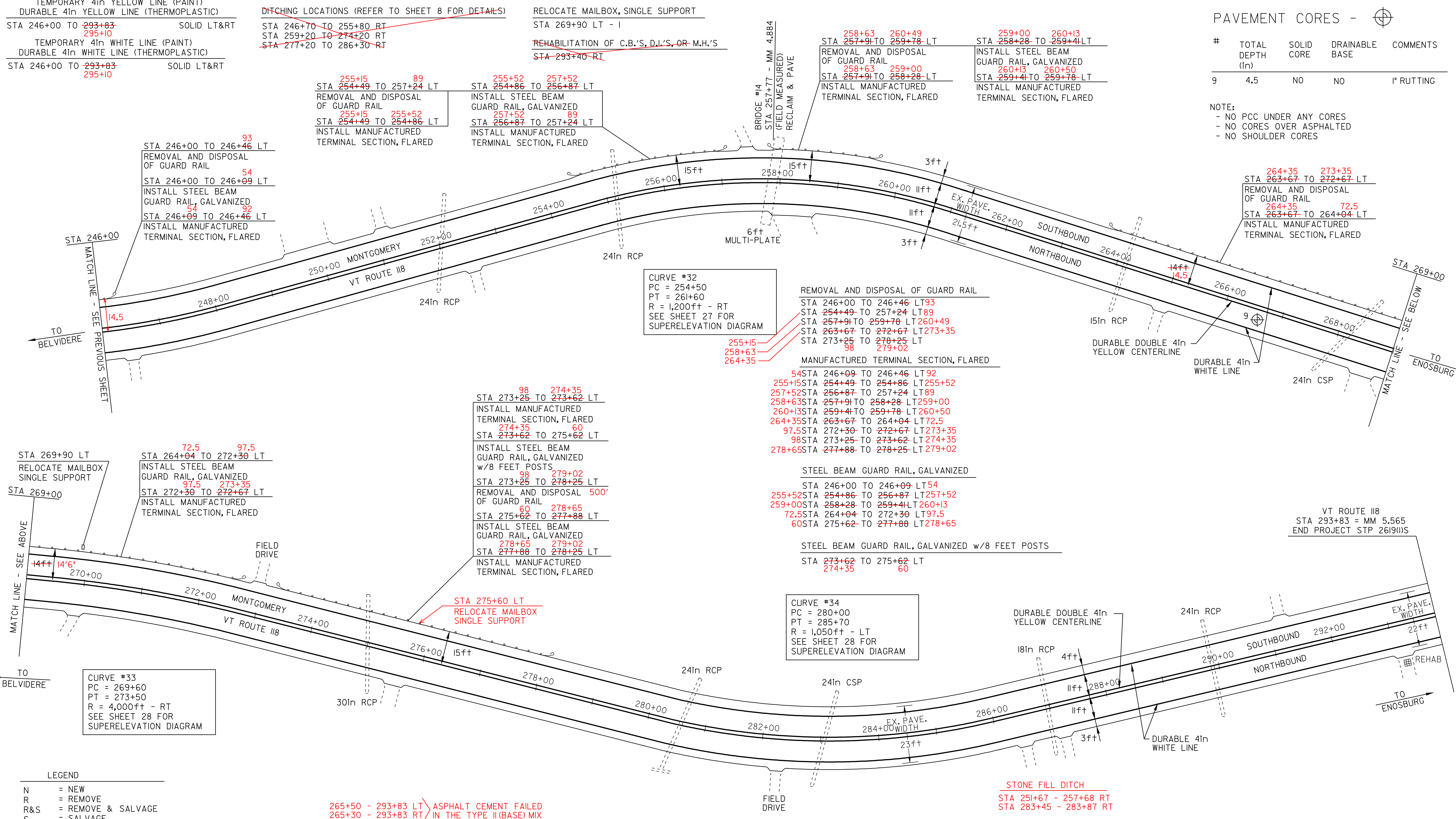

STA 269+90 LT
 RELOCATE MAILBOX
 SINGLE SUPPORT
 STA 269+00
 STA 264+04 TO 272+30 LT
 INSTALL STEEL BEAM
 GUARD RAIL, GALVANIZED
 97.5 273+35
 STA 272+30 TO 272+67 LT
 INSTALL MANUFACTURED
 TERMINAL SECTION, FLARED

98 274+35
 STA 273+25 TO 273+62 LT
 INSTALL MANUFACTURED
 TERMINAL SECTION, FLARED
 274+35 60
 STA 273+62 TO 275+62 LT
 INSTALL STEEL BEAM
 GUARD RAIL, GALVANIZED
 w/8 FEET POSTS
 98 279+02
 STA 273+25 TO 278+25 LT
 REMOVAL AND DISPOSAL
 OF GUARD RAIL 500'
 60 278+65
 STA 275+62 TO 277+88 LT
 INSTALL STEEL BEAM
 GUARD RAIL, GALVANIZED
 278+65 279+02
 STA 277+88 TO 278+25 LT
 INSTALL MANUFACTURED
 TERMINAL SECTION, FLARED

REMOVAL AND DISPOSAL OF GUARD RAIL
 STA 246+00 TO 246+46 LT 93
 STA 254+49 TO 257+24 LT 89
 STA 257+91 TO 259+78 LT 260+49
 STA 263+67 TO 272+67 LT 273+35
 STA 273+25 TO 278+25 LT 98
 279+02
 MANUFACTURED TERMINAL SECTION, FLARED
 54 STA 246+09 TO 246+46 LT 92
 255+15 STA 254+49 TO 254+86 LT 255+52
 257+52 STA 256+87 TO 257+24 LT 89
 258+63 STA 257+91 TO 258+28 LT 259+00
 260+13 STA 259+41 TO 259+78 LT 260+50
 264+35 STA 263+67 TO 264+04 LT 72.5
 97.5 STA 272+30 TO 272+67 LT 273+35
 98 STA 273+25 TO 273+62 LT 274+35
 278+65 STA 277+88 TO 278+25 LT 279+02

STEEL BEAM GUARD RAIL, GALVANIZED
 STA 246+00 TO 246+09 LT 54
 255+52 STA 254+86 TO 256+87 LT 257+52
 259+00 STA 258+28 TO 259+41 LT 260+13
 72.5 STA 264+04 TO 272+30 LT 97.5
 60 STA 275+62 TO 277+88 LT 278+65
 STEEL BEAM GUARD RAIL, GALVANIZED w/8 FEET POSTS
 STA 273+62 TO 275+62 LT
 274+35 60

CURVE #34
 PC = 280+00
 PT = 285+70
 R = 1,050ft - LT
 SEE SHEET 28 FOR
 SUPERELEVATION DIAGRAM

CURVE #33
 PC = 269+60
 PT = 273+50
 R = 4,000ft - RT
 SEE SHEET 28 FOR
 SUPERELEVATION DIAGRAM

265+50 - 293+83 LT ASPHALT CEMENT FAILED
 265+30 - 293+83 RT IN THE TYPE II (BASE) MIX

DITCHING LOCATIONS
 STA 249+48 - 251+67 RT
 STA 262+65 - 268+30 RT
 STA 270+73 - 272+15 RT
 STA 279+00 - 281+00 RT

- LEGEND
- N = NEW
 - R = REMOVE
 - R&S = REMOVE & SALVAGE
 - S = SALVAGE
 - RET = RETAIN
 - B-TO-B = BACK TO BACK
 - CATCH BASIN/DI
 - EXISTING THROAT DI
 - (N.W.) NO WORK REQUIRED (TYP. FOR W.V.'S, C.S.'S, D.I.'S, C.B.'S WHERE NOTED)
 - YIELDING MARKER POST
 - UTILITY POLE
 - DRIVE

PAVING PROJECT LAYOUT SHEET #9

DESIGNED BY	BCE/PJM	DATE	6-07
DRAWN BY	C.E.A., INC.	DATE	6-07
DESIGN FILE NO.	p06cl62.dgn		
PRF FILE	p06cl62pp19.i	DATE PLOTTED	03-NOV-2009
PROJ. NAME	BELVIDERE - MONTGOMERY		
PROJ. NO.	STP 2619(1)S		
SHEET	17	OF	33 SHEETS