

TEMPORARY 4in YELLOW LINE (PAINT)
 DURABLE 4in YELLOW LINE (THERMOPLASTIC)

65 STA 29+57 TO 34+30 25
 25 STA 34+30 TO 41+70 57
 57 STA 41+70 TO 42+20 15
 15 STA 42+20 TO 49+10 05
 05 STA 49+10 TO 75+50

SOLID LT&RT
 SOLID LT & DASHED RT
 SOLID LT&RT
 DASHED LT & SOLID RT
 SOLID LT&RT

TEMPORARY 4in WHITE LINE (PAINT)
 DURABLE 4in WHITE LINE (THERMOPLASTIC)

STA 29+57 TO 75+50
 65

SOLID LT&RT

CURVE #1
 PC = 32+10
 PT = 37+50
 R = 2,000ft - RT
 SEE SHEET 18 FOR
 SUPERELEVATION DIAGRAM

CURVE #2
 PC = 45+60
 PT = 51+90
 R = 1,900ft - LT
 SEE SHEET 18 FOR
 SUPERELEVATION DIAGRAM

CURVE #4
 PC = 62+10
 PT = 67+40
 R = 2,000ft - LT
 SEE SHEET 19 FOR
 SUPERELEVATION DIAGRAM

CURVE #3
 PC = 55+60
 PT = 58+00
 R = 5,000ft - RT
 SEE SHEET 19 FOR
 SUPERELEVATION DIAGRAM

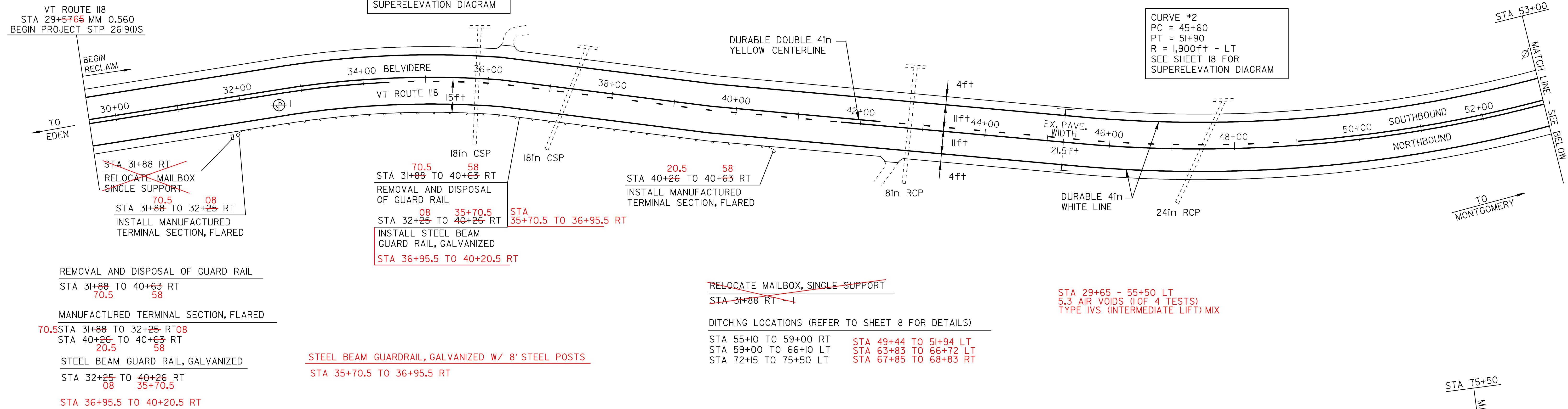

REMOVAL AND DISPOSAL OF GUARD RAIL
 STA 31+88 TO 40+63 RT
 70.5 58

MANUFACTURED TERMINAL SECTION, FLARED
 70.5 STA 31+88 TO 32+25 RT 08
 20.5 STA 40+26 TO 40+63 RT 58

STEEL BEAM GUARD RAIL, GALVANIZED
 STA 32+25 TO 40+26 RT 08
 35+70.5

STA 36+95.5 TO 40+20.5 RT

~~RELOCATE MAILBOX, SINGLE SUPPORT~~
~~STA 31+88 RT~~

DITCHING LOCATIONS (REFER TO SHEET 8 FOR DETAILS)
 STA 55+10 TO 59+00 RT
 STA 59+00 TO 66+10 LT
 STA 72+15 TO 75+50 LT

STA 49+44 TO 51+94 LT
 STA 63+83 TO 66+72 LT
 STA 67+85 TO 68+83 RT

STA 29+65 - 55+50 LT
 5.3 AIR VOIDS (1 OF 4 TESTS)
 TYPE IVS (INTERMEDIATE LIFT) MIX

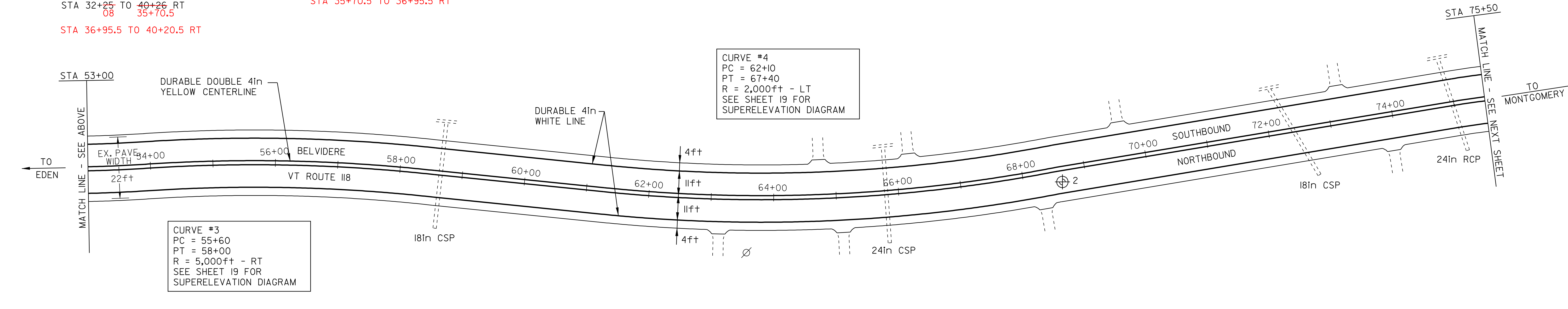

PAVEMENT CORES - ⊕

#	TOTAL DEPTH (in)	SOLID CORE	DRAINABLE BASE	COMMENTS
1	5.0	NO	YES	RUT 1 1/2" S.B.
2	4.0	YES	YES	RUT 1/2"

NOTE:
 - NO PCC UNDER ANY CORES
 - NO CORES OVER ASPHALTED
 - NO SHOULDER CORES

- LEGEND
- N = NEW
 - R = REMOVE
 - R&S = REMOVE & SALVAGE
 - S = SALVAGE
 - RET = RETAIN
 - B-TO-B = BACK TO BACK
 - ⊕ ⊞ □ CATCH BASIN/DI
 - ⊙ ⊞ EXISTING THROAT DI
 - (N.W.) NO WORK REQUIRED (TYP. FOR W.V.'S, C.S.'S, D.I.'S, C.B.'S WHERE NOTED)
 - ⊥ YIELDING MARKER POST
 - ⊕ UTILITY POLE
 - DRIVE

PAVING PROJECT LAYOUT SHEET #1

DESIGNED BY BCE/PJM DATE 6-07
 DRAWN BY C.E.A., INC. DATE 6-07
 DESIGN FILE NO. p06cl62.dgn
 PRF FILE p06cl62pp1.i DATE PLOTTED 03-NOV-2009
 PROJ. NAME **BELVIDERE - MONTGOMERY**
 PROJ. NO. **STP 2619(1)S**
 SHEET **9** OF **33** SHEETS