

INDEX OF SHEETS
SEE SHEET 2

SPECIFICATIONS

- DESIGN:
- A. VERMONT AGENCY OF TRANSPORTATION, STRUCTURES DESIGN MANUAL, 5TH EDITION, 2010
 - B. AASHTO LRFD BRIDGE DESIGN SPECIFICATION, 6TH EDITION, WITH 2013 INTERIM REVISIONS
 - C. AREMA MANUAL FOR RAILWAY ENGINEERING, 2012
 - D. VERMONT AGENCY OF TRANSPORTATION, RAIL BRIDGE MANAGEMENT PROGRAM MANUAL, VERSION 2.2, 2014

STATE OF VERMONT AGENCY OF TRANSPORTATION



PROPOSED IMPROVEMENT CULVERT PROJECT

TOWN OF RYEGATE
COUNTY OF CALEDONIA
US 5 (MAJOR COLLECTOR), BRIDGE NO 116
WASHINGTON COUNTY RAILROAD (WACR), CULVERT NO 27-E

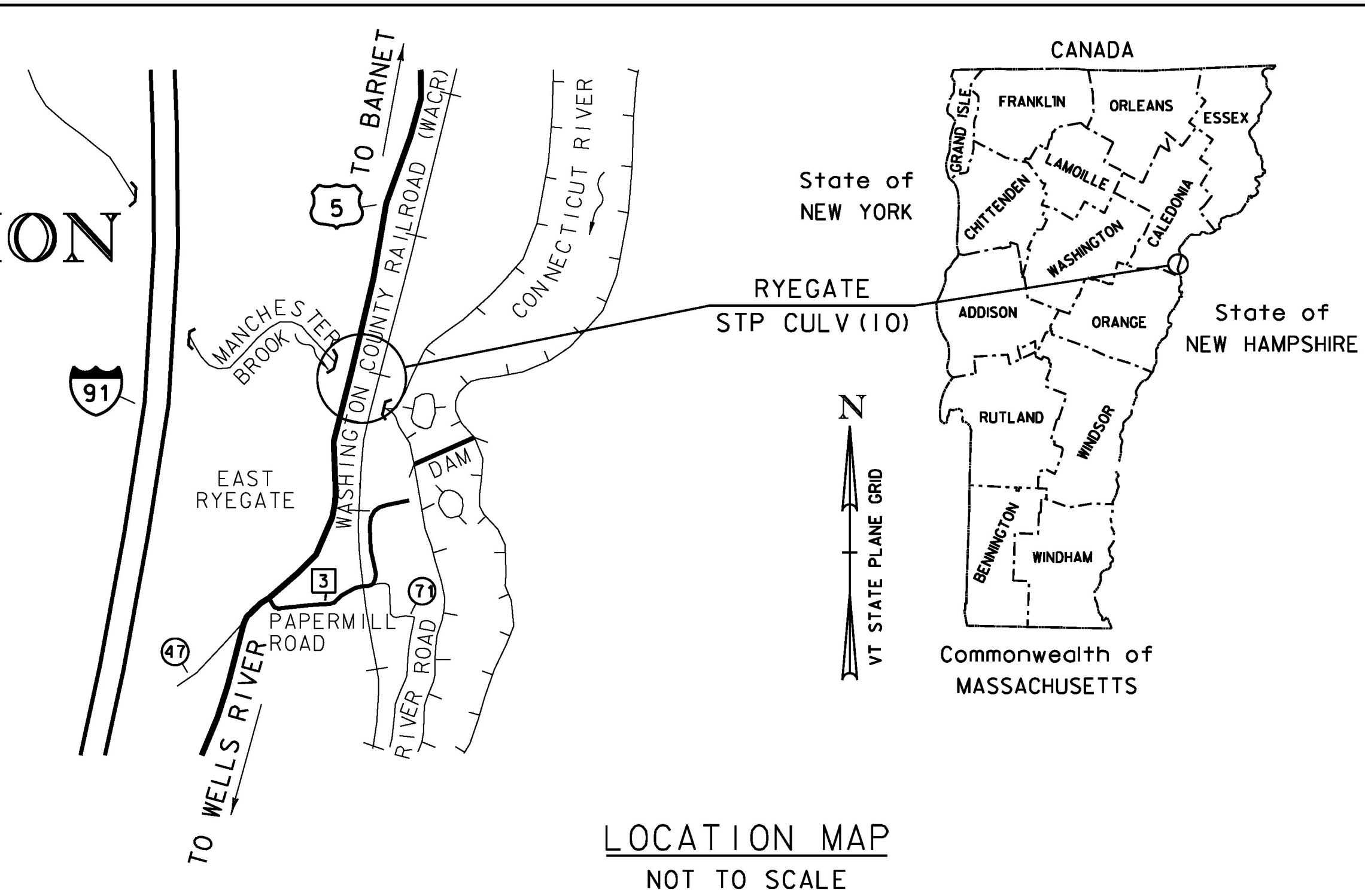

RECORD PLANS

Ryegate Design-Build Project STP CULV (10)

Resident Engineer: Nick Newland

Contractor: Engineers Construction, Inc.

Start Date: 07-14-2014

Completion Date: 08-28-2017

Prepared By: Jason Rowell

PROJECT LOCATION: LOCATED IN THE COUNTY OF CALEDONIA, TOWN OF RYEGATE, ON US 5 & WACR; BRIDGE NO. 116/CULVERT NO. 27-E (MP 59.43) OVER MANCHESTER BROOK, APPROXIMATELY 0.4 MILES NORTH OF THE INTERSECTION OF PAPERMILL ROAD (TH 3) AND US 5.

PROJECT DESCRIPTION: INSTALL TRAFFIC CONTROL, REPLACE BRIDGE 116, AND REPLACE CULVERT NO. 27-E. ROADWAY AND RAIL APPROACH AND CHANNEL IMPROVEMENTS.

LENGTH OF US 5 STRUCTURE: 40.20 FEET (144.00 FEET ALONG CHANNEL LINE)
 LENGTH OF WACR STRUCTURE: 37.03 FEET (128.00 FEET ALONG CHANNEL LINE)
 LENGTH OF ROADWAY: 109.80 FEET
 LENGTH OF RAILROAD: 187.97 FEET

PLAN SECTIONS:

- Section 1: (3.1.1.1 Culvert Plans)
- Section 2: (3.3.2.1 and 3.3.2.2 Roadway & Railway Plans)
- Section 3: (Abandoned Structures)

- Section 1: (3.1.1.1 Culvert Plans)

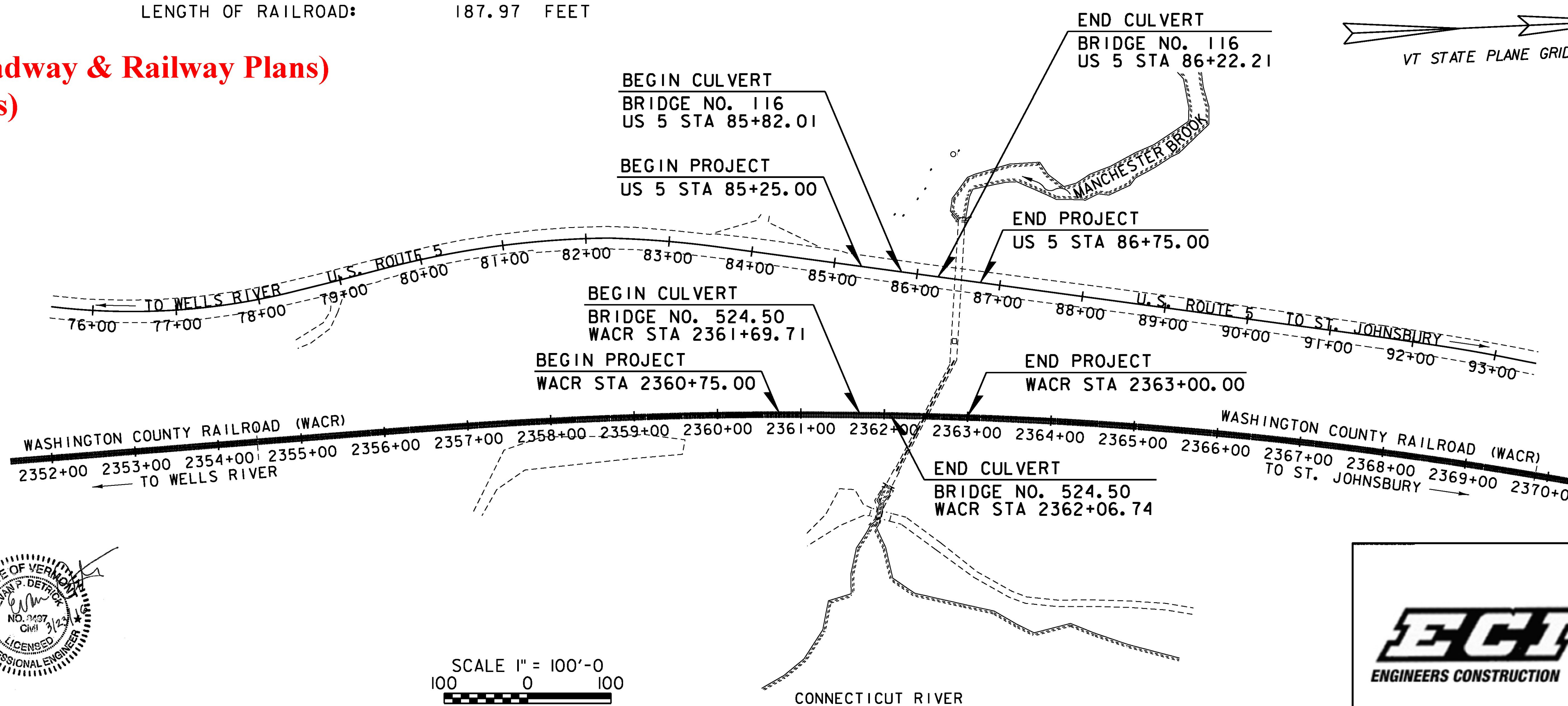

RELEASED FOR
CONSTRUCTION
April 19, 2016

100% WACR & US
ROUTE 5 CULVERTS
PLANS WP 3.3.1
MARCH 23 2016

DEPARTMENT OF TRANSPORTATION
FEDERAL HIGHWAY ADMINISTRATOR

APPROVED _____ DATE _____

DIRECTOR OF PROJECT DELIVERY

APPROVED _____ DATE _____

PROJECT MANAGER : MAHENDRA THILLIYAR, P. E.

PROJECT NAME : RYEGATE
PROJECT NUMBER : STP CULV (10)

SHEET 1 OF 36 SHEETS

CONSTRUCTION IS TO BE CARRIED ON IN ACCORDANCE WITH THESE PLANS AND THE STANDARD SPECIFICATIONS FOR CONSTRUCTION DATED 2011, AS APPROVED BY THE FEDERAL HIGHWAY ADMINISTRATION ON JULY 20, 2011 FOR USE ON THIS PROJECT, INCLUDING ALL SUBSEQUENT REVISIONS AND SUCH REVISED SPECIFICATIONS AND SPECIAL PROVISIONS AS ARE INCORPORATED IN THESE PLANS.

QUALITY ASSURANCE PROGRAM : LEVEL I	
SURVEYED BY :	VTRANS
SURVEYED DATE :	2006 - 2010
DATUM	
VERTICAL	NAVD 88
HORIZONTAL	NAD 83

