

646.426 DURABLE 6 INCH WHITE LINE, RECESSED POLYUREA

U.S. ROUTE 4 WESTBOUND:
STA 17+00.0 - STA 23+00.00 EDGE LINE C/L

646.622 TEMPORARY 6 INCH WHITE LINE, PAINT

U.S. ROUTE 4 WESTBOUND:
STA 17+00.0 - STA 23+00.00 EDGE LINE C/L

646.436 DURABLE 6 INCH YELLOW LINE, RECESSED POLYUREA

U.S. ROUTE 4 WESTBOUND:
STA 17+00.0 - STA 23+00.00 EDGE LINE RT

646.632 TEMPORARY 6 INCH YELLOW LINE, PAINT

U.S. ROUTE 4 WESTBOUND:
STA 17+00.0 - STA 23+00.00 EDGE LINE RT

675.50 REMOVING SIGNS

AS SHOWN - 5

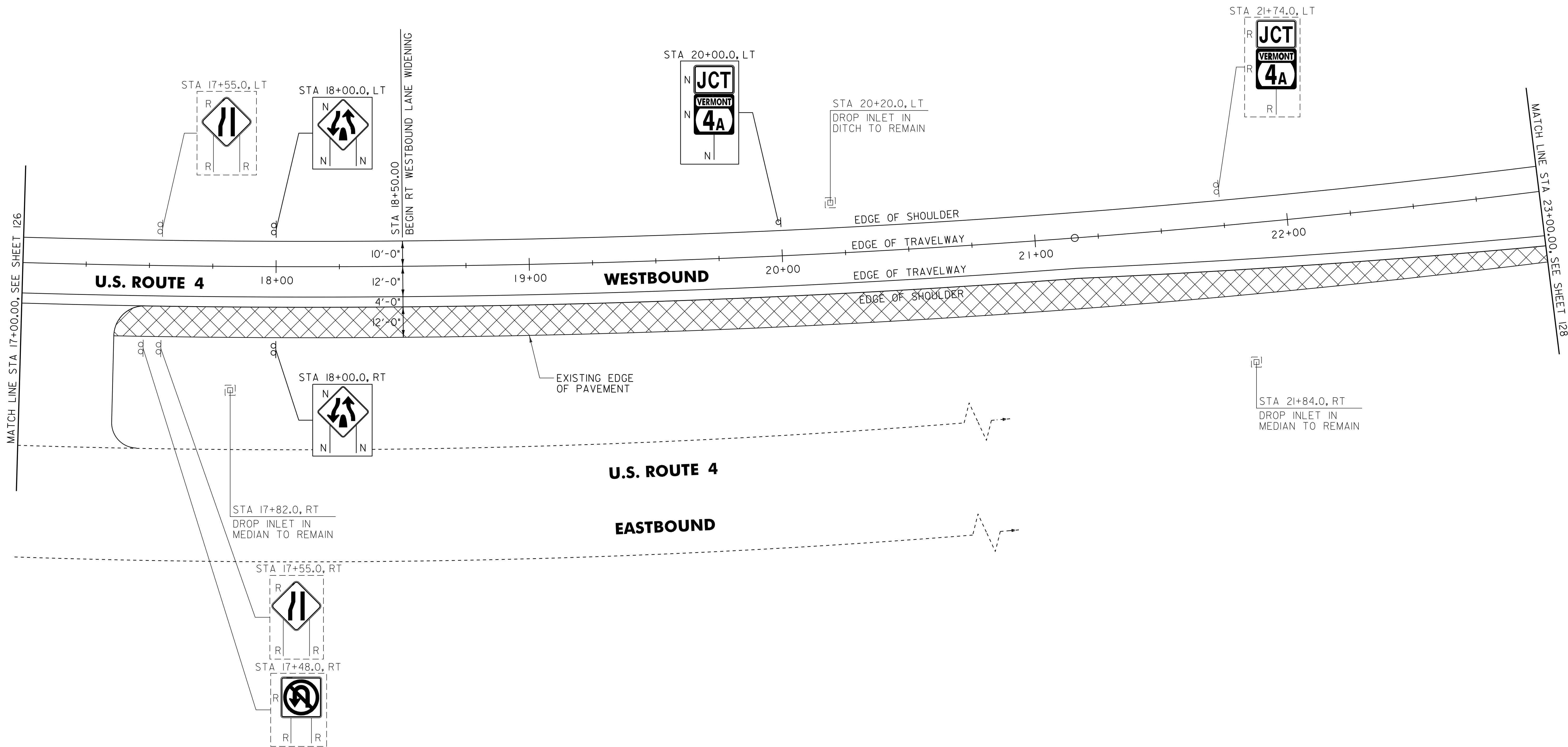

MATCH LINE STA 17+00.00, SEE SHEET 126

MATCH LINE STA 23+00.00, SEE SHEET 128

LEGEND

 REMOVAL OF EXISTING PAVEMENT

213.10 MILLED RUMBLE STRIPS

U.S. ROUTE 4 WESTBOUND:
STA 17+00.0 - STA 23+00.0 LT (600.0 LF)
STA 18+10.0 - STA 23+00.0 RT (490.0 LF)

SIGN LEGEND

R = REMOVE
S = SALVAGE
N = NEW
RET = RETAIN
B-B = BACK TO BACK
EXISTING = - - - - -
NEW = _____

NOT TO SCALE

PROJECT LAYOUT SHEET #4

PROJECT NAME: FAIR HAVEN	PLOT DATE: 22-FEB-2012 12:57
PROJECT NUMBER: NH HES 020-K21	DRAWN BY: C.A.K.
FILE NAME: 08b234.dgn	CHECKED BY: D.E.G.
PROJECT LEADER: D.E.G.	SHEET 127 OF 157
DESIGNED BY: M.J.M.	
DWG. NO. 08b234104.i	