

646.402 DURABLE 4 INCH WHITE LINE, THERMOPLASTIC
 (ALL LINES WILL INCLUDE EDGE LINE BREAKS AND RADIUS FOR TOWN HIGHWAYS)
 CASTLETON:
 STA 92+00.00 - STA 99+00.00 LT & RT
 STA 92+00.00 - STA 93+50.00 DOTTED LANE LINE RT
 STA 93+50.00 - STA 94+25.00 SOLID LANE LINE RT
 STA 95+45.00 - STA 96+05.00 SOLID LANE LINE LT
 STA 96+05.00 - STA 97+85.00 DOTTED LANE LINE LT

646.602 TEMPORARY 4 INCH WHITE LINE, PAINT
 (ALL LINES WILL INCLUDE EDGE LINE BREAKS AND RADIUS FOR TOWN HIGHWAYS)
 CASTLETON:
 STA 92+00.00 - STA 99+00.00 LT & RT
 STA 92+00.00 - STA 93+50.00 DOTTED LANE LINE RT
 STA 93+50.00 - STA 94+25.00 SOLID LANE LINE RT
 STA 95+45.00 - STA 96+05.00 SOLID LANE LINE LT
 STA 96+05.00 - STA 97+85.00 DOTTED LANE LINE LT

646.412 DURABLE 4 INCH YELLOW LINE, THERMOPLASTIC
 (ALL LINES WILL INCLUDE C/L BREAKS FOR TOWN HIGHWAYS) S=SOLID, D=DASHED
 CASTLETON:
 STA 93+50.00 - STA 94+27.00 LT C RT S
 STA 94+43.00 - STA 96+05.00 S S
 STA 94+82.88 DOUBLE SOLID LT, VT. ROUTE 30
 STA 94+82.88 DOUBLE SOLID RT, VT. ROUTE 30
 STA 92+00.00 - STA 93+50.00 DOUBLE SOLID MEDIAN LT & RT
 STA 96+05.00 - STA 99+00.00 DOUBLE SOLID MEDIAN LT & RT

646.612 TEMPORARY 4 INCH YELLOW LINE, PAINT
 (ALL LINES WILL INCLUDE C/L BREAKS FOR TOWN HIGHWAYS) S=SOLID, D=DASHED
 CASTLETON:
 STA 93+50.00 - STA 94+27.00 LT C RT S
 STA 94+43.00 - STA 96+05.00 S S
 STA 94+82.88 DOUBLE SOLID LT, VT. ROUTE 30
 STA 94+82.88 DOUBLE SOLID RT, VT. ROUTE 30
 STA 92+00.00 - STA 93+50.00 DOUBLE SOLID MEDIAN LT & RT
 STA 96+05.00 - STA 99+00.00 DOUBLE SOLID MEDIAN LT & RT

646.442 DURABLE 8 INCH WHITE LINE, THERMOPLASTIC
 CASTLETON:
 STA 93+11.0 - STA 93+23.0 FIRE HYDRANT NO PARKING ZONE, LT
 STA 97+48.0 - STA 94+60.0 FIRE HYDRANT NO PARKING ZONE, LT

646.452 DURABLE 8 INCH YELLOW LINE, THERMOPLASTIC
 CASTLETON:
 STA 92+00.00 - STA 93+50.00 HATCHED MEDIAN LT & RT
 STA 96+05.00 - STA 99+00.00 HATCHED MEDIAN LT & RT

646.482 DURABLE 24 INCH STOP BAR, THERMOPLASTIC
 CASTLETON:
 STA 94+26.00 LT/RT
 STA 94+82.88 LT, VT. ROUTE 30
 STA 94+82.88 RT, VT. ROUTE 30
 STA 95+44.00 LT/RT

646.682 TEMPORARY 24 INCH STOP BAR, PAINT
 CASTLETON:
 STA 94+26.00 LT/RT
 STA 94+82.88 LT, VT. ROUTE 30
 STA 94+82.88 RT, VT. ROUTE 30
 STA 95+44.00 LT/RT

646.502 DURABLE CROSSWALK MARKING, THERMOPLASTIC
 CASTLETON:
 STA 94+35.00 LT/RT
 STA 94+82.88 LT

***604.42 CHANGING ELEVATION OF S.M.H. STA 94+70 RT**

~~604.412, 604.415 OR 604.418~~
 REHAB. DROP INLETS, CATCH BASINS, OR MANHOLES (SEE NOTE 2)

CASTLETON:
 STA 93+26.0 LT STA 95+16 RT
~~STA 94+19.0 LT STA 95+16 LT~~
 STA 96+20.0 RT STA 94+70 LT
 STA 96+54.0 LT
 STA 94+67 RT

NOTES:
 1. SEE SHEET 47 FOR VEHICLE LOOP LAYOUT SHEET.

2. THE CONTRACTOR SHALL REHAB. THE EXISTING DROP INLETS, CATCH BASINS OR MANHOLES TO A DEPTH AS DIRECTED BY THE RESIDENT ENGINEER. ALL REHAB. WORK WILL BE PAID FOR UNDER THE APPLICABLE REHAB. ITEM AS DIRECTED BY THE RESIDENT ENGINEER. ALL EXISTING UTILITIES MARKED "TO REMAIN" SHALL NOT BE ALTERED OR REHABILITATED UNLESS DIRECTED OTHERWISE BY THE RESIDENT ENGINEER.

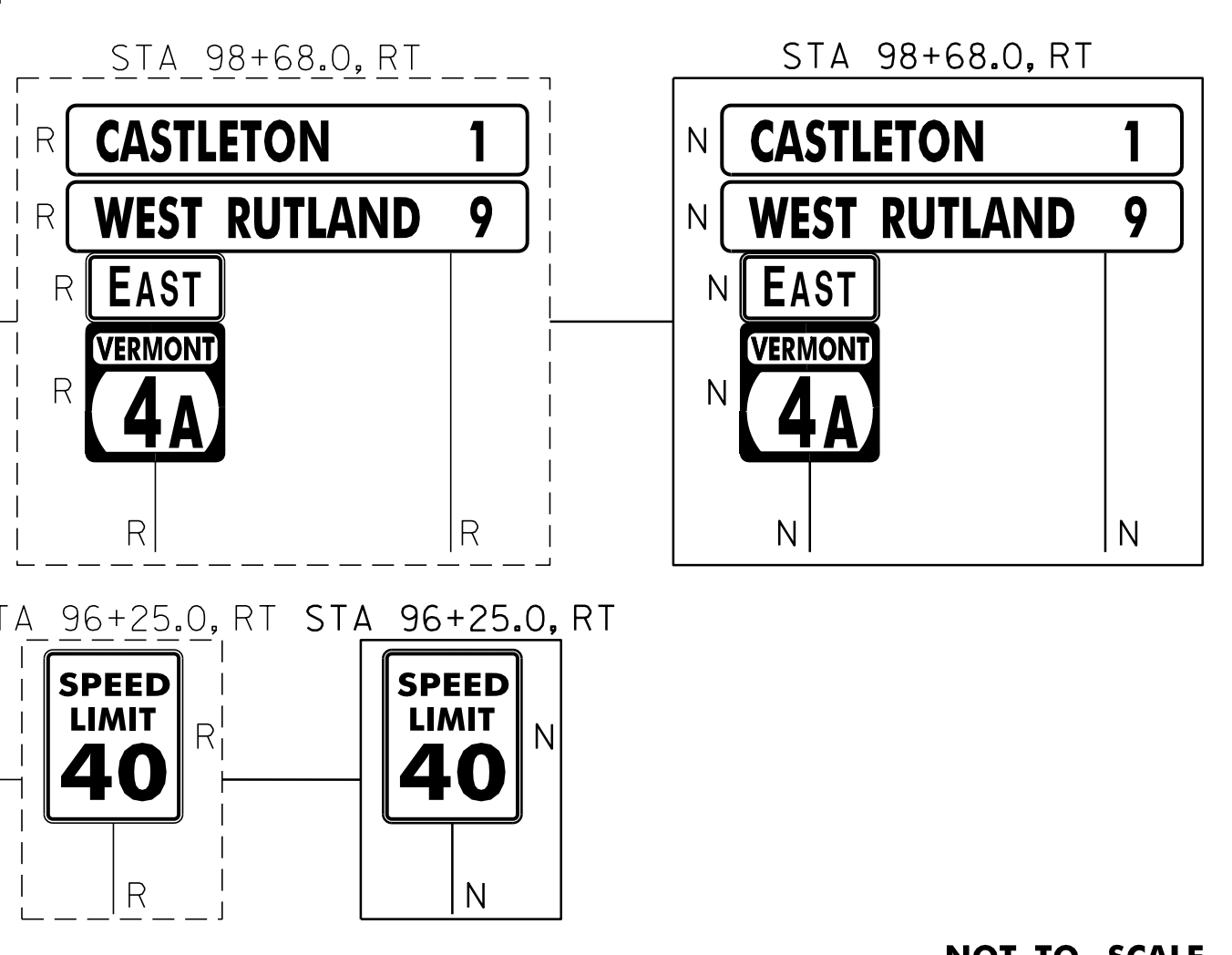
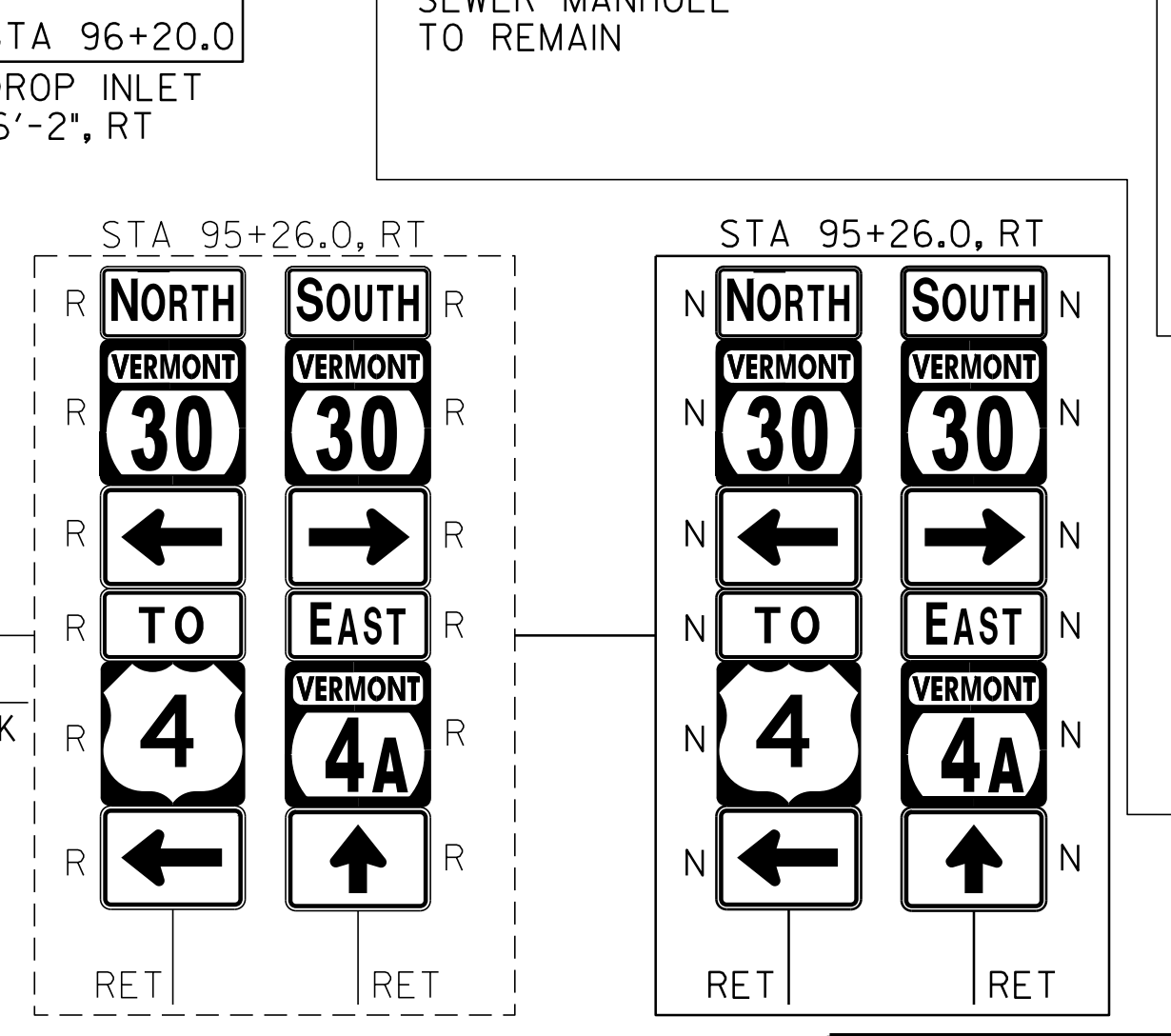
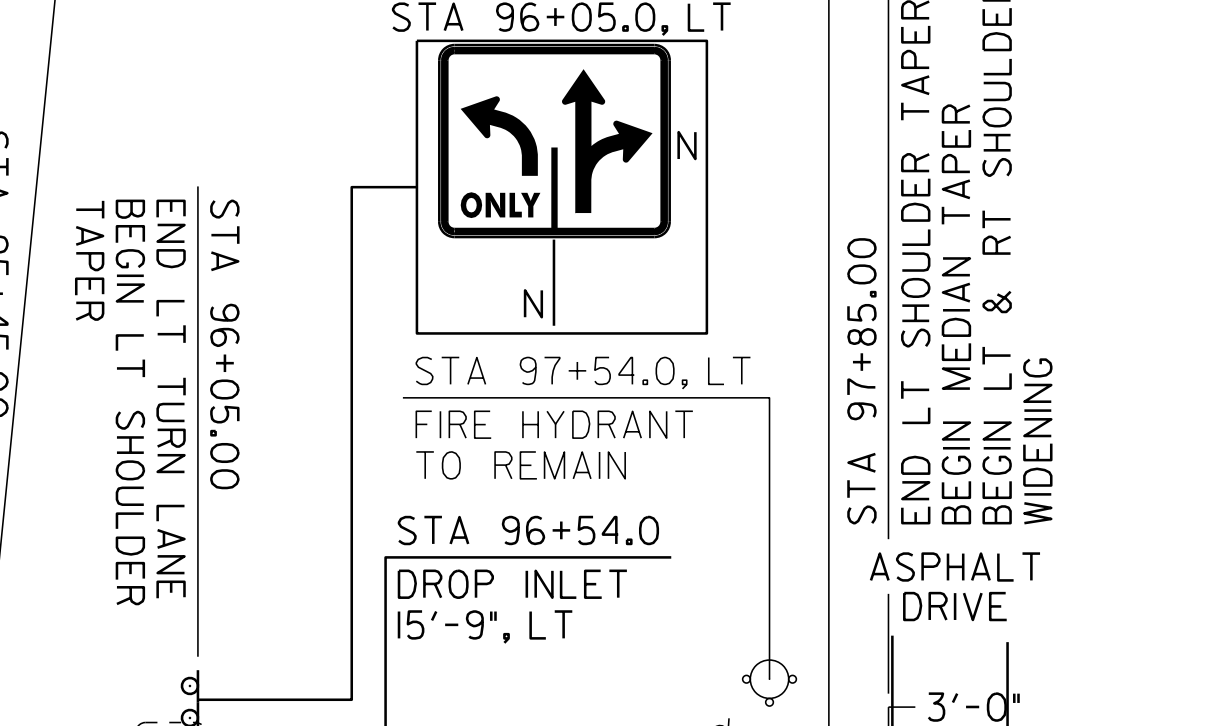
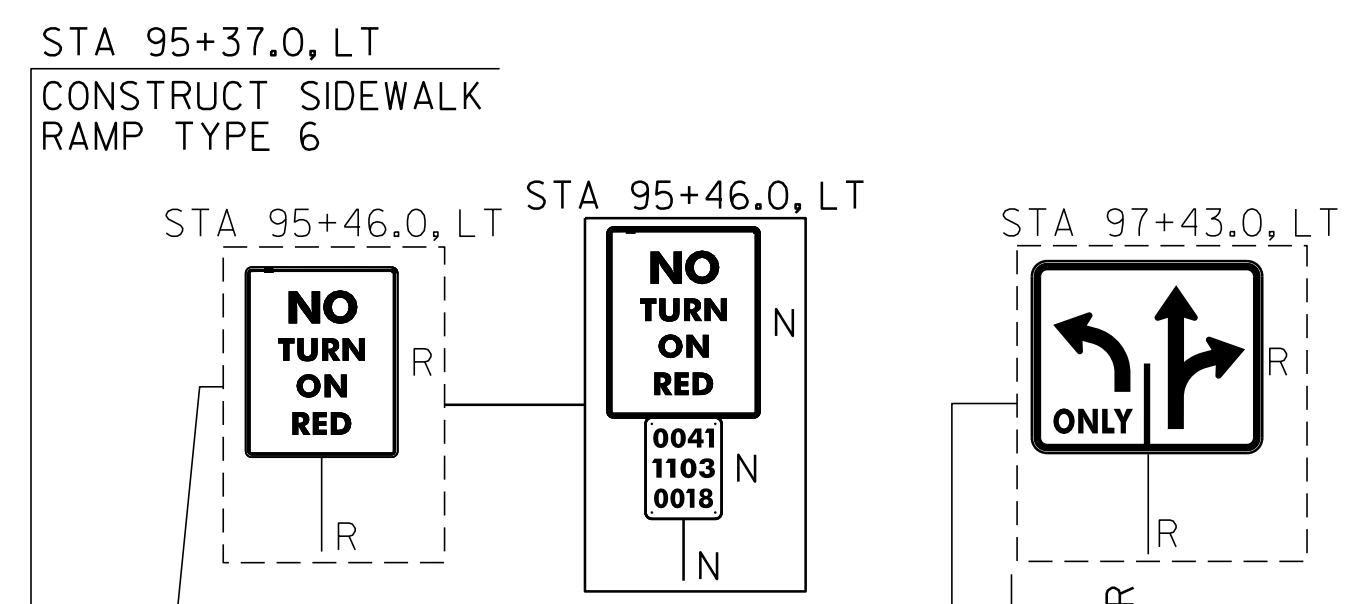
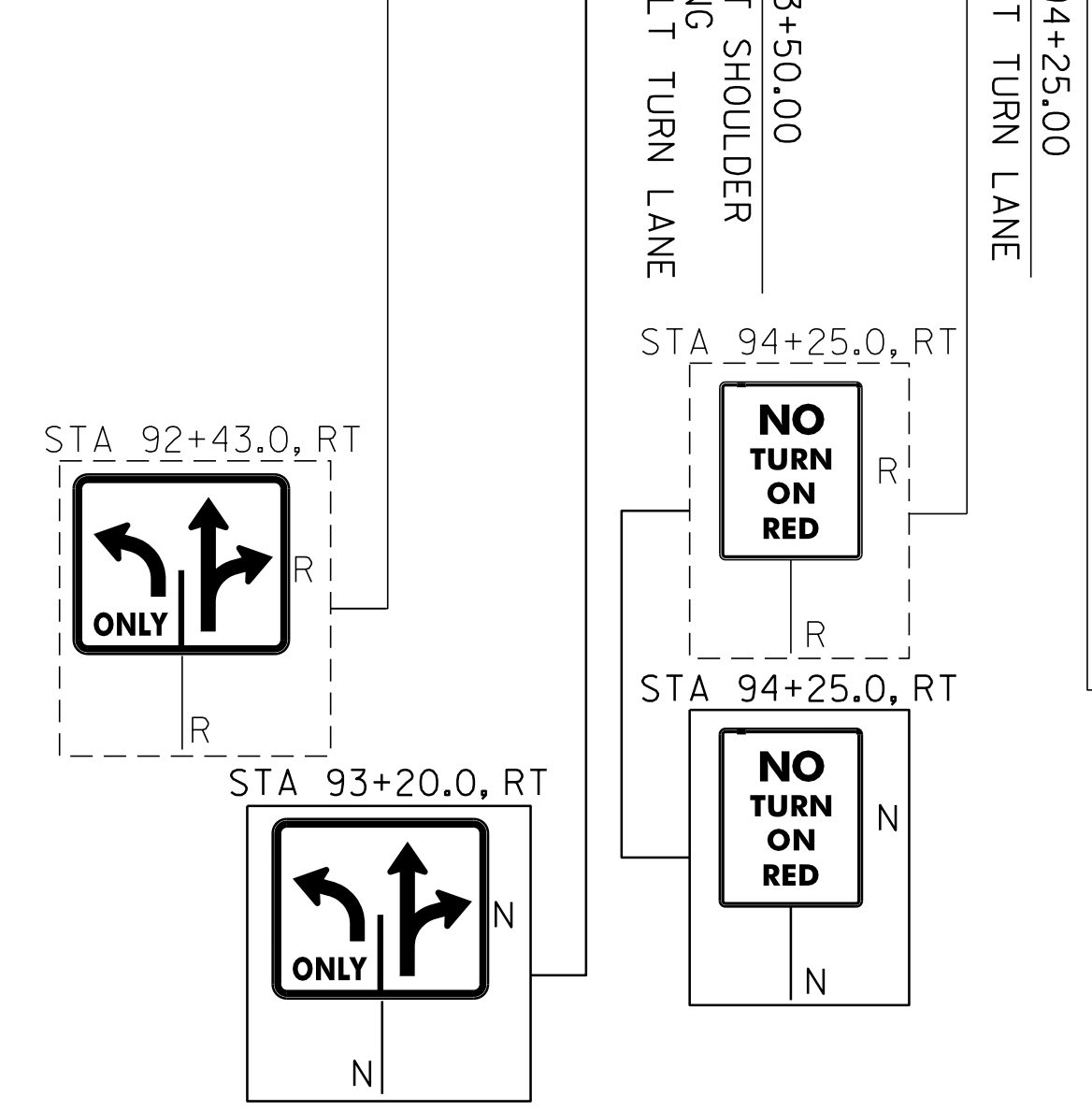
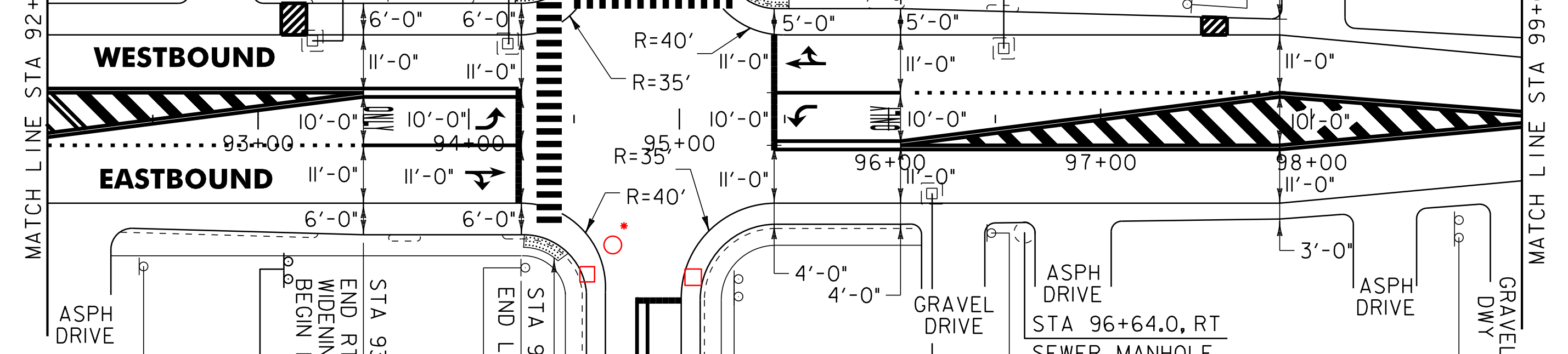
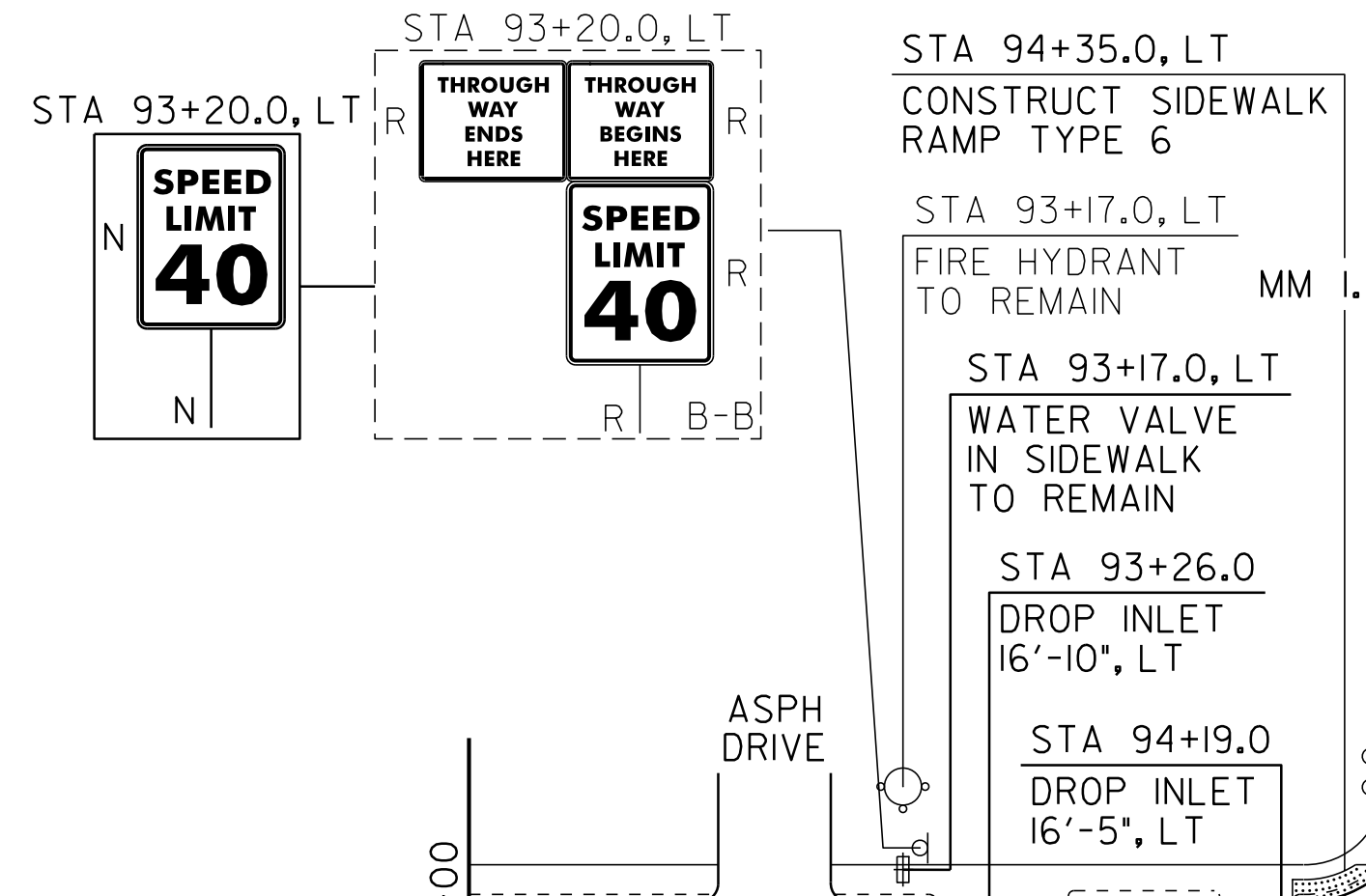
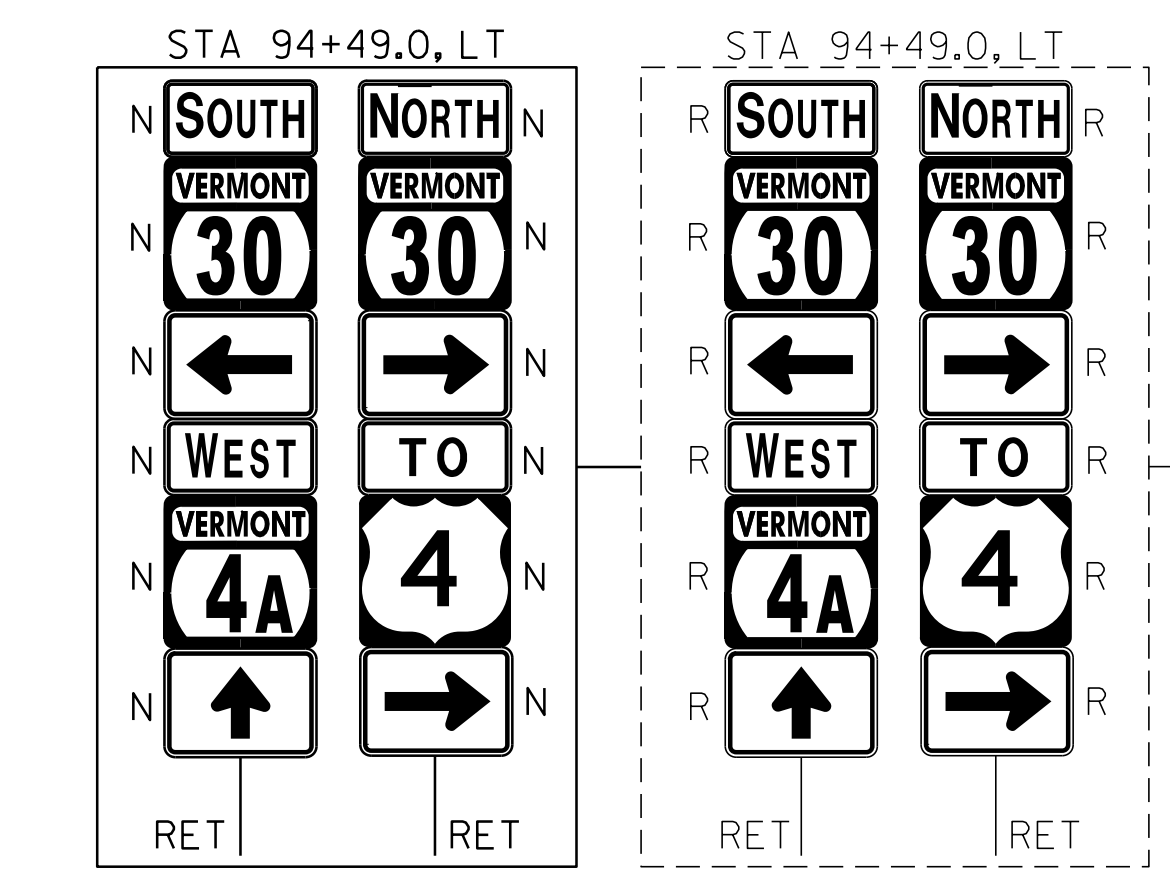

CASTLETON:
 STA 93+54.17 C/L, "O,N,L,Y" (4 EA)
 STA 94+14.50 RT, ARROW (2 EA)
 STA 94+16.25 C/L, ARROW (1EA)
 STA 94+82.88 LT, "O,N,L,Y" (4 EA)
 STA 94+82.88 LT, ARROW (1EA)
 STA 94+82.88 LT, ARROW (2 EA)
 STA 95+53.25 C/L, ARROW (1EA)
 STA 95+55.50 LT, ARROW (2 EA)
 STA 96+00.83 C/L, "O,N,L,Y" (4 EA)

CASTLETON:
 STA 94+14.50 RT, ARROW (4 EA)
 STA 94+16.25 C/L, ARROW (2 EA)
 STA 94+82.88 LT, ARROW (2 EA)
 STA 94+82.88 LT, ARROW (4 EA)
 STA 95+53.25 C/L, ARROW (2 EA)
 STA 95+55.50 LT, ARROW (4 EA)

646.702 TEMPORARY CROSSWALK MARKING, PAINT
 CASTLETON:
 STA 94+35.00 LT/RT
 STA 94+82.88 LT

675.50 REMOVING SIGNS
 AS SHOWN - 36

SIGN LEGEND
 R = REMOVE
 S = SALVAGE
 N = NEW
 RET = RETAIN
 B-B = BACK TO BACK
 EXISTING = - - - - -
 NEW = _____

PROJECT LAYOUT SHEET #16

PROJECT NAME: FAIR HAVEN - CASTLETON
 PROJECT NUMBER: STP HES 2614(1)S
 FILE NAME: p06c058.dgn
 PROJECT LEADER: D.E.G.
 DESIGNED BY: M.J.M.
 IPARM FILE: p06c058i16.i
 PLOT DATE: 22-FEB-2012 12:48
 DRAWN BY: C.A.K.
 CHECKED BY: D.E.G.
 SHEET 37 OF 157

NOT TO SCALE