

646.402 DURABLE 4 INCH WHITE LINE, THERMOPLASTIC  
 (ALL LINES WILL INCLUDE EDGE LINE BREAKS AND RADIUS FOR TOWN HIGHWAYS)

FAIR HAVEN:  
 STA 158+00.00 - STA 171+75.84 LT & RT

CASTLETON:  
 STA 0+00.00 - STA 1+00.00 LT & RT

646.602 TEMPORARY 4 INCH WHITE LINE, PAINT  
 (ALL LINES WILL INCLUDE EDGE LINE BREAKS AND RADIUS FOR TOWN HIGHWAYS)

FAIR HAVEN:  
 STA 158+00.00 - STA 171+75.84 LT & RT

CASTLETON:  
 STA 0+00.00 - STA 1+00.00 LT & RT

646.612 DURABLE 4 INCH YELLOW LINE, THERMOPLASTIC  
 (ALL LINES WILL INCLUDE C/L BREAKS FOR TOWN HIGHWAYS) S=SOLID, D=DASHED

FAIR HAVEN:  
 STA 158+00.00 - STA 161+35.00  
 STA 161+35.00 - STA 171+75.84

CASTLETON:  
 STA 0+00.00 - STA 1+00.00

646.612 TEMPORARY 4 INCH YELLOW LINE, PAINT  
 (ALL LINES WILL INCLUDE C/L BREAKS FOR TOWN HIGHWAYS) S=SOLID, D=DASHED

FAIR HAVEN:  
 STA 158+00.00 - STA 161+35.00  
 STA 161+35.00 - STA 171+75.84

CASTLETON:  
 STA 0+00.00 - STA 1+00.00

675.50 REMOVING SIGNS  
 AS SHOWN - 8

END FAIR HAVEN  
 MM 3.253 = STA 171+75.84  
 BEGIN CASTLETON  
 MM 0.000 = STA 0+00.00

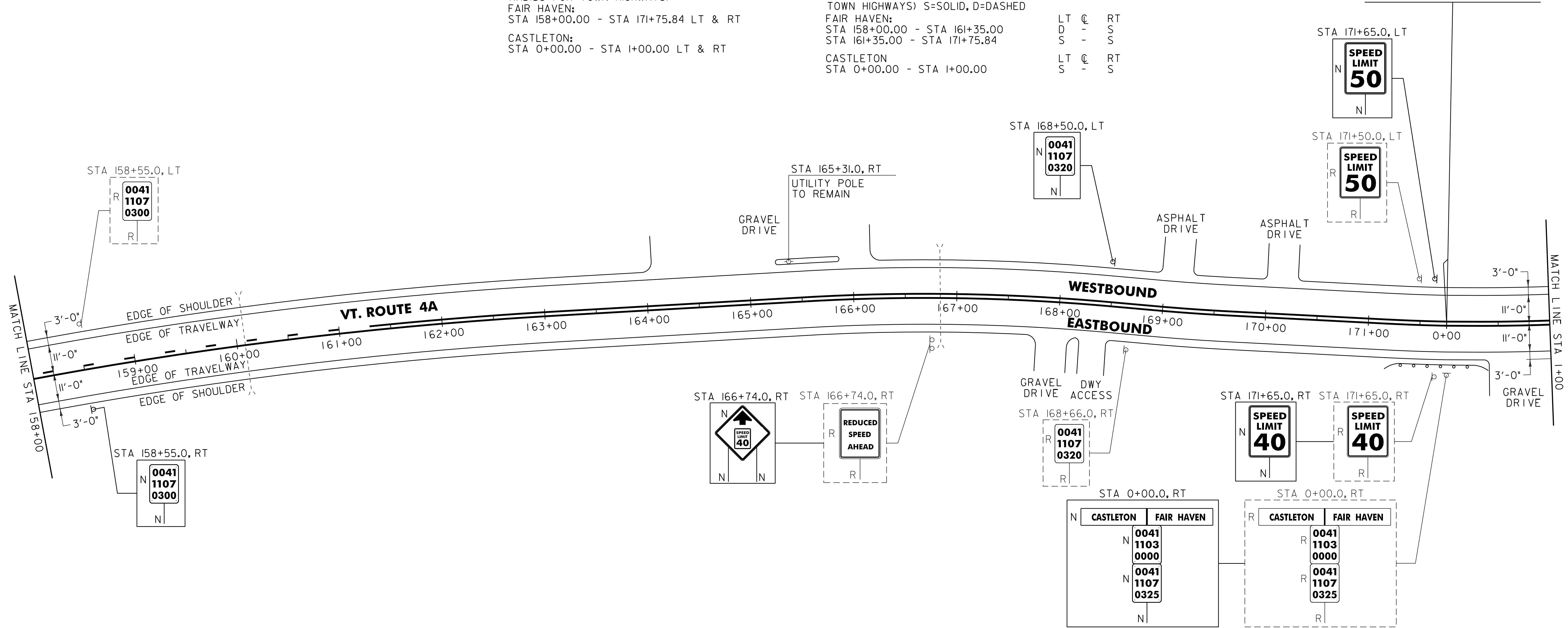

621.20 STEEL BEAM GUARDRAIL, GALVANIZED

FAIR HAVEN:  
 STA 171+31.8 - STA 171+75.8 RT (44.0 LF)

CASTLETON:  
 STA 0+00.0 - STA 0+35.0 RT (35.0 LF)

621.60 ANCHOR FOR STEEL BEAM RAIL

FAIR HAVEN:  
 STA 171+38.3 RT

CASTLETON:  
 STA 0+28.5 RT

621.80 REMOVAL AND DISPOSAL OF GUARDRAIL

FAIR HAVEN:  
 STA 171+31.8 - STA. 171+75.8 RT (44.0 LF)

CASTLETON:  
 STA 0+00.0 - STA. 0+35.0 RT (35.0 LF)

SIGN LEGEND

- R = REMOVE
- S = SALVAGE
- N = NEW
- RET = RETAIN
- B-B = BACK TO BACK
- EXISTING = - - - - -
- NEW = \_\_\_\_\_

NOT TO SCALE

<b>PROJECT LAYOUT SHEET #8</b>	PROJECT NAME: FAIR HAVEN - CASTLETON
	PROJECT NUMBER: STP HES 2614(1)S
	FILE NAME: p06c058.dgn
	PLOT DATE: 22-FEB-2012 12:47
	PROJECT LEADER: D.E.G.
	DESIGNED BY: M.J.M.
	IPARM FILE: p06c058i08.i
	DRAWN BY: C.A.K.
	CHECKED BY: D.E.G.
	SHEET 29 OF 157